

HOBBSOCD**Revised Permit Information 5/14/15:****MAY 19 2015**

Well Name: Osprey 10 No. 702H

RECEIVED

Location:

SL: 220' FNL & 1715' FWL, Section 10, T-25-S, R-34-E, Lea Co., N.M.

BHL: 230' FSL & 1720' FWL, Section 10, T-25-S, R-34-E, Lea Co., N.M.

Casing Program:

Hole Size	Interval	Csg OD	Weight	Grade	Conn	DF _{min} Collapse	DF _{min} Burst	DF _{min} Tension
12.25"	0-1,250'	9.625"	40#	J55	STC	1.125	1.25	1.60
8.75"	0-11,400'	7"	26#	HCP-110	LTC	1.125	1.25	1.60
6.125"	0'-17,264'	4.5"	13.5#	HCP-110	BTC	1.125	1.25	1.60

Cement Program:

Depth	No. Sacks	Wt. ppg	Yld Ft ³ /ft	Slurry Description
1,250'	400	13.5	1.73	Class C + 4.0% Bentonite + 0.6% CD-32 + 0.5% CaCl ₂ + 0.25 lb/sk Cello-Flake (TOC @ Surface)
	200	14.8	1.34	Class C + 0.6% FL-62 + 0.25 lb/sk Cello-Flake + 0.2% Sodium Metasilicate
11,400' DV Tool @ 5,200'	300	10.8	3.68	Stage 1 Lead: Class C + 15.00 lbs/sk BA-90 + 4.00% MPA-5 + 3.00% SMS + 5.00% A-10 + 1.00% BA-10A + 0.80% ASA-301 + 2.90% R-21 + 8.00 lb/sk LCM-1 + 0.005 lb/sx Static Free
	200	14.2	1.32	Stage 1 Tail: Class H + 0.65% FL-52 + 0.6% CD-32 + 1.0% EC-1 + 0.65% SMS + 2.0% Salt + 0.2% R-21 + 0.005 gps FP-6L + 0.005 pps Static Free
	400	12.7	2.22	Stage 2 Lead: Class 'C' + 2.0% SMS + 10.0% Slat + 0.55% R-21 + 0.25 pps Celloflake + 0.005 pps Static Free (TOC @ Surface)
	200	14.8	1.35	Stage 2 Tail: Class 'C' + 0.60% FL-62 + 0.7% CD-32 + 0.3% SMS + 2.0% Salt + 0.10% R-3 + 0.005 pps Static Free + 0.005 gps FP-6L
17,264'	575	11.9	2.36	50:50:6 Class H + 0.20% FL-52 + 0.75% CD-32 + 1.0% EC-1 + 0.15% ASA-301 + 1.60% SMS + 5.0% Salt + 0.50% R-21 + 5.0 pps LCM-1 (TOC @ 10,850')
	450	14.2	1.35	50:50:2 Class H + 0.65% FL-52 + 0.70% CD-32 + 1.0% EC-1 + 0.40% SMS + 2.0% Salt + 0.05% R-3 + 0.005 pps Static Free + 0.005 gps FP-6L

Mud Program:

Depth	Type	Weight (ppg)	Viscosity	Water Loss
0-1,250'	Fresh - Gel	8.6-8.8	28-34	N/c
1,250'-11,400'	Oil Base	8.7-9.4	58-68	N/c - 6
11,400'-11,913'	Oil Base	8.7-9.4	58-68	N/c - 6
11,913'-17,264' Lateral	Oil Base	9.0-9.5	58-68	N/c - 6

MAY 21 2015

Osprey 10 #702H

Lea County, New Mexico
Proposed Wellbore
Revised 5/14/15
API: 30-025-42382

220' FNL
1715' FWL
Section 10
T-25-S, R-34-E

KB: 3,371'
GL: 3,346'

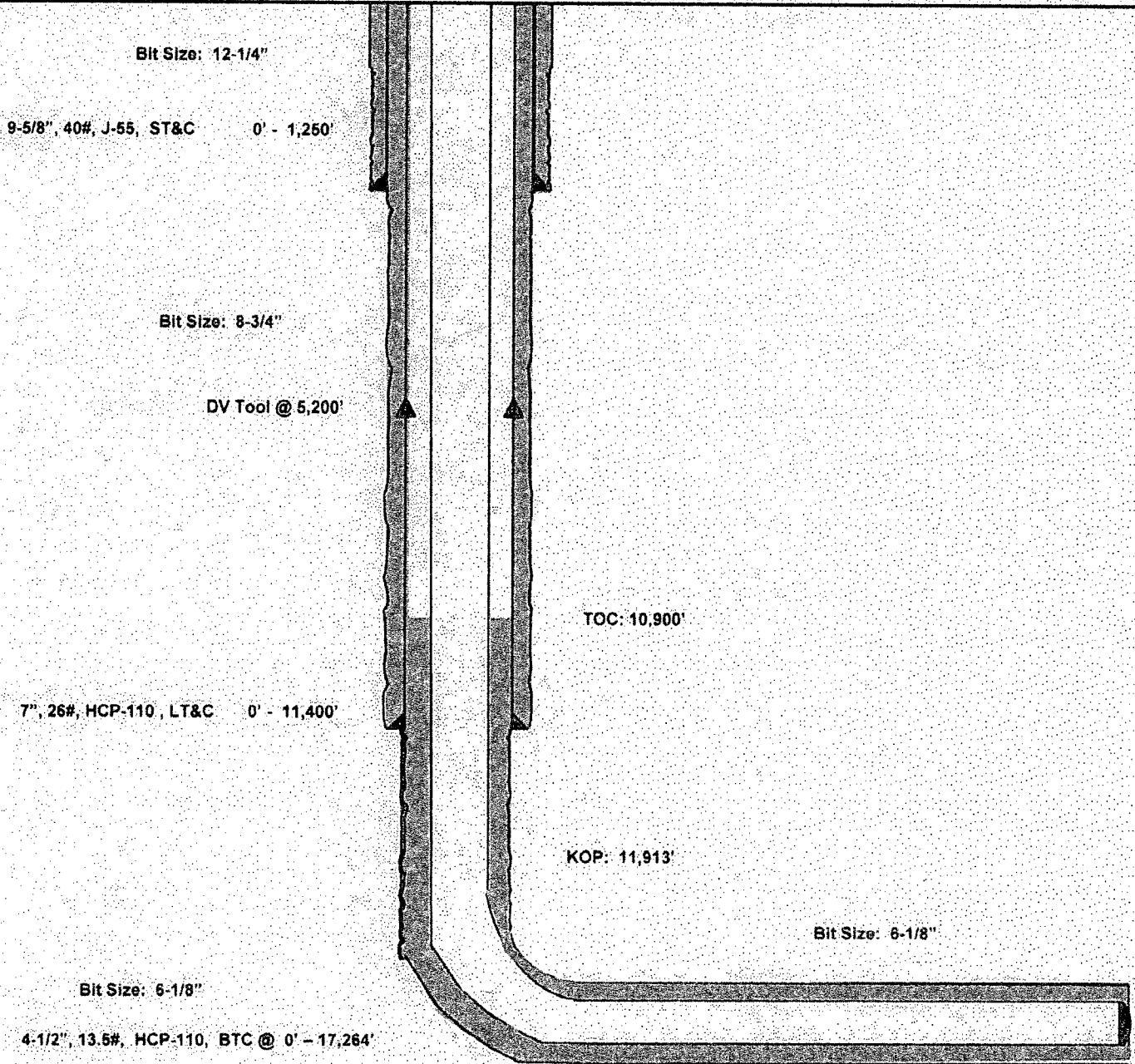

Lateral: 17,264' MD, 12,510' TVD
BH Location: 230' FSL & 1720' FWL
Section 10
T-25-S, R-34-E



Lea County, NM (NAD 27 NME)

Osprey 10 #702H

Plan #2

PROJECT DETAILS: Lea County NM (NAD 27 NME)

Geodetic System: US State Plane 1927 (Exact solution)
Datum: NAD 1927 (NADCON CONUS)
Ellipsoid: Clarke 1866
Zone: New Mexico East 2001
System Datum: Mean Sea Level

Azimuth to Grid North
True North: -0.47°
Magnetic North: 0.00°
Magnetic Field
Strength: 48153.3nT
Dip Angle: 66.03°
Date: 12/05/2015
Model: IGRF2015

To convert a Magnetic Direction to a Grid Direction, Add 0.47°.
To convert a Magnetic Direction to a True Direction, Add 7.161° East.
To convert a True Direction to a Grid Direction, Subtract 0.47°.

WELL DETAILS: #102H

North	East	Northing	Easting	Longitude	Lat
0.0	0.0	419054.00	770104.00	103°27'37.932 W	

SECTION DETAILS

Seq	MD	Inc	Asst	TVD	MD-S	MD-W	Diag	T-Base	V-Speed	Target	Annotation
1	0.0	0.00	0.00	0.0	0.0	0.00	0.00	0.00	0.00		
2	4603.0	0.65	0.00	4200.0	0.0	0.0	0.00	0.00	0.00		
3	4648.2	1.48	1.10	4040.3	1.7	0.0	1.99	1.18	1.7		
4	11913.7	1.40	1.10	11911.5	174.8	3.7	0.00	0.00	-178.8		
5	12024.8	09.65	176.02	12048.8	206.1	7.8	10.00	178.44	304.1		
6	14034.5	09.65	176.02	13845.5	1394.9	15.8	0.00	0.00	1600.0	TTT#1 (Osprey 10 #702H)	
7	14039.8	09.60	174.02	11505.0	-1903.2	15.8	0.00	0.00	1805.3	TTT#2 (Osprey 10 #702H)	
8	16234.5	09.60	174.12	12516.0	-3019.0	23.5	0.00	0.00	3000.0	PTM#1 (Osprey 10 #702H)	
9	15444.8	09.60	173.02	12510.0	-2019.1	23.0	0.00	0.00	3010.3	PTM#2 (Osprey 10 #702H)	
10	17264.7	09.60	173.02	12510.0	-4438.0	37.0	0.00	0.00	4438.0		

WELLBORE TARGET DETAILS (NAD CO-ORDINATES)

Name	TVD	MD-S	MD-W	Northing	Easting	Shape
TTT#1 (Osprey 10 #702H)	12048.8	-119.6	6.8	41944.00	770200.00	Point
TTT#2 (Osprey 10 #702H)	11505.0	-199.8	15.8	41834.10	770207.70	Point
PTM#1 (Osprey 10 #702H)	12510.0	-2019.0	23.5	41913.50	770211.00	Rectangle (E-Max: 1.00 W-Min: 0)
PTM#2 (Osprey 10 #702H)	12510.0	-2019.0	23.0	41934.10	770211.50	Point

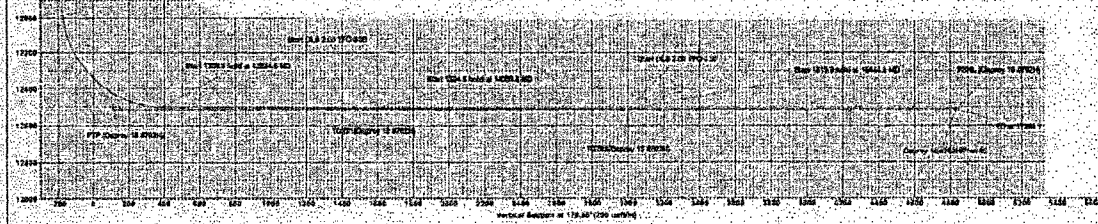
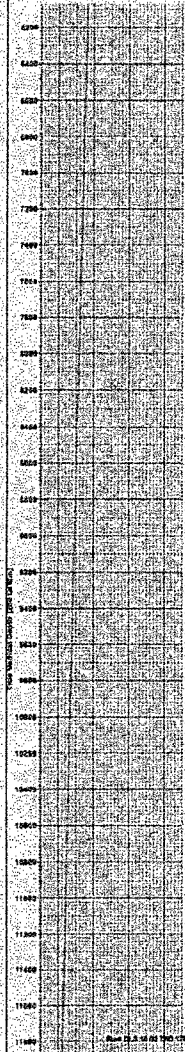
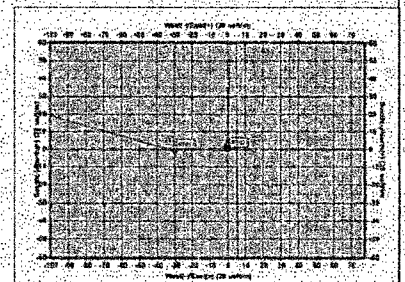
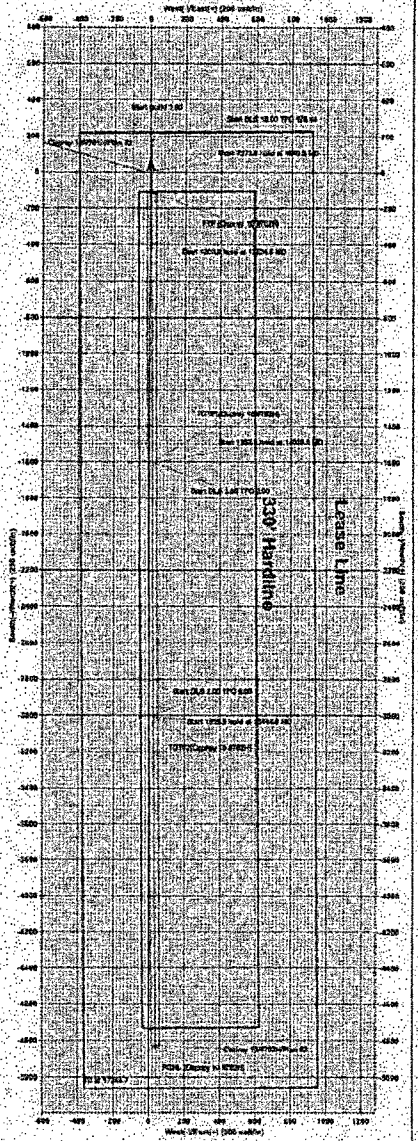
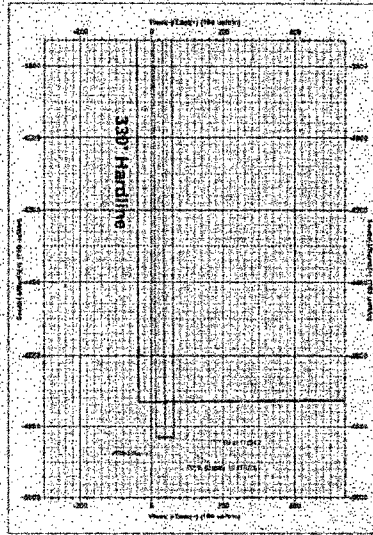
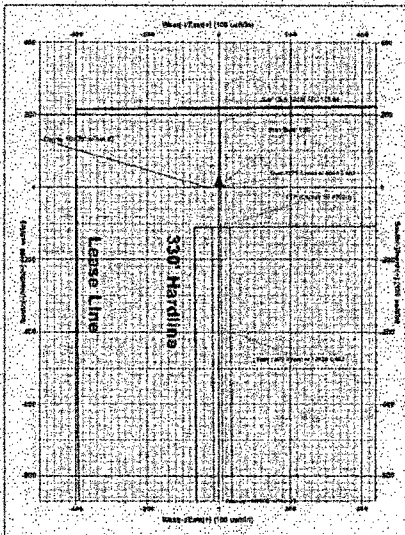



EOG Resources - Midland

Lea County, NM (NAD 27 NME)

Osprey 10

#702H

OH

Plan: Plan #2

Standard Planning Report

19 May, 2015



EOG Resources, Inc.
Planning Report

Database:	EDM 5000.1 Single User Db	Local Co-ordinate Reference:	Well #702H
Company:	EOG Resources - Midland	TVD Reference:	KB = 25' @ 3371.0usft
Project:	Lea County, NM (NAD:27 NME)	MD Reference:	KB = 25' @ 3371.0usft
Site:	Osprey 10	North Reference:	Grid
Well:	#702H	Survey Calculation Method:	Minimum Curvature
Wellbore:	OH		
Design:	Plan #2		

Project:	Lea County, NM (NAD:27 NME)		
Map System:	US State Plane 1927 (Exact solution)	System Datum:	Mean Sea Level
Geo Datum:	NAD 1927 (NADCON CONUS)		
Map Zone:	New Mexico East 3001		

Site:	Osprey 10				
Site Position:	From: Map	Northing:	415,103.00 usft	Latitude:	32° 8' 17.729 N
		Easting:	768,701.00 usft	Longitude:	103° 27' 54.902 W
Position Uncertainty:	0.0 usft	Slot Radius:	13-3/16"	Grid Convergence:	0.46°

Well:	#702H					
Well Position	+N/-S	4,851.0 usft	Northing:	419,954.00 usft	Latitude:	32° 9' 5.612 N
	+E/-W	1,493.0 usft	Easting:	770,194.00 usft	Longitude:	103° 27' 37.082 W
Position Uncertainty	0.0 usft		Wellhead Elevation:	0.0 usft	Ground Level:	3,346.0 usft

Wellbore:	OH				
Magnetics	Model Name	Sample Date	Declination (°)	Dip Angle (°)	Field Strength (nT)
	IGRF2015	1/26/2015	7.16	60.05	48,153

Design:	Plan #2			
Audit Notes:				
Version:	Phase:	PLAN	Tie On Depth:	0.0
Vertical Section:	Depth From (TVD) (usft)	+N/-S (usft)	+E/-W (usft)	Direction (°)
	0.0	0.0	0.0	179.56

Measured Depth (usft)	Inclination (°)	Azimuth (°)	Vertical Depth (usft)	+N/-S (usft)	+E/-W (usft)	Dogleg Rate (°/100usft)	Build Rate (°/100usft)	Turn Rate (°/100usft)	TFO (°)	Target
0.0	0.00	0.00	0.0	0.0	0.0	0.00	0.00	0.00	0.00	
4,500.0	0.00	0.00	4,500.0	0.0	0.0	0.00	0.00	0.00	0.00	
4,640.2	1.40	1.18	4,640.2	1.7	0.0	1.00	1.00	0.00	1.18	
11,913.7	1.40	1.18	11,911.5	179.6	3.7	0.00	0.00	0.00	0.00	
12,824.6	89.69	179.62	12,498.5	-390.1	7.8	10.00	9.69	19.59	178.44	
14,034.5	89.69	179.62	12,505.0	-1,599.9	15.8	0.00	0.00	0.00	0.00	TGT#1(Osprey 10 #7)
14,039.8	89.80	179.62	12,505.0	-1,605.2	15.8	2.00	2.00	0.00	0.00	
15,434.5	89.80	179.62	12,510.0	-2,999.9	25.0	0.00	0.00	0.00	0.00	TGT#2(Osprey 10 #7)
15,444.8	90.00	179.62	12,510.0	-3,010.1	25.0	2.00	2.00	0.00	0.00	
17,264.7	90.00	179.62	12,510.0	-4,830.0	37.0	0.00	0.00	0.00	0.00	PBHL (Osprey 10 #7C)



EOG Resources, Inc.

Planning Report

Database:	EDM 5000.1 Single User Db	Local Co-ordinate Reference:	Well #702H
Company:	EOG Resources - Midland	TVD Reference:	KB = 25' @ 3371.0usft
Project:	Lea County, NM (NAD 27 NME)	MD Reference:	KB = 25' @ 3371.0usft
Site:	Osprey 10	North Reference:	Grid
Well:	#702H	Survey Calculation Method:	Minimum Curvature
Wellbore:	OH		
Design:	Plan #2		

Planned Survey										
Measured Depth (usft)	Inclination (°)	Azimuth (°)	Vertical Depth (usft)	+N/-S (usft)	+E/-W (usft)	Vertical Section (usft)	Dogleg Rate (°/100usft)	Build Rate (°/100usft)	Turn Rate (°/100usft)	
0.0	0.00	0.00	0.0	0.0	0.0	0.0	0.00	0.00	0.00	
100.0	0.00	0.00	100.0	0.0	0.0	0.0	0.00	0.00	0.00	
200.0	0.00	0.00	200.0	0.0	0.0	0.0	0.00	0.00	0.00	
300.0	0.00	0.00	300.0	0.0	0.0	0.0	0.00	0.00	0.00	
400.0	0.00	0.00	400.0	0.0	0.0	0.0	0.00	0.00	0.00	
500.0	0.00	0.00	500.0	0.0	0.0	0.0	0.00	0.00	0.00	
600.0	0.00	0.00	600.0	0.0	0.0	0.0	0.00	0.00	0.00	
700.0	0.00	0.00	700.0	0.0	0.0	0.0	0.00	0.00	0.00	
800.0	0.00	0.00	800.0	0.0	0.0	0.0	0.00	0.00	0.00	
900.0	0.00	0.00	900.0	0.0	0.0	0.0	0.00	0.00	0.00	
1,000.0	0.00	0.00	1,000.0	0.0	0.0	0.0	0.00	0.00	0.00	
1,100.0	0.00	0.00	1,100.0	0.0	0.0	0.0	0.00	0.00	0.00	
1,200.0	0.00	0.00	1,200.0	0.0	0.0	0.0	0.00	0.00	0.00	
1,300.0	0.00	0.00	1,300.0	0.0	0.0	0.0	0.00	0.00	0.00	
1,400.0	0.00	0.00	1,400.0	0.0	0.0	0.0	0.00	0.00	0.00	
1,500.0	0.00	0.00	1,500.0	0.0	0.0	0.0	0.00	0.00	0.00	
1,600.0	0.00	0.00	1,600.0	0.0	0.0	0.0	0.00	0.00	0.00	
1,700.0	0.00	0.00	1,700.0	0.0	0.0	0.0	0.00	0.00	0.00	
1,800.0	0.00	0.00	1,800.0	0.0	0.0	0.0	0.00	0.00	0.00	
1,900.0	0.00	0.00	1,900.0	0.0	0.0	0.0	0.00	0.00	0.00	
2,000.0	0.00	0.00	2,000.0	0.0	0.0	0.0	0.00	0.00	0.00	
2,100.0	0.00	0.00	2,100.0	0.0	0.0	0.0	0.00	0.00	0.00	
2,200.0	0.00	0.00	2,200.0	0.0	0.0	0.0	0.00	0.00	0.00	
2,300.0	0.00	0.00	2,300.0	0.0	0.0	0.0	0.00	0.00	0.00	
2,400.0	0.00	0.00	2,400.0	0.0	0.0	0.0	0.00	0.00	0.00	
2,500.0	0.00	0.00	2,500.0	0.0	0.0	0.0	0.00	0.00	0.00	
2,600.0	0.00	0.00	2,600.0	0.0	0.0	0.0	0.00	0.00	0.00	
2,700.0	0.00	0.00	2,700.0	0.0	0.0	0.0	0.00	0.00	0.00	
2,800.0	0.00	0.00	2,800.0	0.0	0.0	0.0	0.00	0.00	0.00	
2,900.0	0.00	0.00	2,900.0	0.0	0.0	0.0	0.00	0.00	0.00	
3,000.0	0.00	0.00	3,000.0	0.0	0.0	0.0	0.00	0.00	0.00	
3,100.0	0.00	0.00	3,100.0	0.0	0.0	0.0	0.00	0.00	0.00	
3,200.0	0.00	0.00	3,200.0	0.0	0.0	0.0	0.00	0.00	0.00	
3,300.0	0.00	0.00	3,300.0	0.0	0.0	0.0	0.00	0.00	0.00	
3,400.0	0.00	0.00	3,400.0	0.0	0.0	0.0	0.00	0.00	0.00	
3,500.0	0.00	0.00	3,500.0	0.0	0.0	0.0	0.00	0.00	0.00	
3,600.0	0.00	0.00	3,600.0	0.0	0.0	0.0	0.00	0.00	0.00	
3,700.0	0.00	0.00	3,700.0	0.0	0.0	0.0	0.00	0.00	0.00	
3,800.0	0.00	0.00	3,800.0	0.0	0.0	0.0	0.00	0.00	0.00	
3,900.0	0.00	0.00	3,900.0	0.0	0.0	0.0	0.00	0.00	0.00	
4,000.0	0.00	0.00	4,000.0	0.0	0.0	0.0	0.00	0.00	0.00	
4,100.0	0.00	0.00	4,100.0	0.0	0.0	0.0	0.00	0.00	0.00	
4,200.0	0.00	0.00	4,200.0	0.0	0.0	0.0	0.00	0.00	0.00	
4,300.0	0.00	0.00	4,300.0	0.0	0.0	0.0	0.00	0.00	0.00	
4,400.0	0.00	0.00	4,400.0	0.0	0.0	0.0	0.00	0.00	0.00	
4,500.0	0.00	0.00	4,500.0	0.0	0.0	0.0	0.00	0.00	0.00	
4,600.0	1.00	1.18	4,600.0	0.9	0.0	-0.9	1.00	1.00	0.00	
4,640.2	1.40	1.18	4,640.2	1.7	0.0	-1.7	1.00	1.00	0.00	
4,700.0	1.40	1.18	4,700.0	3.2	0.1	-3.2	0.00	0.00	0.00	
4,800.0	1.40	1.18	4,799.9	5.6	0.1	-5.6	0.00	0.00	0.00	
4,900.0	1.40	1.18	4,899.9	8.1	0.2	-8.1	0.00	0.00	0.00	
5,000.0	1.40	1.18	4,999.9	10.5	0.2	-10.5	0.00	0.00	0.00	
5,100.0	1.40	1.18	5,099.8	13.0	0.3	-13.0	0.00	0.00	0.00	
5,200.0	1.40	1.18	5,199.8	15.4	0.3	-15.4	0.00	0.00	0.00	



EOG Resources, Inc.

Planning Report

Database:	EDM 5000.1 Single User Db	Local Co-ordinate Reference:	Well #702H
Company:	EOG Resources - Midland	TVD Reference:	KB = 25' @ 337.1 0usft
Project:	Lea County, NM (NAD 27 NME)	MD Reference:	KB = 25' @ 337.1 0usft
Site:	Osprey 10	North Reference:	Grid
Well:	#702H	Survey Calculation Method:	Minimum Curvature
Wellbore:	OH		
Design:	Plan #2		

Planned Survey

Measured Depth (usft)	Inclination (°)	Azimuth (°)	Vertical Depth (usft)	+N/-S (usft)	+E/-W (usft)	Vertical Section (usft)	Dogleg Rate (°/100usft)	Build Rate (°/100usft)	Turn Rate (°/100usft)
5,300.0	1.40	1.18	5,299.8	17.9	0.4	-17.6	0.00	0.00	0.00
5,400.0	1.40	1.18	5,399.8	20.3	0.4	-20.3	0.00	0.00	0.00
5,500.0	1.40	1.18	5,499.7	22.7	0.5	-22.7	0.00	0.00	0.00
5,600.0	1.40	1.18	5,599.7	25.2	0.5	-25.2	0.00	0.00	0.00
5,700.0	1.40	1.18	5,699.7	27.6	0.6	-27.6	0.00	0.00	0.00
5,800.0	1.40	1.18	5,799.6	30.1	0.6	-30.1	0.00	0.00	0.00
5,900.0	1.40	1.18	5,899.6	32.5	0.7	-32.5	0.00	0.00	0.00
6,000.0	1.40	1.18	5,999.6	35.0	0.7	-35.0	0.00	0.00	0.00
6,100.0	1.40	1.18	6,099.5	37.4	0.8	-37.4	0.00	0.00	0.00
6,200.0	1.40	1.18	6,199.5	39.9	0.8	-39.9	0.00	0.00	0.00
6,300.0	1.40	1.18	6,299.5	42.3	0.9	-42.3	0.00	0.00	0.00
6,400.0	1.40	1.18	6,399.5	44.8	0.9	-44.7	0.00	0.00	0.00
6,500.0	1.40	1.18	6,499.4	47.2	1.0	-47.2	0.00	0.00	0.00
6,600.0	1.40	1.18	6,599.4	49.6	1.0	-49.6	0.00	0.00	0.00
6,700.0	1.40	1.18	6,699.4	52.1	1.1	-52.1	0.00	0.00	0.00
6,800.0	1.40	1.18	6,799.3	54.5	1.1	-54.5	0.00	0.00	0.00
6,900.0	1.40	1.18	6,899.3	57.0	1.2	-57.0	0.00	0.00	0.00
7,000.0	1.40	1.18	6,999.3	59.4	1.2	-59.4	0.00	0.00	0.00
7,100.0	1.40	1.18	7,099.2	61.9	1.3	-61.9	0.00	0.00	0.00
7,200.0	1.40	1.18	7,199.2	64.3	1.3	-64.3	0.00	0.00	0.00
7,300.0	1.40	1.18	7,299.2	66.8	1.4	-66.8	0.00	0.00	0.00
7,400.0	1.40	1.18	7,399.2	69.2	1.4	-69.2	0.00	0.00	0.00
7,500.0	1.40	1.18	7,499.1	71.7	1.5	-71.6	0.00	0.00	0.00
7,600.0	1.40	1.18	7,599.1	74.1	1.5	-74.1	0.00	0.00	0.00
7,700.0	1.40	1.18	7,699.1	76.6	1.6	-76.5	0.00	0.00	0.00
7,800.0	1.40	1.18	7,799.0	79.0	1.6	-79.0	0.00	0.00	0.00
7,900.0	1.40	1.18	7,899.0	81.4	1.7	-81.4	0.00	0.00	0.00
8,000.0	1.40	1.18	7,999.0	83.9	1.7	-83.9	0.00	0.00	0.00
8,100.0	1.40	1.18	8,099.0	86.3	1.8	-86.3	0.00	0.00	0.00
8,200.0	1.40	1.18	8,198.9	88.8	1.8	-88.8	0.00	0.00	0.00
8,300.0	1.40	1.18	8,298.9	91.2	1.9	-91.2	0.00	0.00	0.00
8,400.0	1.40	1.18	8,398.9	93.7	1.9	-93.7	0.00	0.00	0.00
8,500.0	1.40	1.18	8,498.8	96.1	2.0	-96.1	0.00	0.00	0.00
8,600.0	1.40	1.18	8,598.8	98.6	2.0	-98.5	0.00	0.00	0.00
8,700.0	1.40	1.18	8,698.8	101.0	2.1	-101.0	0.00	0.00	0.00
8,800.0	1.40	1.18	8,798.7	103.5	2.1	-103.4	0.00	0.00	0.00
8,900.0	1.40	1.18	8,898.7	105.9	2.2	-105.9	0.00	0.00	0.00
9,000.0	1.40	1.18	8,998.7	108.3	2.2	-108.3	0.00	0.00	0.00
9,100.0	1.40	1.18	9,098.7	110.8	2.3	-110.8	0.00	0.00	0.00
9,200.0	1.40	1.18	9,198.6	113.2	2.3	-113.2	0.00	0.00	0.00
9,300.0	1.40	1.18	9,298.6	115.7	2.4	-115.7	0.00	0.00	0.00
9,400.0	1.40	1.18	9,398.6	118.1	2.4	-118.1	0.00	0.00	0.00
9,500.0	1.40	1.18	9,498.5	120.6	2.5	-120.6	0.00	0.00	0.00
9,600.0	1.40	1.18	9,598.5	123.0	2.5	-123.0	0.00	0.00	0.00
9,700.0	1.40	1.18	9,698.5	125.5	2.6	-125.4	0.00	0.00	0.00
9,800.0	1.40	1.18	9,798.4	127.9	2.6	-127.9	0.00	0.00	0.00
9,900.0	1.40	1.18	9,898.4	130.4	2.7	-130.3	0.00	0.00	0.00
10,000.0	1.40	1.18	9,998.4	132.8	2.7	-132.8	0.00	0.00	0.00
10,100.0	1.40	1.18	10,098.4	135.3	2.8	-135.2	0.00	0.00	0.00
10,200.0	1.40	1.18	10,198.3	137.7	2.8	-137.7	0.00	0.00	0.00
10,300.0	1.40	1.18	10,298.3	140.1	2.9	-140.1	0.00	0.00	0.00
10,400.0	1.40	1.18	10,398.3	142.6	2.9	-142.6	0.00	0.00	0.00
10,500.0	1.40	1.18	10,498.2	145.0	3.0	-145.0	0.00	0.00	0.00
10,600.0	1.40	1.18	10,598.2	147.5	3.0	-147.5	0.00	0.00	0.00



EOG Resources, Inc.
Planning Report

Database:	EDM 5000.1 Single User Db	Local Co-ordinate Reference:	Well #702H
Company:	EOG Resources - Midland	TVD Reference:	KB = 25' @ 3371.0usft
Project:	Lea County, NM (NAD 27 NME)	MD Reference:	KB = 25' @ 3371.0usft
Site:	Osprey 10	North Reference:	Grid
Well:	#702H	Survey Calculation Method:	Minimum Curvature
Wellbore:	OH		
Design:	Plan #2		

Measured Depth (usft)	Inclination (°)	Azimuth (°)	Vertical Depth (usft)	+N/-S (usft)	+E/-W (usft)	Vertical Section (usft)	Dogleg Rate (°/100usft)	Build Rate (°/100usft)	Turn Rate (°/100usft)
10,700.0	1.40	1.18	10,698.2	149.9	3.1	-149.9	0.00	0.00	0.00
10,800.0	1.40	1.18	10,798.1	152.4	3.1	-152.3	0.00	0.00	0.00
10,900.0	1.40	1.18	10,898.1	154.8	3.2	-154.8	0.00	0.00	0.00
11,000.0	1.40	1.18	10,998.1	157.3	3.2	-157.2	0.00	0.00	0.00
11,100.0	1.40	1.18	11,098.1	159.7	3.3	-159.7	0.00	0.00	0.00
11,200.0	1.40	1.18	11,198.0	162.2	3.3	-162.1	0.00	0.00	0.00
11,300.0	1.40	1.18	11,298.0	164.6	3.4	-164.6	0.00	0.00	0.00
11,400.0	1.40	1.18	11,398.0	167.1	3.4	-167.0	0.00	0.00	0.00
11,500.0	1.40	1.18	11,497.9	169.5	3.5	-169.5	0.00	0.00	0.00
11,600.0	1.40	1.18	11,597.9	171.9	3.6	-171.9	0.00	0.00	0.00
11,700.0	1.40	1.18	11,697.9	174.4	3.6	-174.4	0.00	0.00	0.00
11,800.0	1.40	1.18	11,797.8	176.8	3.7	-176.8	0.00	0.00	0.00
11,900.0	1.40	1.18	11,897.8	179.3	3.7	-179.2	0.00	0.00	0.00
11,913.7	1.40	1.18	11,911.5	179.6	3.7	-179.6	0.00	0.00	0.00
11,950.0	2.23	178.64	11,947.8	179.4	3.7	-179.3	10.00	2.28	488.66
12,000.0	7.23	179.32	11,997.6	175.2	3.8	-175.2	10.00	10.00	1.36
12,050.0	12.23	179.45	12,046.9	166.8	3.9	-166.7	10.00	10.00	0.25
12,100.0	17.23	179.50	12,095.2	154.1	4.0	-154.0	10.00	10.00	0.11
12,150.0	22.23	179.53	12,142.3	137.2	4.1	-137.2	10.00	10.00	0.06
12,200.0	27.23	179.55	12,187.7	116.3	4.3	-116.3	10.00	10.00	0.04
12,250.0	32.23	179.56	12,231.1	91.5	4.5	-91.5	10.00	10.00	0.03
12,300.0	37.23	179.57	12,272.2	63.0	4.7	-63.0	10.00	10.00	0.02
12,350.0	42.23	179.58	12,310.6	31.1	4.8	-31.0	10.00	10.00	0.02
12,400.0	47.23	179.59	12,346.1	-4.1	5.2	4.1	10.00	10.00	0.01
12,450.0	52.23	179.59	12,378.4	-42.2	5.5	42.3	10.00	10.00	0.01
12,500.0	57.23	179.60	12,407.3	-83.0	5.8	83.1	10.00	10.00	0.01
12,550.0	62.23	179.60	12,432.5	-126.2	6.1	126.3	10.00	10.00	0.01
12,563.3	63.56	179.60	12,438.5	-138.1	6.1	138.1	10.00	10.00	0.01
FTP (Osprey 10 #702H)									
12,600.0	67.23	179.61	12,453.8	-171.4	6.4	171.5	10.00	10.00	0.01
12,650.0	72.23	179.61	12,471.1	-218.3	6.7	218.3	10.00	10.00	0.01
12,700.0	77.23	179.62	12,484.3	-266.5	7.0	266.6	10.00	10.00	0.01
12,750.0	82.23	179.62	12,493.2	-315.7	7.3	315.7	10.00	10.00	0.01
12,800.0	87.23	179.62	12,497.8	-365.5	7.7	365.5	10.00	10.00	0.01
12,824.6	89.69	179.62	12,498.5	-390.1	7.8	390.1	10.00	10.00	0.01
12,900.0	89.69	179.62	12,498.9	-465.5	8.3	465.5	0.00	0.00	0.00
13,000.0	89.69	179.62	12,499.4	-565.5	9.0	565.5	0.00	0.00	0.00
13,100.0	89.69	179.62	12,499.9	-665.5	9.6	665.5	0.00	0.00	0.00
13,200.0	89.69	179.62	12,500.5	-765.4	10.3	765.5	0.00	0.00	0.00
13,300.0	89.69	179.62	12,501.0	-865.4	11.0	865.5	0.00	0.00	0.00
13,400.0	89.69	179.62	12,501.6	-965.4	11.6	965.5	0.00	0.00	0.00
13,500.0	89.69	179.62	12,502.1	-1,065.4	12.3	1,065.5	0.00	0.00	0.00
13,600.0	89.69	179.62	12,502.6	-1,165.4	12.9	1,165.5	0.00	0.00	0.00
13,700.0	89.69	179.62	12,503.2	-1,265.4	13.6	1,265.5	0.00	0.00	0.00
13,800.0	89.69	179.62	12,503.7	-1,365.4	14.2	1,365.5	0.00	0.00	0.00
13,900.0	89.69	179.62	12,504.3	-1,465.4	14.9	1,465.5	0.00	0.00	0.00
14,000.0	89.69	179.62	12,504.8	-1,565.4	15.6	1,565.5	0.00	0.00	0.00
14,034.5	89.69	179.62	12,505.0	-1,599.9	15.8	1,600.0	0.00	0.00	0.00
TGT#1 (Osprey 10 #702H)									
14,039.8	89.80	179.62	12,505.0	-1,605.2	15.8	1,605.3	2.00	2.00	0.00
14,100.0	89.80	179.62	12,505.2	-1,665.4	16.2	1,665.5	0.00	0.00	0.00
14,200.0	89.80	179.62	12,505.6	-1,765.4	16.9	1,765.5	0.00	0.00	0.00
14,300.0	89.80	179.62	12,506.0	-1,865.4	17.5	1,865.5	0.00	0.00	0.00
14,400.0	89.80	179.62	12,506.3	-1,965.4	18.2	1,965.5	0.00	0.00	0.00



EOG Resources, Inc.

Planning Report

Database:	EDM 5000.1 Single User Db	Local Co-ordinate Reference:	Well #702H
Company:	EOG Resources - Midland	TVD Reference:	KB = 25' @ 3371.0usft
Project:	Lea County, NM (NAD 27 NME)	MD Reference:	KB = 25' @ 3371.0usft
Site:	Osprey 10	North Reference:	Grid
Well:	#702H	Survey Calculation Method:	Minimum Curvature
Wellbore:	OH		
Design:	Plan #2		