

District I
1625 N. French Dr., Hobbs, NM 88240
District II
1301 W. Grand Avenue, Artesia, NM 88210
District III
1000 Rio Brazos Rd., Aztec, NM 87410
District IV
1220 S. St. Francis Dr., Santa Fe, NM 87505

Oil Conservation Division
1220 S. St. Francis Dr.
Santa Fe, NM 87505

Submit to appropriate District Office

AMENDED REPORT

APPLICATION FOR PERMIT TO DRILL, RE-ENTER, DEEPEN, PLUGBACK, OR ADD A ZONE

¹ Operator Name and Address MISSION RESOURCES CORPORATION 1100 LOUISIANA, STE. 4400, HOUSTON, TX 77002		² OGRID Number 148381
⁴ Property Code 33493	⁵ Property Name STATE A A/C 2	³ API Number 30-025-37564
⁹ Proposed Pool 1 JALMAT; TANSILL-YATES-7RIVERS (GAS) #79240		⁶ Well No. 086
¹⁰ Proposed Pool 2		

⁷ Surface Location

UL or lot no.	Section	Township	Range	Lot. Idn	Feet from the	North/South Line	Feet from the	East/West line	County
G	11	22S	36E		1980	NORTH	1980	EAST	LEA

⁸ Proposed Bottom Hole Location If Different From Surface

UL or lot no.	Section	Township	Range	Lot. Idn	Feet from the	North/South Line	Feet from the	East/West line	County
SAME									

Additional Well Location

¹¹ Work Type Code N	¹² Well Type Code G	¹³ Cable/Rotary R	¹⁴ Lease Type Code S	¹⁵ Ground Level Elevation 3525
¹⁶ Multiple NO	¹⁷ Proposed Depth 4000'	¹⁸ Formation YATES/7RIVERS	¹⁹ Contractor To be Determined	²⁰ Spud Date 12/15/05
Depth to ground water 137'		Distance from nearest fresh water well 1000' +		Distance from nearest surface water 1000' +
Pit: Liner: Synthetic <input checked="" type="checkbox"/> 12 mils thick Clay <input checked="" type="checkbox"/> Pit Volume 5704 bbls Drilling Method: ROTARY				
Closed-Loop System <input type="checkbox"/>		Fresh Water <input checked="" type="checkbox"/> Brine <input checked="" type="checkbox"/> Diesel/Oil-based <input type="checkbox"/>		Gas/Air <input type="checkbox"/>

²¹ Proposed Casing and Cement Program

Hole Size	Casing Size	Casing weight/foot	Setting Depth	Sacks of Cement	Estimated TOC
11"	8-5/8"	24#	600'	325	SURFACE
7-7/8"	4-1/2"	11.6#	4000'	725	SURFACE

²² Describe the proposed program. If this application is to DEEPEN or PLUG BACK, give the data on the present productive zone and proposed new productive zone. Describe the blowout prevention program, if any. Use additional sheets if necessary.

**Permit Expires 1 Year From Approval
Date Unless Drilling Underway**

Please see Attached:
Well Location & Acreage Dedication Plat (C-102)
Proposed Well Plan
Casing/Cementing Program
BOP/Choke Manifold Diagrams

²³ I hereby certify that the information given above is true and complete to the best of my knowledge and belief. I further certify that the drilling pit will be constructed according to NMOCD guidelines <input type="checkbox"/> a general permit <input type="checkbox"/> , or an (attached) alternative OCD-approved plan <input checked="" type="checkbox"/>		OIL CONSERVATION DIVISION	
Signature: <i>Nancy K. Gatti</i>		Approved by: <i>[Signature]</i> PETROLEUM ENGINEER	
Printed name: Nancy K. Gatti		Title: NOV 22 2005	
Title: Regulatory Manager		Approval Date: NOV 22 2005	
E-mail Address: ngatti@petrohawk.com		Expiration Date:	
Date: 11/17/05	Phone: 832-204-2700	Conditions of Approval: Attached <input type="checkbox"/>	

DISTRICT I
1625 N. French Dr., Hobbs, NM 88240

State of New Mexico
Energy, Minerals & Natural Resources Department

Form C-102
Revised August 15, 2000
Submit to Appropriate District Office
State Lease - 4 Copies
Fee Lease - 3 Copies

DISTRICT II
P.O. Drawer DD, Artesia, NM 88211-0719

OIL CONSERVATION DIVISION
2040 South Pacheco
Santa Fe, NM 87505

DISTRICT III
1000 Rio Brazos Rd., Aztec, NM 87410

DISTRICT IV
2040 South Pacheco, Santa Fe, NM 87606

AMENDED REPORT

WELL LOCATION AND ACREAGE DEDICATION PLAT

API Number 30-025-37564	Pool Code 79240	Pool Name Jalmat;tansill-yates-7rivers (gas)
Property Code 33493	Property Name STATE A A/C 2	Well Number 86
OGRID No. 148381	Operator Name MISSION RESOURCES CORPORATION	Elevation 3525'

Surface Location

UL or lot No.	Section	Township	Range	Lot Idn	Feet from the	North/South line	Feet from the	East/West line	County
G	11	22 S	36 E		1980	NORTH	1980	EAST	LEA

Bottom Hole Location If Different From Surface

UL or lot No.	Section	Township	Range	Lot Idn	Feet from the	North/South line	Feet from the	East/West line	County
same									

Dedicated Acres 640	Joint or Infill Infill	Consolidation Code	Order No. Admin. Order # SD-05-06 ✓
------------------------	---------------------------	--------------------	--

NO ALLOWABLE WILL BE ASSIGNED TO THIS COMPLETION UNTIL ALL INTERESTS HAVE BEEN CONSOLIDATED OR A NON-STANDARD UNIT HAS BEEN APPROVED BY THE DIVISION

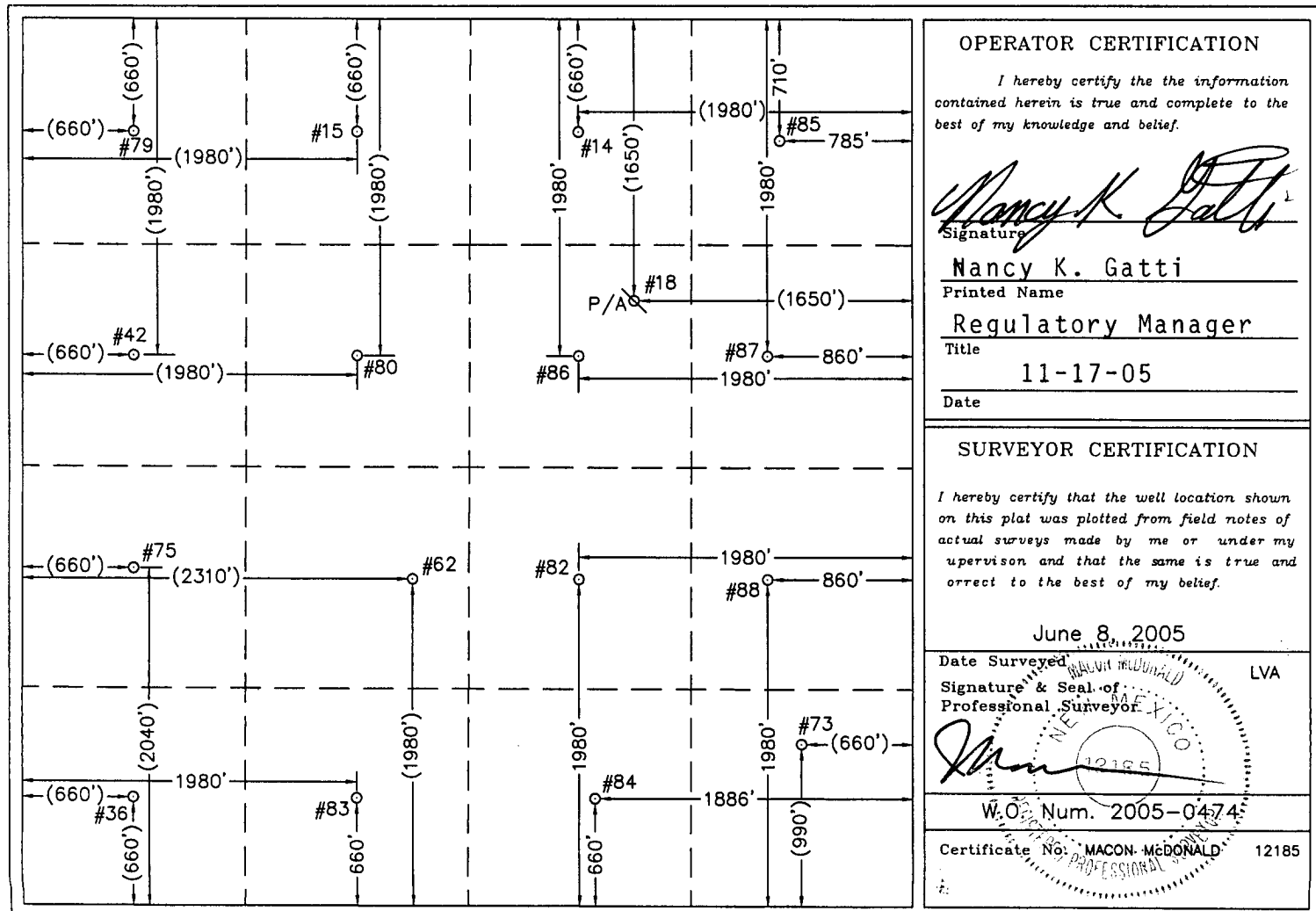

WELL LOCATIONS SHOWN HEREON WITH DIMENSIONS IN PARENTHESIS WERE PROVIDED BY MISSION RESOURCES CORPORATION AND ARE NOT FIELD SURVEYED.

PROPOSED WELL PLAN

1. Drill an 11" hole from surface to 600'
2. Run 8-5/8" 24# J-55 STC casing to 600' and cement to surface.
3. NU BOP's and drill a 7-7/8" hole to 4,000'.
4. Run 4-1/2" 11.6# J-55 casing to 4,000' and cement to surface.
5. Perforate the Yates/7-Rivers from 3000' to 3500'.
6. Acid and Frac treatment will be determined after looking at logs.
7. Complete and put on production.

CASING PROGRAM

SURFACE: 8-5/8" casing in 11" hole at 600'

PRODUCTION: 4-1/2" casing in 7-7/8" hole at 4,000'.

CEMENTING PROGRAM

SURFACE:

LEAD: 100 sx CI C + 4% gel + 2% CaCl₂ + 0.25 pps Cello-Flake
Mixed at 13.5 ppg (1.74 cf/sk)

TAIL: 125 sx CI C + 2% CaCl₂
Mixed at 14.8 ppg (1.34 cf/sk)

PRODUCTION:

LEAD: 475 sx 50:50 Poz/CI C + 10% gel + 5% salt
Mixed at 12.0 ppg (2.3 cf/sk)

TAIL: 250 sx 50:50 Poz/CI C + 2% gel + 5% salt
Mixed at 14.2 ppg (1.3 cf/sk)

MISSION RESOURCES CORPORATION

PROPOSED WELLBORE SCHEMATIC

State A A/C 2 Well #86

Lea County, NM

1980' FNL & 1980' FEL SEC 11, T22S, R36E

GL = 3525'
RKB = 3539'
RKB to GL = 14'

HOLE SIZE: 11"

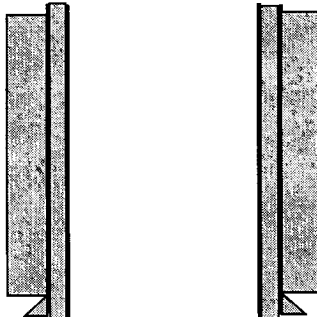

8-5/8", 24#, J-55, ST&C @ 600'
Cmt'd to surf

HOLE SIZE: 7-7/8"

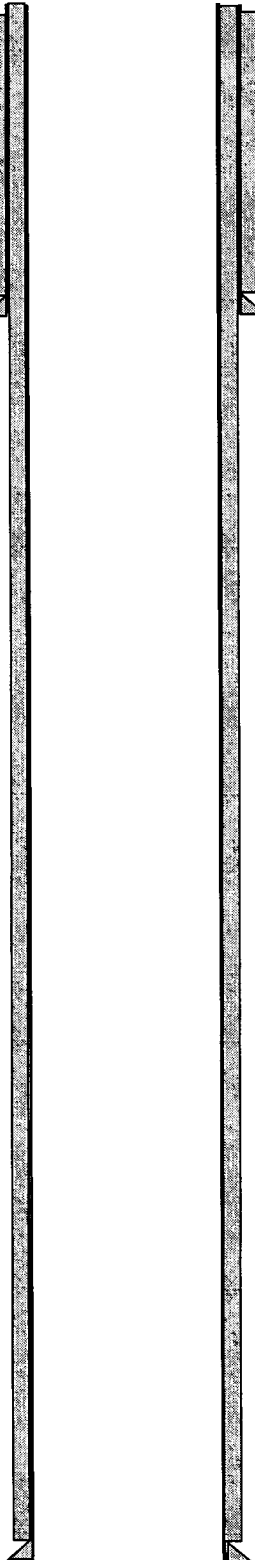

4-1/2", 11.6#, J-55, LTC @ 4000'
Cmt'd to surf

BOP SPECIFICATIONS

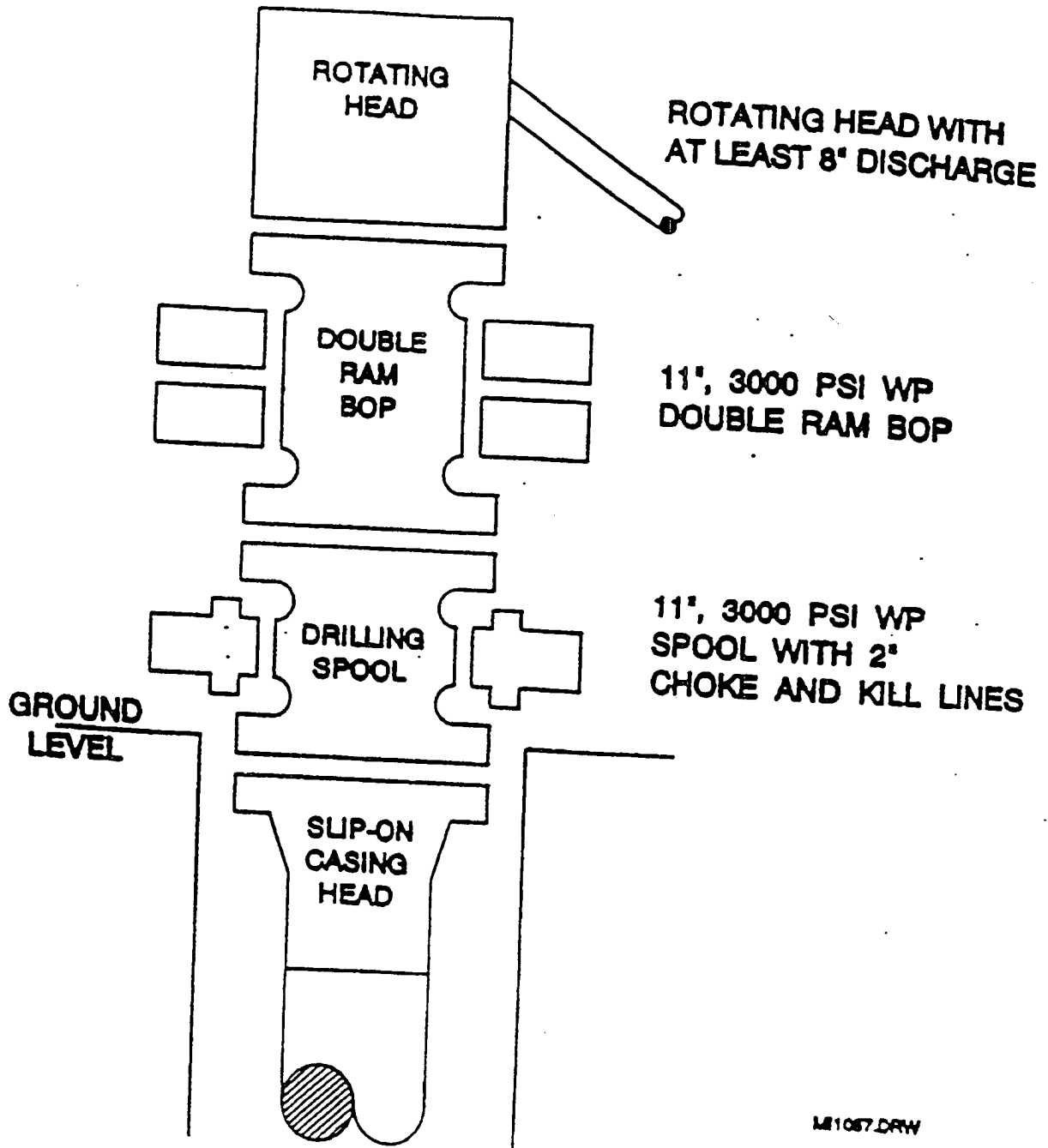

CHOKE MANIFOLD DIAGRAM

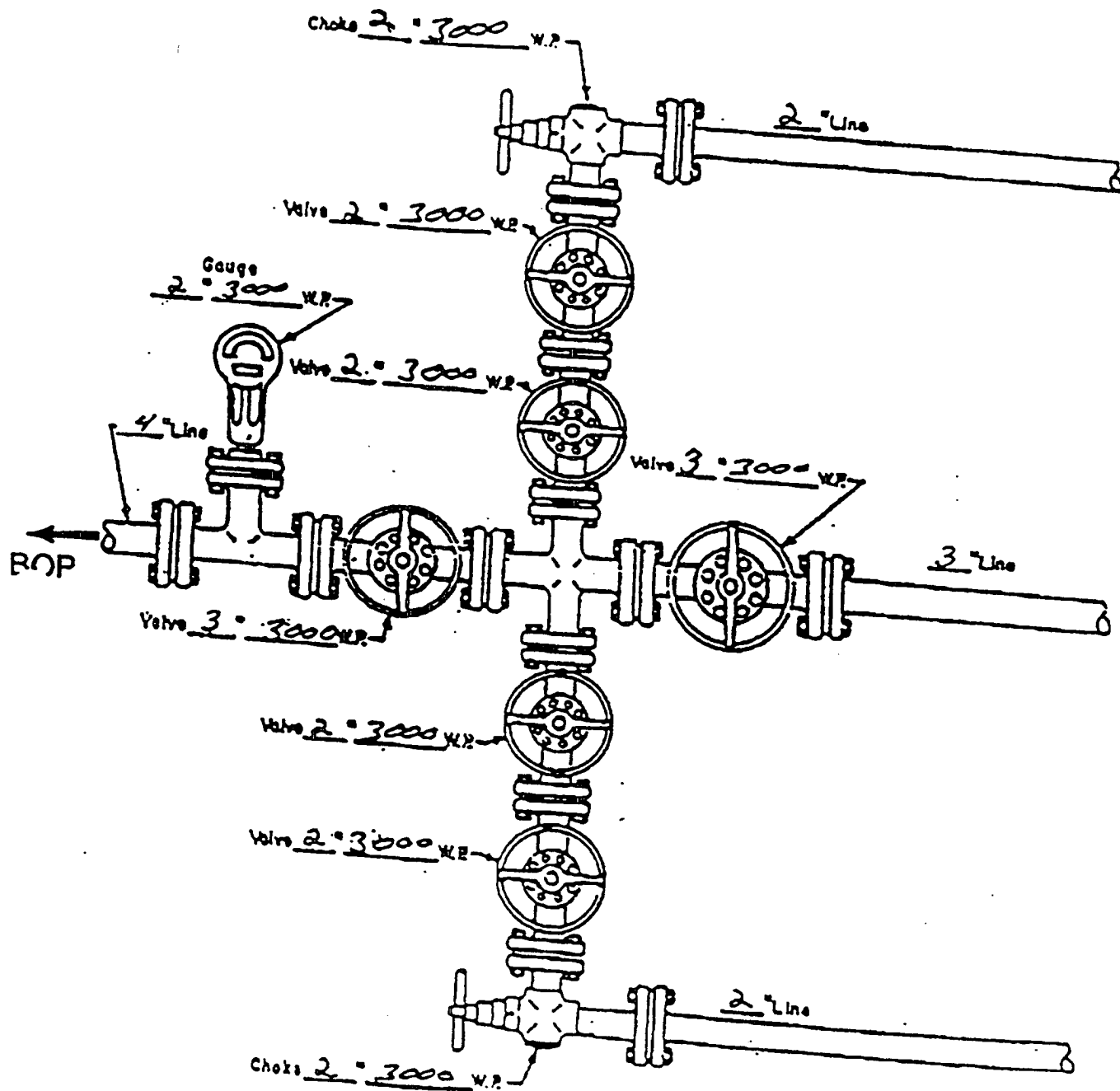

MANIFOLD
3000 W.P.

- Manual
- Hydraulic