

**HOBBS OCD**

**FEB 06 2018**

FORM APPROVED  
OMB No. 1004-0137  
Expires October 31, 2014

UNITED STATES  
DEPARTMENT OF THE INTERIOR  
BUREAU OF LAND MANAGEMENT

**RECEIVED**

**APPLICATION FOR PERMIT TO DRILL OR REENTER**

1a. Type of work: <input checked="" type="checkbox"/> DRILL <input type="checkbox"/> REENTER		5. Lease Serial No. NMNM63763
1b. Type of Well: <input checked="" type="checkbox"/> Oil Well <input type="checkbox"/> Gas Well <input type="checkbox"/> Other <input checked="" type="checkbox"/> Single Zone <input type="checkbox"/> Multiple Zone		6. If Indian, Allottee or Tribe Name
2. Name of Operator MATADOR PRODUCTION COMPANY		7. If Unit or CA Agreement, Name and No.
3a. Address 5400 LBJ Freeway, Suite 1500 Dallas TX 7524	3b. Phone No. (include area code) (972)371-5200	8. Lease Name and Well No. MJ FEDERAL 234H (320706)
4. Location of Well (Report location clearly and in accordance with any State requirements.) At surface NWNE / 169 FNL / 2121 FEL / LAT 32.6524965 / LONG -103.6320904 At proposed prod. zone SESE / 240 FSL / 330 FEL / LAT 32.6390917 / LONG -103.6262974		9. API Well No. 30-025-44478
10. Field and Pool, or Exploratory TONTO / WOLFCAMP (59500)		11. Sec., T. R. M. or Blk. and Survey or Area SEC 33 / T19S / R33E / NMP
14. Distance in miles and direction from nearest town or post office* 21 miles		12. County or Parish LEA
15. Distance from proposed* location to nearest property or lease line, ft. (Also to nearest drig. unit line, if any) 169 feet		13. State NM
16. No. of acres in lease 520	17. Spacing Unit dedicated to this well 160	
18. Distance from proposed location* to nearest well, drilling, completed, 30 feet applied for, on this lease, ft.	19. Proposed Depth 11760 feet / 16663 feet	20. BLM/BIA Bond No. on file FED: NMB001079
21. Elevations (Show whether DF, KDB, RT, GL, etc.) 3664 feet	22. Approximate date work will start* 10/01/2017	23. Estimated duration 90 days

**24. Attachments**

The following, completed in accordance with the requirements of Onshore Oil and Gas Order No.1, must be attached to this form:

- |  |   |
|--|---|
| 1. Well plat certified by a registered surveyor.   | 4. Bond to cover the operations unless covered by an existing bond on file (see Item 20 above). |
| 2. A Drilling Plan.  | 5. Operator certification   |
| 3. A Surface Use Plan (if the location is on National Forest System Lands, the SUPO must be filed with the appropriate Forest Service Office). | 6. Such other site specific information and/or plans as may be required by the BLM.             |

25. Signature (Electronic Submission)	Name (Printed/Typed) Brian Wood / Ph: (505)466-8120	Date 08/17/2017
Title President		
Approved by (Signature) (Electronic Submission)	Name (Printed/Typed) Cody Layton / Ph: (575)234-5959	Date 01/31/2018
Title Supervisor Multiple Resources		

Application approval does not warrant or certify that the applicant holds legal or equitable title to those rights in the subject lease which would entitle the applicant to conduct operations thereon.  
Conditions of approval, if any, are attached.

Title 18 U.S.C. Section 1001 and Title 43 U.S.C. Section 1212, make it a crime for any person knowingly and willfully to make to any department or agency of the United States any false, fictitious or fraudulent statements or representations as to any matter within its jurisdiction.

(Continued on page 2)

\*(Instructions on page 2)

**APPROVED WITH CONDITIONS**  
Approval Date: 01/31/2018

Ka  
02/06/18

\* Double sided

## INSTRUCTIONS

**GENERAL:** This form is designed for submitting proposals to perform certain well operations, as indicated on Federal and Indian lands and leases for action by appropriate Federal agencies, pursuant to applicable Federal laws and regulations. Any necessary special instructions concerning the use of this form and the number of copies to be submitted, particularly with regard to local, area, or regional procedures and practices, either are shown below or will be issued by, or may be obtained from local Federal offices.

**ITEM 1:** If the proposal is to redrill to the same reservoir at a different subsurface location or to a new reservoir, use this form with appropriate notations. Consult applicable Federal regulations concerning subsequent work proposals or reports on the well.

**ITEM 4:** Locations on Federal or Indian land should be described in accordance with Federal requirements. Consult local Federal offices for specific instructions.

**ITEM 14:** Needed only when location of well cannot readily be found by road from the land or lease description. A plat, or plats, separate or on the reverse side, showing the roads to, and the surveyed location of, the well, and any other required information, should be furnished when required by Federal agency offices.

**ITEMS 15 AND 18:** If well is to be, or has been directionally drilled, give distances for subsurface location of hole in any present or objective productive zone.

**ITEM 22:** Consult applicable Federal regulations, or appropriate officials, concerning approval of the proposal before operations are started.

## NOTICES

The Privacy Act of 1974 and regulation in 43 CFR 2.48(d) provide that you be furnished the following information in connection with information required by this application.

**AUTHORITY:** 30 U.S.C. 181 et seq., 25 U.S.C. 396; 43 CFR 3160

**PRINCIPAL PURPOSES:** The information will be used to: (1) process and evaluate your application for a permit to drill a new oil, gas, or service well or to reenter a plugged and abandoned well; and (2) document, for administrative use, information for the management, disposal and use of National Resource Lands and resources including (a) analyzing your proposal to discover and extract the Federal or Indian resources encountered; (b) reviewing procedures and equipment and the projected impact on the land involved; and (c) evaluating the effects of the proposed operation on the surface and subsurface water and other environmental impacts.

**ROUTINE USE:** Information from the record and/or the record will be transferred to appropriate Federal, State, and local or foreign agencies, when relevant to civil, criminal or regulatory investigations or prosecution, in connection with congressional inquiries and for regulatory responsibilities.

**EFFECT OF NOT PROVIDING INFORMATION:** Filing of this application and disclosure of the information is mandatory only if you elect to initiate a drilling or reentry operation on an oil and gas lease.

The Paperwork Reduction Act of 1995 requires us to inform you that:

The BLM collects this information to allow evaluation of the technical, safety, and environmental factors involved with drilling for oil and/or gas on Federal and Indian oil and gas leases. This information will be used to analyze and approve applications. Response to this request is mandatory only if the operator elects to initiate drilling or reentry operations on an oil and gas lease. The BLM would like you to know that you do not have to respond to this or any other Federal agency-sponsored information collection unless it displays a currently valid OMB control number.

**BURDEN HOURS STATEMENT:** Public reporting burden for this form is estimated to average 8 hours per response, including the time for reviewing instructions, gathering and maintaining data, and completing and reviewing the form. Direct comments regarding the burden estimate or any other aspect of this form to U.S. Department of the Interior, Bureau of Land Management (1004-0137), Bureau Information Collection Clearance Officer (WO-630), 1849 C Street, N.W., Mail Stop 401 LS, Washington, D.C. 20240.

## **Additional Operator Remarks**

### **Location of Well**

1. SHL: NWN / 169 FNL / 2121 FEL / TWSP: 19S / RANGE: 33E / SECTION: 33 / LAT: 32.6524965 / LONG: -103.6320904 ( TVD: 0 feet, MD: 0 feet )

PPP: NWN / 169 FNL / 2121 FEL / TWSP: 19S / RANGE: 33E / SECTION: 33 / LAT: 32.6524965 / LONG: -103.6320904 ( TVD: 0 feet, MD: 0 feet )

BHL: SESE / 240 FSL / 330 FEL / TWSP: 19S / RANGE: 33E / SECTION: 23 / LAT: 32.6390917 / LONG: -103.6262974 ( TVD: 11760 feet, MD: 16663 feet )

## **BLM Point of Contact**

Name: Priscilla Perez

Title: Legal Instruments Examiner

Phone: 5752345934

Email: pperez@blm.gov

## **Review and Appeal Rights**

A person contesting a decision shall request a State Director review. This request must be filed within 20 working days of receipt of the Notice with the appropriate State Director (see 43 CFR 3165.3). The State Director review decision may be appealed to the Interior Board of Land Appeals, 801 North Quincy Street, Suite 300, Arlington, VA 22203 (see 43 CFR 3165.4). Contact the above listed Bureau of Land Management office for further information.

---

**Approval Date: 01/31/2018**

(Form 3160-3, page 4)

**HOBBS OCD**U.S. Department of the Interior  
BUREAU OF LAND MANAGEMENT

FEB 06 2018

**Operator Certification Data Report**

02/01/2018

**RECEIVED****Operator Certification**

I hereby certify that I, or someone under my direct supervision, have inspected the drill site and access route proposed herein; that I am familiar with the conditions which currently exist; that I have full knowledge of state and Federal laws applicable to this operation; that the statements made in this APD package are, to the best of my knowledge, true and correct; and that the work associated with the operations proposed herein will be performed in conformity with this APD package and the terms and conditions under which it is approved. I also certify that I, or the company I represent, am responsible for the operations conducted under this application. These statements are subject to the provisions of 18 U.S.C. 1001 for the filing of false statements.

**NAME:** Brian Wood**Signed on:** 08/17/2017**Title:** President**Street Address:** 37 Verano Loop**City:** Santa Fe**State:** NM**Zip:** 87508**Phone:** (505)466-8120**Email address:** afmss@permitswest.com**Field Representative****Representative Name:****Street Address:****City:****State:****Zip:****Phone:****Email address:**



U.S. Department of the Interior  
BUREAU OF LAND MANAGEMENT

## Application Data Report

02/01/2018

APD ID: 10400019888

Submission Date: 08/17/2017

Highlighted data  
reflects the most  
recent changes

Operator Name: MATADOR PRODUCTION COMPANY

Well Name: MJ FEDERAL

Well Number: 234H

[Show Final Text](#)

Well Type: OIL WELL

Well Work Type: Drill

### Section 1 - General

APD ID: 10400019888

Tie to previous NOS?

Submission Date: 08/17/2017

BLM Office: CARLSBAD

User: Brian Wood

Title: President

Federal/Indian APD: FED

Is the first lease penetrated for production Federal or Indian? FED

Lease number: NMNM63763

Lease Acres: 520

Surface access agreement in place?

Allotted?

Reservation:

Agreement in place? NO

Federal or Indian agreement:

Agreement number:

Agreement name:

Keep application confidential? NO

Permitting Agent? YES

APD Operator: MATADOR PRODUCTION COMPANY

Operator letter of designation:

### Operator Info

Operator Organization Name: MATADOR PRODUCTION COMPANY

Operator Address: 5400 LBJ Freeway, Suite 1500

Zip: 75240

Operator PO Box:

Operator City: Dallas

State: TX

Operator Phone: (972)371-5200

Operator Internet Address: amonroe@matadorresources.com

### Section 2 - Well Information

Well in Master Development Plan? NO

Master Development Plan name:

Well in Master SUPO? NO

Master SUPO name:

Well in Master Drilling Plan? NO

Master Drilling Plan name:

Well Name: MJ FEDERAL

Well Number: 234H

Well API Number:

Field/Pool or Exploratory? Field and Pool

Field Name: TONTO

Pool Name: WOLFCAMP

Is the proposed well in an area containing other mineral resources? USEABLE WATER,POTASH

**Operator Name:** MATADOR PRODUCTION COMPANY

**Well Name:** MJ FEDERAL

**Well Number:** 234H

**Describe other minerals:**

**Is the proposed well in a Helium production area?** N **Use Existing Well Pad?** NO **New surface disturbance?**

**Type of Well Pad:** MULTIPLE WELL

**Multiple Well Pad Name:** MJ  
FEDERAL

**Number:** 3-4

**Well Class:** HORIZONTAL

**Number of Legs:** 1

**Well Work Type:** Drill

**Well Type:** OIL WELL

**Describe Well Type:**

**Well sub-Type:** INFILL

**Describe sub-type:**

**Distance to town:** 21 Miles

**Distance to nearest well:** 30 FT

**Distance to lease line:** 169 FT

**Reservoir well spacing assigned acres Measurement:** 160 Acres

**Well plat:** MJ\_234H\_Plat\_08-17-2017.pdf

**Well work start Date:** 10/01/2017

**Duration:** 90 DAYS

### Section 3 - Well Location Table

**Survey Type:** RECTANGULAR

**Describe Survey Type:**

**Datum:** NAD83

**Vertical Datum:** NAVD88

**Survey number:** 18329

	NS-Foot	NS Indicator	EW-Foot	EW Indicator	Twsp	Range	Section	Aliquot/Lot/Tract	Latitude	Longitude	County	State	Meridian	Lease Type	Lease Number	Elevation	MD	TVD
SHL Leg #1	169	FNL	212 1	FEL	19S	33E	33	Aliquot NWNE	32.65249 65	- 103.6320 904	LEA	NEW MEXI CO	NEW MEXI CO	F	NMNM 63763	366 4	0	0
KOP Leg #1	169	FNL	212 1	FEL	19S	33E	33	Aliquot NWNE	32.65249 65	- 103.6320 904	LEA	NEW MEXI CO	NEW MEXI CO	F	NMNM 63763	- 757 0	114 00	112 34
PPP Leg #1	169	FNL	212 1	FEL	19S	33E	33	Aliquot NWNE	32.65249 65	- 103.6320 904	LEA	NEW MEXI CO	NEW MEXI CO	F	NMNM 63763	366 4	0	0

**Operator Name:** MATADOR PRODUCTION COMPANY

**Well Name:** MJ FEDERAL

**Well Number:** 234H

	NS-Foot	NS Indicator	EW-Foot	EW Indicator	Twp	Range	Section	Aliquot/Lot/Tract	Latitude	Longitude	County	State	Meridian	Lease Type	Lease Number	Elevation	MD	TVD
EXIT Leg #1	240	FSL	330	FEL	19S	33E	23	Aliquot SESE	32.63909 17	- 103.6262 974	LEA	NEW MEXI CO	NEW MEXI CO	F	NMNM 63763	- 809 6	166 63	117 60
BHL Leg #1	240	FSL	330	FEL	19S	33E	23	Aliquot SESE	32.63909 17	- 103.6262 974	LEA	NEW MEXI CO	NEW MEXI CO	F	NMNM 63763	- 809 6	166 63	117 60





U.S. Department of the Interior  
BUREAU OF LAND MANAGEMENT

## Drilling Plan Data Report

02/01/2018

APD ID: 10400019888

Submission Date: 08/17/2017

Highlighted data  
reflects the most  
recent changes

Operator Name: MATADOR PRODUCTION COMPANY

Well Name: MJ FEDERAL

Well Number: 234H

[Show Final Text](#)

Well Type: OIL WELL

Well Work Type: Drill

### Section 1 - Geologic Formations

Formation ID	Formation Name	Elevation	True Vertical Depth	Measured Depth	Lithologies	Mineral Resources	Producing Formation
1	---	3662	0	0	OTHER : Quaternary	USEABLE WATER	No
2	RUSTLER ANHYDRITE	2152	1510	1516		NONE	No
3	TOP SALT	2037	1625	1632		NONE	No
4	BASE OF SALT	457	3205	3242		NONE	No
5	YATES	267	3395	3436	GYPSUM	NONE	No
6	QUEEN	-163	3825	3863	SANDSTONE	NONE	No
7	SEVEN RIVERS	-163	3825	3863	DOLOMITE	NONE	No
8	GRAYBURG	-1183	4845	4912	SANDSTONE	NONE	No
9	DELAWARE SAND	-1888	5550	5630		NATURAL GAS,CO2,OIL	No
10	BRUSHY CANYON	-2508	6170	6262	SANDSTONE	NATURAL GAS,CO2,OIL	No
11	BONE SPRING LIME	-4333	7995	8123		NATURAL GAS,CO2,OIL	No
12	BONE SPRING 1ST	-5518	9180	9328	SANDSTONE	NATURAL GAS,CO2,OIL	No
13	BONE SPRING 2ND	-6043	9705	9865	SANDSTONE	NATURAL GAS,CO2,OIL	No
14	BONE SPRING 3RD	-6923	10585	10753	SANDSTONE	NATURAL GAS,CO2,OIL	No
15	WOLFCAMP	-7118	10780	10947	OTHER : Carbonate	NATURAL GAS,CO2,OIL	No
16	WOLFCAMP	-7928	11590	11800	SANDSTONE	NATURAL GAS,CO2,OIL	Yes

### Section 2 - Blowout Prevention

- Power Generation – On lease
  - Operating a generator will only utilize a portion of the produced gas and the remainder of gas would still need to be flared.
  - Power Company has to be willing to purchase gas back and if they are willing they require a 5 year commitment to supply the agreed upon amount of power back to them. With gas decline rates and unpredictability of markets it is impossible to agree to such long term demands. If the demands are not met then operator is burdened with penalty for not delivering.
- Compressed Natural Gas – On lease
  - Compressed Natural Gas is likely to be uneconomic to operate when the gas volume declines.
- NGL Removal – On lease
  - NGL Removal requires a plant and is expensive on such a small scale rendering it uneconomic and still requires residue gas to be flared.

Operator Name: MATADOR PRODUCTION COMPANY

Well Name: MJ FEDERAL

Well Number: 234H

Pressure Rating (PSI): 5M

Rating Depth: 12000

**Equipment:** A 12,000' 5000-psi BOP stack consisting of 3 rams with 2 pipe rams, 1 blind ram, and 1 annular preventer will be used below surface casing to TD. See attached BOP, choke manifold, co-flex hose, and speed head diagrams. An accumulator complying with Onshore Order 2 for the BOP stack pressure rating will be present. Rotating head will be installed as needed.

**Requesting Variance?** YES

**Variance request:** Matador is requesting a variance to use a speed head. Speed head diameter range is 13.375" x 9.625" x 7.625" x 5.5". Matador requests a variance to drill this well using a co-flex line between the BOP and choke manifold. Certification for proposed co-flex hose is attached. Manufacturer does not require the hose to be anchored. If the specific hose is not available, then one of equal or higher rating will be used.

**Testing Procedure:** Pressure tests will be conducted before drilling out from under all casing strings. BOP will be inspected and operated as required in Onshore Order 2. Kelly cock and sub equipped with a full opening valve sized to fit the drill pipe and collars will be available on the rig floor in the open position. A third party company will test the BOPs. After surface casing is set and the BOP is nipped up, then BOP pressure tests will be made to 250 psi low and 2000 psi high. Intermediate 1 pressure tests will be made to 250 psi low and 3000 psi high. Intermediate 2 pressure tests will be made to 250 psi low and 7500 psi high. Annular preventer will be tested to 250 psi low and 2500 psi high on the surface casing, and 250 psi low and 2500 psi high on the intermediate 1 and 2 casing. In the case of running a speed head with landing mandrel for 9.625" and 7" casing, after surface casing is set, BOP test pressures will be 250 psi low and 3000 psi high. Wellhead seals will be tested to 5000 psi once the 9.625" casing has been landed and cemented. BOP will then be lifted to install the C-section of the wellhead. BOP will then be nipped back up and pressure tested to 250 psi low and 7500 psi high. Annular will be tested to 250 psi low and 2500 psi high.

**Choke Diagram Attachment:**

MJ\_234H\_Choke\_20171024080405.pdf

**BOP Diagram Attachment:**

MJ\_234H\_BOP\_08-17-2017.pdf

### Section 3 - Casing

Casing ID	String Type	Hole Size	Csg Size	Condition	Standard	Tapered String	Top Set MD	Bottom Set MD	Top Set TVD	Bottom Set TVD	Top Set MSL	Bottom Set MSL	Calculated casing length MD	Grade	Weight	Joint Type	Collapse SF	Burst SF	Joint SF Type	Joint SF	Body SF Type	Body SF
1	SURFACE	20	13.375	NEW	API	N	0	1535	0	1530	3664		1535	J-55	54.5	OTHER - BTC	1.12 5	1.12 5	DRY	1.8	DRY	1.8
2	INTERMED IATE	8.75	7.625	NEW	API	Y	0	4900	0	4833	3664		4900	P- 110	29.7	OTHER - BTC	1.12 5	1.12 5	DRY	1.8	DRY	1.8
3	INTERMED IATE	12.2 5	9.625	NEW	API	N	0	5000	0	4931	3664		5000	J-55	40	OTHER - BTC	1.12 5	1.12 5	DRY	1.8	DRY	1.8
4	PRODUCTI ON	6.12 5	5.5	NEW	API	Y	0	11203	0	11037	3664		11203	P- 110	20	OTHER - Tenaris XP	1.12 5	1.12 5	DRY	1.8	DRY	1.8
5	INTERMED IATE	8.75	7.625	NEW	API	Y	4900	11303	4833	11137			6403	P- 110	29.7	OTHER - VAM HTF-NR	1.12 5	1.12 5	DRY	1.8	DRY	1.8

**Operator Name:** MATADOR PRODUCTION COMPANY

**Well Name:** MJ FEDERAL

**Well Number:** 234H

Casing ID	String Type	Hole Size	Csg Size	Condition	Standard	Tapered String	Top Set MD	Bottom Set MD	Top Set TVD	Bottom Set TVD	Top Set MSL	Bottom Set MSL	Calculated casing length MD	Grade	Weight	Joint Type	Collapse SF	Burst SF	Joint SF Type	Joint SF	Body SF Type	Body SF
6	INTERMEDIATE	8.75	7.0	NEW	API	Y	11303	12150	11137	11751			847	P-110	29	OTHER - BTC	1.125	1.125	DRY	1.8	DRY	1.8
7	PRODUCTION	6.125	4.5	NEW	API	Y	11203	16663	11037	11760			5460	P-110	13.5	OTHER - Tenaris XP	1.125	1.125	DRY	1.8	DRY	1.8

#### Casing Attachments

**Casing ID:** 1      **String Type:** SURFACE

**Inspection Document:**

**Spec Document:**

**Tapered String Spec:**

**Casing Design Assumptions and Worksheet(s):**

Casing\_Design\_Assumptions\_Surface\_08-17-2017.docx

**Casing ID:** 2      **String Type:** INTERMEDIATE

**Inspection Document:**

**Spec Document:**

**Tapered String Spec:**

Casing\_Design\_Assumptions\_Intermediate\_08-17-2017.docx

**Casing Design Assumptions and Worksheet(s):**

Casing\_Design\_Assumptions\_Intermediate\_08-17-2017.docx

**Operator Name:** MATADOR PRODUCTION COMPANY

**Well Name:** MJ FEDERAL

**Well Number:** 234H

---

**Casing Attachments**

---

**Casing ID:** 3      **String Type:**INTERMEDIATE

**Inspection Document:**

**Spec Document:**

**Tapered String Spec:**

**Casing Design Assumptions and Worksheet(s):**

Casing\_Design\_Assumptions\_Intermediate\_08-17-2017.docx

---

**Casing ID:** 4      **String Type:**PRODUCTION

**Inspection Document:**

**Spec Document:**

**Tapered String Spec:**

5.5\_Inch\_Casing\_Spec\_20171024080433.PDF

**Casing Design Assumptions and Worksheet(s):**

Casing\_Design\_Assumptions\_Production\_08-17-2017.docx

---

**Casing ID:** 5      **String Type:**INTERMEDIATE

**Inspection Document:**

**Spec Document:**

**Tapered String Spec:**

7.625\_Inch\_Casing\_Spec\_20171024080502.PDF

Casing\_Design\_Assumptions\_Intermediate\_08-17-2017.docx

**Casing Design Assumptions and Worksheet(s):**

Casing\_Design\_Assumptions\_Intermediate\_08-17-2017.docx

---

Operator Name: MATADOR PRODUCTION COMPANY

Well Name: MJ FEDERAL

Well Number: 234H

#### Casing Attachments

Casing ID: 6 String Type: INTERMEDIATE

Inspection Document:

Spec Document:

Tapered String Spec:

Casing\_Design\_Assumptions\_Intermediate\_08-17-2017.docx

Casing Design Assumptions and Worksheet(s):

Casing\_Design\_Assumptions\_Intermediate\_08-17-2017.docx

Casing ID: 7 String Type: PRODUCTION

Inspection Document:

Spec Document:

Tapered String Spec:

4.5\_Inch\_Casing\_Spec\_08-17-2017.pdf

Casing Design Assumptions and Worksheet(s):

Casing\_Design\_Assumptions\_Production\_08-17-2017.docx

#### Section 4 - Cement

String Type	Lead/Tail	Stage Tool Depth	Top MD	Bottom MD	Quantity(sx)	Yield	Density	Cu Ft	Excess%	Cement type	Additives
SURFACE	Lead		0	1535	1693	1.75	13.5	2962	100	Class C	3% NaCl + LCM
SURFACE	Tail		0	1535	537	1.38	14.8	741	100	Class C	5% NaCl + LCM
INTERMEDIATE	Lead		0	4900	848	2.36	11.5	2001	35	TXI	Fluid Loss + Dispersant + Retarder + LCM
INTERMEDIATE	Tail		0	4900	223	1.38	13.2	307	35	TXI	Fluid Loss + Dispersant + Retarder + LCM
INTERMEDIATE	Lead		0	5000	1161	1.81	13.5	2101	100	Class C	Bentonite + 1% CaCl2 + 8% NaCl + LCM

Operator Name: MATADOR PRODUCTION COMPANY

Well Name: MJ FEDERAL

Well Number: 234H

String Type	Lead/Tail	Stage Tool Depth	Top MD	Bottom MD	Quantity(sx)	Yield	Density	Cu Ft	Excess%	Cement type	Additives
INTERMEDIATE	Tail		0	5000	454	1.38	14.8	626	100	Class C	5% NaCl + LCM
PRODUCTION	Lead		0	1120 3	414	1.38	15.8	571	10	Class H	Fluid Loss + Dispersant + Retarder + LCM
PRODUCTION	Tail		0	1120 3	414	1.38	15.8	571	10	Class H	Fluid Loss + Dispersant + Retarder + LCM
INTERMEDIATE	Lead		4900	1130 3	848	2.36	11.5	2001	35	TXI	Fluid Loss + Dispersant + Retarder + LCM
INTERMEDIATE	Tail		4900	1130 3	223	1.38	13.2	307	35	TXI	Fluid Loss + Dispersant + Retarder + LCM
INTERMEDIATE	Lead		1130 3	1215 0	848	2.36	11.5	2001	35	TXI	Fluid Loss + Dispersant + Retarder + LCM
INTERMEDIATE	Tail		1130 3	1215 0	223	1.38	13.2	307	35	TXI	Fluid Loss + Dispersant + Retarder + LCM
PRODUCTION	Lead		1120 3	1666 3	414	1.38	15.8	571	10	Class H	Fluid Loss + Dispersant + Retarder + LCM
PRODUCTION	Tail		1120 3	1663	414	1.38	15.8	571	10	Class H	Fluid Loss + Dispersant + Retarder + LCM

## Section 5 - Circulating Medium

Mud System Type: Closed

Will an air or gas system be Used? NO

Description of the equipment for the circulating system in accordance with Onshore Order #2:

Diagram of the equipment for the circulating system in accordance with Onshore Order #2:

Describe what will be on location to control well or mitigate other conditions: All necessary mud products (barite, bentonite, LCM) for weight addition and fluid loss control will be on location at all times.

Describe the mud monitoring system utilized: An electronic Parson mud monitoring system complying with Onshore Order 1 will be used.

## Circulating Medium Table

Top Depth	Bottom Depth	Mud Type	Min Weight (lbs/gal)	Max Weight (lbs/gal)	Density (lbs/cu ft)	Gel Strength (lbs/100 sqft)	PH	Viscosity (CP)	Salinity (ppm)	Filtration (cc)	Additional Characteristics
-----------	--------------	----------	----------------------	----------------------	---------------------	-----------------------------	----	----------------	----------------	-----------------	----------------------------

**Operator Name:** MATADOR PRODUCTION COMPANY

**Well Name:** MJ FEDERAL

**Well Number:** 234H

Top Depth	Bottom Depth	Mud Type	Min Weight (lbs/gal)	Max Weight (lbs/gal)	Density (lbs/cu ft)	Gel Strength (lbs/100 sqft)	PH	Viscosity (CP)	Salinity (ppm)	Filtration (cc)	Additional Characteristics
0	1535	OTHER : Fresh water	8.3	8.3							
1535	5000	SALT SATURATED	10	10							
5000	12150	OTHER : Fresh water & cut brine	9	9							
12150	16051	OIL-BASED MUD	12.5	12.5							

### Section 6 - Test, Logging, Coring

**List of production tests including testing procedures, equipment and safety measures:**

A 2-person mud logging program will be used from 1515' to TD.

No electric log is planned at this time. GR will be collected through the MWD tools from intermediate casing to TD. CBL with CCL will be run as far as gravity will let it fall to TOC.

**List of open and cased hole logs run in the well:**

CBL,GR

**Coring operation description for the well:**

No core or drill stem test is planned.

### Section 7 - Pressure

**Anticipated Bottom Hole Pressure:** 8232

**Anticipated Surface Pressure:** 5644.8

**Anticipated Bottom Hole Temperature(F):** 180

**Anticipated abnormal pressures, temperatures, or potential geologic hazards?** NO

**Describe:**

**Contingency Plans geohazards description:**

**Contingency Plans geohazards attachment:**

**Hydrogen Sulfide drilling operations plan required?** YES

**Hydrogen sulfide drilling operations plan:**



**Operator Name:** MATADOR PRODUCTION COMPANY

**Well Name:** MJ FEDERAL

**Well Number:** 234H

MJ\_234H\_H2S\_Plan\_20171024080534.pdf

## **Section 8 - Other Information**

**Proposed horizontal/directional/multi-lateral plan submission:**

MJ\_234H\_Horizontal\_Drill\_Plan\_08-17-2017.pdf

**Other proposed operations facets description:**

**Other proposed operations facets attachment:**

MJ\_234H\_General\_Drill\_Plan\_08-17-2017.pdf

MJ\_234H\_Speedhead\_Specs\_20171024080551.pdf

**Other Variance attachment:**

MJ\_234H\_DV\_Tool\_Variance\_Request\_20171024080601.pdf

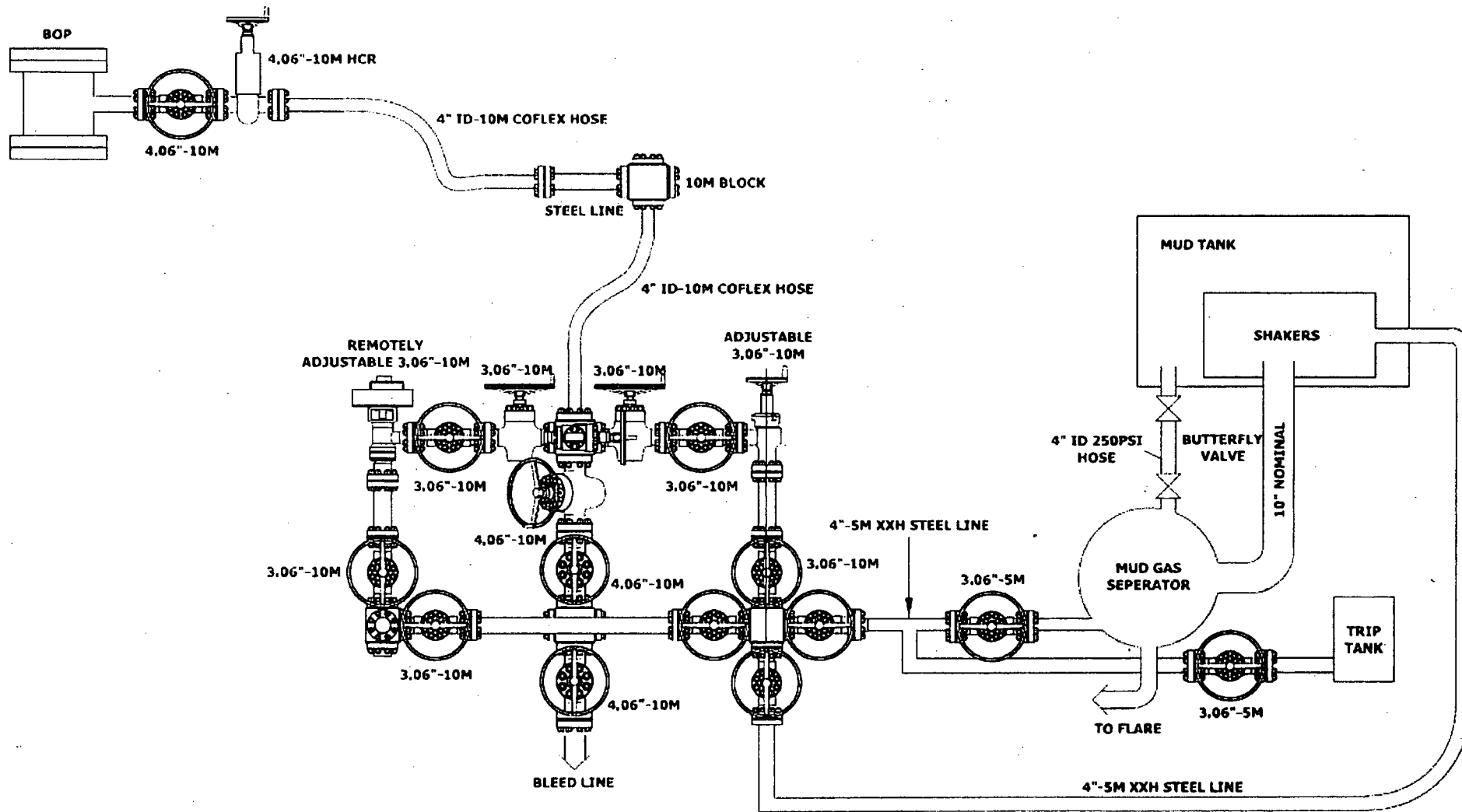

GENERAL NOTES & TO BE OBSERVED BY THE USER				PATTERSON-UTI			
<p>GENERAL WARNING NOTES:</p> <p>ALL ACCESSIBLE CONTACT SURFACES SHALL BE JOINTED WITH CONTINUOUS COINTEGRITY TO THE JOINT SURFACES TO BE JOINTED. THE JOINT SURFACES SHALL BE JOINTED TO THE JOINT SURFACES TO BE JOINTED. THE JOINT SURFACES SHALL BE JOINTED TO THE JOINT SURFACES TO BE JOINTED.</p>				<p>DRILLING COMPANY LLC</p> <p>CONFIDENTIAL AND PROPRIETARY</p> <p>NOT TO BE DISTRIBUTED</p>			
<p>MAINTENANCE NOTES:</p> <p>ALL ACCESSIBLE CONTACT SURFACES SHALL BE JOINTED WITH CONTINUOUS COINTEGRITY TO THE JOINT SURFACES TO BE JOINTED. THE JOINT SURFACES SHALL BE JOINTED TO THE JOINT SURFACES TO BE JOINTED.</p>				<p>CHOKE MANIFOLD</p> <p>10M CHOKE ARRANGEMENT</p> <p>RIG 237</p>			
<p>DATE</p> <p>DESCRIPTION</p>				<p>DATE</p> <p>DESCRIPTION</p>			
<p>DATE</p> <p>DESCRIPTION</p>				<p>DATE</p> <p>DESCRIPTION</p>			



U.S. Department of the Interior  
BUREAU OF LAND MANAGEMENT

## SUPO Data Report

02/01/2018

APD ID: 10400019888

Submission Date: 08/17/2017

Highlighted data  
reflects the most  
recent changes

Operator Name: MATADOR PRODUCTION COMPANY

Well Name: MJ FEDERAL

Well Number: 234H

[Show Final Text](#)

Well Type: OIL WELL

Well Work Type: Drill

### Section 1 - Existing Roads

Will existing roads be used? YES

Existing Road Map:

MJ\_234H\_Road\_Map\_08-17-2017.pdf

Existing Road Purpose: ACCESS

Row(s) Exist? NO

ROW ID(s)

ID:

Do the existing roads need to be improved? NO

Existing Road Improvement Description:

Existing Road Improvement Attachment:

### Section 2 - New or Reconstructed Access Roads

Will new roads be needed? YES

New Road Map:

MJ\_234H\_New\_Road\_Map\_08-17-2017.pdf

New road type: LOCAL

Length: 553 Feet Width (ft.): 30

Max slope (%): 0 Max grade (%): 1

Army Corp of Engineers (ACOE) permit required? NO

ACOE Permit Number(s):

New road travel width: 14

New road access erosion control: Crown and ditch; caliche surface

New road access plan or profile prepared? NO

New road access plan attachment:

Access road engineering design? NO

Access road engineering design attachment:

Matador requests the option to run a DV tool with annular packer as contingency in the intermediate 1 section on 9-5/8" casing if lost circulation is encountered. If losses occur the DV tool with packer will be placed at least 100' above loss zone to give the option to pump cement as either a single stage or two stage.

**Matador DV Tool Specifications**

Example:

Assuming DV tool set at 4500' MD but if the setting depth changes, cement volumes will be adjusted proportionately.

Stage 1:

Lead	1262	1.81	13.5	Class C + Bentonite + 1% CaCL <sub>2</sub> + 8% NaCl + LCM
Tail	490	1.38	14.8	Class C + 5% NaCl + LCM
100% excess, TOC = 0' MD				

Stage 2:

Lead	1324	1.81	13.5	Class C + Bentonite + 1% CaCL <sub>2</sub> + 8% NaCl + LCM
100% excess, TOC = 0' MD				

**Operator Name:** MATADOR PRODUCTION COMPANY

**Well Name:** MJ FEDERAL

**Well Number:** 234H

**Access surfacing type:** OTHER

**Access topsoil source:** ONSITE

**Access surfacing type description:** Caliche

**Access onsite topsoil source depth:** 6

**Offsite topsoil source description:**

**Onsite topsoil removal process:** Grader

**Access other construction information:**

**Access miscellaneous information:**

**Number of access turnouts:**

**Access turnout map:**

### **Drainage Control**

**New road drainage crossing:** OTHER

**Drainage Control comments:** Crown and ditch

**Road Drainage Control Structures (DCS) description:** None

**Road Drainage Control Structures (DCS) attachment:**

### **Access Additional Attachments**

**Additional Attachment(s):**

## **Section 3 - Location of Existing Wells**

**Existing Wells Map?** YES

**Attach Well map:**

MJ\_234H\_Well\_Map\_08-17-2017.pdf

**Existing Wells description:**

## **Section 4 - Location of Existing and/or Proposed Production Facilities**

**Submit or defer a Proposed Production Facilities plan?** SUBMIT

**Production Facilities description:**

**Production Facilities map:**

MJ\_234H\_Production\_Diagram\_20171024080626.pdf

## **Section 5 - Location and Types of Water Supply**

### **Water Source Table**

**Operator Name:** MATADOR PRODUCTION COMPANY

**Well Name:** MJ FEDERAL

**Well Number:** 234H

**Water source use type:** DUST CONTROL,  
INTERMEDIATE/PRODUCTION CASING, STIMULATION, SURFACE  
CASING

**Water source type:** GW WELL

**Describe type:**

**Source longitude:**

**Source latitude:**

**Source datum:**

**Water source permit type:** PRIVATE CONTRACT

**Source land ownership:** PRIVATE

**Water source transport method:** TRUCKING

**Source transportation land ownership:** PRIVATE

**Water source volume (barrels):** 20000

**Source volume (acre-feet):** 2.577862

**Source volume (gal):** 840000

**Water source and transportation map:**

MJ\_234H\_Water\_Source\_Map\_08-17-2017.pdf

**Water source comments:**

**New water well?** NO

### **New Water Well Info**

**Well latitude:**

**Well Longitude:**

**Well datum:**

**Well target aquifer:**

**Est. depth to top of aquifer(ft):**

**Est thickness of aquifer:**

**Aquifer comments:**

**Aquifer documentation:**

**Well depth (ft):**

**Well casing type:**

**Well casing outside diameter (in.):**

**Well casing inside diameter (in.):**

**New water well casing?**

**Used casing source:**

**Drilling method:**

**Drill material:**

**Grout material:**

**Grout depth:**

**Casing length (ft.):**

**Casing top depth (ft.):**

**Well Production type:**

**Completion Method:**

**Water well additional information:**

**State appropriation permit:**

**Additional information attachment:**

**Operator Name:** MATADOR PRODUCTION COMPANY

**Well Name:** MJ FEDERAL

**Well Number:** 234H

## Section 6 - Construction Materials

**Construction Materials description:** NM One Call (811) will be notified before construction starts. A fence will be built east of the pad to protect dunes (wildlife habitat). Top 6" of soil and brush will be stockpiled north of the pad. V-door will face north. Closed loop drilling system will be used. Caliche will be hauled from existing caliche pits on private land. Caviness pit is in SWNE 9-18s-33e. Berry pit is in SENE 35-20s-34e.

**Construction Materials source location attachment:**

## Section 7 - Methods for Handling Waste

**Waste type:** DRILLING

**Waste content description:** Cuttings and mud

**Amount of waste:** 2000 barrels

**Waste disposal frequency :** Daily

**Safe containment description:** Steel tanks

**Safe containmant attachment:**

**Waste disposal type:** HAUL TO COMMERCIAL FACILITY **Disposal location ownership:** PRIVATE

**Disposal type description:**

**Disposal location description:** Halfway NM

## Reserve Pit

**Reserve Pit being used?** NO

**Temporary disposal of produced water into reserve pit?**

**Reserve pit length (ft.)** **Reserve pit width (ft.)**

**Reserve pit depth (ft.)** **Reserve pit volume (cu. yd.)**

**Is at least 50% of the reserve pit in cut?**

**Reserve pit liner**

**Reserve pit liner specifications and installation description**

## Cuttings Area

**Cuttings Area being used?** NO

**Are you storing cuttings on location?** YES

**Description of cuttings location** Steel tanks

**Cuttings area length (ft.)**

**Cuttings area width (ft.)**

**Cuttings area depth (ft.)**

**Cuttings area volume (cu. yd.)**

**Operator Name:** MATADOR PRODUCTION COMPANY

**Well Name:** MJ FEDERAL

**Well Number:** 234H

**Is at least 50% of the cuttings area in cut?**

**WCuttings area liner**

**Cuttings area liner specifications and installation description**

## **Section 8 - Ancillary Facilities**

**Are you requesting any Ancillary Facilities?:** NO

**Ancillary Facilities attachment:**

**Comments:**

## **Section 9 - Well Site Layout**

**Well Site Layout Diagram:**

MJ\_234H\_Well\_Site\_Layout\_20171024080715.pdf

**Comments:**

## **Section 10 - Plans for Surface Reclamation**

**Type of disturbance:** New Surface Disturbance

**Multiple Well Pad Name:** MJ FEDERAL

**Multiple Well Pad Number:** 3-4

**Recontouring attachment:**

MJ\_234H\_Recontour\_Plat\_08-17-2017.pdf

MJ\_234H\_Interim\_Reclamation\_Diagram\_20171024080734.pdf

**Drainage/Erosion control construction:** Crown and ditch

**Drainage/Erosion control reclamation:** Harrow with contour and reseed

**Wellpad long term disturbance (acres):** 3.25

**Wellpad short term disturbance (acres):** 3.65

**Access road long term disturbance (acres):** 0.38

**Access road short term disturbance (acres):** 0.38

**Pipeline long term disturbance (acres):** 0

**Pipeline short term disturbance (acres):** 0

**Other long term disturbance (acres):** 0

**Other short term disturbance (acres):** 0

**Total long term disturbance:** 3.63

**Total short term disturbance:** 4.03

**Reconstruction method:** Interim reclamation will be completed within 6 months of completing the well. Interim reclamation will consist of shrinking the pad 11% (0.40 acre) by removing caliche and reclaiming the northwest corner (130' x 270' x 300'). This will leave 3.25 acres for the production equipment (e. g., tank battery, heater-treaters, CBU), 5 pump jacks, and tractor-trailer turn around. Disturbed areas will be contoured to match pre-construction grades. Soil and brush will be evenly spread over disturbed areas and harrowed on the contour. Disturbed areas will be seeded in accordance with the surface owner's requirements.



**Operator Name:** MATADOR PRODUCTION COMPANY

**Well Name:** MJ FEDERAL

**Well Number:** 234H

**Topsoil redistribution:** Enough stockpiled topsoil will be retained to cover the remainder of the pad when the well is plugged. Once the well is plugged, then the rest of the pad and 553' of new road will be similarly reclaimed within 6 months of plugging

**Soil treatment:** None

**Existing Vegetation at the well pad:**

**Existing Vegetation at the well pad attachment:**

**Existing Vegetation Community at the road:**

**Existing Vegetation Community at the road attachment:**

**Existing Vegetation Community at the pipeline:**

**Existing Vegetation Community at the pipeline attachment:**

**Existing Vegetation Community at other disturbances:**

**Existing Vegetation Community at other disturbances attachment:**

**Non native seed used?** NO

**Non native seed description:**

**Seedling transplant description:**

**Will seedlings be transplanted for this project?**

**Seedling transplant description attachment:**

**Will seed be harvested for use in site reclamation?**

**Seed harvest description:**

**Seed harvest description attachment:**

## **Seed Management**

### **Seed Table**

**Seed type:**

**Seed source:**

**Seed name:**

**Source name:**

**Source address:**

**Source phone:**

**Seed cultivar:**

**Seed use location:**

**PLS pounds per acre:**

**Proposed seeding season:**

**Operator Name:** MATADOR PRODUCTION COMPANY

**Well Name:** MJ FEDERAL

**Well Number:** 234H

**Seed Summary**

**Total pounds/Acre:**

**Seed Type**

**Pounds/Acre**

**Seed reclamation attachment:**

**Operator Contact/Responsible Official Contact Info**

**First Name:**

**Last Name:**

**Phone:**

**Email:**

**Seedbed prep:**

**Seed BMP:**

**Seed method:**

**Existing invasive species?** NO

**Existing invasive species treatment description:**

**Existing invasive species treatment attachment:**

**Weed treatment plan description:** To BLM standards

**Weed treatment plan attachment:**

**Monitoring plan description:** To BLM standards

**Monitoring plan attachment:**

**Success standards:** To BLM satisfaction

**Pit closure description:** No pit

**Pit closure attachment:**

**Section 11 - Surface Ownership**

**Disturbance type:** NEW ACCESS ROAD

**Describe:**

**Surface Owner:** BUREAU OF LAND MANAGEMENT

**Other surface owner description:**

**BIA Local Office:**

**BOR Local Office:**

**COE Local Office:**

**DOD Local Office:**

**NPS Local Office:**

**State Local Office:**

**Operator Name:** MATADOR PRODUCTION COMPANY

**Well Name:** MJ FEDERAL

**Well Number:** 234H

**Military Local Office:**

**USFWS Local Office:**

**Other Local Office:**

**USFS Region:**

**USFS Forest/Grassland:**

**USFS Ranger District:**

**Disturbance type:** WELL PAD

**Describe:**

**Surface Owner:** BUREAU OF LAND MANAGEMENT

**Other surface owner description:**

**BIA Local Office:**

**BOR Local Office:**

**COE Local Office:**

**DOD Local Office:**

**NPS Local Office:**

**State Local Office:**

**Military Local Office:**

**USFWS Local Office:**

**Other Local Office:**

**USFS Region:**

**USFS Forest/Grassland:**

**USFS Ranger District:**

## Section 12 - Other Information

**Right of Way needed?** NO

**Use APD as ROW?**

**ROW Type(s):**

**ROW Applications**

**Operator Name:** MATADOR PRODUCTION COMPANY

**Well Name:** MJ FEDERAL

**Well Number:** 234H

**SUPO Additional Information:**

**Use a previously conducted onsite?** YES

**Previous Onsite information:** On site inspection was held with Vance Wolf (BLM) on April 20, 2017. Lone Mountain will inspect and file an archaeology report.

**Other SUPO Attachment**

MJ\_234H\_General\_SUPO\_20171024080757.pdf

### **Section 3 - Unlined Pits**

Would you like to utilize Unlined Pit PWD options? NO

Produced Water Disposal (PWD) Location:

PWD surface owner:

PWD disturbance (acres):

Unlined pit PWD on or off channel:

Unlined pit PWD discharge volume (bbl/day):

Unlined pit specifications:

Precipitated solids disposal:

Describe precipitated solids disposal:

Precipitated solids disposal permit:

Unlined pit precipitated solids disposal schedule:

Unlined pit precipitated solids disposal schedule attachment:

Unlined pit reclamation description:

Unlined pit reclamation attachment:

Unlined pit Monitor description:

Unlined pit Monitor attachment:

Do you propose to put the produced water to beneficial use?

Beneficial use user confirmation:

Estimated depth of the shallowest aquifer (feet):

Does the produced water have an annual average Total Dissolved Solids (TDS) concentration equal to or less than that of the existing water to be protected?

TDS lab results:

Geologic and hydrologic evidence:

State authorization:

Unlined Produced Water Pit Estimated percolation:

Unlined pit: do you have a reclamation bond for the pit?

Is the reclamation bond a rider under the BLM bond?

Unlined pit bond number:

Unlined pit bond amount:

Additional bond information attachment:

### **Section 4 - Injection**

Would you like to utilize Injection PWD options? NO

Produced Water Disposal (PWD) Location:

PWD surface owner:

PWD disturbance (acres):

Injection PWD discharge volume (bbl/day):

Injection well mineral owner:

**Injection well type:**

**Injection well number:**

**Injection well name:**

**Assigned injection well API number?**

**Injection well API number:**

**Injection well new surface disturbance (acres):**

**Minerals protection information:**

**Mineral protection attachment:**

**Underground Injection Control (UIC) Permit?**

**UIC Permit attachment:**

## **Section 5 - Surface Discharge**

**Would you like to utilize Surface Discharge PWD options? NO**

**Produced Water Disposal (PWD) Location:**

**PWD surface owner:**

**PWD disturbance (acres):**

**Surface discharge PWD discharge volume (bbl/day):**

**Surface Discharge NPDES Permit?**

**Surface Discharge NPDES Permit attachment:**

**Surface Discharge site facilities information:**

**Surface discharge site facilities map:**

## **Section 6 - Other**

**Would you like to utilize Other PWD options? NO**

**Produced Water Disposal (PWD) Location:**

**PWD surface owner:**

**PWD disturbance (acres):**

**Other PWD discharge volume (bbl/day):**

**Other PWD type description:**

**Other PWD type attachment:**

**Have other regulatory requirements been met?**

**Other regulatory requirements attachment:**



U.S. Department of the Interior  
BUREAU OF LAND MANAGEMENT

## Bond Info Data Report

02/01/2018

### Bond Information

Federal/Indian APD: FED

BLM Bond number: NMB001079

BIA Bond number:

Do you have a reclamation bond? NO

Is the reclamation bond a rider under the BLM bond?

Is the reclamation bond BLM or Forest Service?

BLM reclamation bond number:

Forest Service reclamation bond number:

Forest Service reclamation bond attachment:

Reclamation bond number:

Reclamation bond amount:

Reclamation bond rider amount:

Additional reclamation bond information attachment:

Issued on: 12 Janv. 2017 by T. DELBOSCO

VRCC 16-1177 Rev02 for Houston Field Service

**DATA ARE INFORMATIVE ONLY.  
BASED ON SI\_PD-101836 P&B**

**VAM® HTF-NR**  
Connection Data Sheet

OD	Weight	Wall Th.	Grade	API Drift	Connection
7 5/8 in.	29.70 lb/ft	0.375 in.	P110 EC	6.750 in.	VAM® HTF NR

PIPE PROPERTIES	
Nominal OD	7.625 in.
Nominal ID	6.875 in.
Nominal Cross Section Area	8.541 sqin.
Grade Type	Enhanced API
Min. Yield Strength	125 ksi
Max. Yield Strength	140 ksi
Min. Ultimate Tensile Strength	135 ksi
Tensile Yield Strength	1 068 klb
Internal Yield Pressure	10 760 psi
Collapse pressure	7 360 psi

CONNECTION PROPERTIES	
Connection Type	Premium Integral Flush
Connection OD (nom)	7.701 in.
Connection ID (nom)	6.782 in.
Make-Up Loss	4.657 in.
Critical Cross Section	4.971 sqin.
Tension Efficiency	58 % of pipe
Compression Efficiency	72.7 % of pipe
Compression Efficiency with Sealability	34.8 % of pipe
Internal Pressure Efficiency	100 % of pipe
External Pressure Efficiency	100 % of pipe

CONNECTION PERFORMANCES	
Tensile Yield Strength	619 klb
Compression Resistance	778 klb
Compression with Sealability	372 klb
Internal Yield Pressure	10 760 psi
External Pressure Resistance	7 360 psi
Max. Bending	44 °/100ft
Max. Bending with Sealability	17 °/100ft

TORQUE VALUES	
Min. Make-up torque	9 600 ft.lb
Opti. Make-up torque	11 300 ft.lb
Max. Make-up torque	13 000 ft.lb
Max. Torque with Sealability	58 500 ft.lb
Max. Torsional Value	73 000 ft.lb

VAM® HTF™ (High Torque Flush) is a flush OD integral connection providing maximum clearance along with torque strength for challenging applications such as extended reach and slim hole wells, drilling liner / casing, liner rotation to achieve better cementation in highly deviated and critical High Pressure / High Temperature wells.

Looking ahead on the outcoming testing industry standards, VAM® decided to create an upgraded design and launch on the market the VAM® HTF-NR as the new standard version of VAM® extreme high torque flush connection. The VAM® HTF-NR has extensive tests as per API RP 5C5:2015 CAL II which include the gas sealability having load points with bending, internal pressure and high temperature at 135°C.

**Do you need help on this product? - Remember no one knows VAM® like VAM®**

canada@vamfieldservice.com  
usa@vamfieldservice.com  
mexico@vamfieldservice.com  
brazil@vamfieldservice.com

uk@vamfieldservice.com  
dubai@vamfieldservice.com  
nigeria@vamfieldservice.com  
angola@vamfieldservice.com

china@vamfieldservice.com  
baku@vamfieldservice.com  
singapore@vamfieldservice.com  
australia@vamfieldservice.com

**Over 180 VAM® Specialists available worldwide 24/7 for Rig Site Assistance**

Other Connection Data Sheets are available at [www.vamservices.com](http://www.vamservices.com)

**Vallourec Group**

**vallourec**



For the latest performance data, always visit our website: [www.tenaris.com](http://www.tenaris.com)

July 15 2015



**Connection:** TenarisXP™ BTC  
**Casing/Tubing:** CAS  
**Coupling Option:** REGULAR

**Size:** 5.500 in.  
**Wall:** 0.361 in.  
**Weight:** 20.00 lbs/ft  
**Grade:** P110-IC  
**Min. Wall Thickness:** 87.5 %

PIPE BODY DATA					
GEOMETRY					
Nominal OD	5.500 in.	Nominal Weight	20.00 lbs/ft	Standard Drift Diameter	4.653 in.
Nominal ID	4.778 in.	Wall Thickness	0.361 in.	Special Drift Diameter	N/A
Plain End Weight	19.83 lbs/ft				
PERFORMANCE					
Body Yield Strength	641 x 1000 lbs	Internal Yield	12630 psi	SMYS	110000 psi
Collapse	12100 psi				
TENARISXP™ BTC CONNECTION DATA					
GEOMETRY					
Connection OD	6.100 in.	Coupling Length	9.450 in.	Connection ID	4.766 in.
Critical Section Area	5.828 sq. in.	Threads per in.	5.00	Make-Up Loss	4.204 in.
PERFORMANCE					
Tension Efficiency	100 %	Joint Yield Strength	641 x 1000 lbs	Internal Pressure Capacity <sup>(1)</sup>	12630 psi
Structural Compression Efficiency	100 %	Structural Compression Strength	641 x 1000 lbs	Structural Bending <sup>(2)</sup>	92 °/100 ft
External Pressure Capacity	12100 psi				
ESTIMATED MAKE-UP TORQUES <sup>(3)</sup>					
Minimum	11270 ft-lbs	Optimum	12520 ft-lbs	Maximum	13770 ft-lbs
OPERATIONAL LIMIT TORQUES					
Operating Torque	21500 ft-lbs	Yield Torque	23900 ft-lbs		

---

**BLANKING DIMENSIONS**

---

Blanking Dimensions

---

**(1)** Internal Pressure Capacity related to structural resistance only. Internal pressure leak resistance as per section 10.3 API 5C3 / ISO 10400 - 2007.

**(2)** Structural rating, pure bending to yield (i.e no other loads applied)

**(3)** Torque values calculated for API Modified thread compounds with Friction Factor=1. For other thread compounds please contact us at [licensees@oilfield.tenaris.com](mailto:licensees@oilfield.tenaris.com). Torque values may be further reviewed.

For additional information, please contact us at [contact-tenarishydril@tenaris.com](mailto:contact-tenarishydril@tenaris.com)

For the latest performance data, always visit our website: [www.tenaris.com](http://www.tenaris.com)

December 31 2015



Connection: TenarisXP® BTC  
Casing/Tubing: CAS  
Coupling Option: REGULAR

Size: 4.500 in.  
Wall: 0.290 in.  
Weight: 13.50 lbs/ft  
Grade: P110-ICY  
Min. Wall Thickness: 87.5 %

Nominal OD	4.500 in.	Nominal Weight	13.50 lbs/ft	Standard Drift Diameter	3.795 in.
Nominal ID	3.920 in.	Wall Thickness	0.290 in.	Special Drift Diameter	N/A
Plain End Weight	13.05 lbs/ft				
Body Yield Strength	479 x 1000 lbs	Internal Yield	14100 psi	SMYS	125000 psi
Collapse	11620 psi				
Connection OD	5.000 in.	Coupling Length	9.075 in.	Connection ID	3.908 in.
Critical Section Area	3.836 sq. in.	Threads per in.	5.00	Make-Up Loss	4.016 in.
Tension Efficiency	100 %	Joint Yield Strength	479 x 1000 lbs	Internal Pressure Capacity <sup>(1)</sup>	14100 psi
Structural Compression Efficiency	100 %	Structural Compression Strength	479 x 1000 lbs	Structural Bending <sup>(2)</sup>	127 °/100 ft
External Pressure Capacity	11620 psi				
Minimum	6950 ft-lbs	Optimum	7720 ft-lbs	Maximum	8490 ft-lbs
Operating Torque	10500 ft-lbs	Yield Torque	12200 ft-lbs		
Blanking Dimensions					

## **Casing Design Criteria and Load Case Assumptions**

### **Intermediate #1 Casing**

Collapse:  $DF_c=1.125$

- Full Internal Evacuation: Collapse force equal to the mud gradient in which the casing will be run (0.52 psi/ft). The effects of axial load on collapse will be considered.
- Cementing: Collapse force equal to the gradient of planned cement slurries to planned depths and an internal force equal to mud gradient of displacement fluid (0.43 psi/ft).

Burst:  $DF_b=1.125$

- Pressure Test: Casing test per Onshore Oil and Gas Order No. 2 with an external force equal to the mud gradient in which the casing will be run (0.52 psi/ft), which is a more conservative backup force than pore pressure.
- Gas Kick Profile: Internal burst force at the shoe will be Fracture Pressure at that depth. Surface burst pressure will be fracture gradient at setting depth less a gas gradient to equivalent height of 50 bbl kick with Drill Pipe inside casing and mud gradient with which the next hole section will be run above that (0.47 psi/ft). External force will be equal to the mud gradient in which the casing will be run (0.52 psi/ft), which is a more conservative backup force than pore pressure.
- Fracture at Shoe with 1/3 BHP at Surface: Internal burst force at the shoe will be Fracture Pressure at setting depth. Internal burst force at surface will be 1/3 of pore pressure at setting depth. External force will be equal to the mud gradient in which the casing will be run (0.52 psi/ft) which is a more conservative backup force than pore pressure.

Tensile:  $DF_t=1.8$

- Overpull: A downward force of 100,000 lbs is applied at the shoe along with the weight of the casing string utilizing the effects of buoyancy (10.0 ppg).

### **Intermediate #2 Casing**

Collapse:  $DF_c=1.125$

- Partial Internal Evacuation: Collapse force equal to the mud gradient in which the casing will be run (0.47 psi/ft). The effects of axial load on collapse will be considered. Internal force equal to gas gradient over half of setting depth and mud gradient with which the next hole section will be run below that (0.65 psi/ft).
- Cementing: Collapse force equal to the gradient of planned cement slurries to planned depths and mud gradient in which the casing will be run above that (0.47 psi/ft) and an internal force equal to mud gradient of displacement fluid (0.43 psi/ft).

Burst:  $DF_b=1.125$

- Pressure Test: Casing test per Onshore Oil and Gas Order No. 2 with an external force equal to the mud gradient in which the casing will be run (0.47 psi/ft), which is a more conservative backup force than pore pressure.
- Gas Kick Profile: Internal burst force at the shoe will be Fracture Pressure at that depth. Surface burst pressure will be fracture gradient at setting depth less a gas gradient to equivalent height of 100 bbl kick with Drill Pipe inside casing and mud gradient with which the next hole section will be run above that (0.65 psi/ft). External force will be equal to the mud gradient in which the casing will be run (0.47 psi/ft), which is a more conservative backup force than pore pressure.
- Fracture at Shoe with 1/3 BHP at Surface: Internal burst force at the shoe will be Fracture Pressure at setting depth. Internal burst force at surface will be 1/3 of pore pressure at setting

depth. External force will be equal to the mud gradient in which the casing will be run (0.47 psi/ft) which is a more conservative backup force than pore pressure.

Tensile:  $DF_1=1.8$

- Overpull: A downward force of 100,000 lbs is applied at the shoe along with the weight of the casing string utilizing the effects of buoyancy (9.0 ppg).

## **Casing Design Criteria and Load Case Assumptions**

### **Intermediate #1 Casing**

Collapse:  $DF_c=1.125$

- Full Internal Evacuation: Collapse force equal to the mud gradient in which the casing will be run (0.52 psi/ft). The effects of axial load on collapse will be considered.
- Cementing: Collapse force equal to the gradient of planned cement slurries to planned depths and an internal force equal to mud gradient of displacement fluid (0.43 psi/ft).

Burst:  $DF_b=1.125$

- Pressure Test: Casing test per Onshore Oil and Gas Order No. 2 with an external force equal to the mud gradient in which the casing will be run (0.52 psi/ft), which is a more conservative backup force than pore pressure.
- Gas Kick Profile: Internal burst force at the shoe will be Fracture Pressure at that depth. Surface burst pressure will be fracture gradient at setting depth less a gas gradient to equivalent height of 50 bbl kick with Drill Pipe inside casing and mud gradient with which the next hole section will be run above that (0.47 psi/ft). External force will be equal to the mud gradient in which the casing will be run (0.52 psi/ft), which is a more conservative backup force than pore pressure.
- Fracture at Shoe with 1/3 BHP at Surface: Internal burst force at the shoe will be Fracture Pressure at setting depth. Internal burst force at surface will be 1/3 of pore pressure at setting depth. External force will be equal to the mud gradient in which the casing will be run (0.52 psi/ft) which is a more conservative backup force than pore pressure.

Tensile:  $DF_t=1.8$

- Overpull: A downward force of 100,000 lbs is applied at the shoe along with the weight of the casing string utilizing the effects of buoyancy (10.0 ppg).

### **Intermediate #2 Casing**

Collapse:  $DF_c=1.125$

- Partial Internal Evacuation: Collapse force equal to the mud gradient in which the casing will be run (0.47 psi/ft). The effects of axial load on collapse will be considered. Internal force equal to gas gradient over half of setting depth and mud gradient with which the next hole section will be run below that (0.65 psi/ft).
- Cementing: Collapse force equal to the gradient of planned cement slurries to planned depths and mud gradient in which the casing will be run above that (0.47 psi/ft) and an internal force equal to mud gradient of displacement fluid (0.43 psi/ft).

Burst:  $DF_b=1.125$

- Pressure Test: Casing test per Onshore Oil and Gas Order No. 2 with an external force equal to the mud gradient in which the casing will be run (0.47 psi/ft), which is a more conservative backup force than pore pressure.
- Gas Kick Profile: Internal burst force at the shoe will be Fracture Pressure at that depth. Surface burst pressure will be fracture gradient at setting depth less a gas gradient to equivalent height of 100 bbl kick with Drill Pipe inside casing and mud gradient with which the next hole section will be run above that (0.65 psi/ft). External force will be equal to the mud gradient in which the casing will be run (0.47 psi/ft), which is a more conservative backup force than pore pressure.
- Fracture at Shoe with 1/3 BHP at Surface: Internal burst force at the shoe will be Fracture Pressure at setting depth. Internal burst force at surface will be 1/3 of pore pressure at setting

depth. External force will be equal to the mud gradient in which the casing will be run (0.47 psi/ft) which is a more conservative backup force than pore pressure.

Tensile:  $DF_i=1.8$

- Overpull: A downward force of 100,000 lbs is applied at the shoe along with the weight of the casing string utilizing the effects of buoyancy (9.0 ppg).

## **Casing Design Criteria and Load Case Assumptions**

### **Intermediate #1 Casing**

Collapse:  $DF_c=1.125$

- Full Internal Evacuation: Collapse force equal to the mud gradient in which the casing will be run (0.52 psi/ft). The effects of axial load on collapse will be considered.
- Cementing: Collapse force equal to the gradient of planned cement slurries to planned depths and an internal force equal to mud gradient of displacement fluid (0.43 psi/ft).

Burst:  $DF_b=1.125$

- Pressure Test: Casing test per Onshore Oil and Gas Order No. 2 with an external force equal to the mud gradient in which the casing will be run (0.52 psi/ft), which is a more conservative backup force than pore pressure.
- Gas Kick Profile: Internal burst force at the shoe will be Fracture Pressure at that depth. Surface burst pressure will be fracture gradient at setting depth less a gas gradient to equivalent height of 50 bbl kick with Drill Pipe inside casing and mud gradient with which the next hole section will be run above that (0.47 psi/ft). External force will be equal to the mud gradient in which the casing will be run (0.52 psi/ft), which is a more conservative backup force than pore pressure.
- Fracture at Shoe with 1/3 BHP at Surface: Internal burst force at the shoe will be Fracture Pressure at setting depth. Internal burst force at surface will be 1/3 of pore pressure at setting depth. External force will be equal to the mud gradient in which the casing will be run (0.52 psi/ft) which is a more conservative backup force than pore pressure.

Tensile:  $DF_t=1.8$

- Overpull: A downward force of 100,000 lbs is applied at the shoe along with the weight of the casing string utilizing the effects of buoyancy (10.0 ppg).

### **Intermediate #2 Casing**

Collapse:  $DF_c=1.125$

- Partial Internal Evacuation: Collapse force equal to the mud gradient in which the casing will be run (0.47 psi/ft). The effects of axial load on collapse will be considered. Internal force equal to gas gradient over half of setting depth and mud gradient with which the next hole section will be run below that (0.65 psi/ft).
- Cementing: Collapse force equal to the gradient of planned cement slurries to planned depths and mud gradient in which the casing will be run above that (0.47 psi/ft) and an internal force equal to mud gradient of displacement fluid (0.43 psi/ft).

Burst:  $DF_b=1.125$

- Pressure Test: Casing test per Onshore Oil and Gas Order No. 2 with an external force equal to the mud gradient in which the casing will be run (0.47 psi/ft), which is a more conservative backup force than pore pressure.
- Gas Kick Profile: Internal burst force at the shoe will be Fracture Pressure at that depth. Surface burst pressure will be fracture gradient at setting depth less a gas gradient to equivalent height of 100 bbl kick with Drill Pipe inside casing and mud gradient with which the next hole section will be run above that (0.65 psi/ft). External force will be equal to the mud gradient in which the casing will be run (0.47 psi/ft), which is a more conservative backup force than pore pressure.
- Fracture at Shoe with 1/3 BHP at Surface: Internal burst force at the shoe will be Fracture Pressure at setting depth. Internal burst force at surface will be 1/3 of pore pressure at setting



depth. External force will be equal to the mud gradient in which the casing will be run (0.47 psi/ft) which is a more conservative backup force than pore pressure.

Tensile:  $DF_t=1.8$

- Overpull: A downward force of 100,000 lbs is applied at the shoe along with the weight of the casing string utilizing the effects of buoyancy (9.0 ppg).

## **Casing Design Criteria and Load Case Assumptions**

### **Intermediate #1 Casing**

Collapse:  $DF_c=1.125$

- Full Internal Evacuation: Collapse force equal to the mud gradient in which the casing will be run (0.52 psi/ft). The effects of axial load on collapse will be considered.
- Cementing: Collapse force equal to the gradient of planned cement slurries to planned depths and an internal force equal to mud gradient of displacement fluid (0.43 psi/ft).

Burst:  $DF_b=1.125$

- Pressure Test: Casing test per Onshore Oil and Gas Order No. 2 with an external force equal to the mud gradient in which the casing will be run (0.52 psi/ft), which is a more conservative backup force than pore pressure.
- Gas Kick Profile: Internal burst force at the shoe will be Fracture Pressure at that depth. Surface burst pressure will be fracture gradient at setting depth less a gas gradient to equivalent height of 50 bbl kick with Drill Pipe inside casing and mud gradient with which the next hole section will be run above that (0.47 psi/ft). External force will be equal to the mud gradient in which the casing will be run (0.52 psi/ft), which is a more conservative backup force than pore pressure.
- Fracture at Shoe with 1/3 BHP at Surface: Internal burst force at the shoe will be Fracture Pressure at setting depth. Internal burst force at surface will be 1/3 of pore pressure at setting depth. External force will be equal to the mud gradient in which the casing will be run (0.52 psi/ft) which is a more conservative backup force than pore pressure.

Tensile:  $DF_t=1.8$

- Overpull: A downward force of 100,000 lbs is applied at the shoe along with the weight of the casing string utilizing the effects of buoyancy (10.0 ppg).

### **Intermediate #2 Casing**

Collapse:  $DF_c=1.125$

- Partial Internal Evacuation: Collapse force equal to the mud gradient in which the casing will be run (0.47 psi/ft). The effects of axial load on collapse will be considered. Internal force equal to gas gradient over half of setting depth and mud gradient with which the next hole section will be run below that (0.65 psi/ft).
- Cementing: Collapse force equal to the gradient of planned cement slurries to planned depths and mud gradient in which the casing will be run above that (0.47 psi/ft) and an internal force equal to mud gradient of displacement fluid (0.43 psi/ft).

Burst:  $DF_b=1.125$

- Pressure Test: Casing test per Onshore Oil and Gas Order No. 2 with an external force equal to the mud gradient in which the casing will be run (0.47 psi/ft), which is a more conservative backup force than pore pressure.
- Gas Kick Profile: Internal burst force at the shoe will be Fracture Pressure at that depth. Surface burst pressure will be fracture gradient at setting depth less a gas gradient to equivalent height of 100 bbl kick with Drill Pipe inside casing and mud gradient with which the next hole section will be run above that (0.65 psi/ft). External force will be equal to the mud gradient in which the casing will be run (0.47 psi/ft), which is a more conservative backup force than pore pressure.
- Fracture at Shoe with 1/3 BHP at Surface: Internal burst force at the shoe will be Fracture Pressure at setting depth. Internal burst force at surface will be 1/3 of pore pressure at setting

## **Casing Design Criteria and Load Case Assumptions**

### **Surface Casing**

Collapse:  $DF_c=1.125$

- Full Internal Evacuation: Collapse force equal to the mud gradient in which the casing will be run (0.43 psi/ft). The effects of axial load on collapse will be considered.
- Cementing: Collapse force equal to the gradient of planned cement slurries to planned depths and an internal force equal to mud gradient of displacement fluid (0.52 psi/ft).

Burst:  $DF_b=1.125$

- Pressure Test: Casing test per Onshore Oil and Gas Order No. 2 with an external force equal to the mud gradient in which the casing will be run (0.43 psi/ft), which is a more conservative backup force than pore pressure.

Tensile:  $DF_t=1.8$

- Overpull: A downward force of 100,000 lbs is applied at the shoe along with the weight of the casing string utilizing the effects of buoyancy (8.3 ppg).

- Cementing: Collapse force equal to the gradient of planned cement slurries to planned depths and mud gradient in which the casing will be run above that (0.47 psi/ft) and an internal force equal to mud gradient of displacement fluid (0.43 psi/ft).

Burst:  $DF_b=1.125$

- Pressure Test: Casing test per Onshore Oil and Gas Order No. 2 with an external force equal to the mud gradient in which the casing will be run (0.47 psi/ft), which is a more conservative backup force than pore pressure.
- Gas Kick Profile: Internal burst force at the shoe will be Fracture Pressure at that depth. Surface burst pressure will be fracture gradient at setting depth less a gas gradient to equivalent height of 100 bbl kick with Drill Pipe inside casing and mud gradient with which the next hole section will be run above that (0.65 psi/ft). External force will be equal to the mud gradient in which the casing will be run (0.47 psi/ft), which is a more conservative backup force than pore pressure.
- Fracture at Shoe with 1/3 BHP at Surface: Internal burst force at the shoe will be Fracture Pressure at setting depth. Internal burst force at surface will be 1/3 of pore pressure at setting depth. External force will be equal to the mud gradient in which the casing will be run (0.47 psi/ft) which is a more conservative backup force than pore pressure.

Tensile:  $DF_t=1.8$

- Overpull: A downward force of 100,000 lbs is applied at the shoe along with the weight of the casing string utilizing the effects of buoyancy (9.0 ppg).

### Production Casing

Collapse:  $DF_c=1.125$

- Full Internal Evacuation: Collapse force equal to the mud gradient in which the casing will be run (0.65 psi/ft). The effects of axial load on collapse will be considered.
- Cementing: Collapse force equal to the gradient of planned cement slurries to planned depths and mud gradient in which the casing will be run above that (0.65 psi/ft) and an internal force equal to mud gradient of displacement fluid (0.43 psi/ft).

Burst:  $DF_b=1.125$

- Pressure Test: 8000 psi casing test with an external force equal to the mud gradient in which the casing will be run (0.65 psi/ft), which is a more conservative backup force than pore pressure.
- Injection Down Casing: 9500 psi surface injection pressure plus an internal pressure gradient of 0.65 psi/ft with an external force equal to the mud gradient in which the casing will be run (0.65 psi/ft), which is a more conservative backup force than pore pressure.

Tensile:  $DF_t=1.8$

- Overpull: A downward force of 100,000 lbs is applied at the shoe along with the weight of the casing string utilizing the effects of buoyancy (12.5 ppg).

## Casing Design Criteria and Load Case Assumptions

### Surface Casing

Collapse:  $DF_c=1.125$

- Full Internal Evacuation: Collapse force equal to the mud gradient in which the casing will be run (0.43 psi/ft). The effects of axial load on collapse will be considered.
- Cementing: Collapse force equal to the gradient of planned cement slurries to planned depths and an internal force equal to mud gradient of displacement fluid (0.52 psi/ft).

Burst:  $DF_b=1.125$

- Pressure Test: Casing test per Onshore Oil and Gas Order No. 2 with an external force equal to the mud gradient in which the casing will be run (0.43 psi/ft), which is a more conservative backup force than pore pressure.

Tensile:  $DF_t=1.8$

- Overpull: A downward force of 100,000 lbs is applied at the shoe along with the weight of the casing string utilizing the effects of buoyancy (8.3 ppg).

### Intermediate #1 Casing

Collapse:  $DF_c=1.125$

- Full Internal Evacuation: Collapse force equal to the mud gradient in which the casing will be run (0.52 psi/ft). The effects of axial load on collapse will be considered.
- Cementing: Collapse force equal to the gradient of planned cement slurries to planned depths and an internal force equal to mud gradient of displacement fluid (0.43 psi/ft).

Burst:  $DF_b=1.125$

- Pressure Test: Casing test per Onshore Oil and Gas Order No. 2 with an external force equal to the mud gradient in which the casing will be run (0.52 psi/ft), which is a more conservative backup force than pore pressure.
- Gas Kick Profile: Internal burst force at the shoe will be Fracture Pressure at that depth. Surface burst pressure will be fracture gradient at setting depth less a gas gradient to equivalent height of 50 bbl kick with Drill Pipe inside casing and mud gradient with which the next hole section will be run above that (0.47 psi/ft). External force will be equal to the mud gradient in which the casing will be run (0.52 psi/ft), which is a more conservative backup force than pore pressure.
- Fracture at Shoe with 1/3 BHP at Surface: Internal burst force at the shoe will be Fracture Pressure at setting depth. Internal burst force at surface will be 1/3 of pore pressure at setting depth. External force will be equal to the mud gradient in which the casing will be run (0.52 psi/ft) which is a more conservative backup force than pore pressure.

Tensile:  $DF_t=1.8$

- Overpull: A downward force of 100,000 lbs is applied at the shoe along with the weight of the casing string utilizing the effects of buoyancy (10.0 ppg).

### Intermediate #2 Casing

Collapse:  $DF_c=1.125$

- Partial Internal Evacuation: Collapse force equal to the mud gradient in which the casing will be run (0.47 psi/ft). The effects of axial load on collapse will be considered. Internal force equal to gas gradient over half of setting depth and mud gradient with which the next hole section will be run below that (0.65 psi/ft).

For the latest performance data, always visit our website: [www.tenaris.com](http://www.tenaris.com)

December 31 2015



Connection: TenarisXP® BTC  
Casing/Tubing: CAS  
Coupling Option: REGULAR

Size: 4.500 in.  
Wall: 0.290 in.  
Weight: 13.50 lbs/ft  
Grade: P110-ICY  
Min. Wall Thickness: 87.5 %

Nominal OD	4.500 in.	Nominal Weight	13.50 lbs/ft	Standard Drift Diameter	3.795 in.
Nominal ID	3.920 in.	Wall Thickness	0.290 in.	Special Drift Diameter	N/A
Plain End Weight	13.05 lbs/ft				
Body Yield Strength	479 x 1000 lbs	Internal Yield	14100 psi	SMYS	125000 psi
Collapse	11620 psi				
Connection OD	5.000 in.	Coupling Length	9.075 in.	Connection ID	3.908 in.
Critical Section Area	3.836 sq. in.	Threads per in.	5.00	Make-Up Loss	4.016 in.
Tension Efficiency	100 %	Joint Yield Strength	479 x 1000 lbs	Internal Pressure Capacity <sup>(1)</sup>	14100 psi
Structural Compression Efficiency	100 %	Structural Compression Strength	479 x 1000 lbs	Structural Bending <sup>(2)</sup>	127 °/100 ft
External Pressure Capacity	11620 psi				
Minimum	6950 ft-lbs	Optimum	7720 ft-lbs	Maximum	8490 ft-lbs
Operating Torque	10500 ft-lbs	Yield Torque	12200 ft-lbs		
Blanking Dimensions					

---

**BLANKING DIMENSIONS**

---

Blanking Dimensions

---

- (1) Internal Pressure Capacity related to structural resistance only. Internal pressure leak resistance as per section 10.3 API 5C3 / ISO 10400 - 2007.
- (2) Structural rating, pure bending to yield (i.e no other loads applied)
- (3) Torque values calculated for API Modified thread compounds with Friction Factor=1. For other thread compounds please contact us at [licensees@oilfield.tenaris.com](mailto:licensees@oilfield.tenaris.com). Torque values may be further reviewed.
- For additional information, please contact us at [contact-tenarishydril@tenaris.com](mailto:contact-tenarishydril@tenaris.com)

For the latest performance data, always visit our website: [www.tenaris.com](http://www.tenaris.com)

July 15 2015



**Connection:** TenarisXP™ BTC  
**Casing/Tubing:** CAS  
**Coupling Option:** REGULAR

**Size:** 5.500 in.  
**Wall:** 0.361 in.  
**Weight:** 20.00 lbs/ft  
**Grade:** P110-IC  
**Min. Wall Thickness:** 87.5 %

#### PIPE BODY DATA

##### GEOMETRY

Nominal OD	5.500 in.	Nominal Weight	20.00 lbs/ft	Standard Drift Diameter	4.653 in.
Nominal ID	4.778 in.	Wall Thickness	0.361 in.	Special Drift Diameter	N/A
Plain End Weight	19.83 lbs/ft				

##### PERFORMANCE

Body Yield Strength	641 x 1000 lbs	Internal Yield	12630 psi	SMYS	110000 psi
Collapse	12100 psi				

#### TENARISXP™ BTC CONNECTION DATA

##### GEOMETRY

Connection OD	6.100 in.	Coupling Length	9.450 in.	Connection ID	4.766 in.
Critical Section Area	5.828 sq. in.	Threads per in.	5.00	Make-Up Loss	4.204 in.

##### PERFORMANCE

Tension Efficiency	100 %	Joint Yield Strength	641 x 1000 lbs	Internal Pressure Capacity <sup>(1)</sup>	12630 psi
Structural Compression Efficiency	100 %	Structural Compression Strength	641 x 1000 lbs	Structural Bending <sup>(2)</sup>	92 °/100 ft
External Pressure Capacity	12100 psi				

#### ESTIMATED MAKE-UP TORQUES<sup>(3)</sup>

Minimum	11270 ft-lbs	Optimum	12520 ft-lbs	Maximum	13770 ft-lbs
---------	--------------	---------	--------------	---------	--------------

#### OPERATIONAL LIMIT TORQUES

Operating Torque	21500 ft-lbs	Yield Torque	23900 ft-lbs		
------------------	--------------	--------------	--------------	--	--



depth. External force will be equal to the mud gradient in which the casing will be run (0.47 psi/ft) which is a more conservative backup force than pore pressure.

Tensile:  $DF_i=1.8$

- Overpull: A downward force of 100,000 lbs is applied at the shoe along with the weight of the casing string utilizing the effects of buoyancy (9.0 ppg).

## **Casing Design Criteria and Load Case Assumptions**

### **Intermediate #1 Casing**

Collapse:  $DF_c=1.125$

- Full Internal Evacuation: Collapse force equal to the mud gradient in which the casing will be run (0.52 psi/ft). The effects of axial load on collapse will be considered.
- Cementing: Collapse force equal to the gradient of planned cement slurries to planned depths and an internal force equal to mud gradient of displacement fluid (0.43 psi/ft).

Burst:  $DF_b=1.125$

- Pressure Test: Casing test per Onshore Oil and Gas Order No. 2 with an external force equal to the mud gradient in which the casing will be run (0.52 psi/ft), which is a more conservative backup force than pore pressure.
- Gas Kick Profile: Internal burst force at the shoe will be Fracture Pressure at that depth. Surface burst pressure will be fracture gradient at setting depth less a gas gradient to equivalent height of 50 bbl kick with Drill Pipe inside casing and mud gradient with which the next hole section will be run above that (0.47 psi/ft). External force will be equal to the mud gradient in which the casing will be run (0.52 psi/ft), which is a more conservative backup force than pore pressure.
- Fracture at Shoe with 1/3 BHP at Surface: Internal burst force at the shoe will be Fracture Pressure at setting depth. Internal burst force at surface will be 1/3 of pore pressure at setting depth. External force will be equal to the mud gradient in which the casing will be run (0.52 psi/ft) which is a more conservative backup force than pore pressure.

Tensile:  $DF_t=1.8$

- Overpull: A downward force of 100,000 lbs is applied at the shoe along with the weight of the casing string utilizing the effects of buoyancy (10.0 ppg).

### **Intermediate #2 Casing**

Collapse:  $DF_c=1.125$

- Partial Internal Evacuation: Collapse force equal to the mud gradient in which the casing will be run (0.47 psi/ft). The effects of axial load on collapse will be considered. Internal force equal to gas gradient over half of setting depth and mud gradient with which the next hole section will be run below that (0.65 psi/ft).
- Cementing: Collapse force equal to the gradient of planned cement slurries to planned depths and mud gradient in which the casing will be run above that (0.47 psi/ft) and an internal force equal to mud gradient of displacement fluid (0.43 psi/ft).

Burst:  $DF_b=1.125$

- Pressure Test: Casing test per Onshore Oil and Gas Order No. 2 with an external force equal to the mud gradient in which the casing will be run (0.47 psi/ft), which is a more conservative backup force than pore pressure.
- Gas Kick Profile: Internal burst force at the shoe will be Fracture Pressure at that depth. Surface burst pressure will be fracture gradient at setting depth less a gas gradient to equivalent height of 100 bbl kick with Drill Pipe inside casing and mud gradient with which the next hole section will be run above that (0.65 psi/ft). External force will be equal to the mud gradient in which the casing will be run (0.47 psi/ft), which is a more conservative backup force than pore pressure.
- Fracture at Shoe with 1/3 BHP at Surface: Internal burst force at the shoe will be Fracture Pressure at setting depth. Internal burst force at surface will be 1/3 of pore pressure at setting

**DATA ARE INFORMATIVE ONLY.  
BASED ON SI\_PD-101836 P&B**

**VAM® HTF-NR**  
Connection Data Sheet

OD	Weight	Wall Th.	Grade	API Drift	Connection
7 5/8 in.	29.70 lb/ft	0.375 in.	P110 EC	6.750 in.	VAM® HTF NR

PIPE PROPERTIES	
Nominal OD	7.625 in.
Nominal ID	6.875 in.
Nominal Cross Section Area	8.541 sqin.
Grade Type	Enhanced API
Min. Yield Strength	125 ksi
Max. Yield Strength	140 ksi
Min. Ultimate Tensile Strength	135 ksi
Tensile Yield Strength	1 068 klb
Internal Yield Pressure	10 760 psi
Collapse pressure	7 360 psi

CONNECTION PROPERTIES	
Connection Type	Premium Integral Flush
Connection OD (nom)	7.701 in.
Connection ID (nom)	6.782 in.
Make-Up Loss	4.657 in.
Critical Cross Section	4.971 sqin.
Tension Efficiency	58 % of pipe
Compression Efficiency	72.7 % of pipe
Compression Efficiency with Sealability	34.8 % of pipe
Internal Pressure Efficiency	100 % of pipe
External Pressure Efficiency	100 % of pipe

CONNECTION PERFORMANCES	
Tensile Yield Strength	619 klb
Compression Resistance	778 klb
Compression with Sealability	372 klb
Internal Yield Pressure	10 760 psi
External Pressure Resistance	7 360 psi
Max. Bending	44 °/100ft
Max. Bending with Sealability	17 °/100ft

TORQUE VALUES	
Min. Make-up torque	9 600 ft.lb
Opti. Make-up torque	11 300 ft.lb
Max. Make-up torque	13 000 ft.lb
Max. Torque with Sealability	58 500 ft.lb
Max. Torsional Value	73 000 ft.lb

VAM® HTF™ (High Torque Flush) is a flush OD integral connection providing maximum clearance along with torque strength for challenging applications such as extended reach and slim hole wells, drilling liner / casing, liner rotation to achieve better cementation in highly deviated and critical High Pressure / High Temperature wells.

Looking ahead on the outcoming testing industry standards, VAM® decided to create an upgraded design and launch on the market the VAM® HTF-NR as the new standard version of VAM® extreme high torque flush connection. The VAM® HTF-NR has extensive tests as per API RP 5C5:2015 CAL II which include the gas sealability having load points with bending, internal pressure and high temperature at 135°C.

**Do you need help on this product? - Remember no one knows VAM® like VAM®**

canada@vamfieldservice.com  
usa@vamfieldservice.com  
mexico@vamfieldservice.com  
brazil@vamfieldservice.com

uk@vamfieldservice.com  
dubai@vamfieldservice.com  
nigeria@vamfieldservice.com  
angola@vamfieldservice.com

china@vamfieldservice.com  
baku@vamfieldservice.com  
singapore@vamfieldservice.com  
australia@vamfieldservice.com

**Over 180 VAM® Specialists available worldwide 24/7 for Rig Site Assistance**

Other Connection Data Sheets are available at [www.vamservices.com](http://www.vamservices.com)

**Vallourec Group**



depth. External force will be equal to the mud gradient in which the casing will be run (0.47 psi/ft) which is a more conservative backup force than pore pressure.

Tensile:  $DF_t=1.8$

- Overpull: A downward force of 100,000 lbs is applied at the shoe along with the weight of the casing string utilizing the effects of buoyancy (9.0 ppg).

## **Casing Design Criteria and Load Case Assumptions**

### **Intermediate #1 Casing**

Collapse:  $DF_c=1.125$

- Full Internal Evacuation: Collapse force equal to the mud gradient in which the casing will be run (0.52 psi/ft). The effects of axial load on collapse will be considered.
- Cementing: Collapse force equal to the gradient of planned cement slurries to planned depths and an internal force equal to mud gradient of displacement fluid (0.43 psi/ft).

Burst:  $DF_b=1.125$

- Pressure Test: Casing test per Onshore Oil and Gas Order No. 2 with an external force equal to the mud gradient in which the casing will be run (0.52 psi/ft), which is a more conservative backup force than pore pressure.
- Gas Kick Profile: Internal burst force at the shoe will be Fracture Pressure at that depth. Surface burst pressure will be fracture gradient at setting depth less a gas gradient to equivalent height of 50 bbl kick with Drill Pipe inside casing and mud gradient with which the next hole section will be run above that (0.47 psi/ft). External force will be equal to the mud gradient in which the casing will be run (0.52 psi/ft), which is a more conservative backup force than pore pressure.
- Fracture at Shoe with 1/3 BHP at Surface: Internal burst force at the shoe will be Fracture Pressure at setting depth. Internal burst force at surface will be 1/3 of pore pressure at setting depth. External force will be equal to the mud gradient in which the casing will be run (0.52 psi/ft) which is a more conservative backup force than pore pressure.

Tensile:  $DF_t=1.8$

- Overpull: A downward force of 100,000 lbs is applied at the shoe along with the weight of the casing string utilizing the effects of buoyancy (10.0 ppg).

### **Intermediate #2 Casing**

Collapse:  $DF_c=1.125$

- Partial Internal Evacuation: Collapse force equal to the mud gradient in which the casing will be run (0.47 psi/ft). The effects of axial load on collapse will be considered. Internal force equal to gas gradient over half of setting depth and mud gradient with which the next hole section will be run below that (0.65 psi/ft).
- Cementing: Collapse force equal to the gradient of planned cement slurries to planned depths and mud gradient in which the casing will be run above that (0.47 psi/ft) and an internal force equal to mud gradient of displacement fluid (0.43 psi/ft).

Burst:  $DF_b=1.125$

- Pressure Test: Casing test per Onshore Oil and Gas Order No. 2 with an external force equal to the mud gradient in which the casing will be run (0.47 psi/ft), which is a more conservative backup force than pore pressure.
- Gas Kick Profile: Internal burst force at the shoe will be Fracture Pressure at that depth. Surface burst pressure will be fracture gradient at setting depth less a gas gradient to equivalent height of 100 bbl kick with Drill Pipe inside casing and mud gradient with which the next hole section will be run above that (0.65 psi/ft). External force will be equal to the mud gradient in which the casing will be run (0.47 psi/ft), which is a more conservative backup force than pore pressure.
- Fracture at Shoe with 1/3 BHP at Surface: Internal burst force at the shoe will be Fracture Pressure at setting depth. Internal burst force at surface will be 1/3 of pore pressure at setting

depth. External force will be equal to the mud gradient in which the casing will be run (0.47 psi/ft) which is a more conservative backup force than pore pressure.

Tensile:  $DF_t=1.8$

- Overpull: A downward force of 100,000 lbs is applied at the shoe along with the weight of the casing string utilizing the effects of buoyancy (9.0 ppg).

## **Casing Design Criteria and Load Case Assumptions**

### **Intermediate #1 Casing**

Collapse:  $DF_c=1.125$

- Full Internal Evacuation: Collapse force equal to the mud gradient in which the casing will be run (0.52 psi/ft). The effects of axial load on collapse will be considered.
- Cementing: Collapse force equal to the gradient of planned cement slurries to planned depths and an internal force equal to mud gradient of displacement fluid (0.43 psi/ft).

Burst:  $DF_b=1.125$

- Pressure Test: Casing test per Onshore Oil and Gas Order No. 2 with an external force equal to the mud gradient in which the casing will be run (0.52 psi/ft), which is a more conservative backup force than pore pressure.
- Gas Kick Profile: Internal burst force at the shoe will be Fracture Pressure at that depth. Surface burst pressure will be fracture gradient at setting depth less a gas gradient to equivalent height of 50 bbl kick with Drill Pipe inside casing and mud gradient with which the next hole section will be run above that (0.47 psi/ft). External force will be equal to the mud gradient in which the casing will be run (0.52 psi/ft), which is a more conservative backup force than pore pressure.
- Fracture at Shoe with 1/3 BHP at Surface: Internal burst force at the shoe will be Fracture Pressure at setting depth. Internal burst force at surface will be 1/3 of pore pressure at setting depth. External force will be equal to the mud gradient in which the casing will be run (0.52 psi/ft) which is a more conservative backup force than pore pressure.

Tensile:  $DF_t=1.8$

- Overpull: A downward force of 100,000 lbs is applied at the shoe along with the weight of the casing string utilizing the effects of buoyancy (10.0 ppg).

### **Intermediate #2 Casing**

Collapse:  $DF_c=1.125$

- Partial Internal Evacuation: Collapse force equal to the mud gradient in which the casing will be run (0.47 psi/ft). The effects of axial load on collapse will be considered. Internal force equal to gas gradient over half of setting depth and mud gradient with which the next hole section will be run below that (0.65 psi/ft).
- Cementing: Collapse force equal to the gradient of planned cement slurries to planned depths and mud gradient in which the casing will be run above that (0.47 psi/ft) and an internal force equal to mud gradient of displacement fluid (0.43 psi/ft).

Burst:  $DF_b=1.125$

- Pressure Test: Casing test per Onshore Oil and Gas Order No. 2 with an external force equal to the mud gradient in which the casing will be run (0.47 psi/ft), which is a more conservative backup force than pore pressure.
- Gas Kick Profile: Internal burst force at the shoe will be Fracture Pressure at that depth. Surface burst pressure will be fracture gradient at setting depth less a gas gradient to equivalent height of 100 bbl kick with Drill Pipe inside casing and mud gradient with which the next hole section will be run above that (0.65 psi/ft). External force will be equal to the mud gradient in which the casing will be run (0.47 psi/ft), which is a more conservative backup force than pore pressure.
- Fracture at Shoe with 1/3 BHP at Surface: Internal burst force at the shoe will be Fracture Pressure at setting depth. Internal burst force at surface will be 1/3 of pore pressure at setting



Midwest Hose  
& Specialty, Inc.

### Internal Hydrostatic Test Certificate

General Information		Hose Specifications	
Customer	PATTERSON B&E	Hose Assembly Type	Choke & Kill
MWH Sales Representative	AMY WHITE	Certification	API 7K/FSL Level 2
Date Assembled	3/10/2015	Hose Grade	MUD
Location Assembled	OKC	Hose Working Pressure	10000
Sales Order #	245805	Hose Lot # and Date Code	11839-11/14
Customer Purchase Order #	270590	Hose I.D. (Inches)	2"
Assembly Serial # (Pick Ticket #)	296283	Hose O.D. (Inches)	3.99"
Hose Assembly Length	50'	Armor (yes/no)	YES
FITTINGS			
End A		End B	
Stem (Part and Revision #)	R2.0X32M1502	Stem (Part and Revision #)	RF2.0 32F1502
Stem (Heat #)	14104546	Stem (Heat #)	A144853
Ferrule (Part and Revision #)	RF2.0 10K	Ferrule (Part and Revision #)	RF2.0 10K
Ferrule (Heat #)	41044	Ferrule (Heat #)	41044
Connection - Flange Hammer Union Part		Connection (Part #)	
Connection (Heat #)		Connection (Heat #)	
Nut (Part #)	2" 1502 H2S	Nut (Part #)	
Nut (Heat #)		Nut (Heat #)	
Dies Used	97MM	Dies Used	97MM
Hydrostatic Test Requirements			
Test Pressure (psi)	15,000	Hose assembly was tested with ambient water temperature.	
Test Pressure Hold Time (minutes)	17 3/4		
Date Tested	Tested By	Approved By	
3/10/2015			





Midwest Hose  
& Specialty, Inc.

### Certificate of Conformity

Customer: <b>PATTERSON B&amp;E</b>	Customer P.O.# <b>261581</b>
Sales Order # <b>237566</b>	Date Assembled: <b>12/23/2014</b>

### Specifications

Hose Assembly Type:	<b>Choke &amp; Kill</b>		
Assembly Serial #	<b>286159</b>	Hose Lot # and Date Code	<b>11784-10/14</b>
Hose Working Pressure (psi)	<b>10000</b>	Test Pressure (psi)	<b>15000</b>

We hereby certify that the above material supplied for the referenced purchase order to be true according to the requirements of the purchase order and current industry standards.

Supplier:

Midwest Hose & Specialty, Inc.  
3312 S I-35 Service Rd  
Oklahoma City, OK 73129

Comments:

Approved By	Date
	<b>12/29/2014</b>



Midwest Hose  
& Specialty, Inc.

### Internal Hydrostatic Test Certificate

General Information		Hose Specifications	
Customer	PATTERSON B&E	Hose Assembly Type	Choke & Kill
MWH Sales Representative	AMY WHITE	Certification	API 7K/FSL Level 2
Date Assembled	12/23/2014	Hose Grade	MUD
Location Assembled	OKC	Hose Working Pressure	10000
Sales Order #	237566	Hose Lot # and Date Code	11784-10/14
Customer Purchase Order #	261581	Hose I.D. (Inches)	2"
Assembly Serial # (Pick Ticket #)	286159	Hose O.D. (Inches)	4.00"
Hose Assembly Length	50'	Armor (yes/no)	YES
Fittings			
End A		End B	
Stem (Part and Revision #)	R2.0X32M1502	Stem (Part and Revision #)	R2.0X32M1502
Stem (Heat #)	M14104546	Stem (Heat #)	M14101226
Ferrule (Part and Revision #)	RF2.0 10K	Ferrule (Part and Revision #)	RF2.0 10K
Ferrule (Heat #)	41044	Ferrule (Heat #)	41044
Connection (Flange Hammer Union Part)	2"1502	Connection (Part #)	
Connection (Heat #)	2866	Connection (Heat #)	
Nut (Part #)		Nut (Part #)	
Nut (Heat #)		Nut (Heat #)	
Dies Used	97MM	Dies Used	97MM
Hydrostatic Test Requirements			
Test Pressure (psi)	15,000	Hose assembly was tested with ambient water temperature.	
Test Pressure Hold Time (minutes)	15 1/4		
Date Tested	Tested By		Approved By
12/24/2014			



Midwest Hose  
& Specialty, Inc.

## Internal Hydrostatic Test Graph

Customer: Patterson

Pick Ticket #: 286159

R 809

Check & Sell  
Hoses  
December 24, 2014

### Hose Specifications

<u>Hose Type</u>	<u>Length</u>
Ck	50'
<u>I.D.</u>	<u>O.D.</u>
2"	3.55"
<u>Working Pressure</u>	<u>Burst Pressure</u>
10000 PSI	Standard Safety Multiplier Applies

### Verification

<u>Type of Fitting</u>	<u>Coupling Method</u>
2" 1502	Swage
<u>Die Size</u>	<u>Final O.D.</u>
97MM	3.98"
<u>Hose Serial #</u>	<u>Hose Assembly Serial #</u>
11784	286159

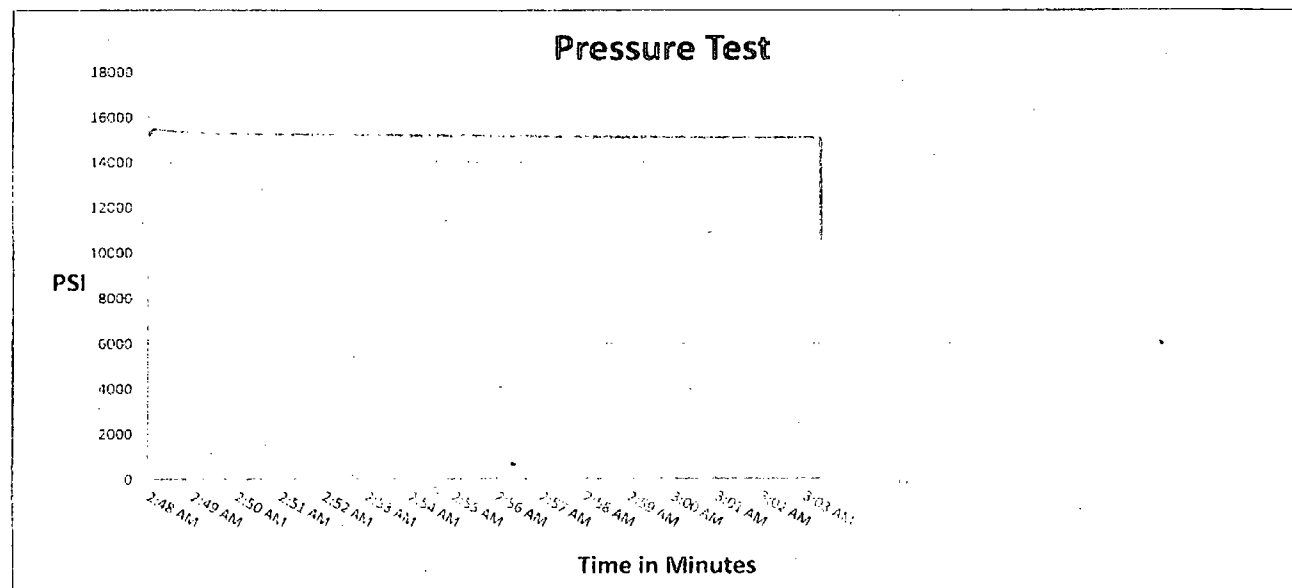

Test Pressure  
15000 PSI

Time Held at Test Pressure  
15 1/4 Minutes

Actual Burst Pressure

Peak Pressure  
15410 PSI

**Comments:** Hose assembly pressure tested with water at ambient temperature.

**Tested By:** Tyler Hill

**Approved By:** Ryan Adams

*Tyler Hill*

*Ryan Adams*



Midwest Hose  
& Specialty, Inc.

### Certificate of Conformity

Customer: **PATTERSON B&E**

Customer P.O.# **270590**

Sales Order # **245805**

Date Assembled: **3/10/2015**

### Specifications

Hose Assembly Type: **Choke & Kill**

Assembly Serial # **296283**

Hose Lot # and Date Code **11839-11/14**

Hose Working Pressure (psi) **10000**

Test Pressure (psi) **15000**

We hereby certify that the above material supplied for the referenced purchase order to be true according to the requirements of the purchase order and current industry standards.

Supplier:

**Midwest Hose & Specialty, Inc.**

**3312 S I-35 Service Rd**

**Oklahoma City, OK 73129**

Comments:

Approved By

Date

**3/19/2015**



Midwest Hose  
& Specialty, Inc.

### Internal Hydrostatic Test Certificate

General Information		Hose Specifications	
Customer	PATTERSON B&E	Hose Assembly Type	Choke & Kill
MWH Sales Representative	AMY WHITE	Certification	API 7K/FSL Level 2
Date Assembled	3/10/2015	Hose Grade	MUD
Location Assembled	OKC	Hose Working Pressure	10000
Sales Order #	245805	Hose Lot # and Date Code	11839-11/14
Customer Purchase Order #	270590	Hose I.D. (Inches)	2"
Assembly Serial # (Pick Ticket #)	296283	Hose O.D. (Inches)	3.99"
Hose Assembly Length	50'	Armor (yes/no)	YES
Fittings			
End A		End B	
Stem (Part and Revision #)	R2.0X32M1502	Stem (Part and Revision #)	RF2.0 32F1502
Stem (Heat #)	14104546	Stem (Heat #)	A144853
Ferrule (Part and Revision #)	RF2.0 10K	Ferrule (Part and Revision #)	RF2.0 10K
Ferrule (Heat #)	41044	Ferrule (Heat #)	41044
Connection - Flange Hammer Union Part		Connection (Part #)	
Connection (Heat #)		Connection (Heat #)	
Nut (Part #)	2" 1502 H2S	Nut (Part #)	
Nut (Heat #)		Nut (Heat #)	
Dies Used	97MM	Dies Used	97MM
Hydrostatic Test Requirements			
Test Pressure (psi)	15,000	Hose assembly was tested with ambient water temperature.	
Test Pressure Hold Time (minutes)	17 3/4		
Date Tested	Tested By		Approved By
3/10/2015			



Midwest Hose  
& Specialty, Inc.

## Internal Hydrostatic Test Graph

Customer: Patterson B&E

Pick Ticket #: 296283

2809

March 10, 2015

### Hose Specifications

<u>Hose Type</u>	<u>Length</u>
Mud	50'
<u>I.D.</u>	<u>O.D.</u>
2"	3.47"
<u>Working Pressure</u>	<u>Burst Pressure</u>
10000 PSI	Standard Safety Multiple: Approx

### Verification

<u>Type of Fitting</u>	<u>Coupling Method</u>
2" 1502	Swage
<u>Die Size</u>	<u>Final O.D.</u>
97MM	4.03"
<u>Hose Serial #</u>	<u>Hose Assembly Serial #</u>
11839	296283

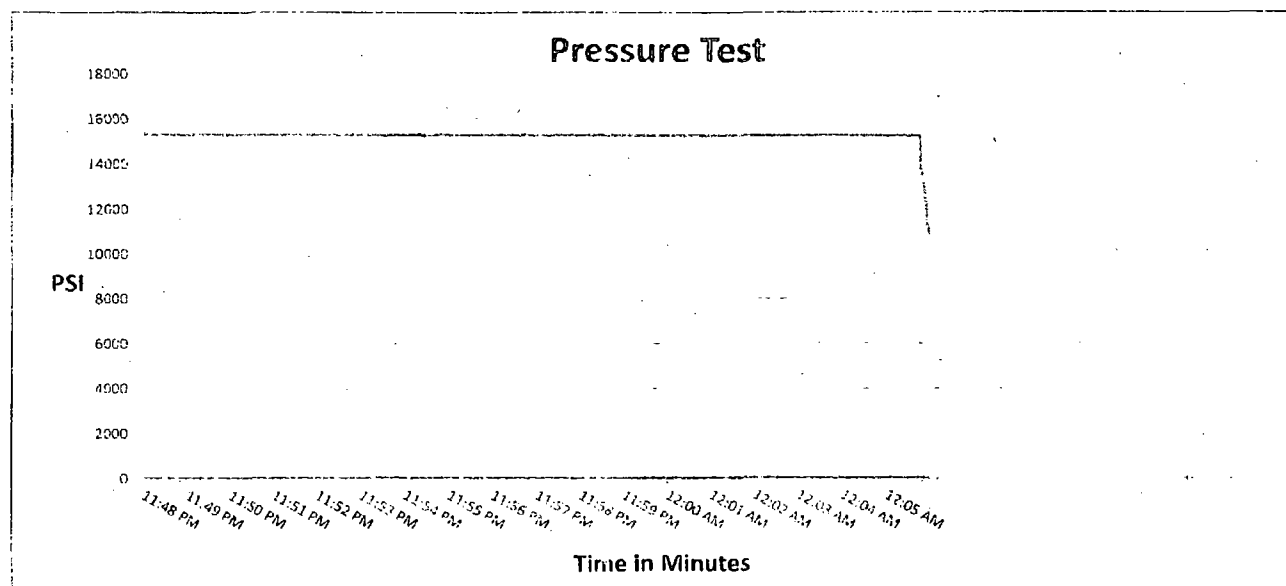

Test Pressure  
15000 PSI

Time Held at Test Pressure  
17 3/4 Minutes

Actual Burst Pressure

Peak Pressure  
15361 PSI

**Comments:** Hose assembly pressure tested with water at ambient temperature.

**Tested By:** Richard Davis

**Approved By:** Ryan Adams

*[Signature]*

*[Signature]*



**PATTERSON-UTI**

*Well Control*

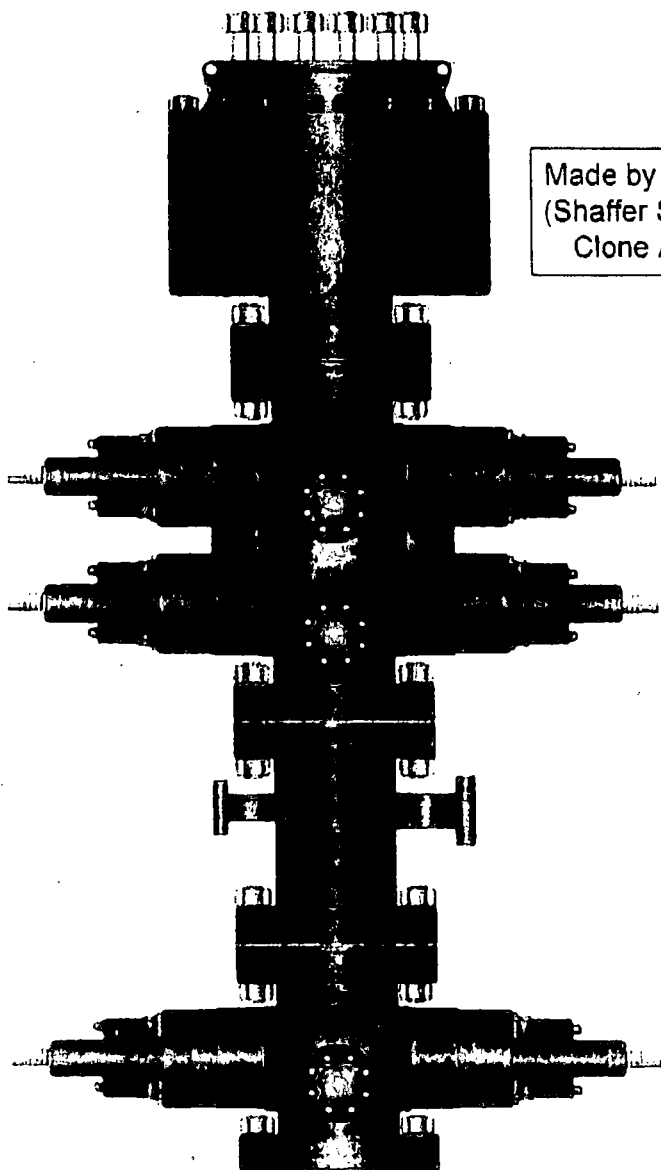
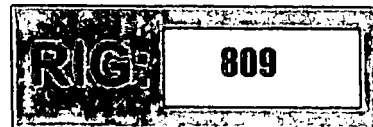

Made by Cameron  
(Shaffer Spherical)  
Clone Annular

PATTERSON-UTI # PS2-628

STYLE: New Shaffer Spherical

BORE 13 5/8" PRESSURE 5,000

HEIGHT: 48 1/2" WEIGHT: 13,800 lbs

PATTERSON-UTI # PC2-128

STYLE: New Cameron Type U

BORE 13 5/8" PRESSURE 10,000

RAMS: TOP 5" Pipe BTM Blinds

HEIGHT: 66 5/8" WEIGHT: 24,000 lbs

Length 40" Outlets 4" 10M

DSA 4" 10M x 2" 10M

PATTERSON-UTI # PC2-228

STYLE: New Cameron Type U

BORE 13 5/8" PRESSURE 10,000

RAMS: 5" Pipe

HEIGHT: 41 5/8" WEIGHT: 13,000 lbs

Handwritten signature

2" Minimum Kill Line

**WING VALVES**

3" Minimum Choke Line



2" Check Valve

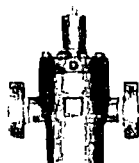

2" Manual Valve

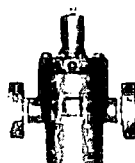

2" Manual Valve

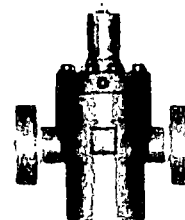

4" Manual Valve

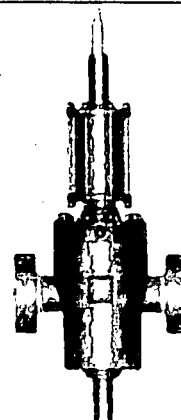

4" Hydraulic Valve

# LOCATION & ELEVATION VERIFICATION MAP

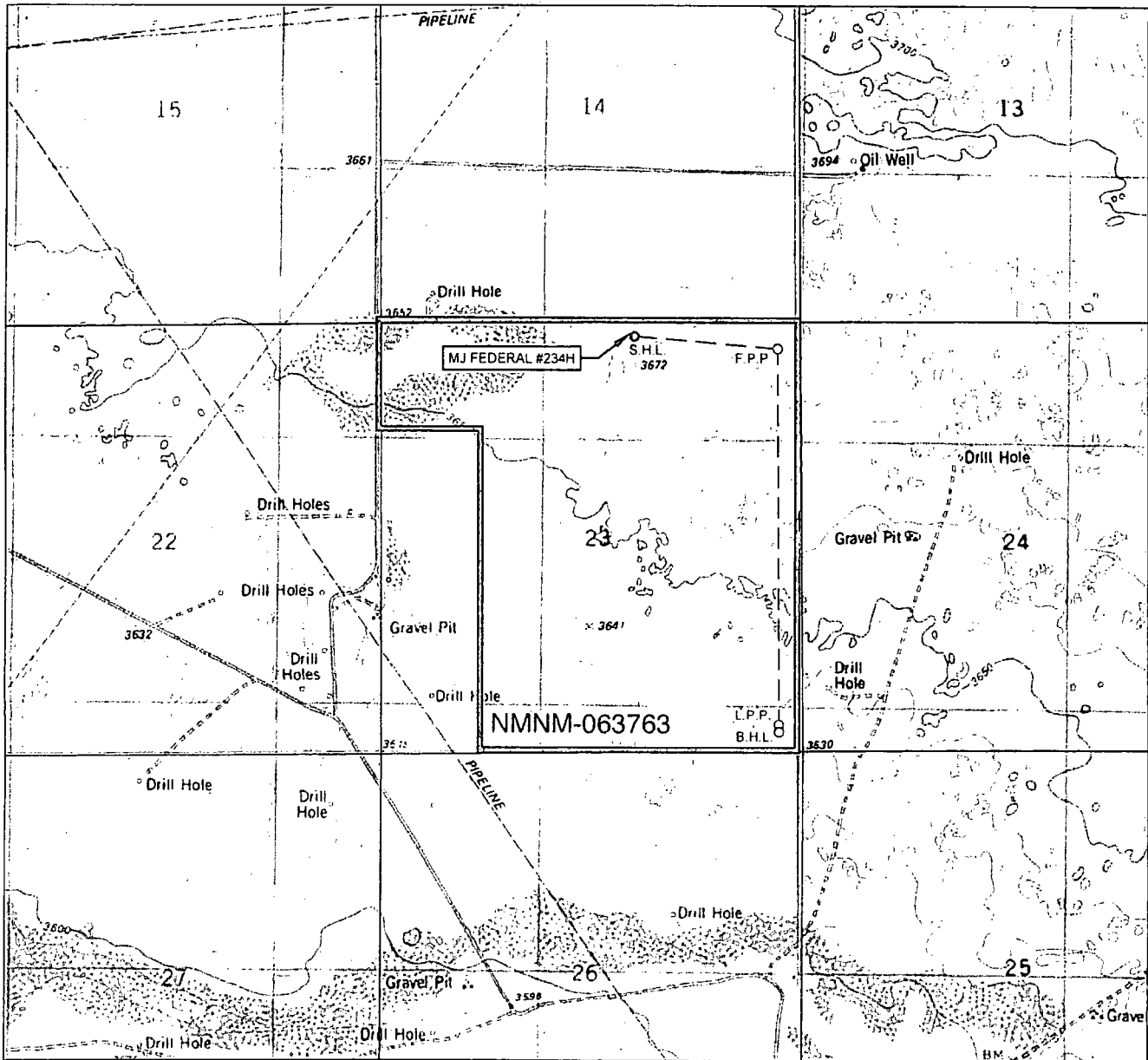

LEASE NAME & WELL NO.: MJ FEDERAL #234H

SECTION 23 TWP 19-S RGE 33-E SURVEY N.M.P.M.  
 COUNTY LEA STATE NM ELEVATION 3664'  
 DESCRIPTION 169' FNL & 2121' FEL

LATITUDE N 32.6524965 LONGITUDE W 103.6320904



SCALE: 1" = 2000'  
 0' 1000' 2000'

THIS EASEMENT/SERVITUDE LOCATION SHOWN HEREON HAS BEEN SURVEYED ON THE GROUND UNDER MY SUPERVISION AND PREPARED ACCORDING TO THE EVIDENCE FOUND AT THE TIME OF SURVEY, AND DATA PROVIDED BY MATADOR PRODUCTION COMPANY. THIS CERTIFICATION IS MADE AND LIMITED TO THOSE PERSONS OR ENTITIES SHOWN ON THE FACE OF THIS PLAT AND IS NON-TRANSFERABLE. THIS SURVEY IS CERTIFIED FOR THIS TRANSACTION ONLY.

ALL BEARINGS, DISTANCES, AND COORDINATE VALUES CONTAINED HEREON ARE GRID BASED UPON THE NEW MEXICO STATE PLANE COORDINATE SYSTEM, EAST ZONE OF THE NORTH AMERICAN DATUM 1983, U.S. SURVEY FEET.



**TOPOGRAPHIC**  
 LOYALTY INNOVATION LEGACY

1400 EVERMAN PARKWAY, Ste. 197 • FT. WORTH, TEXAS 76140  
 TELEPHONE: (817) 744-7512 • FAX: (817) 744-7548  
 2903 NORTH BIG SPRING • MIDLAND, TEXAS 79705  
 TELEPHONE: (432) 682-1653 OR (800) 767-1653 • FAX: (432) 682-1743  
 WWW.TOPOGRAPHIC.COM