

DISTRICT I
1623 N French Dr, Hobbs, NM 88240
Phone (575) 393-6161 Fax (575) 393-0720

DISTRICT II
811 S First St., Artesia, NM 88210
Phone (575) 748-1283 Fax (575) 748-9720

DISTRICT III
1600 Rio Brazos Road, Aztec, NM 87410
Phone (505) 334-6178 Fax (505) 334-6170

DISTRICT IV
1220 S. St. Francis Dr., Santa Fe, NM 87505
Phone (505) 476-3460 Fax (505) 476-3462

HOBBS OCD State of New Mexico
Energy, Minerals & Natural Resources Department

JUN 12 2016 OIL CONSERVATION DIVISION
1220 South St. Francis Dr.
Santa Fe, New Mexico 87505

Form C-102
Revised August 1, 2011
Submit one copy to appropriate
District Office

RECEIVED

DAMENDED REPORT

WELL LOCATION AND ACREAGE DEDICATION PLAT

API Number 30-025-43725		Pool Code 97 838		Pool Name JENNINGS; UPPER BONE SPRING SHALE	
Property Code 305301		Property Name MESA 8105 JV-P			Well Number 31H
OGRID No 260297		Operator Name BTA OIL PRODUCERS, LLC			Elevation 3354'

Surface Location

UL or lot No	Section	Township	Range	Lot Idn	Feet from the	North/South line	Feet from the	East/West line	County
B	I	26-S	32-E		383	NORTH	1897	EAST	LEA

As-Drilled Bottom Hole Location If Different From Surface

UL or lot No	Section	Township	Range	Lot Idn	Feet from the	North/South line	Feet from the	East/West line	County
O	12	26-S	32-E		217.6	SOUTH	2314.2	EAST	LEA

Dedicated Acres 320	Joint or Infill	Consolidation Code	Order No
-------------------------------	-----------------	--------------------	----------

NO ALLOWABLE WILL BE ASSIGNED TO THIS COMPLETION UNTIL ALL INTERESTS HAVE BEEN CONSOLIDATED OR A NON-STANDARD UNIT HAS BEEN APPROVED BY THE DIVISION

SCALE: 1"=2000'

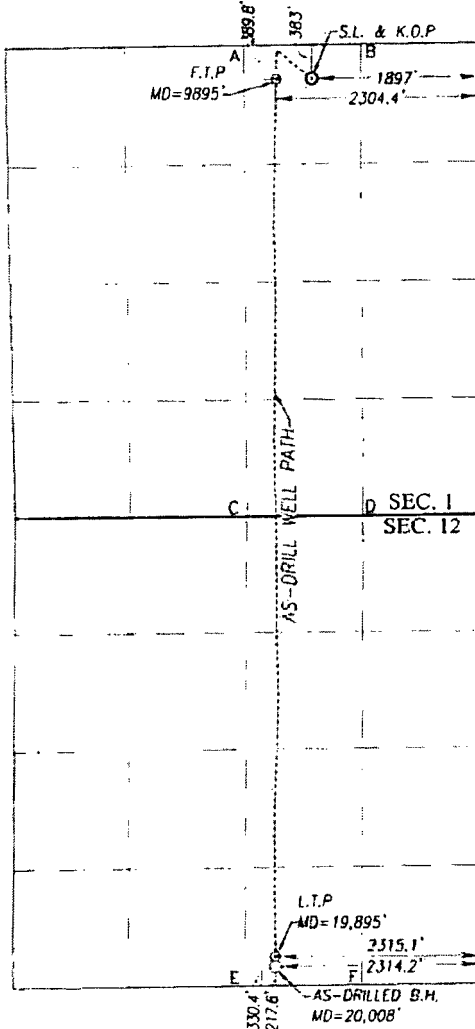

GEODEIC COORDINATES NAD 27 NME SURFACE LOCATION & KICK OFF POINT Y=393041.7 N X=719226.7 E LAT.=32.078610° N LONG.=103.625542° W	GEODEIC COORDINATES NAD 83 NME SURFACE LOCATION & KICK OF POINT Y=393099.2 N X=760413.3 E LAT.=32.078735° N LONG.=103.626013° W
FIRST TAKE POINT NAD 27 NME Y=393029.7 N X=718819.0 E LAT.=32.078585° N LONG.=103.626858° W	FIRST TAKE POINT NAD 83 NME Y=393087.2 N X=760005.6 E LAT.=32.078709° N LONG.=103.627329° W

CORNER COORDINATES TABLE

NAD 27 NME

A - Y=393415.0 N, X=718447.9 E
B - Y=393430.8 N, X=719783.4 E
C - Y=388053.0 N, X=718523.7 E
D - Y=388065.8 N, X=719852.3 E
E - Y=382711.4 N, X=718554.5 E
F - Y=382729.0 N, X=719884.8 E

CORNER COORDINATES TABLE

NAD 83 NME

A - Y=393472.5 N, X=759634.5 E
B - Y=393488.4 N, X=760970.0 E
C - Y=388110.4 N, X=759710.5 E
D - Y=388123.2 N, X=761039.1 E
E - Y=382768.7 N, X=759741.5 E
F - Y=382786.2 N, X=761071.9 E

LAST TAKE POINT NAD 27 NME Y=383046.3 N X=718898.5 E LAT.=32.051140° N LONG.=103.626812° W	LAST TAKE POINT NAD 83 NME Y=383103.6 N X=760085.5 E LAT.=32.051265° N LONG.=103.627282° W
--	--

AS-DRILLED BOTTOM HOLE LOCATION NAD 27 NME Y=382933.5 N X=718900.1 E LAT.=32.050830° N LONG.=103.626810° W	AS-DRILLED BOITOM HOLE LOCATION NAD 83 NME Y=382990.8 N X=760087.1 E LAT.=32.050955° N LONG.=103.627279° W
--	--

NOTE: AS-DRILLED WELL PATH, BOTTOM HOLE AND TAKE POINTS
PLOTTED FROM OCS DIRECTIONAL DRILLING SURVEY REPORT.

OPERATOR CERTIFICATION

I hereby certify that the information herein is true and complete to the best of my knowledge and belief, and that this organization either owns a working interest or unleased mineral interest in the land including the proposed bottom hole location or has a right to drill this well at this location pursuant to a contract with an owner of such mineral or working interest, or to a voluntary pooling agreement or a compulsory pooling order heretofore entered by the division.

Kayla McConnell 5/25/2018
Signature Date

KAYLA MCCONNELL

Printed Name

KMCCONNELL@BTAOIL.COM

E-mail Address

SURVEYOR CERTIFICATION

I hereby certify that the well location shown on this plat was plotted from field notes of actual surveys made by me or under my supervision, and that the same is true and correct to the best of my belief.

JUNE 1, 2016

Date of Survey
Signature of State Registered Surveyor

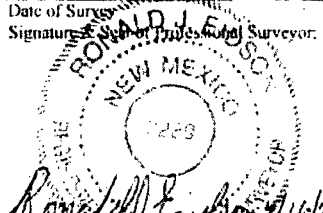

Ronald J. Eidson 6/1/2016
Certificate Number Date
Ronald J. Eidson 1264
Ronald J. Eidson 3239

ACK REL W/O 17130931 JWSC W/O 18 13 0399