

DISTRICT I
1625 N. French Dr., Hobbs, NM 88240
Phone: (575) 393-6161 Fax: (575) 393-0720

DISTRICT II
811 S. First St., Artesia, NM 88210
Phone: (575) 748-1253 Fax: (575) 748-0720

DISTRICT III
1000 Rio Brazos Rd., Aztec, NM 87410
Phone: (505) 334-6178 Fax: (505) 334-6170

DISTRICT IV
1220 S. St. Francis Dr., Santa Fe, NM 87505
Phone: (505) 478-3460 Fax: (505) 478-3462

State of New Mexico
Energy, Minerals & Natural Resources Department

OIL CONSERVATION DIVISION
1220 South St. Frances Dr.
Santa Fe, NM 87505

HOBBS OCD

MAY 01 2019

RECEIVED

Form C-102
Revised August 1, 2011
Submit one copy to appropriate
District Office

☐ AMENDED REPORT

WELL LOCATION AND ACREAGE DEDICATION PLAT

API Number 30-025-45900	Pool Code 98247	Pool Name WC-025 G-08 S20343SD; Wolfcamp
Property Code 302802	Property Name LEA UNIT	Well Number 120H
GRID No. 240974	Operator Name LEGACY RESERVES OPERATING LP	Elevation 3678'

Surface Location

UL or lot No.	Section	Township	Range	Lot Idn	Feet from the	North/South line	Feet from the	East/West line	County
L	19	20 S	35 E	3	2,200	SOUTH	535	WEST	LEA

Bottom Hole Location If Different From Surface

UL or lot No.	Section	Township	Range	Lot Idn	Feet from the	North/South line	Feet from the	East/West line	County
D	18	20 S	35 E	1	100	NORTH	350	WEST	LEA

Dedicated Acres	Joint or Infill	Consolidation Code	Order No.
239.77			

NO ALLOWABLE WILL BE ASSIGNED TO THIS COMPLETION UNTIL ALL INTERESTS HAVE BEEN CONSOLIDATED OR A NON-STANDARD UNIT HAS BEEN APPROVED BY THE DIVISION

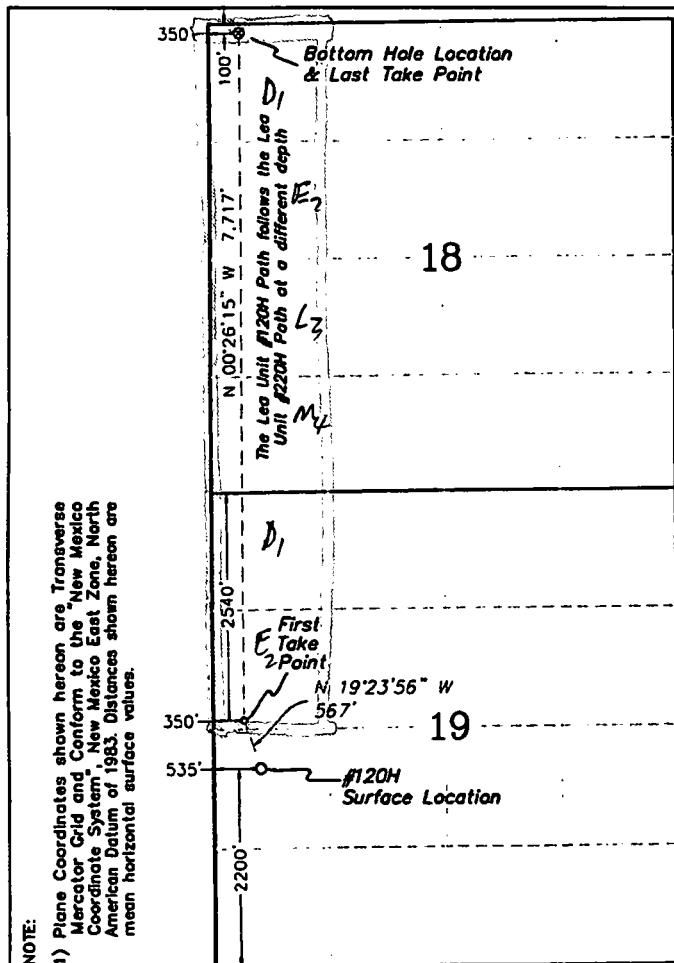

BOTTOM HOLE LOCATION & LAST TAKE POINT (NAD83)

Plane Coordinate
X = 796,784.3
Y = 575,765.7
Geodetic (D.D.)
32.58009758° N
103.50402822° W

FIRST TAKE POINT (NAD83)

Plane Coordinate
X = 796,843.2
Y = 568,049.4
Geodetic (D.D.)
32.55888813° N
103.50403217° W

SURFACE LOCATION (NAD83)

Plane Coordinate
X = 797,031.4
Y = 567,514.9
Geodetic (D.D.)
32.55741506° N
103.50343485° W

Scale
1" = 2000'

OPERATOR CERTIFICATION

I hereby certify that the information contained herein is true and complete to the best of my knowledge and belief, and that this organization either owns a working interest or undivided mineral interest in the land including the proposed bottom hole location or has a right to drill this well at this location pursuant to a contract with an owner of such a mineral or working interest, or to a voluntary pooling agreement or a compulsory pooling order heretofore entered by the division.

Sherry Morrow 1/2/19
Signature Date

Sherry Morrow
Printed Name

smorrow@legacyreserves.com
E-mail Address

SURVEYOR CERTIFICATION

I hereby certify that the well location shown on this plat was plotted from field notes of actual surveys made by me or under my supervision, and that the same is true and correct to the best of my belief.

March 22, 2018

Date of Survey

Signature & Seal of Professional Surveyor

11-05-18

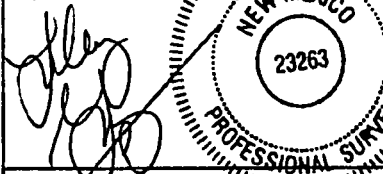

W.O. Num. 201840264

Certificate No. Lindsay Gyax 23263