

UNITED STATES
DEPARTMENT OF THE INTERIOR
BUREAU OF LAND MANAGEMENT

Carlsbad Field Office
FORM APPROVED
OMB No. 1004-0137
Expires January 31, 2018

SUNDRY NOTICES AND REPORTS ON WELLS
Do not use this form for proposals to drill or to re-enter an abandoned well. Use form 3160-3 (APD) for such proposals.

OCD Hobbs
Lease Serial No. 30-025-45127-00-X1

HOBBS OCD

SUBMIT IN TRIPLICATE - Other instructions on page 2

JUN 10 2019

RECEIVED

1. Type of Well <input type="checkbox"/> Oil Well <input type="checkbox"/> Gas Well <input checked="" type="checkbox"/> Other: INJECTION		6. If Indian, Allottee or Tribe Name
2. Name of Operator CHEVRON USA INCORPORATED		7. If Unit or CA/Agreement, Name and/or No.
Contact: LAURA BECERRA E-Mail: LBECERRA@CHEVRON.COM		8. Well Name and No. MAELSTROM SWD 1
3a. Address 6301 DEAUVILLE BLVD MIDLAND, TX 79706	3b. Phone No. (include area code) Ph: 432-687-7655	9. Well No. 30-025-45127-00-X1
4. Location of Well (Footage, Sec., T., R., M., or Survey Description) Sec 15 T26S R32E NWSE 2050FSL 1793FEL 32.041229 N Lat, 103.659966 W Lon		10. Field and Pool or Exploratory Area SWD-SILURIAN
		11. County or Parish, State LEA COUNTY, NM

12. CHECK THE APPROPRIATE BOX(ES) TO INDICATE NATURE OF NOTICE, REPORT, OR OTHER DATA

TYPE OF SUBMISSION	TYPE OF ACTION			
<input checked="" type="checkbox"/> Notice of Intent	<input type="checkbox"/> Acidize	<input type="checkbox"/> Deepen	<input type="checkbox"/> Production (Start/Resume)	<input type="checkbox"/> Water Shut-Off
<input type="checkbox"/> Subsequent Report	<input type="checkbox"/> Alter Casing	<input type="checkbox"/> Hydraulic Fracturing	<input type="checkbox"/> Reclamation	<input type="checkbox"/> Well Integrity
<input type="checkbox"/> Final Abandonment Notice	<input type="checkbox"/> Casing Repair	<input type="checkbox"/> New Construction	<input type="checkbox"/> Recomplete	<input checked="" type="checkbox"/> Other Surface Disturbance
	<input type="checkbox"/> Change Plans	<input type="checkbox"/> Plug and Abandon	<input type="checkbox"/> Temporarily Abandon	
	<input type="checkbox"/> Convert to Injection	<input type="checkbox"/> Plug Back	<input type="checkbox"/> Water Disposal	

13. Describe Proposed or Completed Operation: Clearly state all pertinent details, including estimated starting date of any proposed work and approximate duration thereof. If the proposal is to deepen directionally or recomple horizontally, give subsurface locations and measured and true vertical depths of all pertinent markers and zones. Attach the Bond under which the work will be performed or provide the Bond No. on file with BLM/BIA. Required subsequent reports must be filed within 30 days following completion of the involved operations. If the operation results in a multiple completion or recomple in a new interval, a Form 3160-4 must be filed once testing has been completed. Final Abandonment Notices must be filed only after all requirements, including reclamation, have been completed and the operator has determined that the site is ready for final inspection.

A 30' EDS ROW, 2,980.98' in total length, is proposed in Sec. 15 T26S-R32E.

As part of the original APD for Maelstrom SWD 1, an EDS line was proposed running from the Maelstrom SWD pad to the existing Lease Road (total ROW length 1,619.04'). Unfortunately, it was determined that the existing Chevron EDS ROW for Salado Draw did not extend to the West beyond the existing Salado Draw Pad #5 (SD WE 14 Fed P5). As such, the power system cannot currently be completed/tied in for the Maelstrom SWD. The proposed EDS ROW would close the EDS link and provide necessary power to inject water into the Maelstrom SWD #1 disposal well.

Attached you will find the original Aerial Detail Map and certified EDS plat.

PCM 5-20-17

No new Surface Disturbance all within ROW. Existing COA apply

14. I hereby certify that the foregoing is true and correct. Electronic Submission #464150 verified by the BLM Well Information System For CHEVRON USA INCORPORATED, sent to the Hobbs Committed to AFMSS for processing by JUANA MEDRANO on 05/06/2019 (19JM0046SE)	
Name (Printed/Typed) LAURA BECERRA	Title REGULATORY SPECIALIST
Signature (Electronic Submission)	Date 05/06/2019

THIS SPACE FOR FEDERAL OR STATE OFFICE USE

Approved By <i>Cathy M. Lytle</i>	Title AFM & LGM	Date 05/24/2019
Conditions of approval, if any, are attached. Approval of this notice does not warrant or certify that the applicant holds legal or equitable title to those rights in the subject lease which would entitle the applicant to conduct operations thereon.		Office CPD

Title 18 U.S.C. Section 1001 and Title 43 U.S.C. Section 1212, make it a crime for any person knowingly and willfully to make to any department or agency of the United States any false, fictitious or fraudulent statements or representations as to any matter within its jurisdiction.

(Instructions on page 2)

**** BLM REVISED ** BLM REVISED ** BLM REVISED ** BLM REVISED ** BLM REVISED ****

Ka

Revisions to Operator-Submitted EC Data for Sundry Notice #464150

	Operator Submitted	BLM Revised (AFMSS)
Sundry Type:	DISTURB NOI	DISTURB NOI
Lease:	NMNM118723	NMNM118723
Agreement:		
Operator:	CHEVRON USA INC 6301 DEAUVILLE BLVD MIDLAND, TX 79706 Ph: 432-687-7665	CHEVRON USA INCORPORATED 6301 DEAUVILLE BLVD MIDLAND, TX 79706 Ph: 432.687.7100 Fx: 432-687-7221
Admin Contact:	LAURA BECERRA REGULATORY SPECIALIST E-Mail: LBECERRA@CHEVRON.COM Ph: 432-687-7655	LAURA BECERRA REGULATORY SPECIALIST E-Mail: LBECERRA@CHEVRON.COM Ph: 432-687-7655
Tech Contact:	LAURA BECERRA REGULATORY SPECIALIST E-Mail: LBECERRA@CHEVRON.COM Ph: 432-687-7655	LAURA BECERRA REGULATORY SPECIALIST E-Mail: LBECERRA@CHEVRON.COM Ph: 432-687-7655
Location:		
State:	NM	NM
County:	LEA	LEA
Field/Pool:	SWD; SILURIAN	SWD-SILURIAN
Well/Facility:	MAELSTROM SWD 1 Sec 15 T26S R32E Mer NMP NWSE 2050FSL 1793FEL	MAELSTROM SWD 1 Sec 15 T26S R32E NWSE 2050FSL 1793FEL 32.041229 N Lat, 103.659966 W Lon

R 32 E

FOR THE EXCLUSIVE USE OF
CHEVRON U.S.A. INC.

I, Robert L. Lastrapes, Professional
Surveyor, do hereby state this plat is true
and correct to the best of my knowledge.

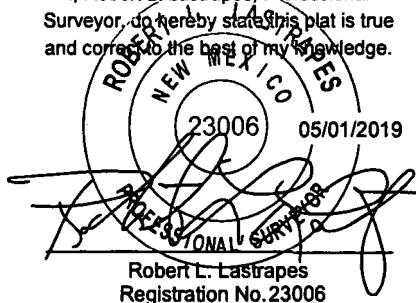

NOTE:

Please be advised, that while reasonable efforts are made to locate and verify pipelines and anomalies using our standard pipeline locating equipment, it is impossible to be 100 % effective. As such, we advise using caution when performing work as there is a possibility that pipelines and other hazards, such as fiber optic cables, PVC pipelines, etc. may exist undetected on site.

NOTE:

Many states maintain information centers that establish links between those who dig (excavators) and those who own and operate underground facilities (operators). It is advisable and in most states, law, for the contractor to contact the center for assistance in locating and marking underground utilities. For guidance: New Mexico One Call, www.nm811.org.

DISCLAIMER: At this time, C.H. Fenstermaker & Associates, LLC has not performed nor was asked to perform any type of engineering, hydrological modeling, flood plain, or "No Rise" certification analyses, including but not limited to determining whether the project will impact flood hazards in connection with federal/FEMA, state, and/or local laws, ordinances and regulations. Accordingly, Fenstermaker makes no warranty or representation of any kind as to the foregoing issues, and persons or entities using this information shall do so at their own risk.

T
26
S

Existing
Maelstrom SWD
Pad

Existing
Access Road

PROPOSED EDS LINE		
COURSE	BEARING	DISTANCE
1	N 00° 04' 01" W	135.61'
2	S 89° 37' 19" W	1422.23'
3	N 00° 04' 01" W	428.22'
4	S 89° 12' 06" W	994.92'

Sec. 15

Bureau of Land Management

POINT OF ENDING
(NAD 27)
X= 708,838.49
Y= 377,500.13

PROPOSED
EDS LINE
±2,980.98'
±180.67 Rods

LEGEND	
---	Section Line
—P—	Proposed EDS Line
---	Existing Road/Pad
---	Existing Pipeline
---	Existing ROW
●	Found Monument



Existing PL ROW

Existing Pad 9

Existing Pad

Existing Lease Road

Sec. 22

Bureau of Land Management

Fnd. 1 1/2" Iron Pipe w/ Cap
@ NW Corner of Section 23

Sec. 14

Bureau of Land
Management

Existing
Pad 5

POINT OF BEGINNING @
EXISTING POLE
(NAD 27)
X= 711,256.16
Y= 376,959.55

Sec. 23

Bureau of Land
Management

(4) Existing
Surface Lines

SURFACE USE PLAT

Scale: 1" = 400'

400' 0 200' 400'

CHEVRON U.S.A. INC.

PROPOSED EDS LINE

MAELSTROM SWD NO. 1

SECTIONS 15, 22 & 23, T26S-R32E

LEA COUNTY, NEW MEXICO

REVISIONS



C. H. Fenstermaker & Associates, L.L.C.
135 Regency Sq. Lafayette, LA 70508
Ph. 337-237-2200 Fax. 337-232-3299
www.fenstermaker.com

DRAWN BY:	#	BY:	DATE:	DESCRIPTION:
PROJ. MGR.:	VHV	1	AMR 04/26/2019	Revised EDS Line
DATE:	11/21/2017	2	VHV 04/30/2019	Removed information for N/S portion.
FILENAME: T:\2017\2175438\DWG\Maelstrom SWD No.1_Powerline_R.dwg				

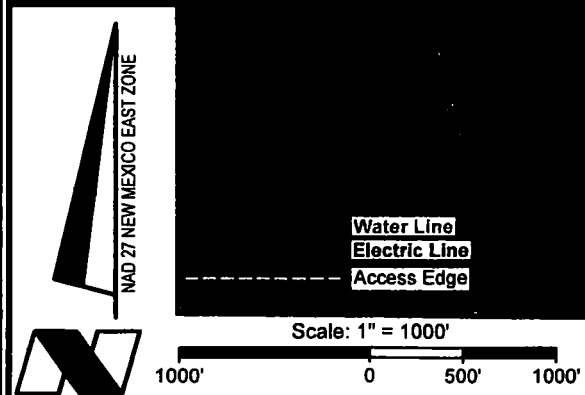
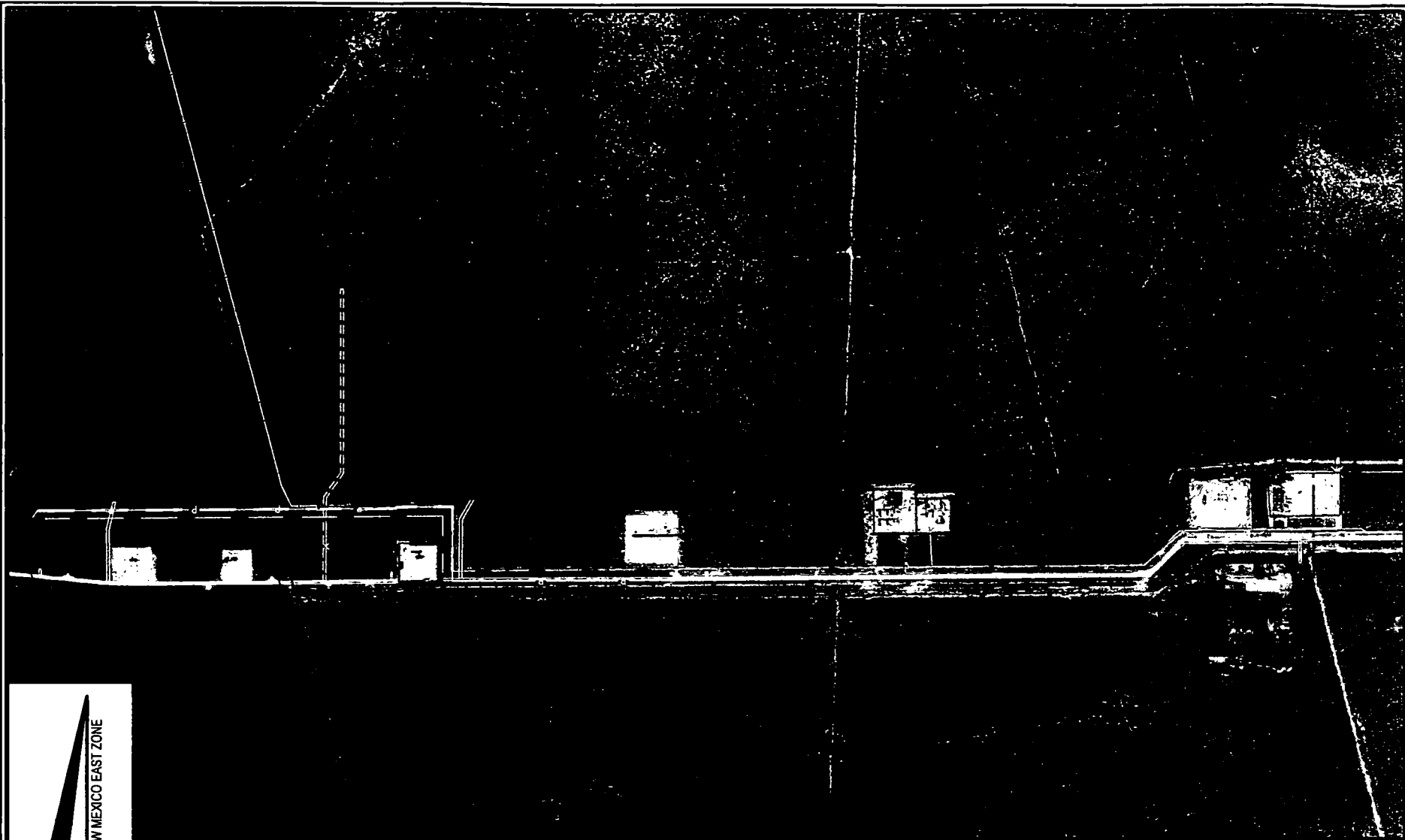

FENSTERMAKER

C. H. Fenstermaker & Associates, L.L.C.
 135 Regency Sq. Lafayette, LA 70508
 Ph. 337-237-2200 Fax. 337-232-3299
www.fenstermaker.com

CHEVRON U.S.A. INC.
 WORK AREA DETAIL FOR THE
 MAELSTROM SWD NO. 1 WELL
 SECTIONS 13-15, 22 & 23, T26S-R32E
 LEA COUNTY, NEW MEXICO

REVISIONS				
DRAWN BY: VHV	#	BY:	DATE:	DESCRIPTION:
PROJ. MGR.: VHV	1	DMB	10/24/2017	Access Revision
DATE: 10/11/2017				
FILENAME: T:\2017\2175438\DWG\Maelstrom SWD No.1_AerialDetail.dwg				

