

ALM/F/3

HOBBS OCD

District I
1625 N. French Dr., Hobbs, NM 88240
Phone: (575) 393-6161 Fax: (575) 393-0720
District II
811 S. First St., Artesia, NM 88210
Phone: (575) 748-1283 Fax: (575) 748-9720
District III
1000 Rio Brazos Road, Aztec, NM 87410
Phone: (505) 334-6178 Fax: (505) 334-6170
District IV
1220 S. St. Francis Dr., Santa Fe, NM 87505
Phone: (505) 476-3460 Fax: (505) 476-3462

State of New Mexico
Energy, Minerals & Natural Resources Department
OIL CONSERVATION DIVISION
1220 South St. Francis Dr.
Santa Fe, NM 87505

MAR 02 2020

Form C-102
Revised August 1, 2011
Submit one copy to appropriate
District Office

RECEIVED

☐ AMENDED REPORT

WELL LOCATION AND ACREAGE DEDICATION PLAT

1 API Number 30-025-46948		2 Pool Code 2209		3 Pool Name ANTELOPE RIDGE WEST; BONE SPRING, WEST	
4 Property Code 727260		5 Property Name IBEX 15/10 B3PA FED COM			6 Well Number 1H
7 OGRID NO. 14744		8 Operator Name MEWBOURNE OIL COMPANY			9 Elevation 3413'

10 Surface Location									
UL or lot no.	Section	Township	Range	Lot Idn	Feet from the	North/South line	Feet From the	East/West line	County
P	15	23S	34E		140	SOUTH	305	EAST	LEA

11 Bottom Hole Location If Different From Surface									
UL or lot no.	Section	Township	Range	Lot Idn	Feet from the	North/South line	Feet from the	East/West line	County
A	10	23S	34E		100	NORTH	600	EAST	LEA

12 Dedicated Acres 320	13 Joint or Infill	14 Consolidation Code	15 Order No.
----------------------------------	--------------------	-----------------------	--------------

No allowable will be assigned to this completion until all interest have been consolidated or a non-standard unit has been approved by the division.

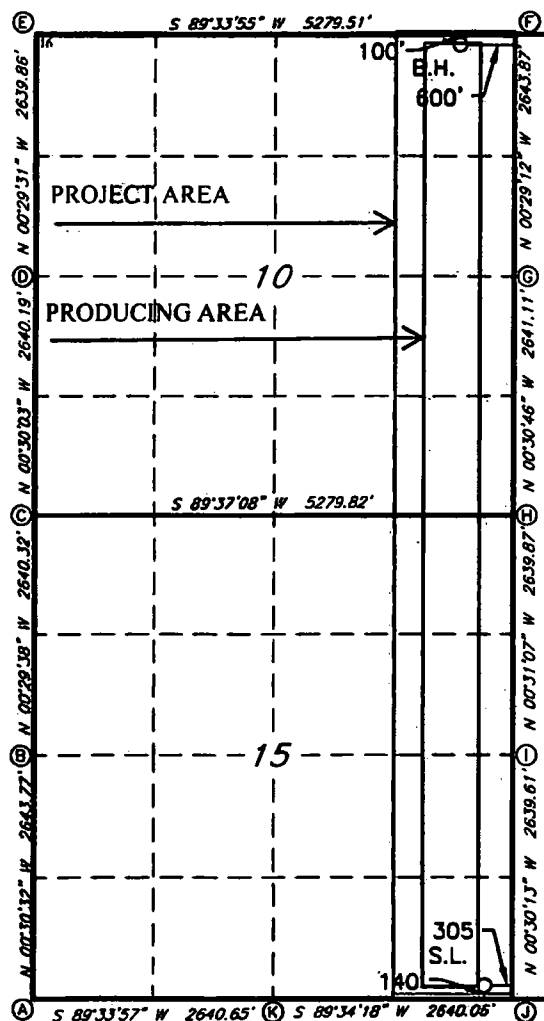

GEODETIC DATA
NAD 83 GRID - NM EAST

SURFACE LOCATION
N 473175.2 - E 814157.1
LAT: 32.2977443° N
LONG: 103.4503861° W

BOTTOM HOLE
N 483495.2 - E 813771.1
LAT: 32.3261181° N
LONG: 103.4513604° W

CORNER DATA
NAD 83 GRID - NM EAST

A: FOUND BRASS CAP "1913"
N 472997.8 - E 809183.6

B: FOUND BRASS CAP "1913"
N 475641.0 - E 809160.1

C: FOUND BRASS CAP "1913"
N 478280.8 - E 809137.4

D: FOUND BRASS CAP "1913"
N 480920.4 - E 809114.3

E: FOUND PK NAIL
N 483559.7 - E 809091.7

F: FOUND PK NAIL
N 483599.8 - E 814370.1

G: FOUND BRASS CAP "1913"
N 480956.4 - E 814392.6

H: FOUND BRASS CAP "1913"
N 478315.9 - E 814416.2

I: FOUND BRASS CAP "1913"
N 475676.6 - E 814440.1

J: FOUND BRASS CAP "1913"
N 473037.5 - E 814463.3

K: FOUND BRASS CAP "1913"
N 473017.8 - E 811823.8

17 OPERATOR CERTIFICATION
I hereby certify that the information contained herein is true and complete to the best of my knowledge and belief, and that this organization either owns a working interest or unleased mineral interest in the land including the proposed bottom hole location or has a right to drill this well at this location pursuant to a contract with an owner of such a mineral or working interest, or in a voluntary pooling agreement or a compulsory pooling order heretofore entered by the division.

Signature: **BRADLEY BISHOP** Date: **8-20-19**
Printed Name: **BRADLEY BISHOP**
Email Address: **BBISHOP@MEWBOURNE.COM**

18 SURVEYOR CERTIFICATION
I hereby certify that the well location shown on this plat was plotted from field notes of actual surveys made by me or under my supervision, and that the same is true and correct to the best of my belief.

Date of Survey: **08-05-2019**
Signature and Seal of Professional Surveyor: **ROBERT M. HOWETT**
Certificate Number: **19680**

Intent ☒ As Drilled ☐

API #

Operator Name: Mewbourne Oil Co.	Property Name: Ibex 15/10 B3PA Fed Com	Well Number 1H
-------------------------------------	---	-------------------

Kick Off Point (KOP)

UL P	Section 15	Township 23S	Range 34E	Lot	Feet 10	From N/S S	Feet 600	From E/W E	County Lea
Latitude 32.2973876					Longitude -103.4513413			NAD 83	

First Take Point (FTP)

UL P	Section 15	Township 23S	Range 34E	Lot	Feet 100	From N/S S	Feet 600	From E/W E	County Lea
Latitude 32.2976350					Longitude -103.4513415			NAD 83	

Last Take Point (LTP)

UL A	Section 10	Township 23S	Range 34E	Lot	Feet 100	From N/S N	Feet 600	From E/W E	County Lea
Latitude 32.3261181					Longitude -103.4513604			NAD 83	

Is this well the defining well for the Horizontal Spacing Unit? ☐ Y

Is this well an infill well? ☐ N

If infill is yes please provide API if available, Operator Name and well number for Defining well for Horizontal Spacing Unit.

API #

Operator Name:	Property Name:	Well Number
----------------	----------------	-------------

KZ 06/29/2018