

District I\*  
1625 N. French Dr., Hobbs, NM 88240  
District II  
1301 W. Grand Avenue, Artesia, NM 88210  
District III  
1000 Rio Brazos Road, Aztec, NM 87410  
District IV  
1220 S. St. Francis Dr., Santa Fe, NM 87505

State of New Mexico  
Energy Minerals and Natural Resources

Form C-144  
June 1, 2004

Oil Conservation Division  
1220 South St. Francis Dr.  
Santa Fe, NM 87505

For drilling and production facilities, submit to appropriate NMOCD District Office.  
For downstream facilities, submit to Santa Fe office

**Pit or Below-Grade Tank Registration or Closure**

Is pit or below-grade tank covered by a "general plan"? Yes  No

Type of action: Registration of a pit or below-grade tank  Closure of a pit or below-grade tank

Operator: Chevron USA (O-Grid #4323) Telephone: 505.394.3133 e-mail address: lduke@chevrontexaco.com		
Address: PO Box 1949 2401 Avenue O Eunice, New Mexico 88231		
Facility or well name: VM Henderson 20 API #: 30-025-37412 Unit Letter (UL): F Qtr/Qtr: SE1/4 NW1/4 Section: 30, T21S, R37E		
County: Lea Latitude: N 32°27'12.84" Longitude: W 103°12'21.83" NAD: 1927 <input type="checkbox"/> 1983 <input type="checkbox"/> WGS 84 <input checked="" type="checkbox"/>		
Surface Owner: Federal <input type="checkbox"/> State <input type="checkbox"/> Private <input checked="" type="checkbox"/> (Tom Kennann) Indian <input type="checkbox"/>		
<b>Pit</b>	<b>Below-grade tank</b>	
Type: Drilling <input checked="" type="checkbox"/> Production <input type="checkbox"/> Disposal <input type="checkbox"/> Workover <input type="checkbox"/> Emergency <input type="checkbox"/>	Volume:      bbl Type of fluid:	
Lined <input checked="" type="checkbox"/> Unlined <input type="checkbox"/>	Construction material:	
Liner type: Synthetic <input checked="" type="checkbox"/> Thickness <u>12</u> mil Clay <input type="checkbox"/>	Double-walled, with leak detection? Yes <input type="checkbox"/> If not, explain why not.	
Pit Volume: ~3,000 bbl		
Depth to ground water (vertical distance from bottom of pit to seasonal high water elevation of ground water.) ~108'bgs	Less than 50 feet	(20 points) <input type="checkbox"/>
	50 feet or more, but less than 100 feet	(10 points) <input type="checkbox"/>
	100 feet or more	( 0 points) <input checked="" type="checkbox"/>
Wellhead protection area: (Less than 200 feet from a private domestic water source, or less than 1000 feet from all other water sources.)	Yes	(20 points) <input checked="" type="checkbox"/>
	No	( 0 points) <input type="checkbox"/>
Distance to surface water: (horizontal distance to all wetlands, playas, irrigation canals, ditches, and perennial and ephemeral watercourses.)	Less than 200 feet	(20 points) <input type="checkbox"/>
	200 feet or more, but less than 1,000 feet	(10 points) <input type="checkbox"/>
	1,000 feet or more	( 0 points) <input checked="" type="checkbox"/>
<b>Ranking Score (Total Points)</b>		<b>20</b>

**If this is a pit closure:** (1) Attach a diagram of the facility showing the pit's relationship to other equipment and tanks. (2) Indicate disposal location: (check the onsite box if you are burying in place) onsite  offsite  If offsite, name of facility \_\_\_\_\_. (3) Attach a general description of remedial action taken including remediation start date and end date. (4) Groundwater encountered: No  Yes  If yes, show depth below ground surface \_\_\_\_\_ ft. and attach sample results. (5) Attach soil sample results and a diagram of sample locations and excavations.

Additional Comments: The pit has been closed consistent with the "ChevronTexaco Drilling and Reserve Pit Closure General Plan, December 2004" and the NMOCD Pit and Below-Grade Tank Guidelines, November 1, 2004 as promulgated under NMOCD Rule 50 (19.15.2.50 NMAC).

Pit Status: Liner intact  Liner punctured or torn

Method of Closure: In-Situ burial, (i.e. stiffen contents, fold over pit liner, install 20-mil liner, cover with 3 feet of clean soil.)

I hereby certify that the information above is true and complete to the best of my knowledge and belief. I further certify that the above-described pit or below-grade tank will be closed according to NMOCD guidelines , a general permit , or an (attached) alternative OCD-approved plan .

Date: 6/6/04 Printed Name/Title Jim Duke, Construction Representative Signature [Signature]

Your certification and NMOCD approval of this application/closure does not relieve the operator of liability should the contents of the pit or tank contaminate ground water or otherwise endanger public health or the environment. Nor does it relieve the operator of its responsibility for compliance with any other federal, state, or local laws and/or regulations.

Approval:  
Printed Name/Title LW JOHNSON - ENVIRO ENGR Signature [Signature] Date: 6.20.04



**ENVIRONMENTAL PLUS, INC.**  
CONSULTING AND REMEDIAL CONSTRUCTION

24 May 2006

Mr. Larry Johnson, Environmental Engineer  
New Mexico Energy, Minerals and Natural Resources Department  
Oil Conservation Division Environmental Bureau  
1625 North French  
Hobbs, New Mexico 88240



Re: Final C-144  
Chevron USA (O-Grid #4323)  
VM Henderson 20 (Ref. #200071)  
UL-F, Section 30, Township 21 South, Range 37 East

Dear Mr. Johnson:

Environmental Plus, Inc., on behalf of Chevron USA (Chevron) submits the enclosed New Mexico Oil Conservation Division (NMOCD) form C-144 and supporting information. Chevron has closed the drill pit at the above-referenced well site in accordance with the NMOCD Pit and Below-Grade Tank Guidelines, November 1, 2004 and the "ChevronTexaco Drilling and Reserve Pit Closure General Plan, December 2004." Please direct all official communications to:

Chevron USA  
Jim Duke, Construction Representative  
PO Box 1949  
Eunice, New Mexico 88231  
Telephone: 505.394.3133  
Email: [lduk@chevrontexaco.com](mailto:lduk@chevrontexaco.com)

Should you have any questions or concerns, please call Iain Olness or myself at (505) 394-3481. Mr. Jim Duke can be contacted at (505) 394-3133 or via e-mail at [lduk@chevron.com](mailto:lduk@chevron.com).

Sincerely,

ENVIRONMENTAL PLUS, INC.

Pat McCasland  
Senior Consultant

ENVIRONMENTAL PLUS, INC.



**ENVIRONMENTAL PLUS, INC.**  
CONSULTING AND REMEDIAL CONSTRUCTION

---

cc: Jim Duke, Chevron USA  
Nathan Mouser, Chevron USA  
Tom Kennann, Landowner  
File

Enclosures: Topographical Map  
Site Location Map  
Site Map  
Groundwater Map  
Well Data Table  
Photographs  
NMOCD Form C-144

ENVIRONMENTAL PLUS, INC.

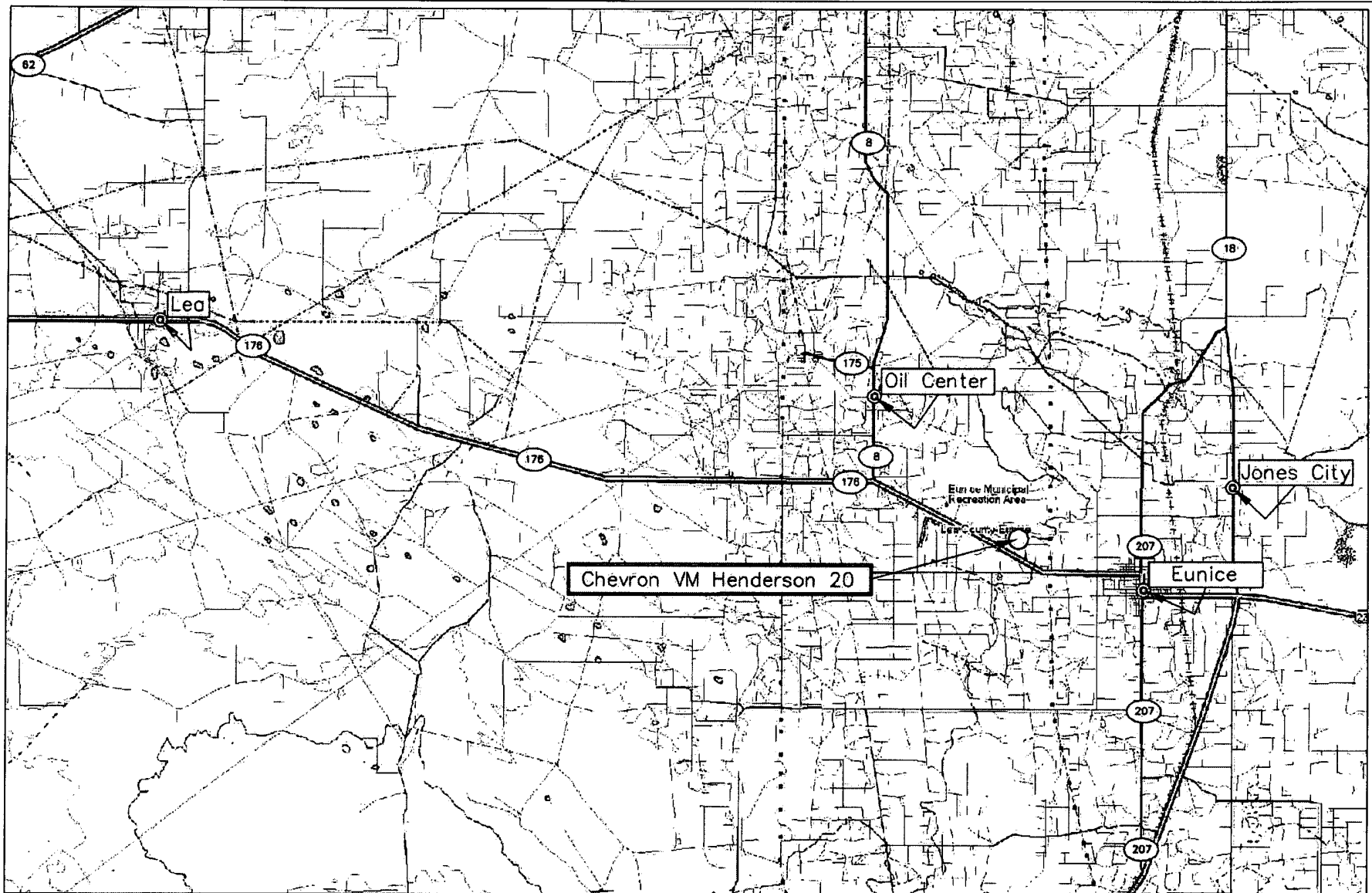

<p>Figure 1 Area Map Chevron Corporation VM Henderson 20</p>	<p>Lea County, New Mexico SE 1/4 of the NW 1/4, Sec. 30, T21S, R37E N 32° 27' 12.84" W 103° 12' 21.82" Elevation: 3,500 feet amsl</p>	<p>DWG By: Daniel Dominguez February 2006</p>	<p>REVISED:  SHEET 1 of 1</p>	
--------------------------------------------------------------------------	---------------------------------------------------------------------------------------------------------------------------------------------------	---------------------------------------------------	-------------------------------------------	--

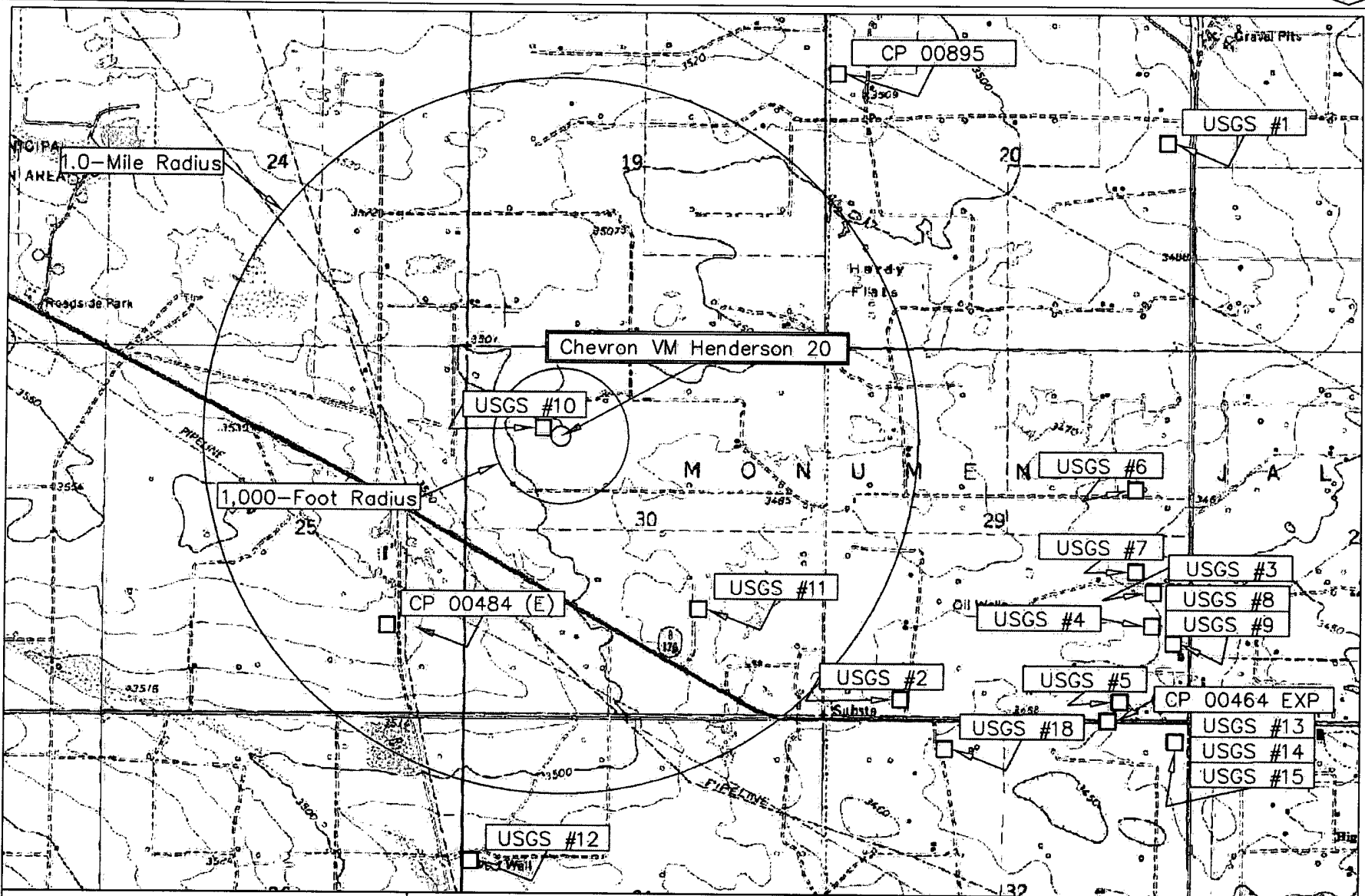
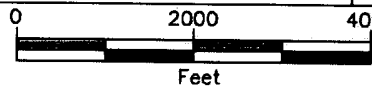

Figure 2  
 Site Location Map  
 Chevron Corporation  
 VM Henderson 20

Lea County, New Mexico  
 SE 1/4 of the NW 1/4, Sec. 30, T21S, R37E  
 N 32° 27' 12.84" W 103° 12' 21.82"  
 Elevation: 3,500 feet amsl

DWG By: Daniel Dominguez  
 February 2006

REVISED:



SHEET  
 1 of 1

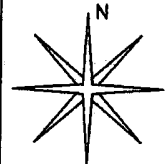

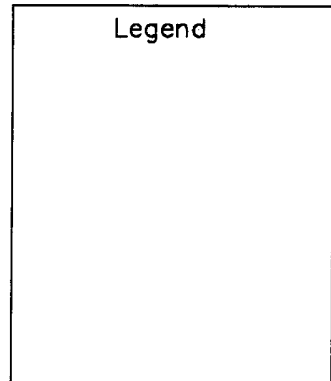
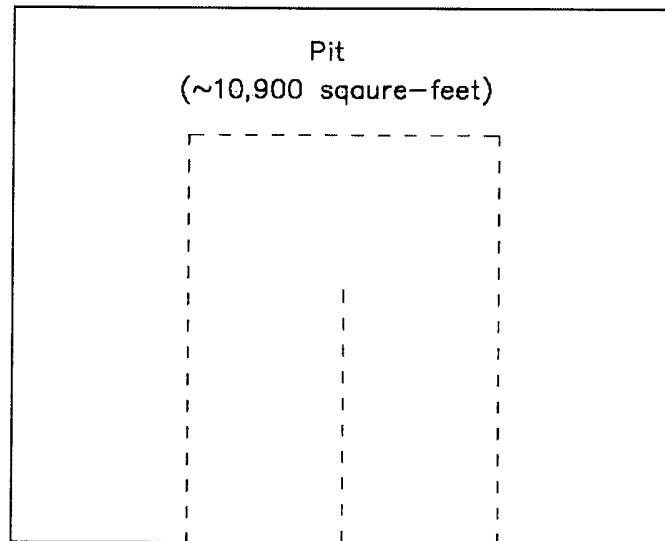
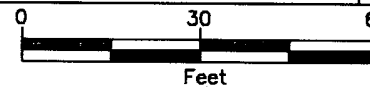

Figure 3  
Site Map  
Chevron Corporation  
VM Henderson 20

Lea County, New Mexico  
SE 1/4 of the NW 1/4, Sec. 30, T21S, R37E  
N 32° 27' 12.84" W 103° 12' 21.82"  
Elevation: 3,500 feet amsl

DWG By: Daniel Dominguez  
February 2006

REVISED:



SHEET  
1 of 1

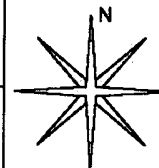

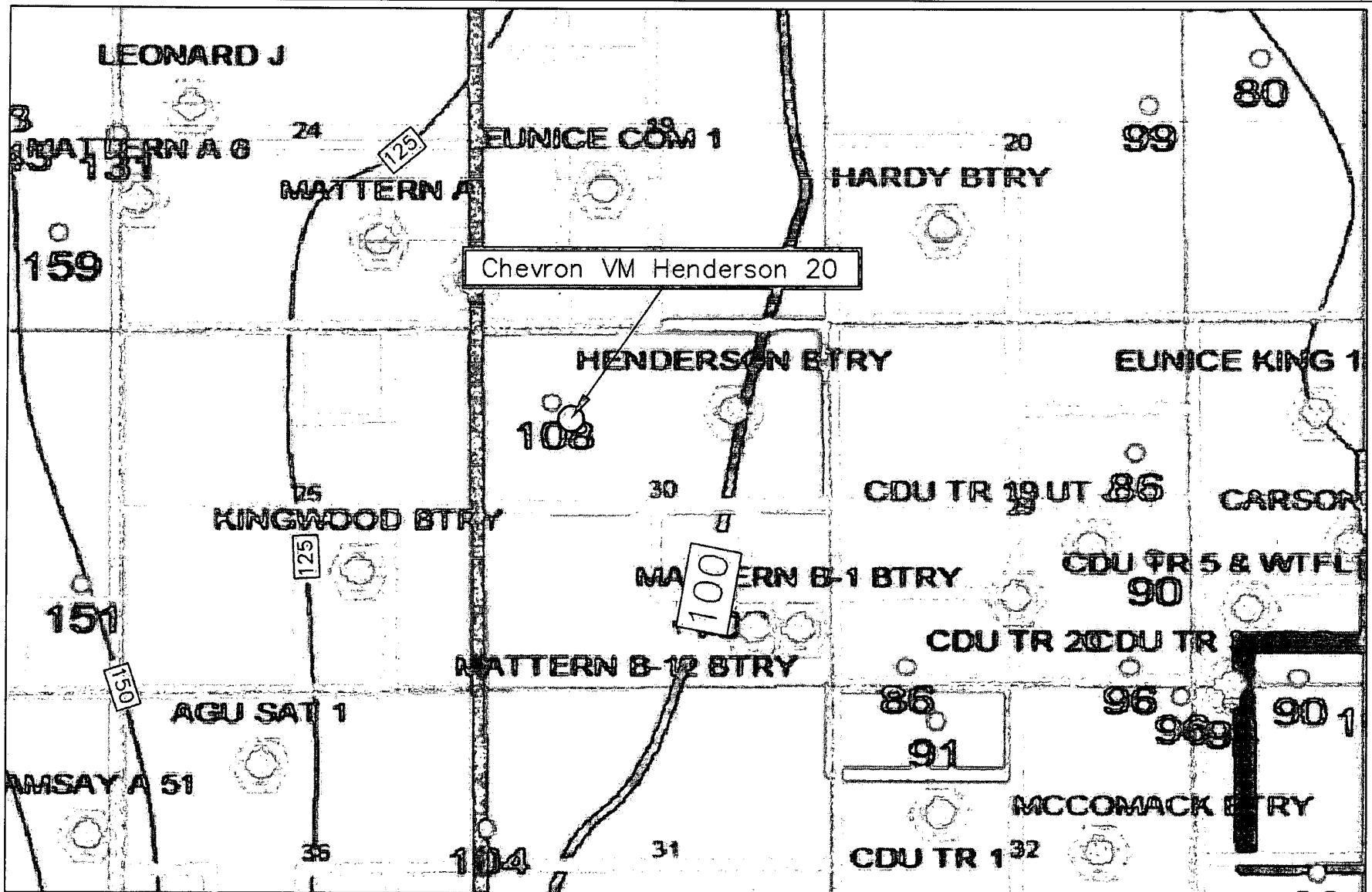
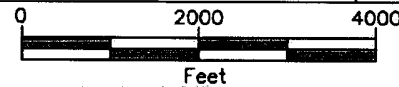

Figure 4  
Groundwater Map  
Chevron Corporation  
VM Henderson 20

Lea County, New Mexico  
SE 1/4 of the NW 1/4, Sec. 30, T21S, R37E  
N 32° 27' 12.84" W 103° 12' 21.82"  
Elevation: 3,500 feet amsl

DWG By: Daniel Dominguez  
February 2006

REVISED:



SHEET  
1 of 1

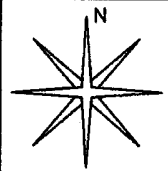



**TABLE 1**  
**WELL INFORMATION REPORT\***  
**Chevron VM Henderson 20 - Ref #200071**

Well Number	Diverston <sup>A</sup>	Owner	Use	Twsp	Rng	Sec q q q	Latitude	Longitude	Date Measured	Surface Elevation <sup>B</sup>	Depth to Water (ft bgs)
CP 00464 EXP	0	EUGENE WINKER	DOM	21S	37E	29 4 4 4	N32° 26' 32.94"	W103° 10' 49.08"		3,466	
CP 00895	3	JOE R. SIMS	DOM	21S	37E	20 1 1	N32° 28' 4.45"	W103° 11' 35.34"	17-Mar-00	3,517	
CP 00484 (E)	3	NORTHERN NATURAL GAS CO.	SAN	21S	36E	25 4 2	N32° 26' 46.43"	W103° 10' 41.80"	20-Jul-70	3,540	148
USGS #1				21S	37E	20 2 4 4			06-Mar-96		98.69
USGS #2				21S	37E	29 3 3 4			10/29/1965		85.86
USGS #3				21S	37E	29 4 2 4			11/30/1965		99.82
USGS #4				21S	37E	29 4 4 2			21-Jan-76		98.76
USGS #5				21S	37E	29 4 4 3			21-Jan-76		96.19
USGS #6				21S	37E	29 2 4 1			06-Mar-96		85.83
USGS #7				21S	37E	29 4 2 4			17-Apr-91		89.98
USGS #8				21S	37E	29 4 4 2			29-Oct-65		106.93
USGS #9				21S	37E	29 4 4 2			21-Jan-76		93.93
USGS #10				21S	37E	30 1 1 4			17-Apr-91		107.82
USGS #11				21S	37E	30 4 1 4			08-Feb-96		99.85
USGS #12				21S	37E	31 1 3 3			16-Apr-91		104.44
USGS #13				21S	37E	32 2 2 2			07-Mar-86		95.62
USGS #14				21S	37E	32 2 2 2			22-Jan-76		98.08
USGS #15				21S	37E	32 2 2 2			07-Mar-86		94.99
USGS #18				21S	37E	32 1 2 1			15-Jan-54		90.67
USGS #16				21S	37E	32 4 2 2			22-Jan-76		99.15
USGS #17				21S	37E	32 4 2 4			22-Jan-76		91.89
USGS #19				21S	37E	32 4 2 2			22-Jan-76		99.29

\* = Data obtained from the New Mexico Office of the State Engineer Website ([http://iwaters.ose.state.nm.us:7001/WATERS/wr\\_RegisServlet1](http://iwaters.ose.state.nm.us:7001/WATERS/wr_RegisServlet1)) and USGS Database.

<sup>A</sup> = in acre feet per annum

<sup>B</sup> = Interpolated from USGS Topographical Map

SAN = Sanitary in conjunction with commercial use

DOM = Domestic one household

(quarters are 1=NW, 2=NE, 3=SW, 4=SE)

(quarters are biggest to smallest - X Y are in Feet - UTM are in Meters)

Shaded area indicates wells not shown on Figure 2



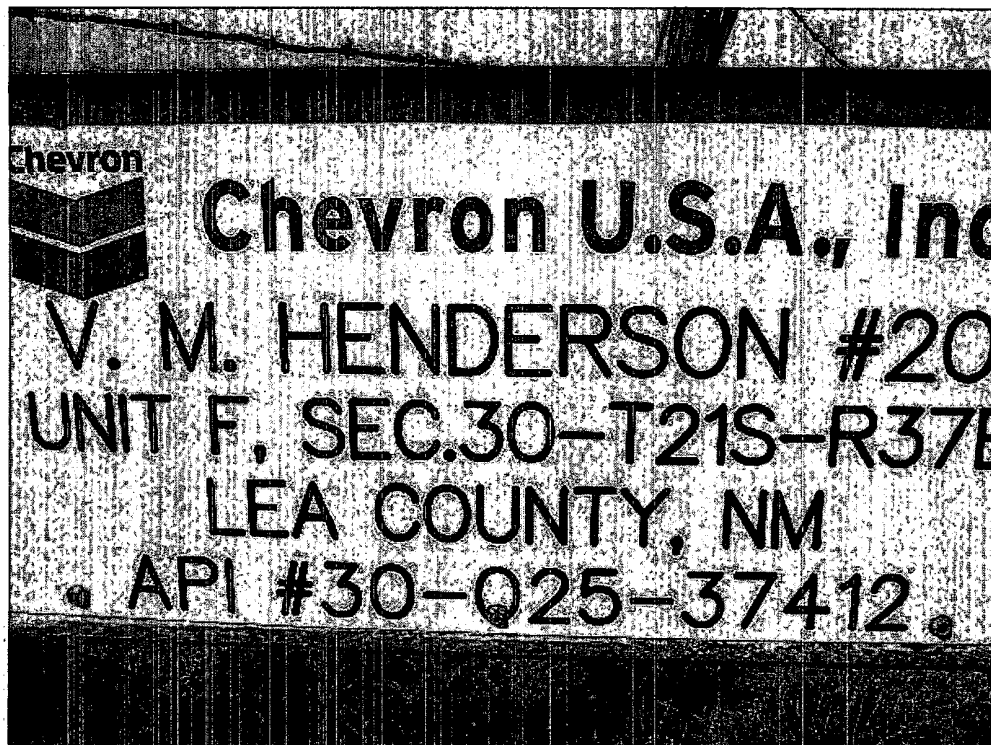

Photograph #1- Lease sign.

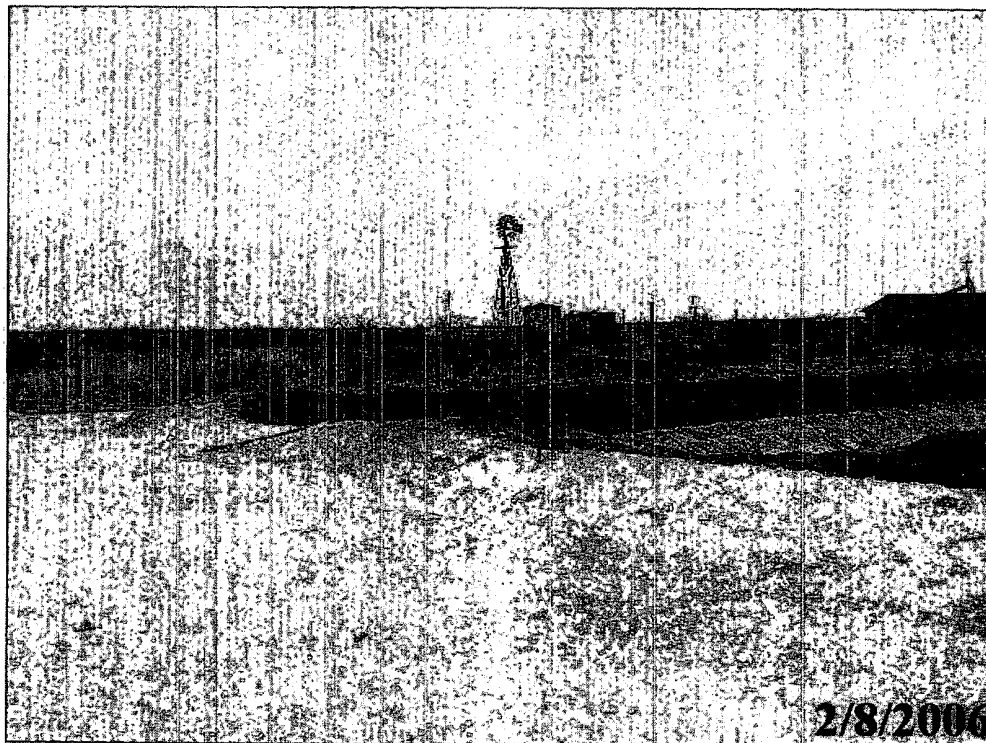

Photograph #2 - Pit and berm looking westerly.



Photograph #3 - Pit and berm looking northeasterly.



Photograph #4 - Pit and berm looking northeasterly.

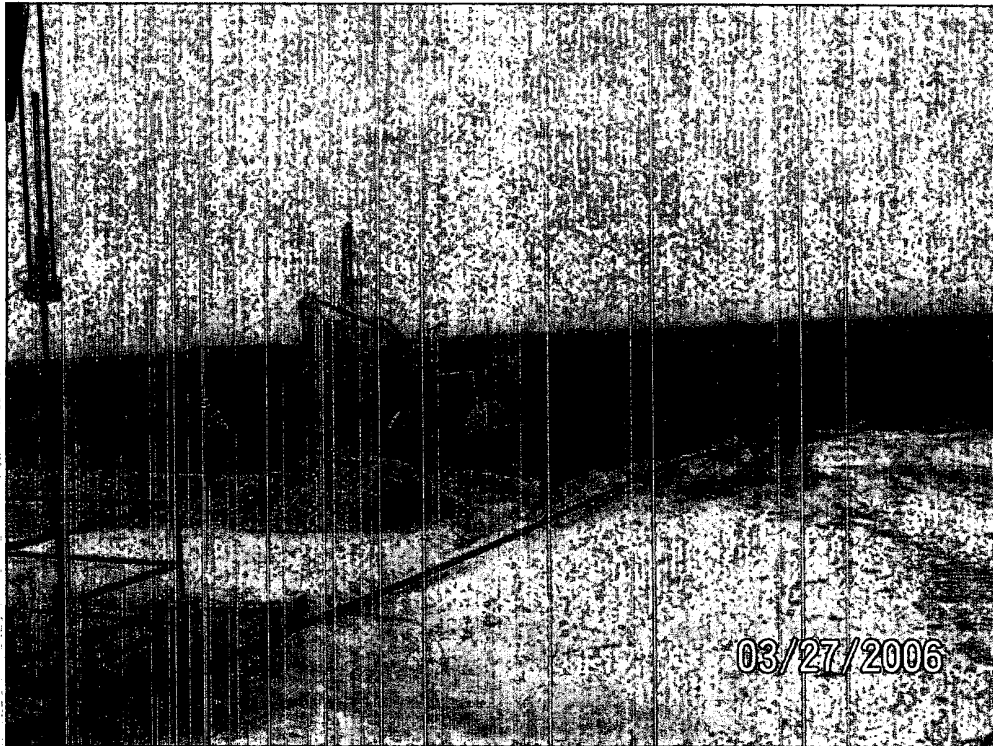

Photograph #5 – Stiffening of pit contents.



Photograph #6 – Stiffening of pit contents.



Photograph #7 – Liner covering pit contents.

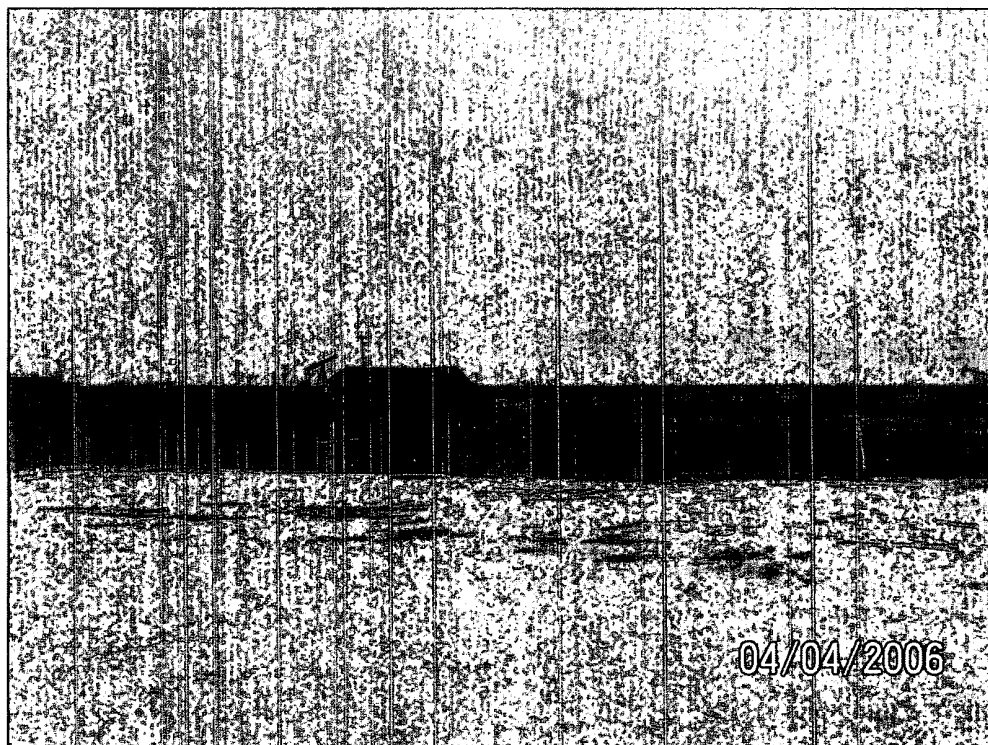

Photograph #8 – Closed pit.