

District I
1625 N. French Dr., Hobbs, NM 88240
District II
1301 W. Grand Avenue, Artesia, NM 88210
District III
1000 Rio Brazos Road, Aztec, NM 87410
District IV
1220 S. St. Francis Dr., Santa Fe, NM 87505

State of New Mexico
Energy Minerals and Natural Resources
Oil Conservation Division
1220 South St. Francis Dr.
Santa Fe, NM 87505

Form C-101
June 16, 2008

Submit to appropriate District Office

AMENDED REPORT

HOBBS OGD
MAY 23 2011
RECEIVED

APPLICATION FOR PERMIT TO DRILL, RE-ENTER, DEEPEN, PLUGBACK, OR ADD A ZONE

¹ Operator Name and Address ConocoPhillips Company 3300 N "A" St, Bldg 6 Midland, TX 79705		² OGRID Number 217817
³ Property Code 38238		⁴ Property Name Tourmaline State
⁵ Proposed Pool 1 Maljamar; Yeso, West		⁶ Well No. 3
⁷ Surface Location		

UL or lot no.	Section	Township	Range	Lot Idn	Feet from the	North/South line	Feet from the	East/West line	County
O	16	17S	32E		608	South	2304	East	Lea

⁸ Proposed Bottom Hole Location If Different From Surface

UL or lot no.	Section	Township	Range	Lot Idn	Feet from the	North/South line	Feet from the	East/West line	County

Additional Well Information

¹¹ Work Type Code N	¹² Well Type Code O	¹³ Cable/Rotary R	¹⁴ Lease Type Code S	¹⁵ Ground Level Elevation 4023'
¹⁶ Multiple	¹⁷ Proposed Depth 7200'	¹⁸ Formation Yeso, West	¹⁹ Contractor Precision 194	²⁰ Spud Date 07/20/2011



²¹ Proposed Casing and Cement Program

Hole Size	Casing Size	Casing weight/foot	Setting Depth	Sacks of Cement	Estimated TOC
12.25"	8.625"	24#	850'	400 sx C	surface
7.875"	5.5"	17#	7190'	1000 sx C	surface

²² Describe the proposed program. If this application is to DEEPEN or PLUG BACK, give the data on the present productive zone and proposed new productive zone. Describe the blowout prevention program, if any. Use additional sheets if necessary.

See attached drilling program for Mud and BOP information

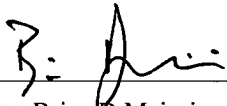
**Permit Expires 2 Years From Approval
Date Unless Drilling Underway**

²³ I hereby certify that the information given above is true and complete to the best of my knowledge and belief. Signature:  Printed name: Brian D Maiorino Title: Regulatory Specialist E-mail Address: brian.d.maiorino@conocophilips.com Date: 05/18/2011	OIL CONSERVATION DIVISION	
	Approved by:  Title: PETROLEUM ENGINEER Approval Date: MAY 24 2011	Expiration Date:
Phone: (432)688-6913	Conditions of Approval Attached <input type="checkbox"/>	

MAY 26 2011

DISTRICT I
1625 N. French Dr., Hobbs, NM 88240

DISTRICT II
1301 W. Grand Avenue, Artesia, NM 88210

DISTRICT III
1000 Rio Brazos Rd., Asteo, NM 87410

DISTRICT IV
1220 S. St. Francis Dr., Santa Fe, NM 87505

State of New Mexico

Energy, Minerals & Natural Resources Department

HOBBS OGD OIL CONSERVATION DIVISION

1220 South St. Frances Dr.
Santa Fe, NM 87505

Form C-102

Revised October 12, 2005

Submit to Appropriate District Office

State Lease - 4 Copies

Fee Lease - 3 Copies

MAY 23 2011

RECEIVED

AMENDED REPORT

WELL LOCATION AND ACREAGE DEDICATION PLAT

API Number 30-025-40139	Pool Code 44500	Pool Name Maljamaa, West
Property Code 38238	Property Name TOURMALINE STATE	Well Number 3
OGRID No. 217817	Operator Name CONOCOPHILLIPS	Elevation 4023'

Surface Location

UL or lot No.	Section	Township	Range	Lot Idn	Feet from the	North/South line	Feet from the	East/West line	County
0	16	17 S	32 E		608	SOUTH	2304	EAST	LEA

Bottom Hole Location If Different From Surface

UL or lot No.	Section	Township	Range	Lot Idn	Feet from the	North/South line	Feet from the	East/West line	County

Dedicated Acres 40	Joint or Infill	Consolidation Code	Order No.
-----------------------	-----------------	--------------------	-----------

NO ALLOWABLE WILL BE ASSIGNED TO THIS COMPLETION UNTIL ALL INTERESTS HAVE BEEN CONSOLIDATED OR A NON-STANDARD UNIT HAS BEEN APPROVED BY THE DIVISION

NOTE:

1) Plane Coordinates shown hereon are Transverse Mercator Grid and Conform to the "New Mexico Coordinate System", New Mexico East Zone, North American Datum of 1927, Distances shown hereon are mean horizontal surface values.

OPERATOR CERTIFICATION

I hereby certify the the information contained herein is true and complete to the best of my knowledge and belief, and that this organization either owns a working interest or unleased mineral interest in the land including the proposed bottom hole location or has a right to drill this well at this location pursuant to a contract with an owner of such a mineral or working interest, or to a voluntary pooling agreement or a compulsory pooling order heretofore entered by the division.

Signature: B. J. ... Date: 5/18/11

Printed Name: Brian D. Majorino

Plane Coordinates
X = 673,087.8
Y = 665,739.1

SURVEYOR CERTIFICATION

I hereby certify that the well location shown on this plat was plotted from field notes of actual surveys made by me or under my supervision and that the same is true and correct to the best of my belief.

Date of Survey: April 15, 2011

Signature & Seal of Professional Surveyor: MACON McDONALD

W.O. Num. 2011-0535

Certificate No. MACON McDONALD 12185

7
Tourmaline # 3

15. Proposed Depth = 7200' MD RKB

19. Proposed Casing and Cement Program						
Type	Hole Size (inches)	Casing OD (inches)	Casing Wt (lb/ft)	Setting Depth (feet)	Sacks of Cement	Estimated TOC (feet)
Surface	12.25	8.625	24	850	400	0
Prod	7.875	5.5	17	7190	1000	0

Casing and Cement Program: Additional Comments
Fresh Water and Fresh Water Mud will be used for drilling the surface hole.
Brine and Brine Based Mud will be used for drilling the production hole.

Proposed Blowout Prevention Program			
Type	Working Pressure	Test Pressure	Manufacturer
Annular	2000	1000	
Blind Ram	2000	2000	
Pipe Ram	2000	2000	

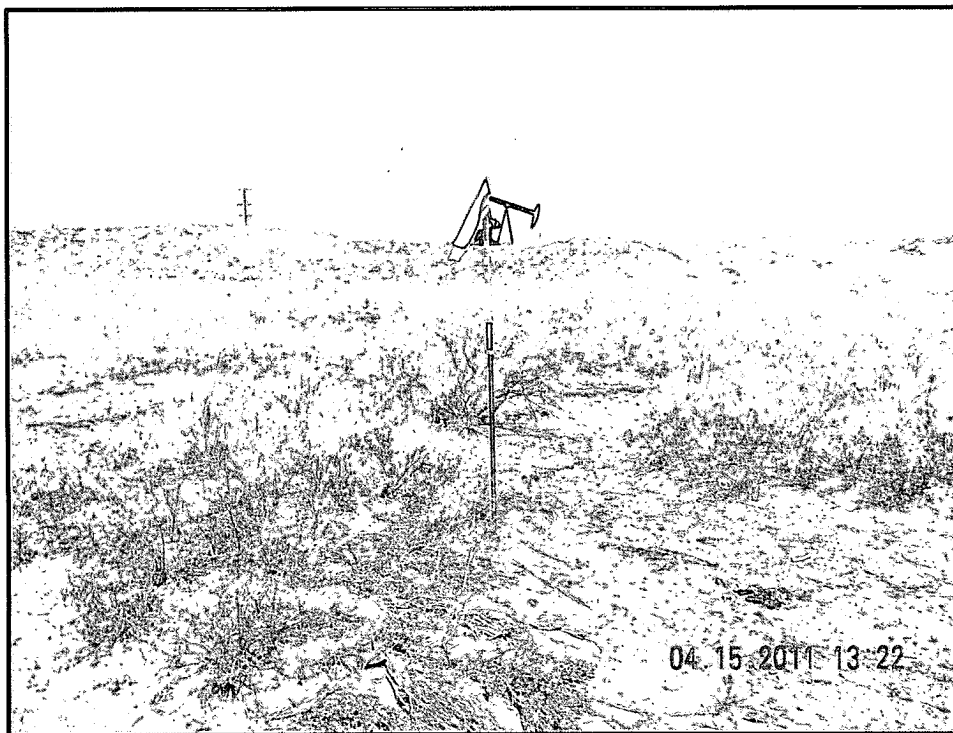

NORTHERLY VIEW TO LOCATION STAKE

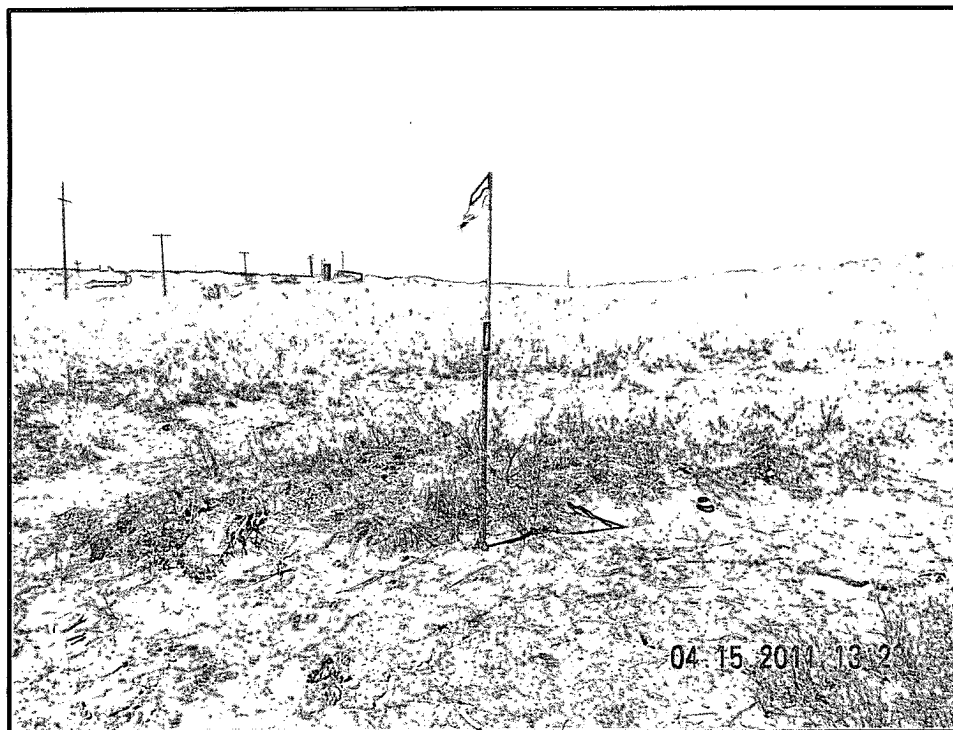

WESTERLY VIEW TO LOCATION STAKE

ConocoPhillips

TOURMALINE STATE #3

Located 608' FSL & 2304' FEL, Section 16
Township 17 South, Range 32 East, N.M.P.M.
Lea County, New Mexico

WEST
COMPANY
of Midland, Inc.

110 W. LOUISIANA, STE. 110
MIDLAND TEXAS, 79701
(432) 687-0865 - (432) 687-0868 FAX

Drawn By: KHY

Date: May 3, 2011

SECTION 16, TOWNSHIP 17 SOUTH, RANGE 32 EAST, N.M.P.M.

LEA COUNTY

NEW MEXICO

THIS IS NOT A BOUNDARY SURVEY
 Apparent property corners and property lines, if shown,
 are for information only.

L-2011-0535-A

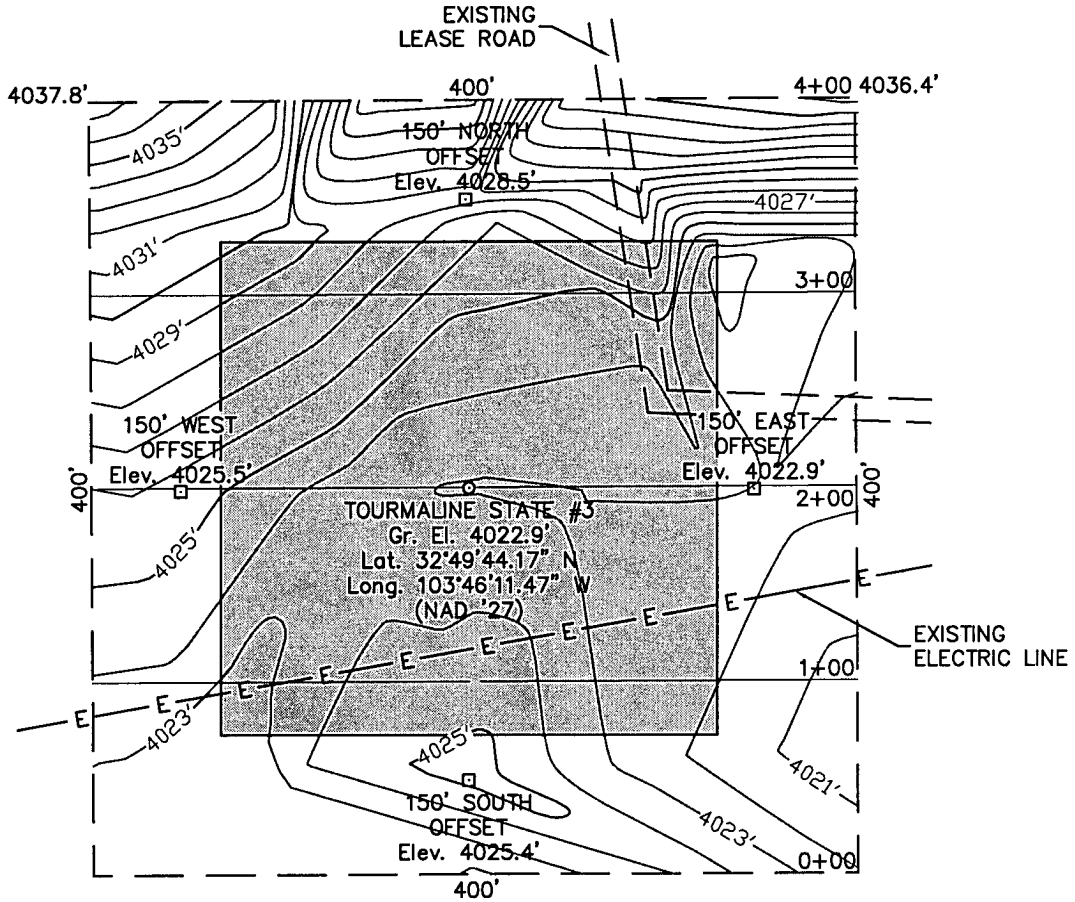

DRIVING DIRECTIONS

FROM THE INTERSECTION OF HIGHWAY 82 AND COUNTY ROAD 126 IN MALJAMAR, NM. GO SOUTH ON SAID COUNTY ROAD 126 2.0 MILES TO A LEASE ROAD ON WEST (RIGHT) SIDE OF ROAD, THEN GO WEST 0.1 MILE, THEN GO NORTHWEST (RIGHT) 0.5 MILE, THEN GO WEST (LEFT) 0.5 MILE, THEN GO NORTH (RIGHT) 0.4 MILE TO THE PROPOSED LOCATION.

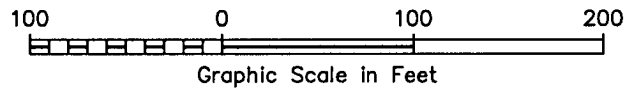

I HEREBY CERTIFY THAT THIS PLAT WAS MADE FROM AN ACTUAL SURVEY MADE BY ME OR UNDER MY DIRECT SUPERVISION AND THAT THE SAME IS TRUE AND CORRECT TO THE BEST OF MY KNOWLEDGE AND BELIEF.

Macon McDonald

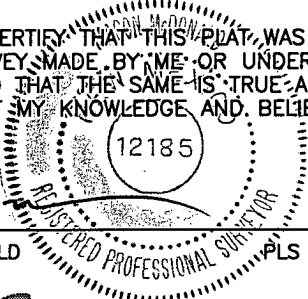

MACON McDONALD PLS NO. 12185



110 W. LOUISIANA, STE. 110
 MIDLAND TEXAS, 79701
 (432) 687-0865 - (432) 687-0868 FAX

ConocoPhillips

Topographic Map

TOURMALINE STATE #3

Located 608' FSL & 2304' FEL, Section 16
 Township 17 South, Range 32 East, N.M.P.M.
 Lea County, New Mexico

Drawn By: KHY	Date: May 6, 2011
Scale: 1" = 100'	Field Book: 518 / 8-10
Sheet 1 of 3	Quadrangle: Maljamar
W.O. No: 2011-0535	Dwg. No.: L-2011-0535-A

SECTION 16, TOWNSHIP 17 SOUTH, RANGE 32 EAST, N.M.P.M.

LEA COUNTY

NEW MEXICO

THIS IS NOT A BOUNDARY SURVEY
 Apparent property corners and property lines, if shown,
 are for information only.

L-2011-0535-B

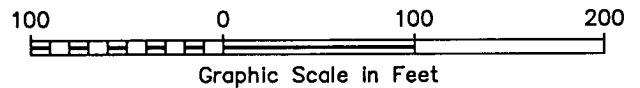
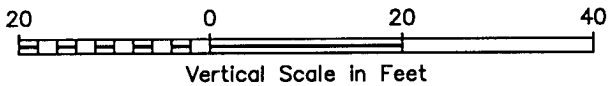
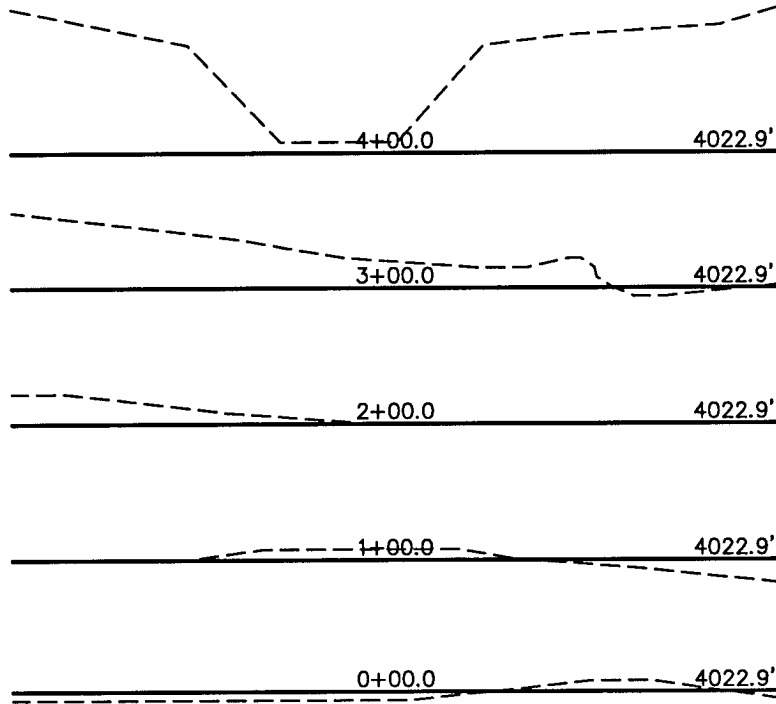

I HEREBY CERTIFY THAT THIS PLAT WAS MADE FROM AN ACTUAL SURVEY MADE BY ME OR UNDER MY DIRECT SUPERVISION AND THAT THE SAME IS TRUE AND CORRECT TO THE BEST OF MY KNOWLEDGE AND BELIEF.

[Signature]

MACON McDONALD

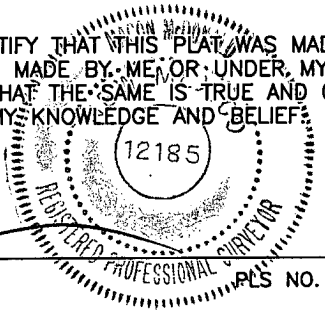

PLS NO. 12185



110 W. LOUISIANA, STE. 110
 MIDLAND TEXAS, 79701
 (432) 687-0865 - (432) 687-0868 FAX

ConocoPhillips	
Topographic Map	
TOURMALINE STATE #3	
Located 608' FSL & 2304' FEL, Section 16 Township 17 South, Range 32 East, N.M.P.M. Lea County, New Mexico	
Drawn By: KHY	Date: May 3, 2011
Scale: 1" = 100'	Field Book: 518 / 8-10
Sheet 2 of 3	Quadrangle: Maljamar
W.O. No: 2011-0535	Dwg. No.: L-2011-0535-B

SECTION 16, TOWNSHIP 17 SOUTH, RANGE 32 EAST, N.M.P.M.

LEA COUNTY

THIS IS NOT A BOUNDARY SURVEY
 Apparent property corners and property lines, if shown,
 are for information only.

NEW MEXICO

L-2011-0535-C

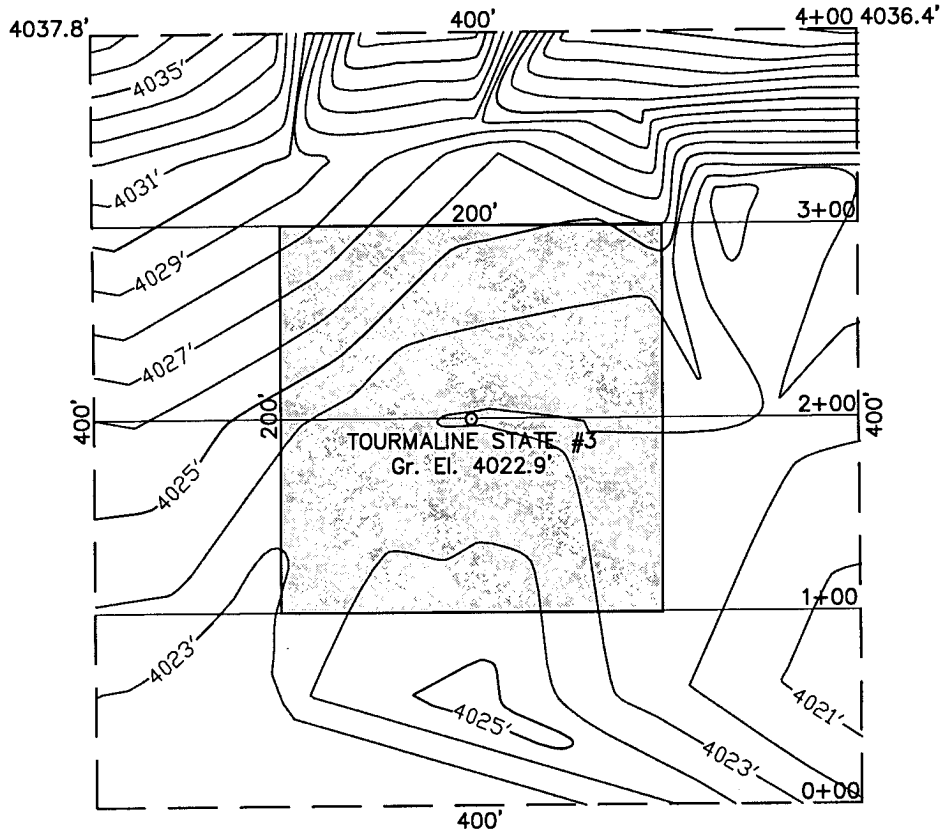

INTERIM RECLAMATION



I HEREBY CERTIFY THAT THIS PLAT WAS MADE FROM AN ACTUAL SURVEY MADE BY ME OR UNDER MY DIRECT SUPERVISION AND THAT THE SAME IS TRUE AND CORRECT TO THE BEST OF MY KNOWLEDGE AND BELIEF.

[Signature]

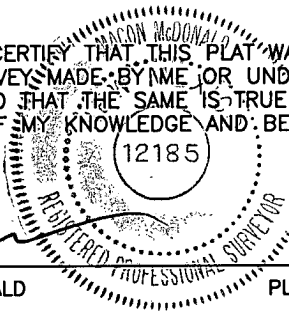

MACON McDONALD

PLS NO. 12185



110 W. LOUISIANA, STE. 110
 MIDLAND TEXAS, 79701
 (432) 687-0865 - (432) 687-0868 FAX

ConocoPhillips	
Topographic Map	
TOURMALINE STATE #3	
Located 608' FSL & 2304' FEL, Section 16 Township 17 South, Range 32 East, N.M.P.M. Lea County, New Mexico	
Drawn By: KHY	Date: May 3, 2011
Scale: 1" = 100'	Field Book: 518 / 8-10
Sheet 3 of 3	Quadrangle: Maljamar
W.O. No: 2011-0535	Dwg. No.: L-2011-0535-C

LOCATION VERIFICATION MAP

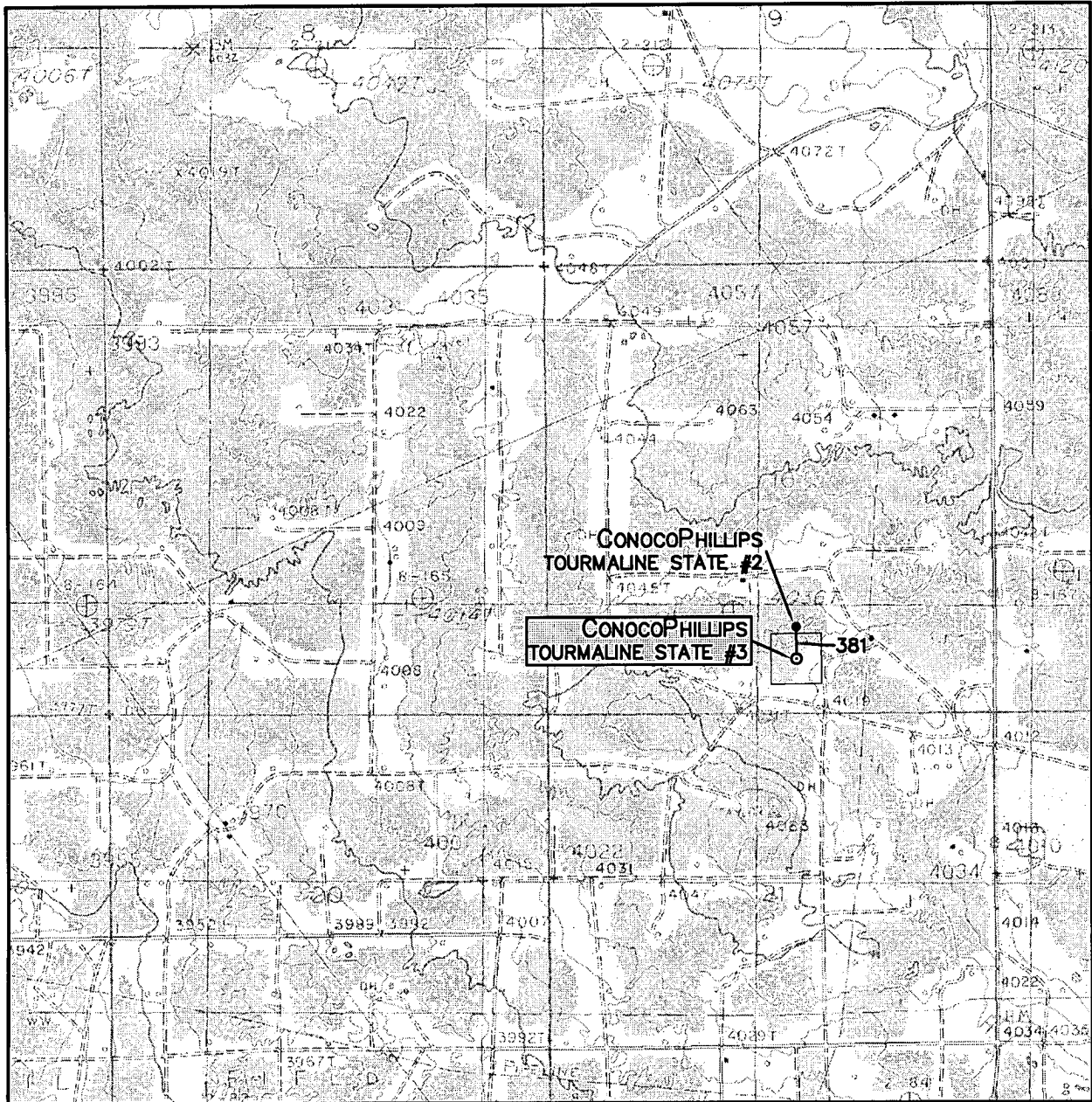

SCALE: 1" = 2000'

CONTOUR INTERVAL:
MALJAMAR - 10'

SEC. 16 TWP. 17-S RGE. 32-E

SURVEY N.M.P.M.

COUNTY LEA

DESCRIPTION 608' FSL & 2304' FEL

ELEVATION 4023'

OPERATOR CONOCOPHILLIPS

LEASE TOURMALINE STATE

U.S.G.S. TOPOGRAPHIC MAP
MALJAMAR



110 W. LOUISIANA, STE. 110
MIDLAND TEXAS, 79701
(432) 687-0865 - (432) 687-0868 FAX

VICINITY MAP

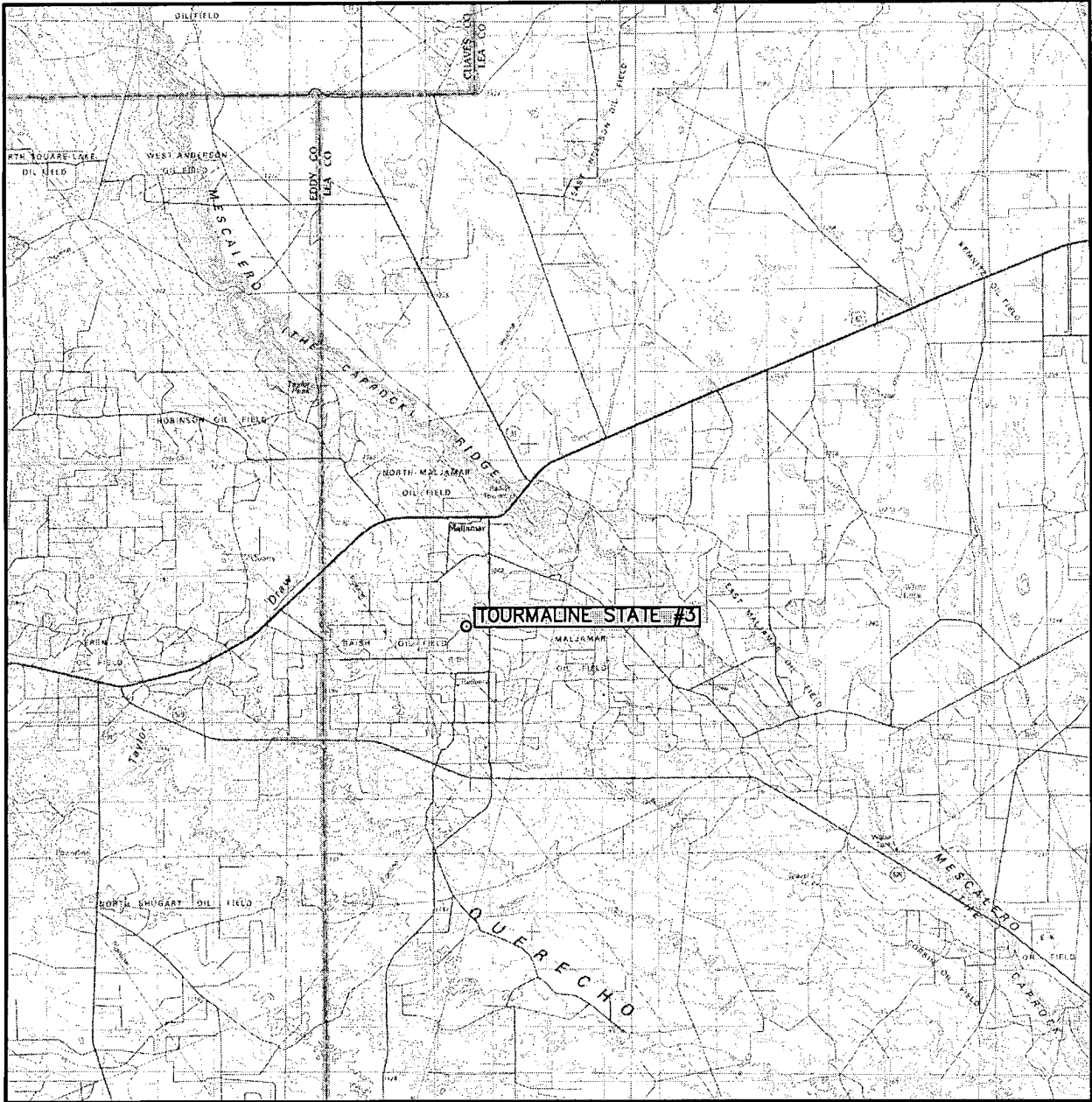

SCALE: 1" = 3 MILES

SEC. 16 TWP. 17-S RGE. 32-E

SURVEY N.M.P.M.

COUNTY LEA

DESCRIPTION 608' FSL & 2304' FEL

ELEVATION 4023'

OPERATOR CONOCOPHILLIPS

LEASE TOURMALINE STATE



**WEST
COMPANY**
of Midland, Inc.

110 W. LOUISIANA, STE. 110
MIDLAND TEXAS, 79701
(432) 687-0865 - (432) 687-0868 FAX