

R 37 E

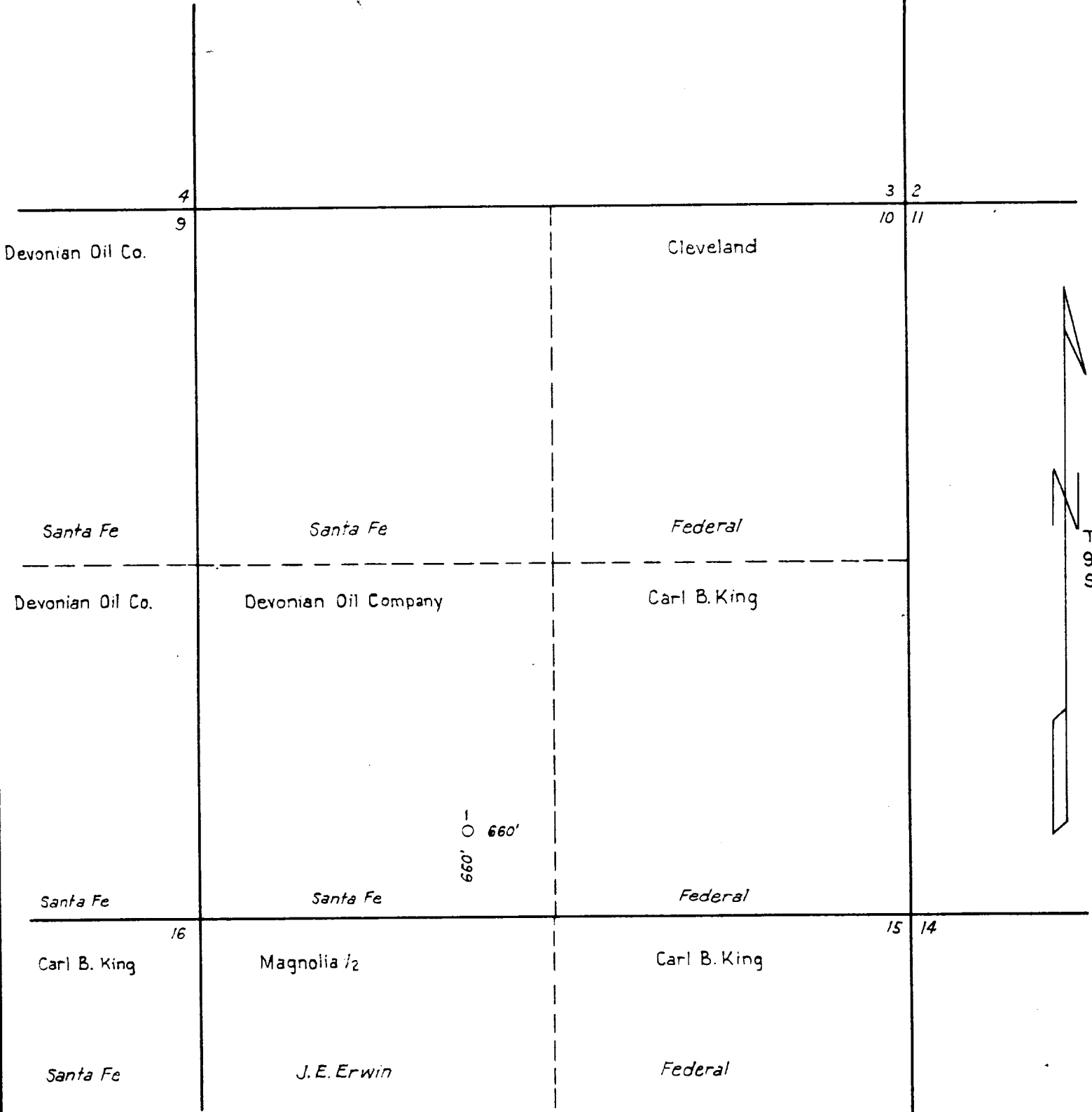

I, Clifford C. Cool, certify that this survey was made by me on the ground and that this plat is true and correct.  
August 1, 1947.

*Clifford C. Cool*  
 Licensed State Land Surveyor  
 of Midland County, Texas.

COOL & STUDDERT

LOCATION PLAT  
 DEVONIAN OIL COMPANY  
 SANTA FE LEASE  
 SW 1/4, SEC. 10  
 TWP. 9-S, RNG. 37-E  
 LEA COUNTY, N.M.  
 Scale: 1"=1000'

