

NEW MEXICO OIL CONSERVATION COMMISSION
WELL LOCATION AND ACREAGE DEDICATION PLAT

Form O-112
Supersedes O-124
Effective 1-1-65

All distances must be from the outer boundaries of the Section
LANDS OFFICE, O. O. O.

CHARLES B. READ		JUL 17 11 39 AM '68		LEA	
P	19	9 SOUTH	34 EAST	LEA	
554	SOUTH	554	EAST	160 acres	
4297.6	Bough "C"	Undesignated			

- Outline the acreage dedicated to the subject well by colored pencil or hatchure marks on the plat below.
- If more than one lease is dedicated to the well, outline each and identify the ownership interest (both as to working interest and royalty).

If more than one lease of different ownership is dedicated to the well, have the interests of all owners been consolidated by communitization, unitization, force-pooling, etc?

Yes No If answer is "yes," type of consolidation _____

If answer is "No," list the owners and tract descriptions which have actually been consolidated (if so, reverse side of this form if necessary): _____

What water will be assigned to the well until all interests have been consolidated by communitization, unitization, force-pooling, or otherwise (or until a non-standard unit, eliminating such interests, has been approved by the Commission)? _____

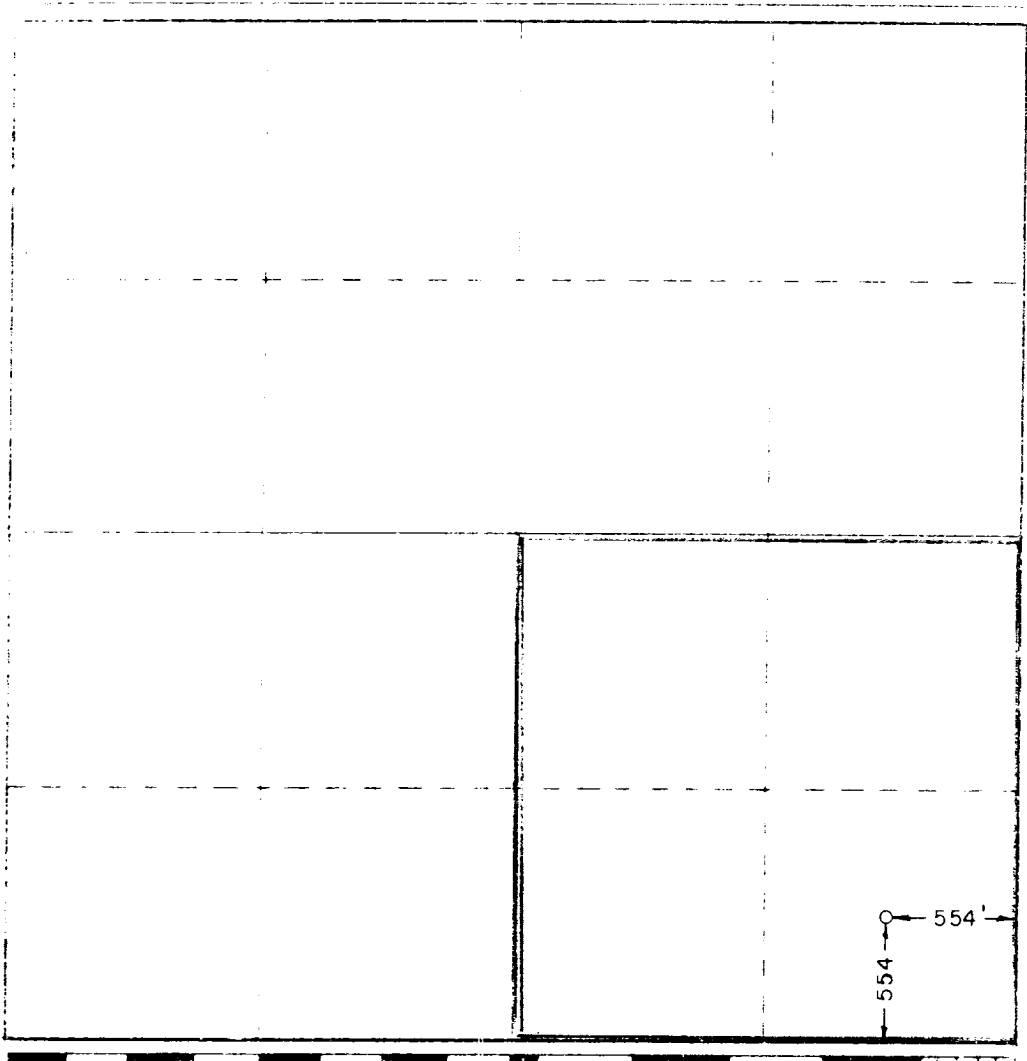

CERTIFICATION

I hereby certify that the information contained hereon is true and complete to the best of my knowledge and belief.

Charles B. Read
Operator

Charles B. Read

July 15, 1968

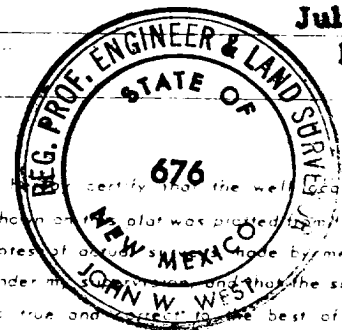

I hereby certify that the well location shown on this plat was plotted from field notes of observations made by me or under my supervision and that the same is true and correct to the best of my knowledge and belief.

JULY 6, 1968

Registration of Well Location and Acreage Dedication

John W. West
676