

UNITED STATES
DEPARTMENT OF THE INTERIOR
GEOLOGICAL SURVEY

APPLICATION FOR PERMIT TO DRILL, DEEPEN, OR PLUG BACK

1a. TYPE OF WORK DRILL <input checked="" type="checkbox"/> DEEPEN <input type="checkbox"/> PLUG BACK <input type="checkbox"/>		5. LEASE DESIGNATION AND SERIAL NO. NM - 050475	
b. TYPE OF WELL OIL WELL <input checked="" type="checkbox"/> GAS WELL <input type="checkbox"/> OTHER <input type="checkbox"/> SINGLE ZONE <input checked="" type="checkbox"/> MULTIPLE ZONE <input type="checkbox"/>		6. IF INDIAN, ALLOTTEE OR TRIBE NAME	
2. NAME OF OPERATOR John L. Cox		7. UNIT AGREEMENT NAME	
3. ADDRESS OF OPERATOR Box 2217, Midland, Texas 79701		8. FARM OR LEASE NAME Federal "A"	
4. LOCATION OF WELL (Report location clearly and in accordance with any State requirements.)* At surface 1839' FSL & 1839' FEL At proposed prod. zone		9. WELL NO. 1	
14. DISTANCE IN MILES AND DIRECTION FROM NEAREST TOWN OR POST OFFICE* 9 miles East, Crossroads, New Mexico		10. FIELD AND POOL, OR WILDCAT W. Sawyer (San Andres)	
15. DISTANCE FROM PROPOSED* LOCATION TO NEAREST PROPERTY OR LEASE LINE, FT. (Also to nearest drlg. unit line, if any) 801'		11. SEC., T., R., M., OR BLK. AND SURVEY OR AREA 22, 9S, 37E	
16. NO. OF ACRES IN LEASE 80		12. COUNTY OR PARISH Lea	
17. NO. OF ACRES ASSIGNED TO THIS WELL 80		13. STATE New Mexico	
18. DISTANCE FROM PROPOSED LOCATION* TO NEAREST WELL, DRILLING, COMPLETED, OR APPLIED FOR, ON THIS LEASE, FT. 1st well		19. PROPOSED DEPTH 5100'	
20. ROTARY OR CABLE TOOLS Rotary		21. APPROX. DATE WORK WILL START* Upon approval	
22. ELEVATIONS (Show whether DF, RT, GR, etc.) 3970.7 Gr.		23. PROPOSED CASING AND CEMENTING PROGRAM	

SIZE OF HOLE	SIZE OF CASING	WEIGHT PER FOOT	SETTING DEPTH	QUANTITY OF CEMENT
12 1/4"	8 5/8"	20#	400	375 sx. circulated
7 7/8"	4 1/2"	9.5#	5100	350 sx.

8 5/8" casing to be cemented with 375 sx. Class H cement with 2% Calcium Chloride. This is ample cement to circulate to surface.

4 1/2" casing to be cemented with 350 sx. Class C cement, 50-50 pozmix with 2% gel, 8# salt/sack and 0.75% CFR2 preceded by 500 gallon mud flush.

Mud Program: Water, gel, lime 0 - 400'
Native Redbed mud 400' - 4700'
Low solids salt gel-starch mud 4700' - TD

IN ABOVE SPACE DESCRIBE PROPOSED PROGRAM: If proposal is to deepen or plug back, give data on present productive zone and proposed new productive zone. If proposal is to drill or deepen directionally, give pertinent data on subsurface locations and measured and true vertical depths. Give blowout preventer program, if any.

24. SIGNED Martha Wittenbach TITLE Production Clerk DATE 9-17-74
(This space for Federal or State office use)

PERMIT NO. _____ APPROVAL DATE _____
APPROVED BY _____ TITLE _____
CONDITIONS OF APPROVAL, IF ANY:

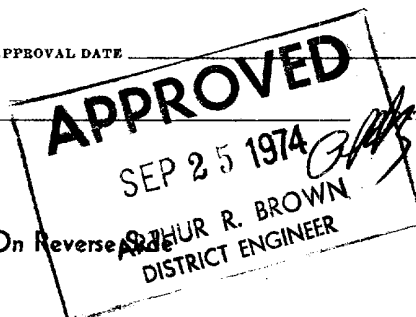

*See Instructions On Reverse

PIT DIAGRAM ... RIG # 3

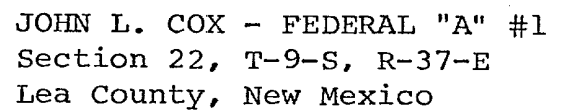

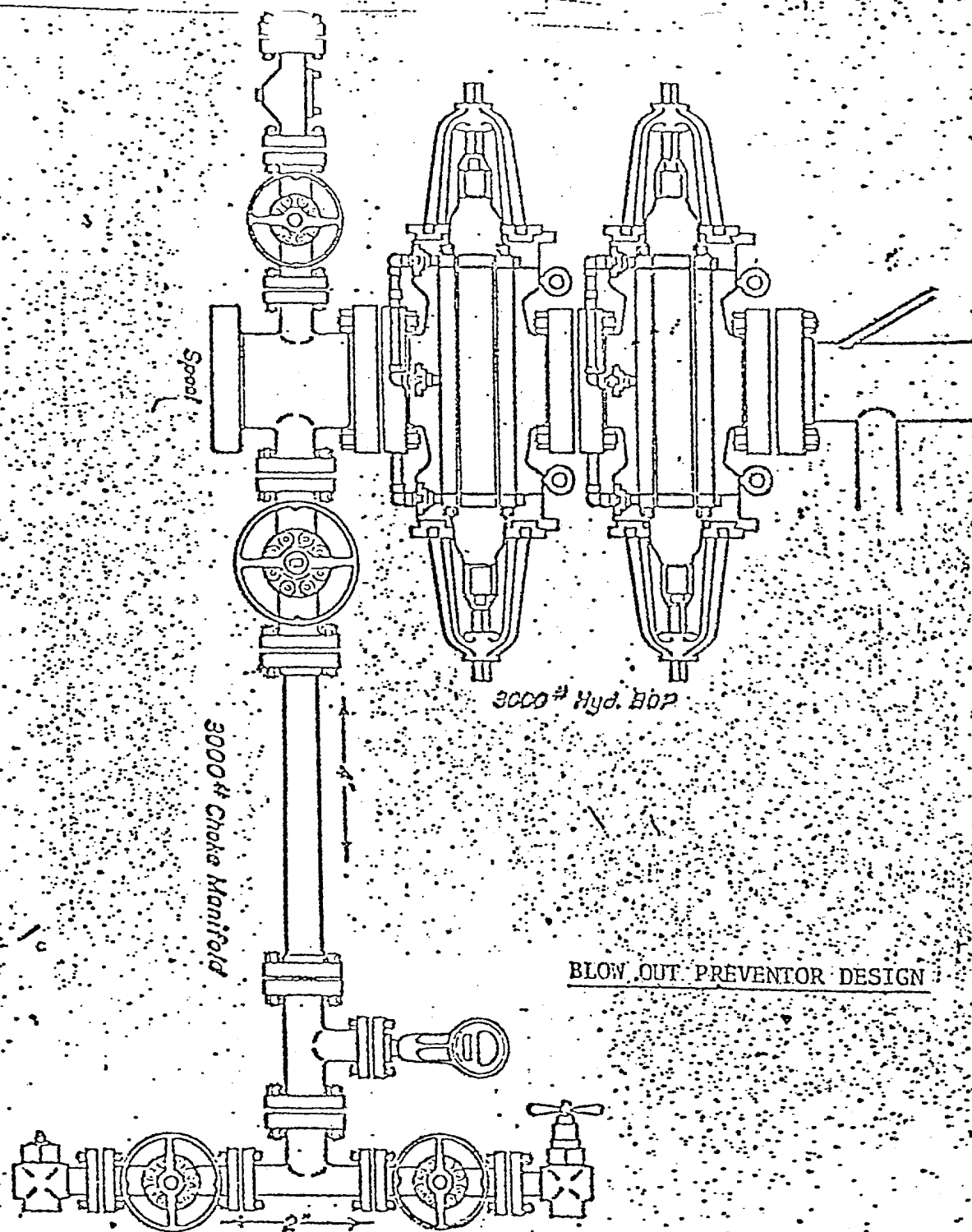

JOHN L. COX - FEDERAL "A" #1
 Section 22, T-9-S, R-37-E
 Lea County, New Mexico

JOHN L. COX
PLAN FOR SURFACE DEVELOPMENT FOR L. L. COX
SECTION 22, T-9-S, R-37-E, LEA COUNTY, NEW MEXICO

1. Existing roads including location of the exit from the main highway.

See attached plat

2. Planned access roads.

Approx. 1100' in length and 12' wide, compacted.
See attached plat for location.

3. Location of existing wells.

See attached plat.

4. Lateral roads to well locations.

See attached plat.

5. Location of tank batteries and flow lines.

Tank batteries are indicated by OO on attached plat.
Flow lines will be laid along roads.

6. Location and type of water supply.

Water will be hauled by commercial water hauler for drilling.

7. Methods for handling waste disposal.

Trash will be buried in trash pit with 24" cover of
top soil.

8. Location of camps.

None

9. Location of airstrips

None

10. Location of layout to include position of the rig, mud tanks,
reserve pits, burn pits, pipe racks, etc.

See attached detailed information
Compacted surface for drilling pad.

11. Plans for restoration of the surface.

Pits will be filled and location cleared.

12. General description of area and environment.

The area is sandy and relatively flat with very little vegetation.

FIELD REPRESENTATIVE TO BE CONTACTED IN REGARD TO DEVELOPMENT PLAN:

Mr. Hulen Lemon

Phone: 1-915-682-9435 (Office)

1-915-682-1596 (Home)

1-915-683-4002 (Mobil)

PLAN FOR SURFACE DEVELOPMENT FOR LEASES
SECTION 22, T-9-S, R-37-E, LEA COUNTY, N. MEXICO

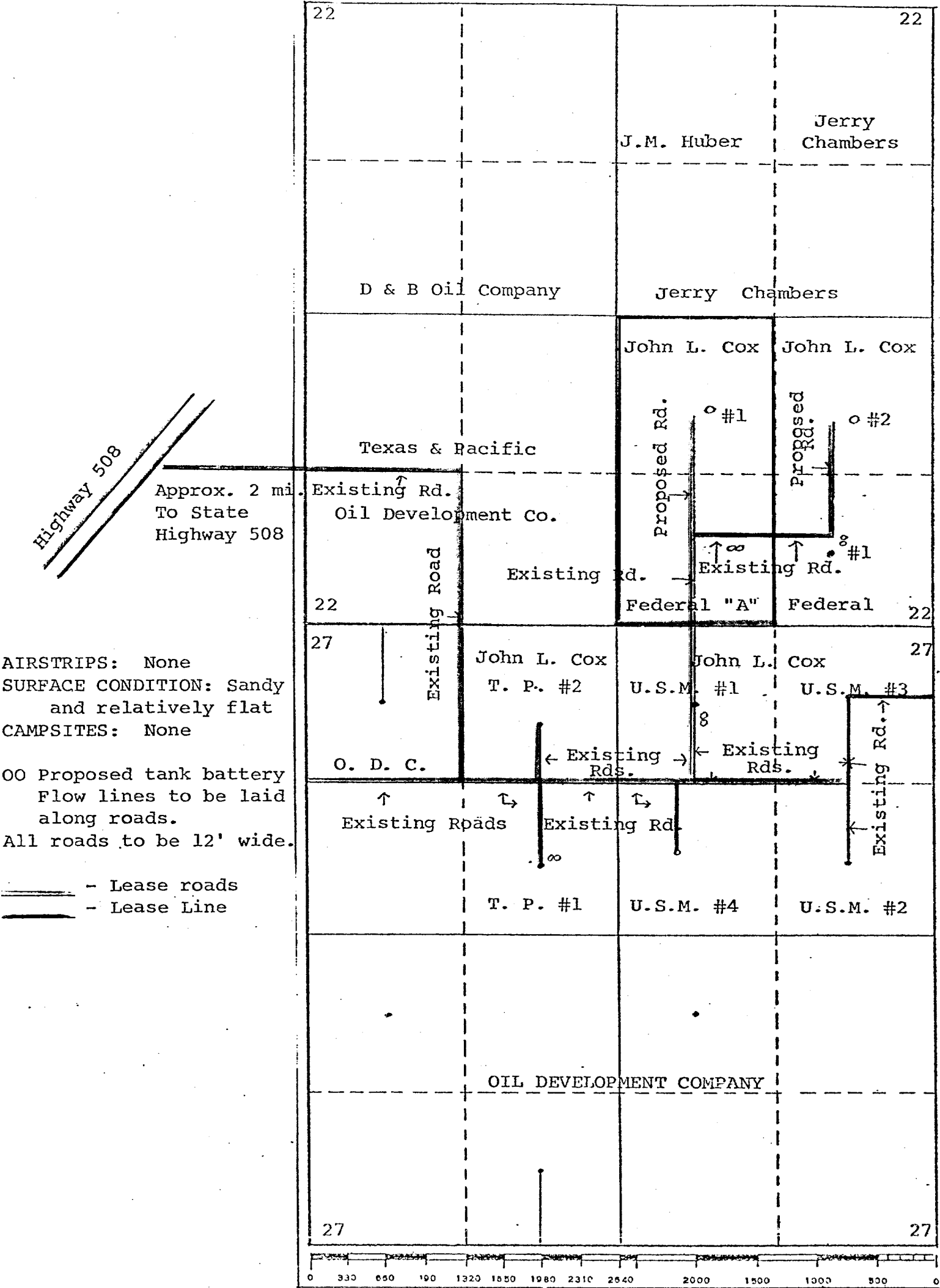

JOHN L. COX - FEDERAL "A" #1
Section 22, T-9-S, R-37-E
Lea County, New Mexico