

UNITED STATES
DEPARTMENT OF THE INTERIOR
GEOLOGICAL SURVEY

SUBMIT IN TRIPLE
(Other instructions
verse side)

Form approved.
Budget Bureau No. 42-R1424.

SUNDRY NOTICES AND REPORTS ON WELLS

(Do not use this form for proposals to drill or to deepen or plug back to a different reservoir.
Use "APPLICATION FOR PERMIT—" for such proposals.)

1. OIL WELL <input checked="" type="checkbox"/> GAS WELL <input type="checkbox"/> OTHER <input type="checkbox"/>		5. LEASE DESIGNATION AND SERIAL NO. NM0560261
2. NAME OF OPERATOR The Desana Corporation		6. IF INDIAN, ALLOTTEE OR TRIBE NAME
3. ADDRESS OF OPERATOR 610 Vaughn Bldg. Midland, Texas 79701		7. UNIT AGREEMENT NAME
4. LOCATION OF WELL (Report location clearly and in accordance with any State requirements.* See also space 17 below.) At surface 1980 FSL 660 FWL Sec. 8 TWP 8 South Rng. 38 East		8. FARM OR LEASE NAME Federal 8
14. PERMIT NO.	15. ELEVATIONS (Show whether DF, RT, GR, etc.) 3994.9 GR	9. WELL NO. 1
16. Check Appropriate Box To Indicate Nature of Notice, Report, or Other Data		10. FIELD AND POOL, OR WILDCAT Bluitt (San Andres)
NOTICE OF INTENTION TO:		11. SEC., T., R., M., OR BLK. AND SURVEY OR AREA Sec 8 - 38 E
TEST WATER SHUT-OFF <input type="checkbox"/>	PULL OR ALTER CASING <input type="checkbox"/>	12. COUNTY OR PARISH 13. STATE Roosevelt N.M.
FRACTURE TREAT <input type="checkbox"/>	MULTIPLE COMPLETE <input type="checkbox"/>	
SHOOT OR ACIDIZE <input type="checkbox"/>	ABANDON* <input type="checkbox"/>	
REPAIR WELL <input type="checkbox"/>	CHANGE PLANS <input type="checkbox"/>	
(Other) <input type="checkbox"/>		
		SUBSEQUENT REPORT OF:
		WATER SHUT-OFF <input checked="" type="checkbox"/>
		REPAIRING WELL <input type="checkbox"/>
		FRACTURE TREATMENT <input type="checkbox"/>
		ALTERING CASING <input type="checkbox"/>
		SHOOTING OR ACIDIZING <input type="checkbox"/>
		ABANDONMENT* <input type="checkbox"/>
		(Other) <input checked="" type="checkbox"/>
		(NOTE: Report results of multiple completion on Well Completion or Recompletion Report and Log form.)
17. DESCRIBE PROPOSED OR COMPLETED OPERATIONS (Clearly state all pertinent details, and give pertinent dates, including estimated date of starting any proposed work. If well is directionally drilled, give subsurface locations and measured and true vertical depths for all markers and zones pertinent to this work.)*		

8 5/8" surface casing set at 463' with 350 sx cmt. Hole drilled with 12 1/2" bit. Well spudded 12/21/73.

18. I hereby certify that the foregoing is true and correct

SIGNED *Jarrell E. Smith* TITLE President DATE 12/24/73

(This space for Federal or State office use)

APPROVED BY _____ TITLE _____

CONDITIONS OF APPROVAL, IF ANY: _____

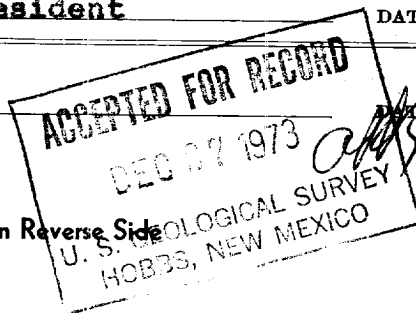

*See Instructions on Reverse Side

Instructions

General: This form is designed for submitting proposals to perform certain well operations, and reports of such operations when completed, as indicated, on Federal and Indian lands pursuant to applicable Federal law and regulations, and, if approved or accepted by any State, on all lands in such State, pursuant to applicable State law and regulations. Any necessary special instructions concerning the use of this form and the number of copies to be submitted, particularly with regard to local, area, or regional procedures and practices, either are shown below or will be issued by, or may be obtained from, the local Federal and/or State office.

Item 4: If there are no applicable State requirements, locations on Federal or Indian land should be described in accordance with Federal requirements. Consult local State or Federal office for specific instructions.

Item 17: Proposals to abandon a well and subsequent reports of abandonment should include such special information as is required by local Federal and/or State offices. In addition, such proposals and reports should include reasons for the abandonment; data on any former or present productive zones, or other zones with present significant fluid contents not sealed off by cement or otherwise; depths (top and bottom) and method of placement of cement plugs; mud or other material placed below, between and above plugs; amount, size, method of parting of any casing, liner or tubing pulled and the depth to top of any left in the hole; method of closing top of well; and date well site conditioned for final inspection looking to approval of the abandonment.

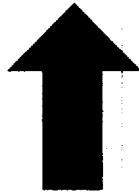
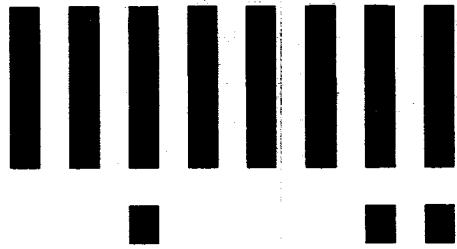

LTR



Job separation sheet

UNITED STATES
DEPARTMENT OF THE INTERIOR
GEOLOGICAL SURVEY

2-41234

5. LEASE DESIGNATION AND SERIAL NO.
NM 0560261

6. IF INDIAN, ALLOTTEE OR TRIBE NAME

7. UNIT AGREEMENT NAME

8. FARM OR LEASE NAME
Federal 8

9. WELL NO.
1

10. FIELD AND POOL, OR WILDCAT
Bluitt (San Andres)

11. SEC., T., R., M., OR BLK.
AND SURVEY OR AREA *Acce*
Sec. 8, 8 South, 38 East

12. COUNTY OR PARISH | 13. STATE
Roosevelt | New Mexico

APPLICATION FOR PERMIT TO DRILL, DEEPEN, OR PLUG BACK

1a. TYPE OF WORK
DRILL DEEPEN PLUG BACK

b. TYPE OF WELL
OIL WELL GAS WELL OTHER
SINGLE ZONE MULTIPLE ZONE

2. NAME OF OPERATOR
The Desana Corporation

3. ADDRESS OF OPERATOR
610 Vaughn Building, Midland, Texas 79701

4. LOCATION OF WELL (Report location clearly and in accordance with any State requirements.)*
At surface 1980' FSL & 660' FWL, Sec. 8, TWP 8 South
Range 38 East
At proposed prod. zone Same

14. DISTANCE IN MILES AND DIRECTION FROM NEAREST TOWN OR POST OFFICE*
3-1/2 miles west of Bledsoe, New Mexico

10. DISTANCE FROM PROPOSED* LOCATION TO NEAREST PROPERTY OR LEASE LINE, FT. (Also to nearest drlg. unit line, if any) ---

16. NO. OF ACRES IN LEASE
320

17. NO. OF ACRES ASSIGNED TO THIS WELL
80

18. DISTANCE FROM PROPOSED LOCATION* TO NEAREST WELL, DRILLING, COMPLETED, OR APPLIED FOR, ON THIS LEASE, FT. ---

19. PROPOSED DEPTH
4800'

20. ROTARY OR CABLE TOOLS
Rotary

21. ELEVATIONS (Show whether DF, RT, GR, etc.)
3994.9' GR

22. APPROX. DATE WORK WILL START*
Cont. on approval & rig availability

PROPOSED CASING AND CEMENTING PROGRAM

SIZE OF HOLE	SIZE OF CASING	WEIGHT PER FOOT	SETTING DEPTH	QUANTITY OF CEMENT
11 3/4"	8 5/8"	24#	350'	sufficient to circulate
7 7/8"	4 1/2"	9.5#	4800'	300 sxs. (est.)

Proposed Program: Drill to 350', set 8 5/8" casing and cement to surface, then drill to pay at approximately 4800' and run drill stem test. If test indicates productive formation, 4 1/2" production casing will be run to total depth and cemented with 300 sacks. (Well will be logged prior to running casing.) Well will be perforated opposite pay and stimulated with 3000 gallons of acid and completed as a flowing or pumping well in the San Andres Dolomite. (Please refer to attached plat for blowout preventer diagram.)

IN ABOVE SPACE DESCRIBE PROPOSED PROGRAM: If proposal is to deepen or plug back, give data on present productive zone and proposed new productive zone. If proposal is to drill or deepen directionally, give pertinent data on subsurface locations and measured and true vertical depths. Give blowout preventer program, if any.

24. SIGNED Wassell E. Smith TITLE President DATE September 17, 1973

(This space for Federal or State office use)

PERMIT NO. _____ APPROVAL BY _____

APPROVED BY _____ TITLE _____

CONDITIONS OF APPROVAL, IF ANY:

APPROVED
SEP 29 1973
ARTHUR R. BROWN
DISTRICT ENGINEER

WELL NAME: THE DESANA COR., FEDERAL 8 NO. 1

LOCATION: 1980' FSL, 660FWL SEC 8, TWP 8 SOUTH
RNG 38 EAST ROOSEVELT COUNTY, NEW MEXICO

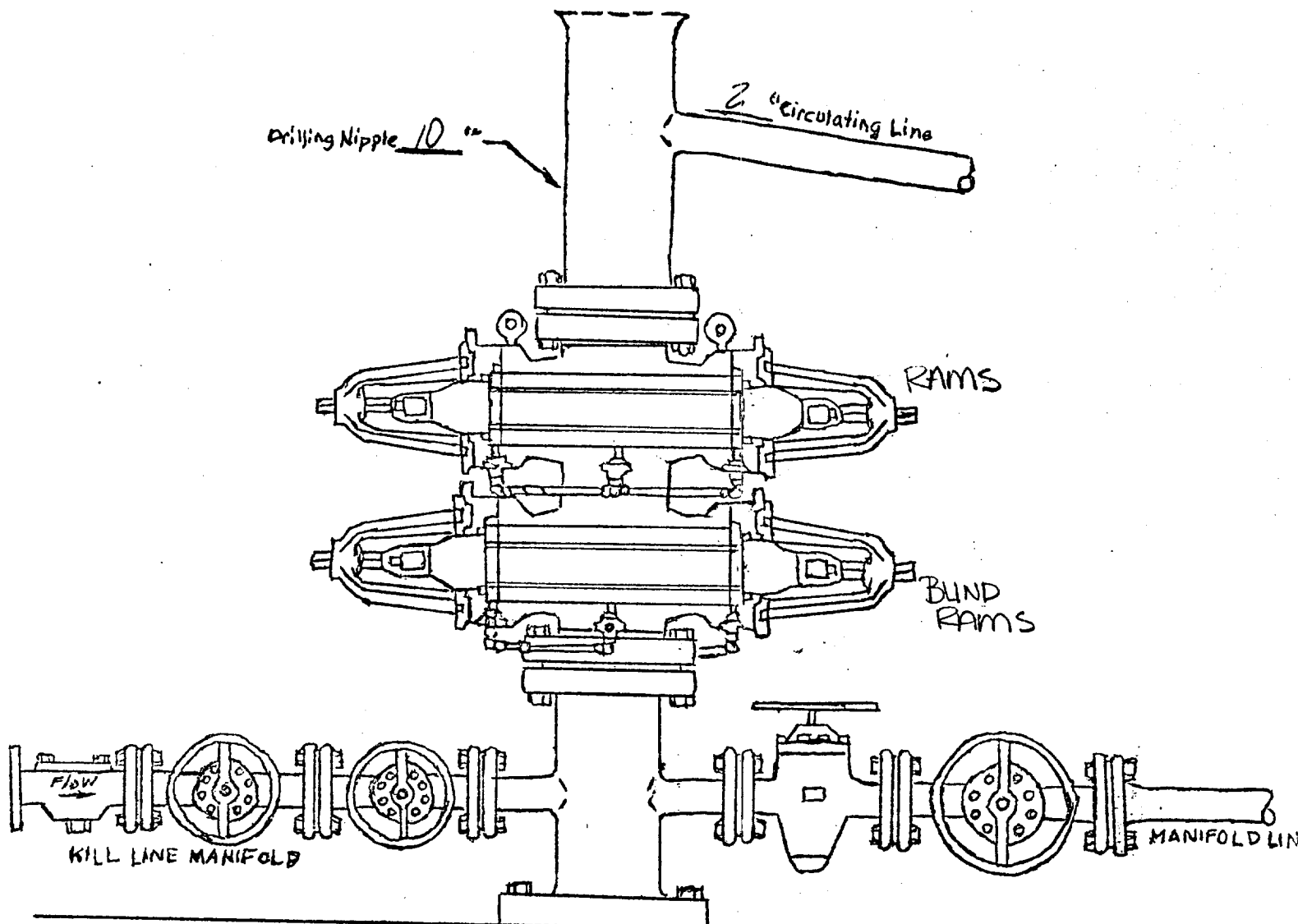

WELL HEAD B.O.P.
5000 PSI

Manual
 Hydraulic

NEW MEXICO OIL CONSERVATION COMMISSION
WELL LOCATION AND ACREAGE DEDICATION PLAT.

Form O-102
Supersedes O-128
Effective 1-1-65

All distances must be from the outer boundaries of the Section

Operator THE DESANA CORPORATION		Lease FEDERAL 8		Well No. 1
Tract Letter L	Section 8	Township 8 South	Range 38 East	County Roosevelt
Approximate True Location of Well: 1930 feet from the South line and 660 feet from the West line				
Original Level Elev. 3994.9	Producing Formation S. Ancho	Pool Bluff SA Usser.	Dedicated Acreage: 80 Acres	

- Outline the acreage dedicated to the subject well by colored pencil or hachure marks on the plat below.
- If more than one lease is dedicated to the well, outline each and identify the ownership thereof (both as to working interest and royalty).
- If more than one lease of different ownership is dedicated to the well, have the interests of all owners been consolidated by communitization, unitization, force-pooling, etc?
 Yes No If answer is "yes," type of consolidation _____

If answer is "no," list the owners and tract descriptions which have actually been consolidated (Use reverse side of this form if necessary) _____

No allowable will be assigned to the well until all interests have been consolidated (by communitization, unitization, forced-pooling, or otherwise) or until a non-standard unit, eliminating such interests, has been approved by the Commission.

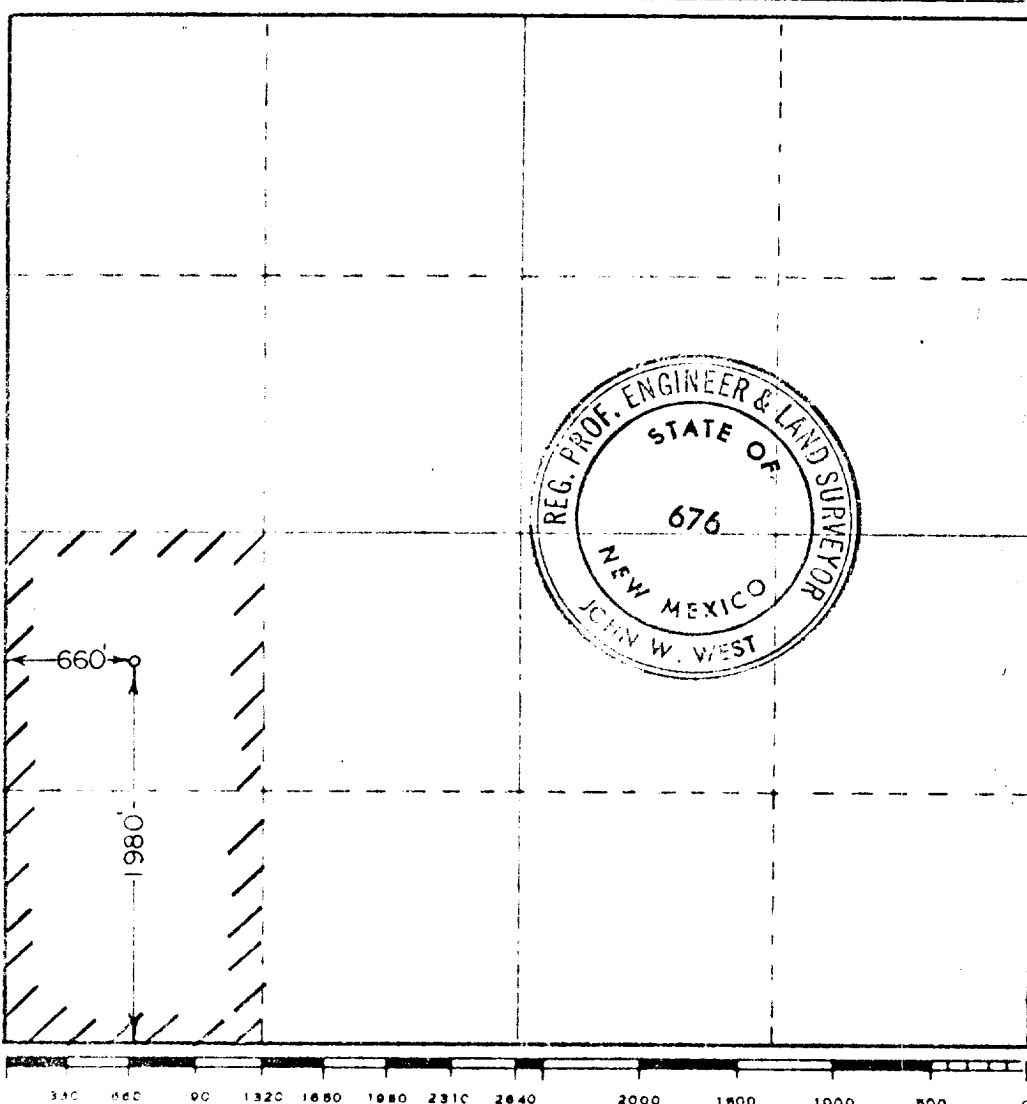

CERTIFICATION

I hereby certify that the information contained herein is true and complete to the best of my knowledge and belief.

Russell E. Smith
President

The Desana Corporation

September 17, 1973

I hereby certify that the well location shown on this plat was plotted from field notes of actual surveys made by me or under my supervision and that the same is true and correct to the best of my knowledge and belief.

September 2, 1973

Registered Professional Engineer
No. 676

John W. West
Certificate No. 676

THE DESANA CORPORATION

610 VAUGHN BUILDING
MIDLAND, TEXAS 79701

DARRELL E. SMITH
PRESIDENT

JESSE L. DALLY
VICE PRESIDENT

PHONE
915-683-5266

September 17, 1973

United States Department
of the Interior
Geological Survey
Post Office Box 1157
Hobbs, New Mexico 88240

Attention: Mr. Arthur R. Brown

Re: Development Plan for
Surface Use
The Desana Corporation
Federal 8 No. 1

Gentlemen:

The following Development Plan for Surface Use is submitted in conjunction with our Application for Permit to Drill The Desana Corporation Federal 8 No. 1, Section 8, TWP 8 South, Range 38 East, Roosevelt County, New Mexico:

- 1.) Existing Roads (Please refer to plat no. 1)
- 2.) Planned Access Road (Please refer to plat no. 1)
- 3.) Location of Existing Wells (Please refer to plat no. 2)
- 4.) Lateral Roads (Please refer to plat no. 1)
- 5.) Location of Tank Batteries, etc. (Please refer to plat no. 3)
- 6.) Water Supply--To be hauled to location by truck
- 7.) Waste Disposal--To be hauled from location by truck
- 8.) Camps--none planned
- 9.) Airstrips--none planned
- 10.) Location Layout (Please refer to plat no. 3)
- 11.) Surface restoration--In event of dry hole, all pits will be filled and leveled to original state as soon as weather permits. In the event of a producer, only that portion of surface necessary to equip and produce the well will be used.
- 12.) Other information--Please refer to plat no. 3.

Very truly yours,



Darrell E. Smith

DES/cgc
Encls.



SCALE:
ONE MILE

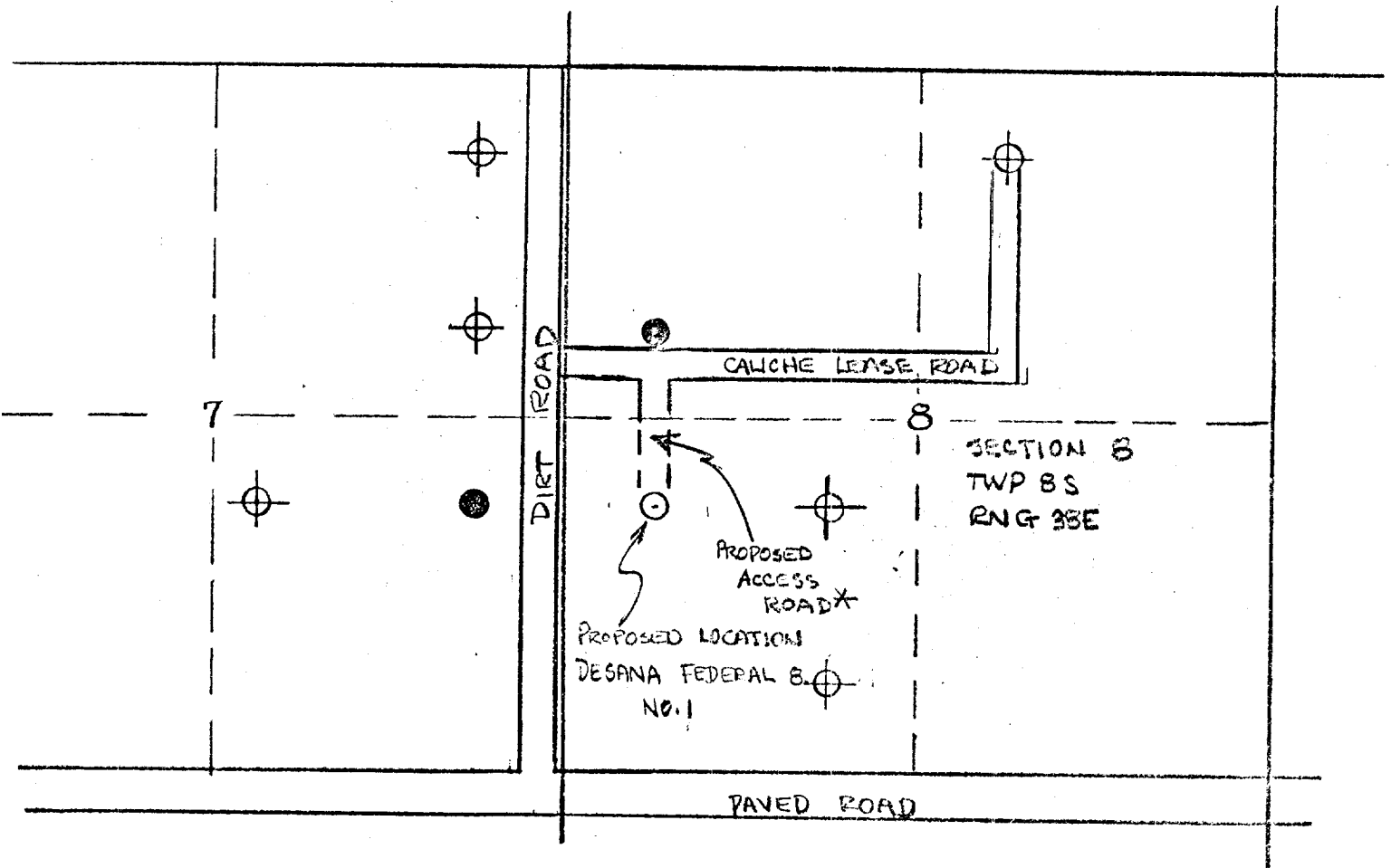
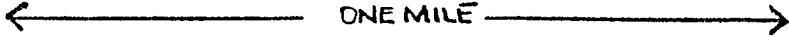

* NOTE: ROAD TO BE 12' WIDE
& 1,150' LONG & CONSTRUCTED
OF 6" OF COMPACTED CALICHE

- PROPOSED SURFACE USE -
PLAT NO. 1
PLANNED ACCESS ROAD
FOR
THE DESANA COMMUNITARIAN
FEDERAL 8 NO. 1

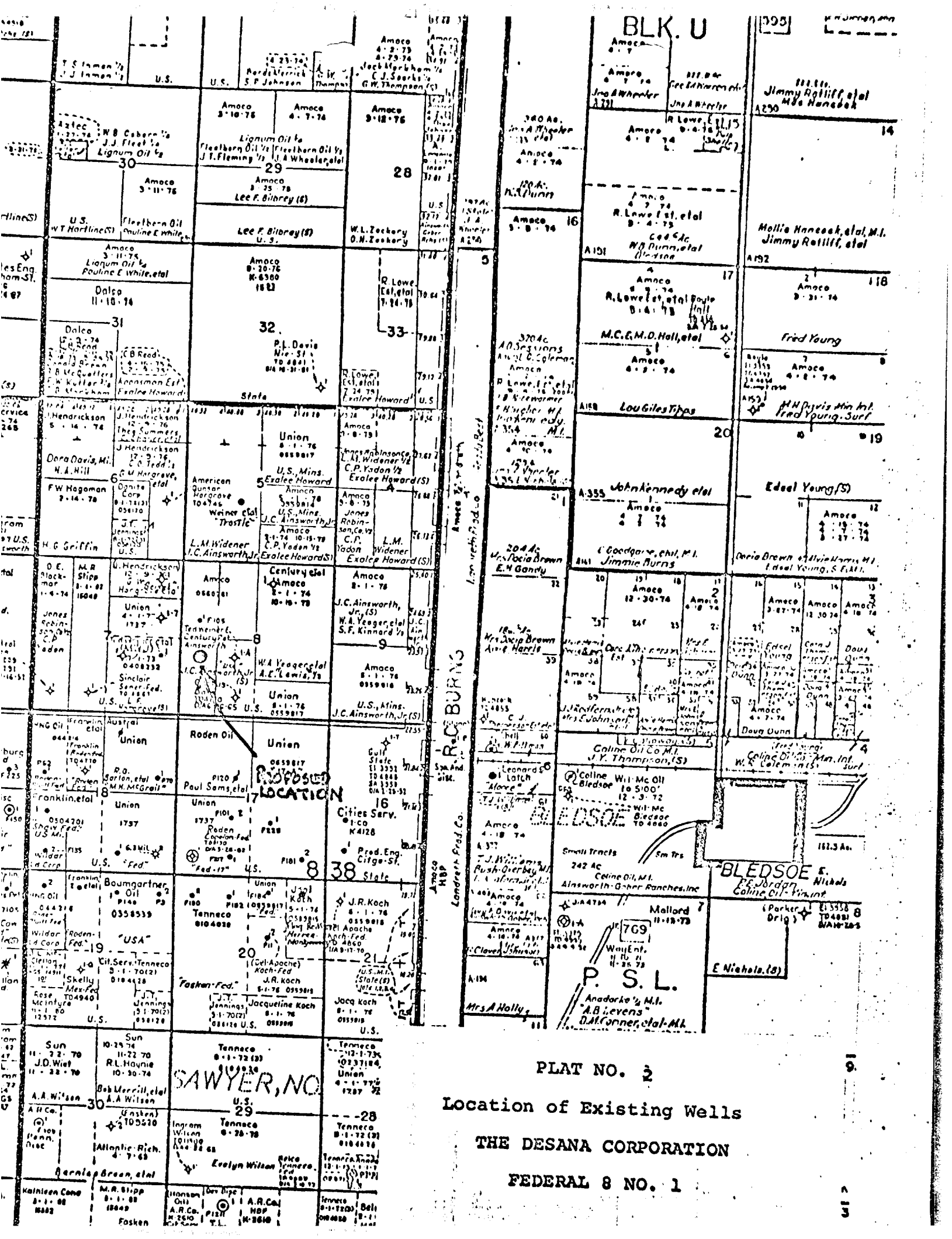

BLK. U

395

PLAT NO. 2

Location of Existing Wells
 THE DESANA CORPORATION
 FEDERAL 8 NO. 1

SAWYER, NO.

BLED SOE

P. S. L.

USA

Tenneco

USA

USA

USA

USA

USA

USA

USA

USA

USA

USA

USA

USA

USA

USA

USA

USA

USA

USA

USA

USA

USA

USA

USA

USA

USA

USA

USA

USA

USA

USA

USA

USA

USA

USA

USA

USA

USA

USA

USA

USA

USA

USA

USA

USA

USA

USA

USA

USA

USA

USA

USA

USA

USA

USA

USA

USA

USA

USA

USA

USA

USA

USA

USA

USA

USA

USA

USA

USA

USA

USA

USA

USA

USA

USA

USA

USA

USA

USA

USA

USA

USA

USA

USA

USA

USA

USA

USA

USA

USA

USA

USA

USA

USA

USA

USA

USA

USA

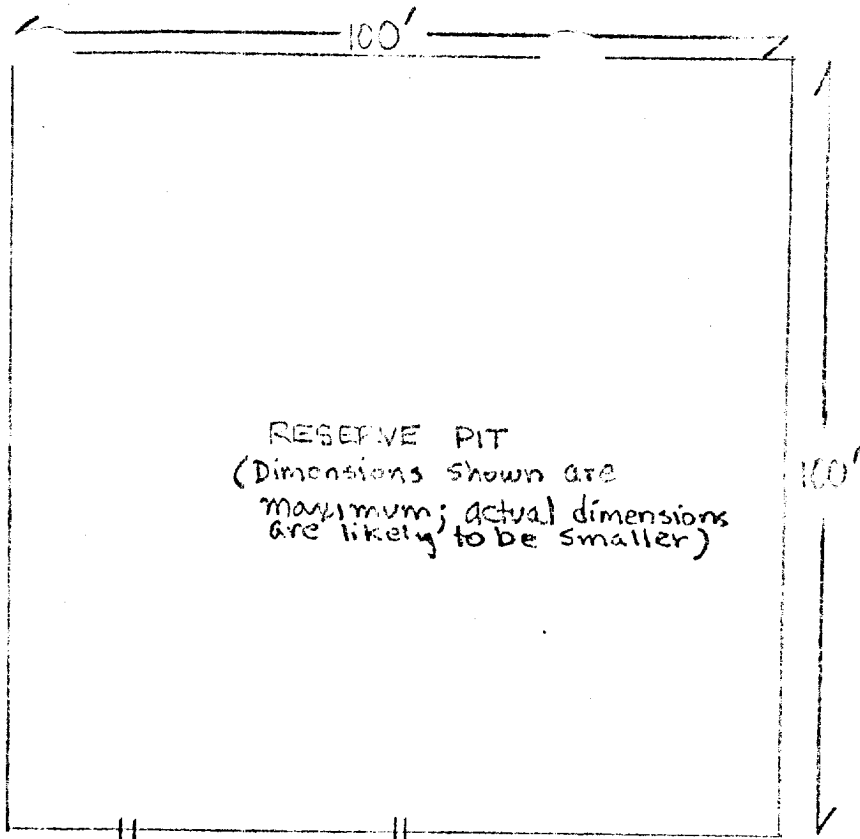

PROPOSED SURFACE USE
 FLAT NO. 3
 DRILLING & COMPLETION
 EQUIPMENT
 THE DESANA CORPORATION
 FEDERAL 6
 NO. 1

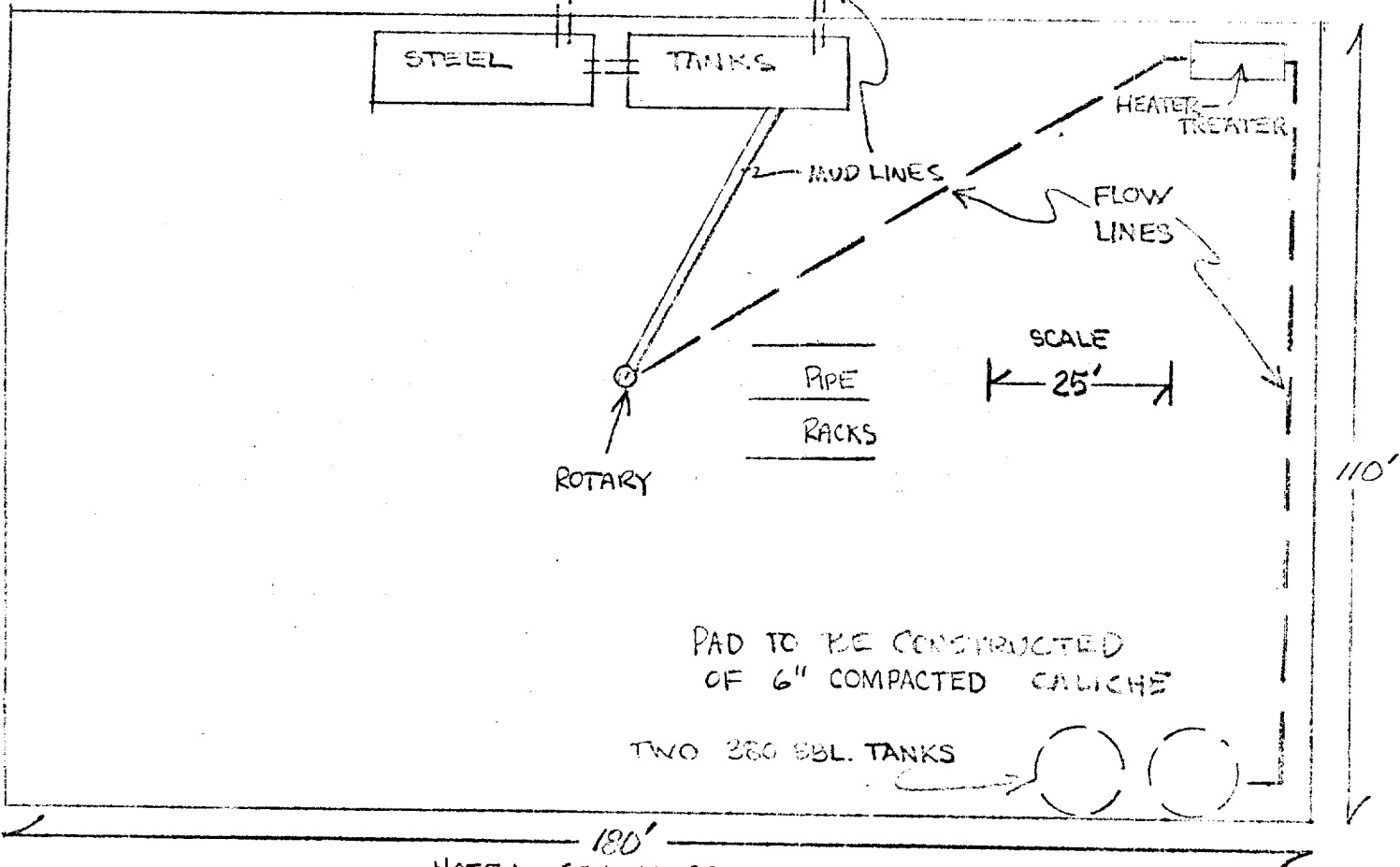

PAD TO BE CONSTRUCTED
 OF 6" COMPACTED CALICHE

TWO 380 BBL. TANKS

NOTE: SOIL IS SANDY
 TERRAIN IS FLAT
 PRIMARY VEGETATION IS SHINNEY