

30-041-20600

NO. OF COPIES RECEIVED	
DISTRIBUTION	
SANTA FE	
FILE	
U.S.G.S.	
LAND OFFICE	
OPERATOR	

5A. Indicate Type of Lease
STATE FEE

5. State Oil & Gas Lease No.
V-23

APPLICATION FOR PERMIT TO DRILL, DEEPEN, OR PLUG BACK

1a. Type of Work DRILL <input checked="" type="checkbox"/> DEEPEN <input type="checkbox"/> PLUG BACK <input type="checkbox"/>		7. Unit Agreement Name N/A	
b. Type of Well OIL WELL <input checked="" type="checkbox"/> GAS WELL <input type="checkbox"/> OTHER <input type="checkbox"/>		8. Farm or Lease Name State	
2. Name of Operator Crescent Energy Corp.		9. Well No. 1	
3. Address of Operator P. O. Box 3578 Midland, Texas 79702		10. Field and Pool, or Wildcat Allison - Penn	
4. Location of Well UNIT LETTER <u>G N/A</u> LOCATED <u>2630</u> FEET FROM THE <u>North</u> LINE AND <u>1980</u> FEET FROM THE <u>East</u> LINE OF SEC. <u>32</u> TWP. <u>8S</u> RGF. <u>37E</u> N.M.P.M.		11. County Roosevelt	
18. Proposed Depth 9650		19A. Formation Bough C	20. Rotary or C.C. Rotary
21. Elevations (Show whether DF, RT, etc.) 4,032' GL	21A. Kind & Status Plug. Bond \$50,000 Blanket	21B. Drilling Contractor Chico Drilling Co.	22. Approx. Date Work will start May 25, 1981

PROPOSED CASING AND CEMENT PROGRAM

SIZE OF HOLE	SIZE OF CASING	WEIGHT PER FOOT	SETTING DEPTH	SACKS OF CEMENT	EST. TOP
18"	13 3/8"	46#	425'		Surface
11"	9 5/8"	34#	4250'		400'
7 7/8"	5 1/2"	17#	9650'		4250'

Description of Blowout Preventer: One 10" Cameron - SS Double Ram Working Pressure 3,000 psi

Description of BOP Accumulator: Payne NSA 4-80 total usable volume 80 gal. Precharge pressure rating 1,000 psi.

APPROVAL VALID FOR 180 DAYS
PERMIT EXPIRES 11/28/81
UNLESS IT IS RENEWED FIRST

IN ABOVE SPACE DESCRIBE PROPOSED PROGRAM; IF PROPOSAL IS TO DEEPEN OR PLUG BACK, GIVE DATA ON PRESENT PRODUCTIVE ZONE AND PROPOSED NEW PRODUCTIVE ZONE. GIVE BLOWOUT PREVENTER PROGRAM, IF ANY.

I hereby certify that the information above is true and complete to the best of my knowledge and belief.

Signed Bill Mikulski Title Agent Date 5/20/81

(This space for State Use)

APPROVED BY [Signature] TITLE [Signature] DATE [Signature]

CONDITIONS OF APPROVAL, IF ANY:

[Signature]
Certificate No. 6689

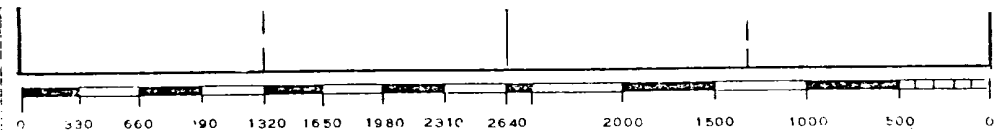

NEW MEXICO OIL CONSERVATION COMMISSION
 WELL LOCATION AND ACREAGE DEDICATION PLAT

Form C-102
 Supersedes C-128
 Effective 1-1-65

All distances must be from the outer boundaries of the Section.

CRESCENT ENERGY CORPORATION			State		Well No. 1
Tract No. <i>B</i>	Section 32	Township 8-S	Range 37E	County Roosevelt	
Section Location of Well:					
2630' feet from the North line and		1980 feet from the East line			
Surface Elevation 4032'	Producing Formation Bough "C"	Pool Allison - Penn		Dedicated Acreage: 80 Acres	

- Outline the acreage dedicated to the subject well by colored pencil or hachure marks on the plat below.
- If more than one lease is dedicated to the well, outline each and identify the ownership thereof (both as to working interest and royalty). **N/A Only one lease is dedicated to the well**
- If more than one lease of different ownership is dedicated to the well, have the interests of all owners been consolidated by communitization, unitization, force-pooling, etc? **n/A**
 Yes No If answer is "yes," type of consolidation _____

If answer is "no," list the owners and tract descriptions which have actually been consolidated. (Use reverse side of this form if necessary.) _____
 No allowable will be assigned to the well until all interests have been consolidated (by communitization, unitization, forced-pooling, or otherwise) or until a non-standard unit, eliminating such interests, has been approved by the Commission.

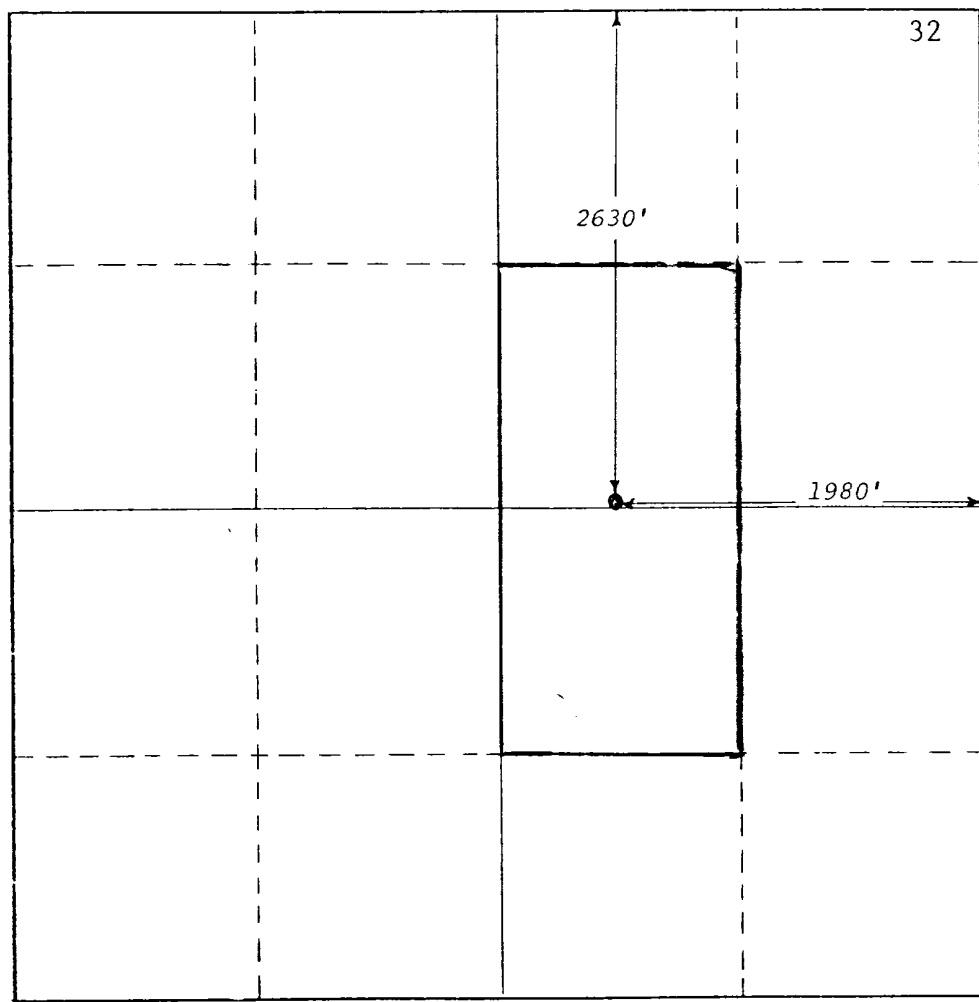

CERTIFICATION

I hereby certify that the information contained herein is true and complete to the best of my knowledge and belief.

Bill Mikulin
 Name
 Bill Mikulin
 Position
 Agent
 Company
 Crescent Energy Corp.
 Date
 5/20/81

I hereby certify that the well location shown on this plat was plotted from field notes of actual surveys made by me or under my supervision, and that the same is true and correct to the best of my knowledge and belief.

Date Surveyed **GARY D. BOSSWELL**
GARY D. BOSSWELL
 Registered Professional Geologist and Oil Field Surveyor
 No. 6689
Gary D. Bosswell
 Certificate No. 6689

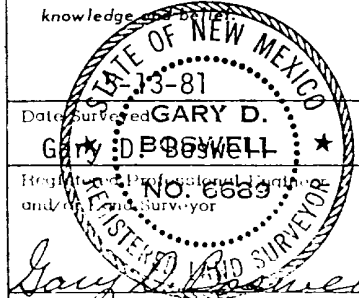

RECEIVED
MAY 27 1994

MISSOURI STATE DIV.