

NM330 - ARTESIA
NM000 - HOBBS
BLM - SANTA FEUNITED STATES
DEPARTMENT OF THE INTERIOR
GEOLOGICAL SURVEY

APPLICATION FOR PERMIT TO DRILL, DEEPEN, OR PLUG BACK

1a. TYPE OF WORK

DRILL ☒DEEPEN ☐PLUG BACK ☐

b. TYPE OF WELL

OIL
WELL ☒GAS
WELL ☐

OTHER

SINGLE
ZONE ☒MULTIPLE
ZONE ☐

2. NAME OF OPERATOR

Eugene E. Nearburg

3. ADDRESS OF OPERATOR

3303 Lee Parkway Dallas, Texas 75219

4. LOCATION OF WELL (Report location clearly and in accordance with any State requirements.*)

At surface

State of New Mexico Unit Letter B, being 660' from N line and
1980' from E line of section.At proposed prod. zone
Same

14. DISTANCE IN MILES AND DIRECTION FROM NEAREST TOWN OR POST OFFICE*

10 miles east of Elkins, New Mexico

15. DISTANCE FROM PROPOSED*

LOCATION TO NEAREST
PROPERTY OR LEASE LINE, FT.
(Also to nearest drlg. unit line, if any)

660 feet

16. NO. OF ACRES IN LEASE

240

17. NO. OF ACRES ASSIGNED
TO THIS WELL

40

18. DISTANCE FROM PROPOSED LOCATION*
TO NEAREST WELL, DRILLING, COMPLETED,
OR APPLIED FOR, ON THIS LEASE, FT.

1320 feet

19. PROPOSED DEPTH

3550'

20. ROTARY OR CABLE TOOLS

Rotary

21. ELEVATIONS (Show whether DF, RT, GR, etc.)

GR

4019.2

22. APPROX. DATE WORK WILL START*

Upon approval

23. PROPOSED CASING AND CEMENTING PROGRAM

SIZE OF HOLE	SIZE OF CASING	WEIGHT PER FOOT	SETTING DEPTH	QUANTITY OF CEMENT
12-1/4"	8-5/8"	20#	300'	250 sacks
7-7/8"	4-1/2"	9-1/2#	3550'	300 sacks

Plan to drill vertical hole to approximately 3550', set pipe, perforate, acidize, and snub San Andres. Acreage dedicated to this well is the NW/4 NE/4, Section 8, T-8-S, R-30-E, consisting of 40 acres. (Note attached NM000 form C-102)

IN ABOVE SPACE DESCRIBE PROPOSED PROGRAM: If proposal is to deepen or plug back, give data on present productive zone and proposed new productive zone. If proposal is to drill or deepen directionally, give pertinent data on subsurface locations and measured and true vertical depths. Give blowout preventer program if any.

24.

Patrick J. F. Bratton

Exploration Manager

DATE 24 October 1967

(This space for Federal or State office use)

PERMIT NO.

APPROVAL DATE

APPROVED BY
APPROVED BY, IF ANY:

TITLE

RECEIVED

OCT 26 1967

OCT 26 1967

J. W. SUTHERLAND
DISTRICT ENGINEER

*See Instructions On Reverse Side

U. S. GEOLOGICAL SURVEY
ROSWELL, NEW MEXICO

Instructions

General: This form is designed for submitting proposals to perform certain well operations, as indicated, on all types of lands and leases for appropriate action by either a Federal or a State agency, or both, pursuant to applicable Federal and/or State laws and regulations. Any necessary special instructions concerning the use of this form and the number of copies to be submitted, particularly with regard to local, area, or regional procedures and practices, either are shown below or will be issued by, or may be obtained from, the local Federal and/or State office.

Item 1: ~~If~~ the proposal is to redrill to the same reservoir at a different subsurface location or to a new reservoir, use this form with appropriate notations. Consult applicable State or Federal regulations concerning subsequent work proposals or reports on the well.

Item 4: If there are no applicable State requirements, locations on Federal or Indian land should be described in accordance with Federal requirements. Consult local State or Federal office for specific instructions.

Item 14: Needed only when location of well cannot readily be found by road from the land or lease description. A plat, or plats, separate or on this reverse side, showing the roads to, and the surveyed location of, the well, and any other required information, should be furnished when required by Federal or State agency offices.

Items 15 and 18: If well is to be, or has been directionally drilled, give distances for subsurface location of hole in any present or objective production zone.

Item 22: Consult applicable Federal or State regulations, or appropriate officials, concerning approval of the proposal before operations are started.

NATIONAL OIL CONSERVATION COMMISSION
WELL LOCATION AND ACREAGE DEDICATION PLAT

Form C-102
Supersedes C-128
Effective 1-1-65

All distances must be from the outer boundaries of the Section.

Operator Eugene E. Nearburg			Lease Skinner-Federal		Well No. 2
Unit Letter B	Section 8	Township 8 South	Range 30 East	County Chaves	
Actual Footage Location of Well: 1980 feet from the east line and 660 feet from the north line					
Ground Level Elev. 4819.8	Producing Formation San Andres	Pool Cato	Dedicated Acreage: 40 Acres		

- Outline the acreage dedicated to the subject well by colored pencil or hachure marks on the plat below.
- If more than one lease is dedicated to the well, outline each and identify the ownership thereof (both as to working interest and royalty). **Not Applicable**
- If more than one lease of different ownership is dedicated to the well, have the interests of all owners been consolidated by communitization, unitization, force-pooling, etc? **Not Applicable**
☐ Yes ☐ No If answer is "yes," type of consolidation **Not Applicable**

If answer is "no," list the owners and tract descriptions which have actually been consolidated. (Use reverse side of this form if necessary.) **Not Applicable**

No allowable will be assigned to the well until all interests have been consolidated (by communitization, unitization, forced-pooling, or otherwise) or until a non-standard unit, eliminating such interests, has been approved by the Commission.

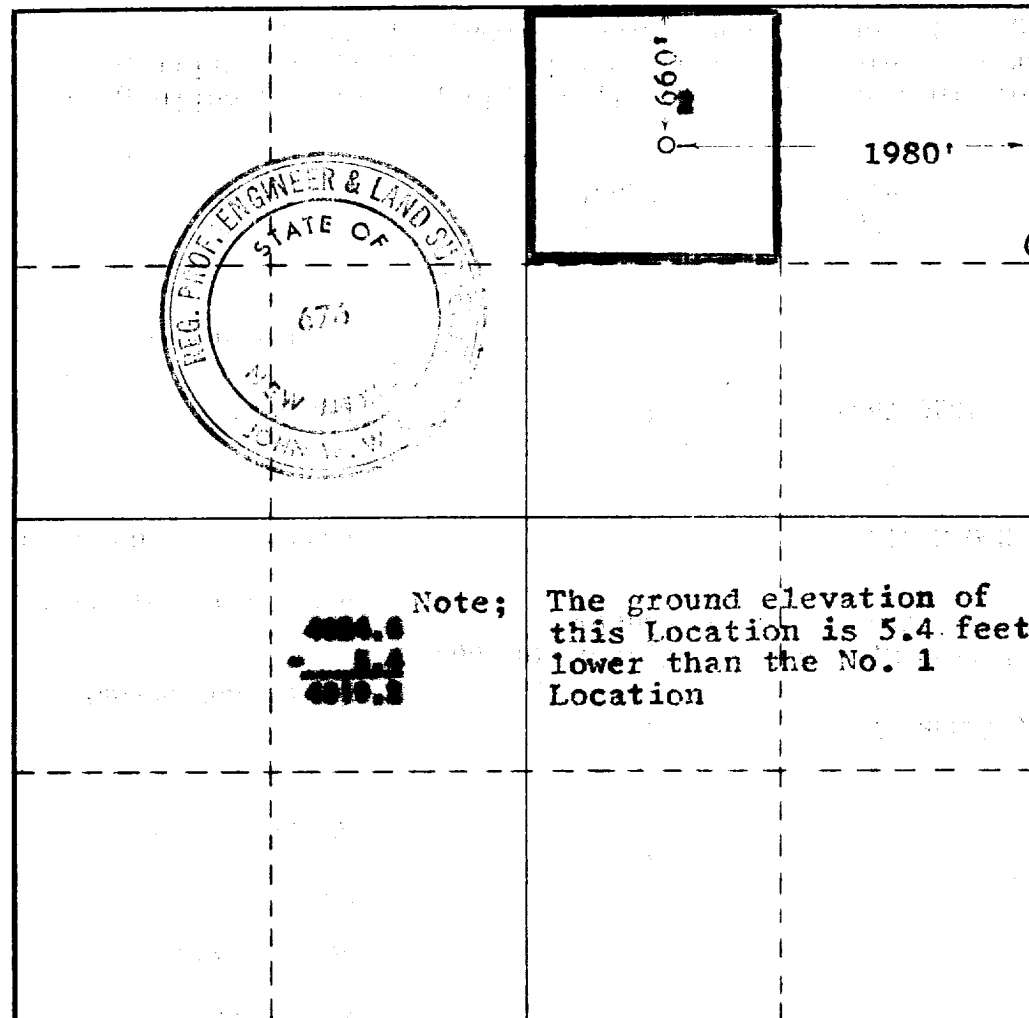

CERTIFICATION

I hereby certify that the information contained herein is true and complete to the best of my knowledge and belief.

Patrick J. F. Sutton
Name **Patrick J. F. Sutton**

Position **Exploration Manager**

Company **Eugene E. Nearburg**

Date **24 October 1967**

I hereby certify that the well location shown on this plat was plotted from field notes of actual surveys made by me or under my supervision, and that the same is true and correct to the best of my knowledge and belief.

Date Surveyed **August 9, 1967**

Registered Professional Engineer and/or Land Surveyor

John W. West

Certificate No. **676**

