

~~SECRET~~ COPY

SUBMIT IN TRIPLICATE* (Other instructions on reverse side)

Form approved. Budget Bureau No. 42-R1425.

UNITED STATES DEPARTMENT OF THE INTERIOR GEOLOGICAL SURVEY

APPLICATION FOR PERMIT TO DRILL, DEEPEN, OR PLUG BACK

1a. TYPE OF WORK DRILL [X] DEEPEN [] PLUG BACK []

1b. TYPE OF WELL OIL WELL [X] GAS WELL [] OTHER [] SINGLE ZONE [X] MULTIPLE ZONE []

2. NAME OF OPERATOR Sundance Oil Company

3. ADDRESS OF OPERATOR 1300 The Main Building Houston, Texas 77002

4. LOCATION OF WELL (Report location clearly and in accordance with any State requirements.*) At surface 660' From North Line, 1980' From West line At proposed prod. zone same

14. DISTANCE IN MILES AND DIRECTION FROM NEAREST TOWN OR POST OFFICE* 15 miles East of Elkins

15. DISTANCE FROM PROPOSED* LOCATION TO NEAREST PROPERTY OR LEASE LINE, FT. (Also to nearest drlg. unit line, if any) 660

18. DISTANCE FROM PROPOSED LOCATION* TO NEAREST WELL, DRILLING, COMPLETED, OR APPLIED FOR, ON THIS LEASE, FT. 1866.5

21. ELEVATIONS (Show whether DF, RT, GR, etc.) 4240.3

5. LEASE DESIGNATION AND SERIAL NO. NM 16637 (A) 6. IF INDIAN, ALLOTTEE OR TRIBE NAME --- 7. UNIT AGREEMENT NAME --- 8. FEDERAL LEASE NAME Tom Tom and San Address 9. WELL NO. E 2 10. FIELD AND POOL, OR WILDCAT Tom Tom and San Address 11. SEC., T., R., M., OR BLK. AND SURVEY OR AREA Sec 9 T8S R31E 12. COUNTY OR PARISH Chaves 13. STATE New Mexico

16. NO. OF ACRES IN LEASE 120

17. NO. OF ACRES ASSIGNED TO THIS WELL 40

19. PROPOSED DEPTH 4100

20. ROTARY OR CABLE TOOLS Rotary

22. APPROX. DATE WORK WILL START* 3 weeks

23. PROPOSED CASING AND CEMENTING PROGRAM

SIZE OF HOLE	SIZE OF CASING	WEIGHT PER FOOT	SETTING DEPTH	QUANTITY OF CEMENT
12 1/4	8 5/8	24.0	400	330 cu. ft.
7 7/8	4 1/2	10.5	4100	400 cu. ft.

Log, Evaluate and Complete

RECEIVED JUL 28 1975 U.S. GEOLOGICAL SURVEY ARTESIA, NEW MEXICO

IN ABOVE SPACE DESCRIBE PROPOSED PROGRAM: If proposal is to deepen or plug back, give data on present productive zone and proposed new productive zone. If proposal is to drill or deepen directionally, give pertinent data on subsurface locations and measured and true vertical depths. Give blowout preventer program, if any.

24. SIGNED [Signature] TITLE Gulf Coast Production Manager DATE July 18, 1975

(This space for Federal or State office use)

PERMIT NO. APPROVAL DATE APPROVED BY H. L. BEEKHUIS ACTING DISTRICT ENGINEER THIS APPROVAL IS RESCINDED IF OPERATIONS ARE NOT COMMENCED WITHIN 3 MONTHS. EXPIRES NOV 4 - 1975 See Instructions On Reverse Side

NEW MEXICO OIL CONSERVATION COMMISSION
WELL LOCATION AND ACREAGE DEDICATION PLAT

Form C-102
Supersedes C-128
Effective 1-1-65

All distances must be from the outer boundaries of the Section

Operator Sundance Oil Company		Lease <i>Strange Fed. East-Strange?</i>		Well No. 2
Section C	Section 9	Section 8 South	Section 31 East	Section Chaves
Acreage Dedication to this Well 660 feet from the North side and 1980 feet from the West side		Ground Level Elev 4240.3		
Producing Formation San Andres		Block Tom Tom		Dedicated Acreage 40 Acres

- Outline the acreage dedicated to the subject well by colored pencil or hachure marks on the plat below.
- If more than one lease is dedicated to the well, outline each and identify the ownership thereof (both as to working interest and royalty).
- If more than one lease of different ownership is dedicated to the well, have the interests of all owners been consolidated by communitization, unitization, force-pooling, etc?

Yes No If answer is "yes," type of consolidation _____

If answer is "no," list the owners and tract descriptions which have actually been consolidated. (Use reverse side of this form if necessary.) _____

No allowable will be assigned to the well until all interests have been consolidated (by communitization, unitization, forced-pooling, or otherwise) or until a non-standard unit, eliminating such interests, has been approved by the Commission.

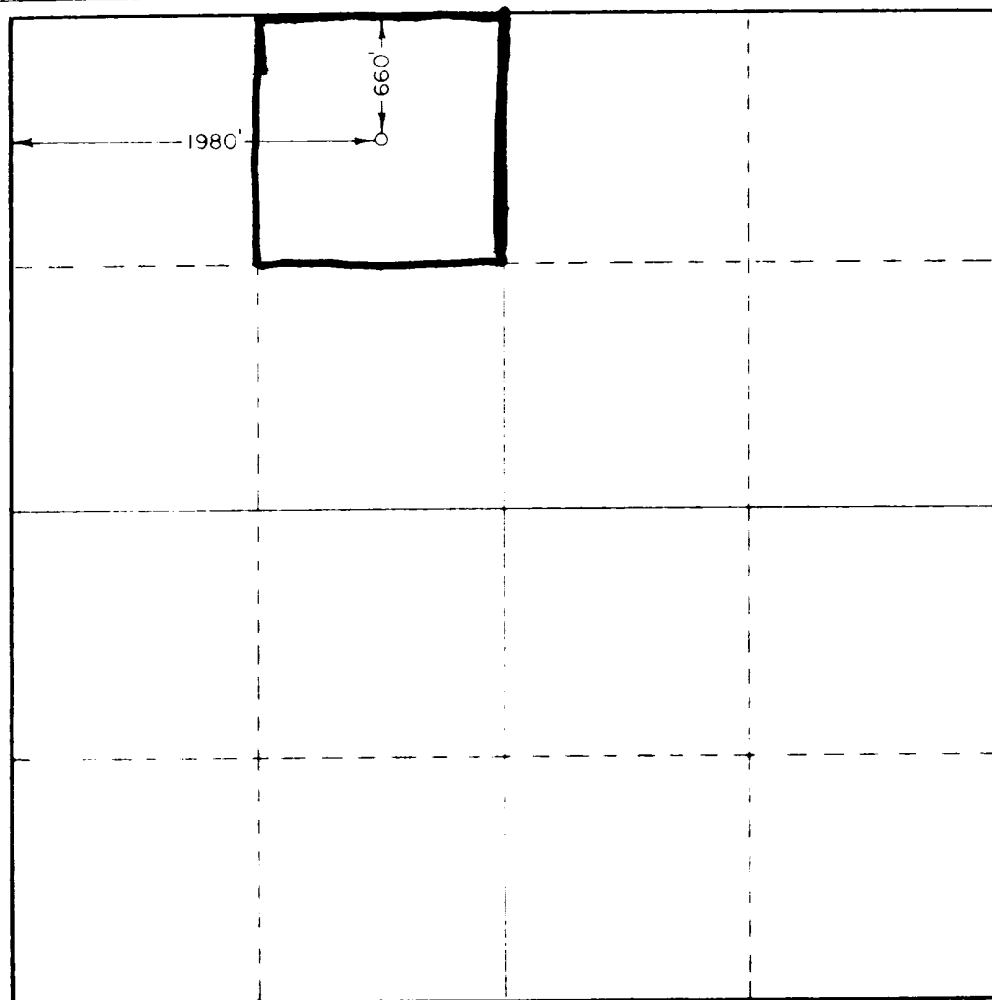

CERTIFICATION

I hereby certify that the information contained herein is true and complete to the best of my knowledge and belief.

B. H. Wallace

Name
B. H. Wallace

Position
Gulf Coast Production Manager

Company
Sundance Oil Company

Date
July 18, 1975

I hereby certify that the well location shown on this plat was plotted from field notes of actual surveys made by me or under my supervision, and that the same is true and correct to the best of my knowledge and belief.

Date Signed
July 11, 1975

Registered Professional Engineer and/or Land Surveyor
NEW MEXICO

Certificate No. **676**

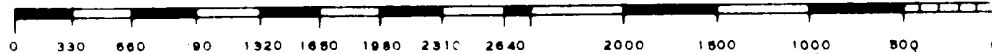

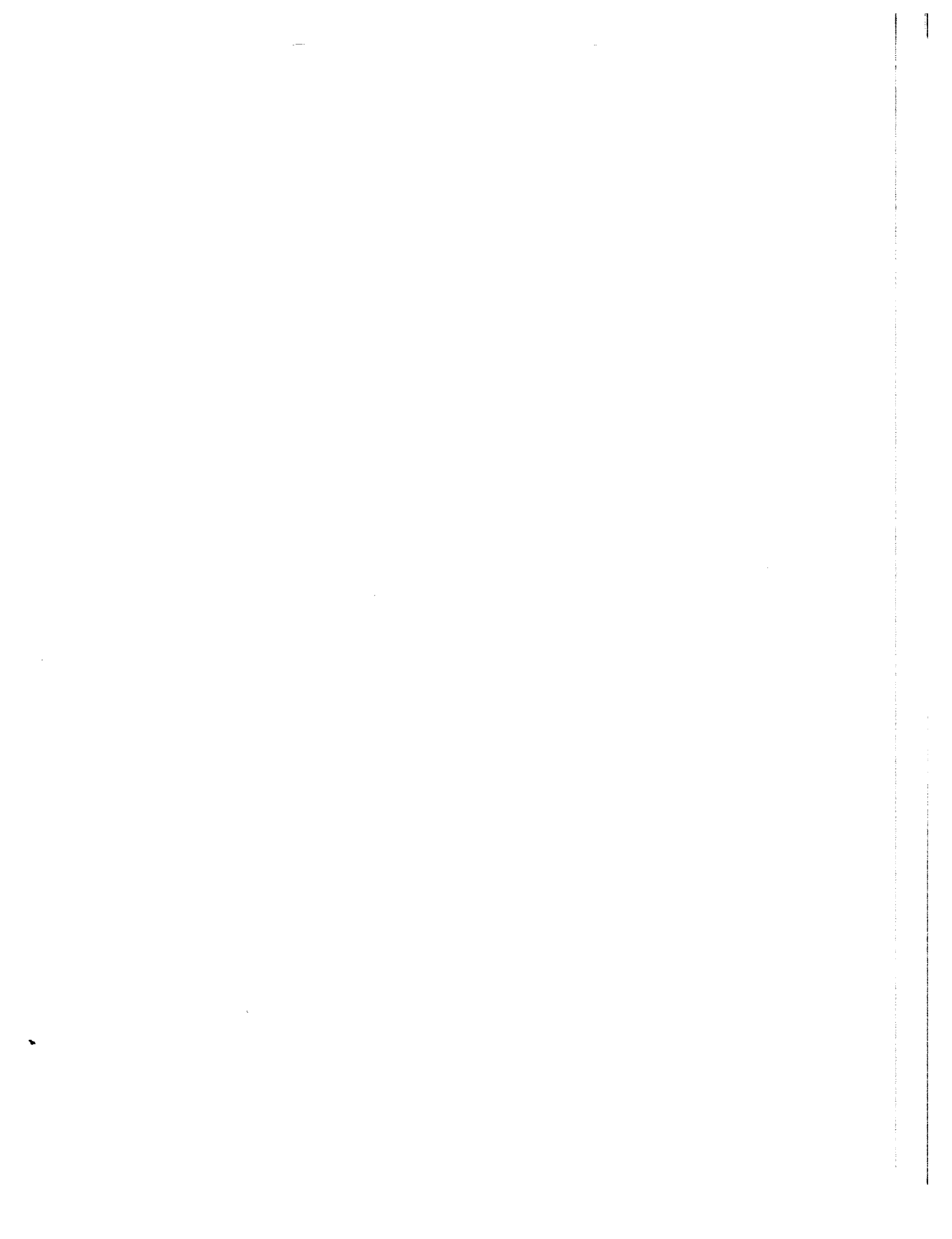



G U I D A N C E O I L C O M P A N Y

DEVELOPMENT PLAN FOR SURFACE USE
UNITED STATES GEOLOGICAL SURVEY
Southern Rocky Mountain Area

Date: July 18, 1975

Well: No. 2 Strange Fed
~~Federal Storage # 3~~

Location Sec 9 T8S 31E

1. Existing roads including location of the exit from the main highway.
see attached maps
2. Planned access roads.
see attached plat
3. Location of existing wells.
see attached plat
4. Lateral roads to well location. Caliche roads will be required. See attached plat
5. Location of tank batteries and flow lines. Tank battery is at the Federal Storage #9
Well # 3
6. Location and type of water supply (rivers, creeks, lakes, ponds, well, etc.).
Water will be hauled from crossroads.
7. Methods for handling waste disposal. Buried in reserve pit. Minimum 24 inches.
8. Location of camps. None
9. Location of airstrips. None

1300 the main building
1212 main street
Houston, Texas 77002
telephone (713) 724-4526

10. Location of layout to include position of the rig, mud tanks, reserve pits, burn pits, pipe racks, etc. see attached plat

11. Plans for restoration of the surface.

should not be necessary

12. Any other information that may be used in evaluating the impact on environment.

Include general description of the topography, vegetation, and other aspects of the area. The area of this well is sand dunes with scruboak, beargrass, and

very sparse vegetation. The lateral roads are over the same terrain.

Company Sundance Oil Company

Representative B. S. Waller

Phone: Office 713-224-4526 Home 713-448-9812

Address: 1300 The Main Bldg.

Houston, TX 77002

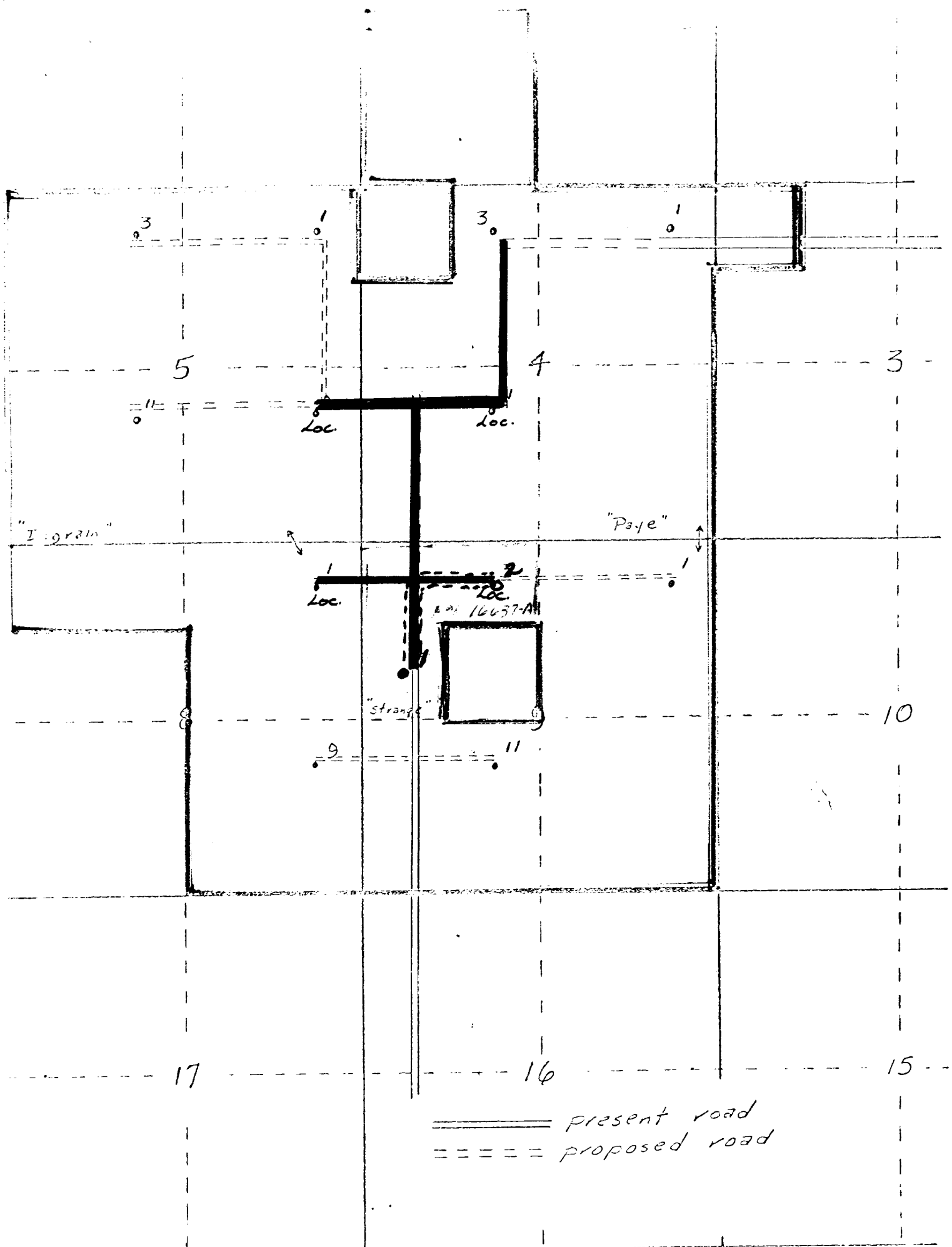

Loc.

Loc.

Loc.

Loc.

16637-A

"strange"

"I. grain"

"Paye"

17

16

15

==== present road
----- proposed road

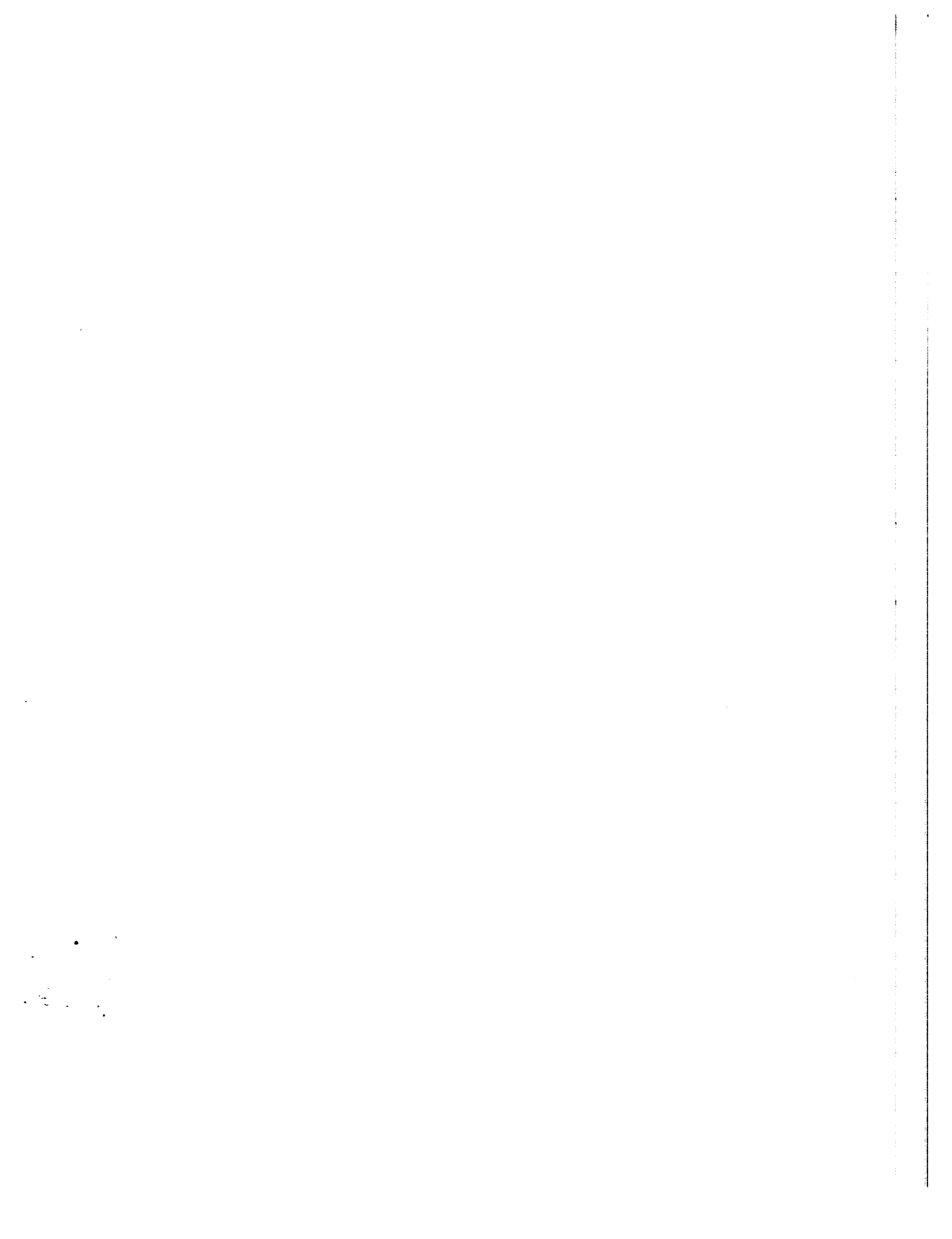



SUNDANCE OIL COMPANY

Existing roads

Planned access roads

Lateral roads to well

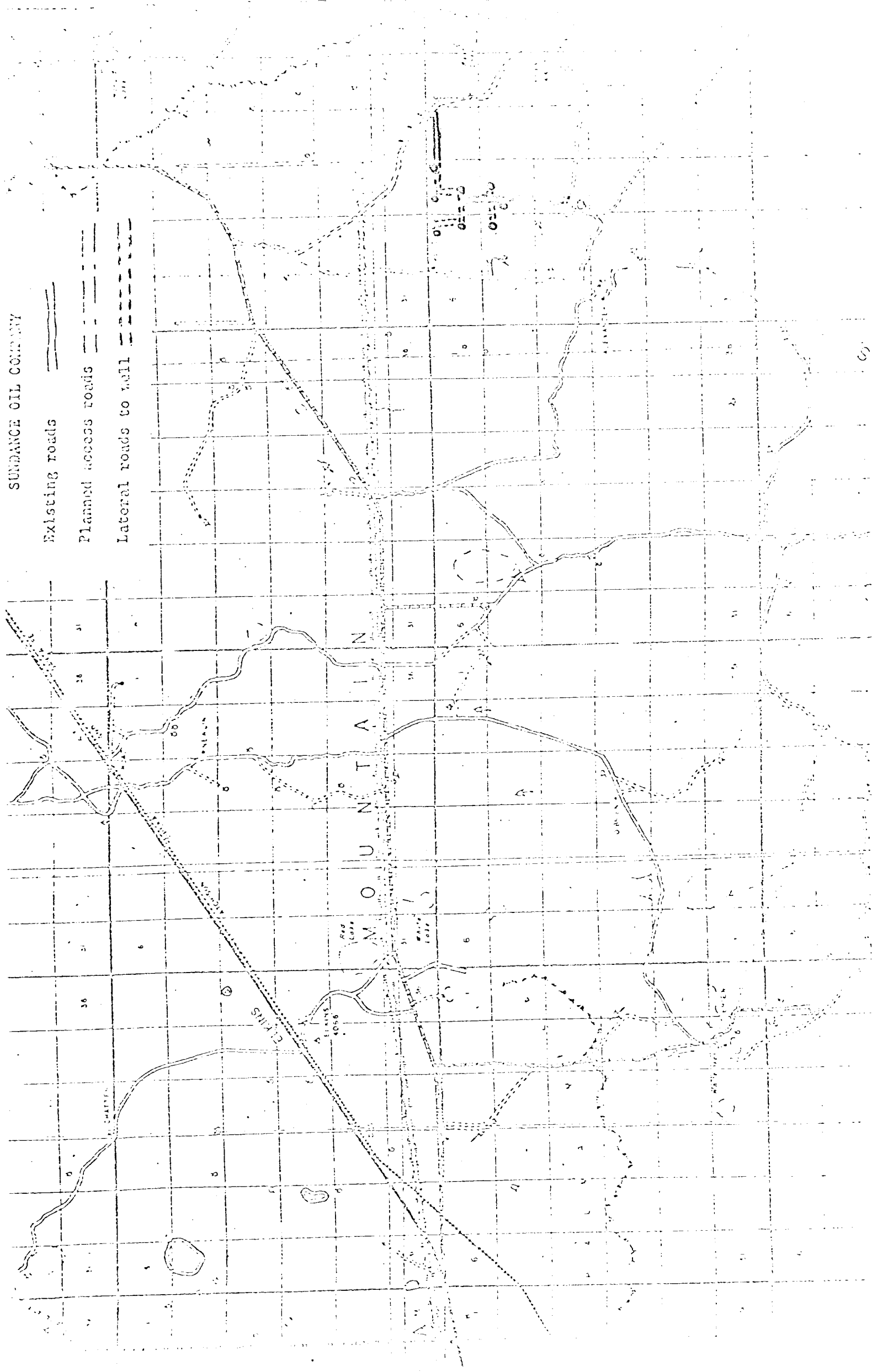



DATE: 10/10/2014 TIME: 10:00 AM 56 0700
REVISED BY: [unclear]
REVISED BY: [unclear]

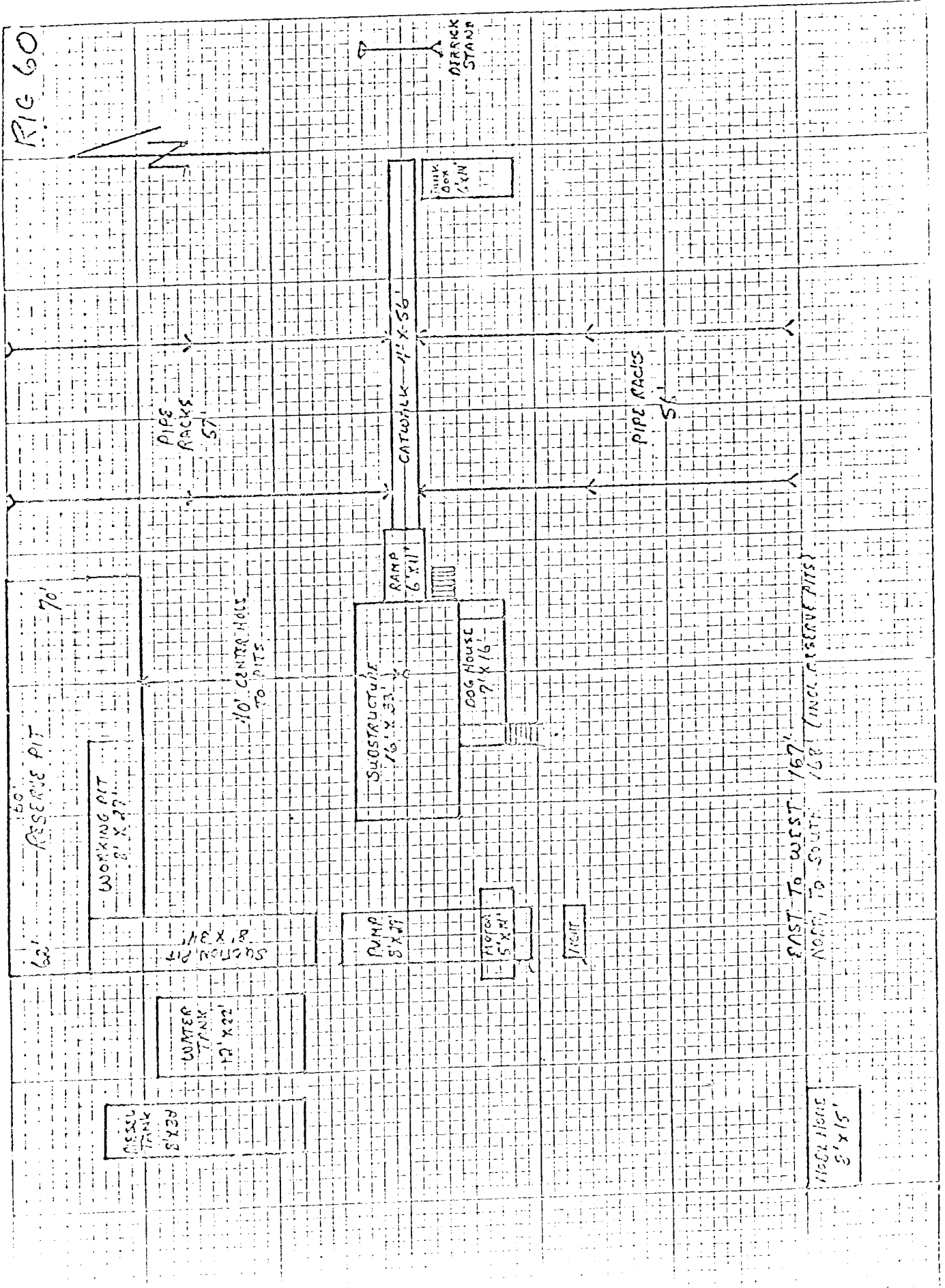

RIG 60

RESERVE PIT
160' x 70'

WORKING PIT
8' x 27'

SECTION PIT
12' x 24'

WATER TANK
12' x 22'

PUMP
8' x 11'

MOTOR
5' x 11'

TRAIL

SUBSTRUCTURE
16' x 33'

DOG HOUSE
7' x 16'

RAMP
6' x 11'

CATWALK
4' x 56'

PIPE RACKS
57'

PIPE RACKS
5'

PIPE RACK DOOR
6' x 4'

DERRICK STAND

WATER TANK
15' x 33'

DOG HOUSE
8' x 15'

157' x 157'
EAST TO WEST
NORTH TO SOUTH

RESERVE PIT
158' x 158'
EAST TO WEST
NORTH TO SOUTH

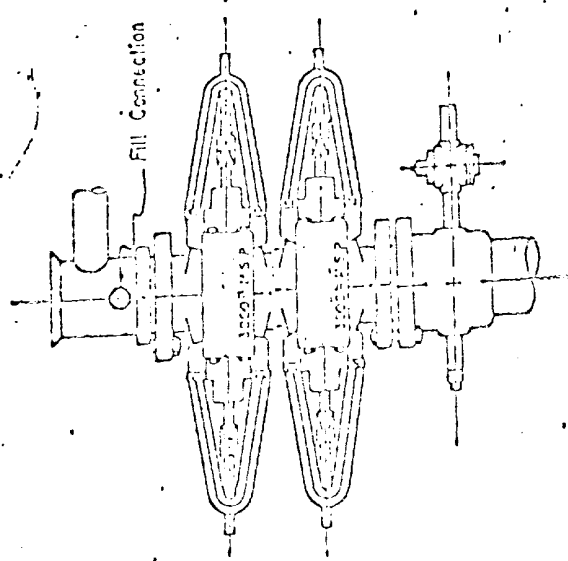

3,000 PSI WORKING PRESSURE
BLOWOUT PREVENTER HOOK-UP

Series 500 Flanges, or Better

RECEIVED
AUG 1975
D. C. C.
ARTEBIA, OFFICE