

COPY TO O. C. C.

Form 9-331 C
(May 1963)

SUBMIT IN TRIPLICATE*
(Other instructions on reverse side)

Form approved.
Budget Bureau No. 42-R1425.

UNITED STATES
DEPARTMENT OF THE INTERIOR
GEOLOGICAL SURVEY

30-005-20758
5. LEASE DESIGNATION AND SERIAL NO.
M 13999

APPLICATION FOR PERMIT TO DRILL, DEEPEN, OR PLUG BACK

1a. TYPE OF WORK
DRILL DEEPEN PLUG BACK

6. IF INDIAN, ALLOTTEE OR TRIBE NAME

7. UNIT AGREEMENT NAME

b. TYPE OF WELL
OIL WELL GAS WELL OTHER
SINGLE ZONE MULTIPLE ZONE

8. FARM OR LEASE NAME
Dachner Federal

2. NAME OF OPERATOR
ET Ranch, Inc.

9. WELL NO.
#8

3. ADDRESS OF OPERATOR
7003 Broadway, Lubbock, Texas 79401

10. FIELD AND POOL, OR WILDCAT
Chaveroo (SA)

4. LOCATION OF WELL (Elevations in feet, in accordance with any State requirements.*)
At surface 990' PSE & 2200' FWL

11. SEC., T., R., M., OR BLK. AND SURVEY OR AREA
Sec. 3, T8C, R32E

At proposed prod. zone

14. DISTANCE IN MILES AND DIRECTION FROM NEAREST TOWN OR POST OFFICE*
20 miles south of Elida, New Mexico

12. COUNTY OR PARISH Chaves
13. STATE New Mexico

15. DISTANCE FROM PROPOSED* LOCATION TO NEAREST PROPERTY OR LEASE LINE, FT. (Also to nearest drlg. unit line, if any)
440

16. NO. OF ACRES IN LEASE
160

17. NO. OF ACRES ASSIGNED TO THIS WELL
40

18. DISTANCE FROM PROPOSED LOCATION* TO NEAREST WELL, DRILLING, COMPLETED, OR APPLIED FOR, ON THIS LEASE, FT.
1320

19. PROPOSED DEPTH
4375

20. ROTARY OR CABLE TOOLS
Rotary

21. ELEVATIONS (Show whether OF, RT, GR, etc.)
4482.1

22. APPROX. DATE WORK WILL START*
Aug. 22, 1980

23. PROPOSED CASING AND CEMENTING PROGRAM

SIZE OF PIPE	SIZE OF CASING	WEIGHT PER FOOT	SETTING DEPTH	QUANTITY OF CEMENT
12-7/8	8-5/8	23#	1700	550 Circulate
7-7/8	4-1/2	10.5#	4375	175

Mud Program: 10# Mud, 35 Viscosity from 4000' to TD
BOP Program: See Attached C, D, & E

RECEIVED

JUL 7 1980

U. S. GEOLOGICAL SURVEY
HOBBS, NEW MEXICO

IN ABOVE SPACE DESCRIBE PROPOSED PROGRAM: If proposal is to deepen or plug back, give data on present productive zone and proposed new productive zone. If proposal is to drill or deepen directionally, give pertinent data on subsurface locations and measured and true vertical depths. Give blowout preventer program, if any.

24. SIGNED Robert R. Randa TITLE Agent DATE July 2, 1980

(This space for Federal or State office use)

PERMIT NO. _____ APPROVAL DATE _____

APPROVED BY _____ TITLE _____
CONDITIONS OF APPROVAL, IF ANY:

APPROVED
AS AMENDED
AUG 15 1980
DISTRICT SUPERVISOR

Instructions

General: This form is designed for submitting proposals to perform certain well operations, as indicated, on all types of lands and leases for appropriate action by either a Federal or a State agency, or both, pursuant to applicable Federal and/or State laws and regulations. Any necessary special instructions concerning the use of this form and the number of copies to be submitted, particularly with regard to local, area, or regional procedures and practices, either are shown below or will be issued by, or may be obtained from, the local Federal and/or State office.

Item 1: If the proposal is to redrill to the same reservoir at a different subsurface location or to a new reservoir, use this form with appropriate notations. Consult applicable State or Federal regulations concerning subsequent work proposals or reports on the well.

Item 4: If there are no applicable State requirements, locations on Federal or Indian land should be described in accordance with Federal requirements. Consult local State or Federal office for specific instructions.

Item 14: Needed only when location of well cannot readily be found by road from the land or lease description. A plat, or plats, separate or on this reverse side, showing the roads to, and the surveyed location of, the well, and any other required information, should be furnished when required by Federal or State agency offices.

Items 15 and 18: If well is to be, or has been directionally drilled, give distances for subsurface location of hole in any present or objective production zone.

Item 22: Consult applicable Federal or State regulations, or appropriate officials, concerning approval of the proposal before operations are started.

☆ U.S. GOVERNMENT PRINTING OFFICE: 1965-O-711-366

RECEIVED

AUG 26 1980

OIL CONSERVATION DIV.

NEW MEXICO OIL CONSERVATION COMMISSION
WELL LOCATION AND ACREAGE DEDICATION PLAT

Form C-102
Supersedes C-128
Effective 1-1-65

All distances must be from the outer boundaries of the Section.

Operator EL RAN, INC.			Lease # Dachner			Well No. 8		
Unit Letter N	Section 3	Township 8 South	Range 32 East	County Chaves				
Actual Footage Location of Well: 990 feet from the South line and 2200 feet from the West line								
Ground Level Elev. 4482.1	Producing Formation San Andres		Pool Chaveroo			Dedicated Acreage: 40 Acres		

1. Outline the acreage dedicated to the subject well by colored pencil or hachure marks on the plat below.
2. If more than one lease is dedicated to the well, outline each and identify the ownership thereof (both as to working interest and royalty).
3. If more than one lease of different ownership is dedicated to the well, have the interests of all owners been consolidated by communitization, unitization, force-pooling, etc?

Yes No If answer is "yes," type of consolidation **Federal Minerals**

If answer is "no," list the owners and tract descriptions which have actually been consolidated. (Use reverse side of this form if necessary.) _____

No allowable will be assigned to the well until all interests have been consolidated (by communitization, unitization, forced-pooling, or otherwise) or until a non-standard unit, eliminating such interests, has been approved by the Commission.

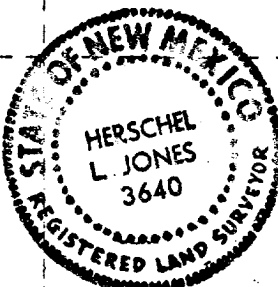
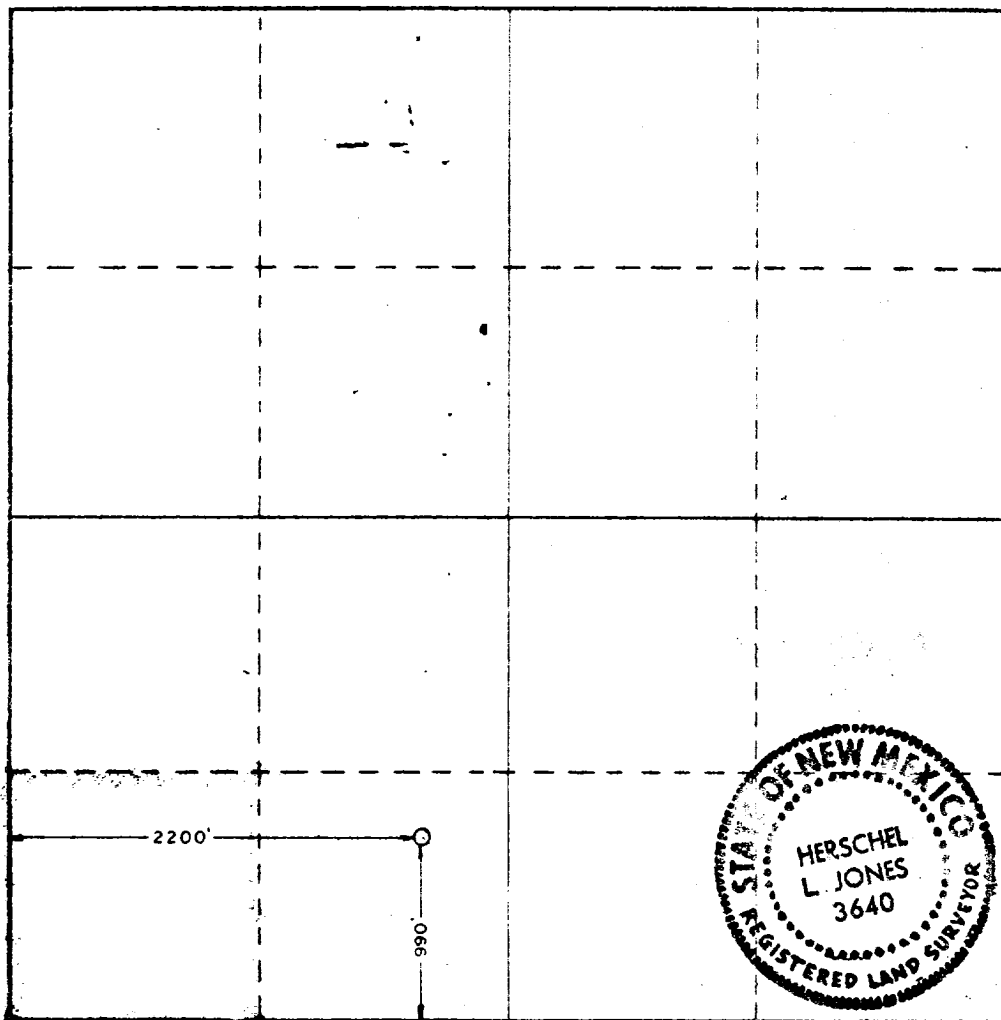

CERTIFICATION

I hereby certify that the information contained herein is true and complete to the best of my knowledge and belief.

Robert R. Ranck

Name Robert R. Ranck
Position Vice-President
Company El Ran, Inc.
Date July 2, 1980

I hereby certify that the well location shown on this plat was plotted from field notes of actual surveys made by me or under my supervision, and that the same is true and correct to the best of my knowledge and belief.

Date Surveyed 6-19-80
Registered Professional Engineer and/or Land Surveyor <i>Herschel L. Jones</i>
Certificate No. 3640

APPLICATION FOR DRILLING

EL RAN, INC.

DACHNER FEDERAL #8
SECTION 3, T8S, R32E
CHAVES COUNTY, NEW MEXICO

In conjunction with Form 9-331-C, Application for Permit to Drill subject well, El Ran, Inc. submits the following ten items of pertinent information.

1. The geologic surface formation is the Ogallala formation.
2. The estimated tops of geologic markers are as follows:

Yates	2380'
San Andres	3058'

3. The depths at which anticipated water, oil or gas formations are expected to be encountered:

Water: No data available. Probably from Triassic formation at approximately 500 to 600 feet.

Oil or Gas: San Andres at approximately 3478 feet to 4375 feet.

4. Proposed casing program: See Form 9-331-C
5. Pressure control equipment: See Exhibits C, D, and E.
6. Mud Program: See Form 9-331-C.
7. Auxiliary equipment: See Exhibit D.
8. Testing, logging and coring programs: None.
9. No abnormal temperatures or pressures are anticipated.
10. Anticipated starting date: As soon as possible.
Anticipated completion of drilling operations: Approximately 7 days after starting date.