

Exxon Lse. No. _____

MEXICO OIL CONSERVATION COMMISSION
WELL LOCATION AND ACREAGE DEDICATION PLAT

Form C-102
Supersedes C-128
Effective 1-1-65

State Lse. No. _____

Federal Lse. No. _____

All distances must be from the outer boundaries of the Section.

Operator Petroleum Development Corporation			Lease Wattam Fed		Well No. 4
Unit Letter H	Section 6	Township 8S	Range 31E	County Chavez	
Actual Footage Location of Well: 2060 feet from the North line and 598 feet from the East line					
Ground Level Elev: 4219'	Producing Formation San Andres	Pool Fornhawk Cato	Dedicated Acreage: 40 Acres		

1. Outline the acreage dedicated to the subject well by colored pencil or hachure marks on the plat below.
2. If more than one lease is dedicated to the well, outline each and identify the ownership thereof (both as to working interest and royalty).
3. If more than one lease of different ownership is dedicated to the well, have the interests of all owners been consolidated by communitization, unitization, force-pooling, etc?

Yes No If answer is "yes," type of consolidation _____

If answer is "no," list the owners and tract descriptions which have actually been consolidated. (Use reverse side of this form if necessary.) _____

No allowable will be assigned to the well until all interests have been consolidated (by communitization, unitization, forced-pooling, or otherwise) or until a non-standard unit, eliminating such interests, has been approved by the Commission.

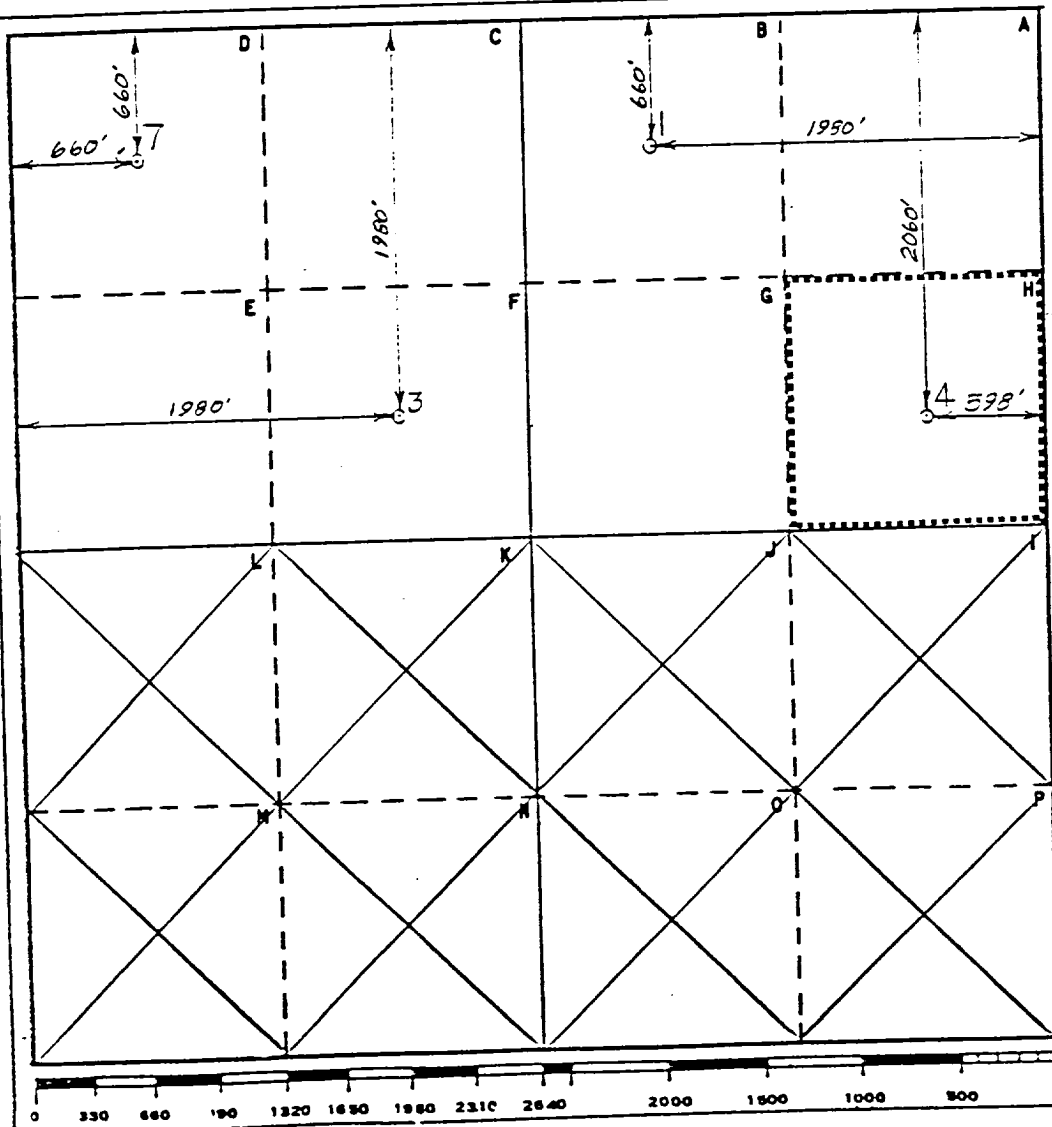

CERTIFICATION

I hereby certify that the information contained herein is true and complete to the best of my knowledge and belief.

Name *Edgar Ruschel*
Position *Proration Specialist*
Company *Exxon Corporation*
Box 1600 Midland, Texas
Date *6-11-81*

I hereby certify that the well location shown on this plat was plotted from field notes of actual surveys made by me or under my supervision, and that the same is true and correct to the best of my knowledge and belief.

Date Surveyed *5-19-81*
Registered Professional Engineer and/or Land Surveyor

H. S. Westerbeld
Certificate No. *1382*



RECEIVED

MAR 21 1993

WOBBS
RCS