

All distances must be from the outer boundaries of the Section.

Lessor Murphey Operating Corp.		Lessee Ingram Federal		Well No. 20
Unit Section N 9	Township 8 South	Range 31 East	County Chaves	
Well Location of Well 330 feet from the South line and 1650 feet from the West line				
Original Level Elev. 4231'	Producing Formation San Andres	Perforations Siete San Andres	Dedicated Acreage 40 Acres	

- Outline the acreage dedicated to the subject well by colored pencil or hachure marks on the plat below.
- If more than one lease is dedicated to the well, outline each and identify the ownership thereof (both as to working interest and royalty).
- If more than one lease of different ownership is dedicated to the well, have the interests of all owners been consolidated by communitization, unitization, force-pooling, etc?

Yes No If answer is "yes;" type of consolidation _____

If answer is "no," list the owners and tract descriptions which have actually been consolidated. (Use reverse side of this form if necessary.) _____

No allowable will be assigned to the well until all interests have been consolidated (by communitization, unitization, force-pooling, or otherwise) or until a non-standard unit, eliminating such interests, has been approved by the Division

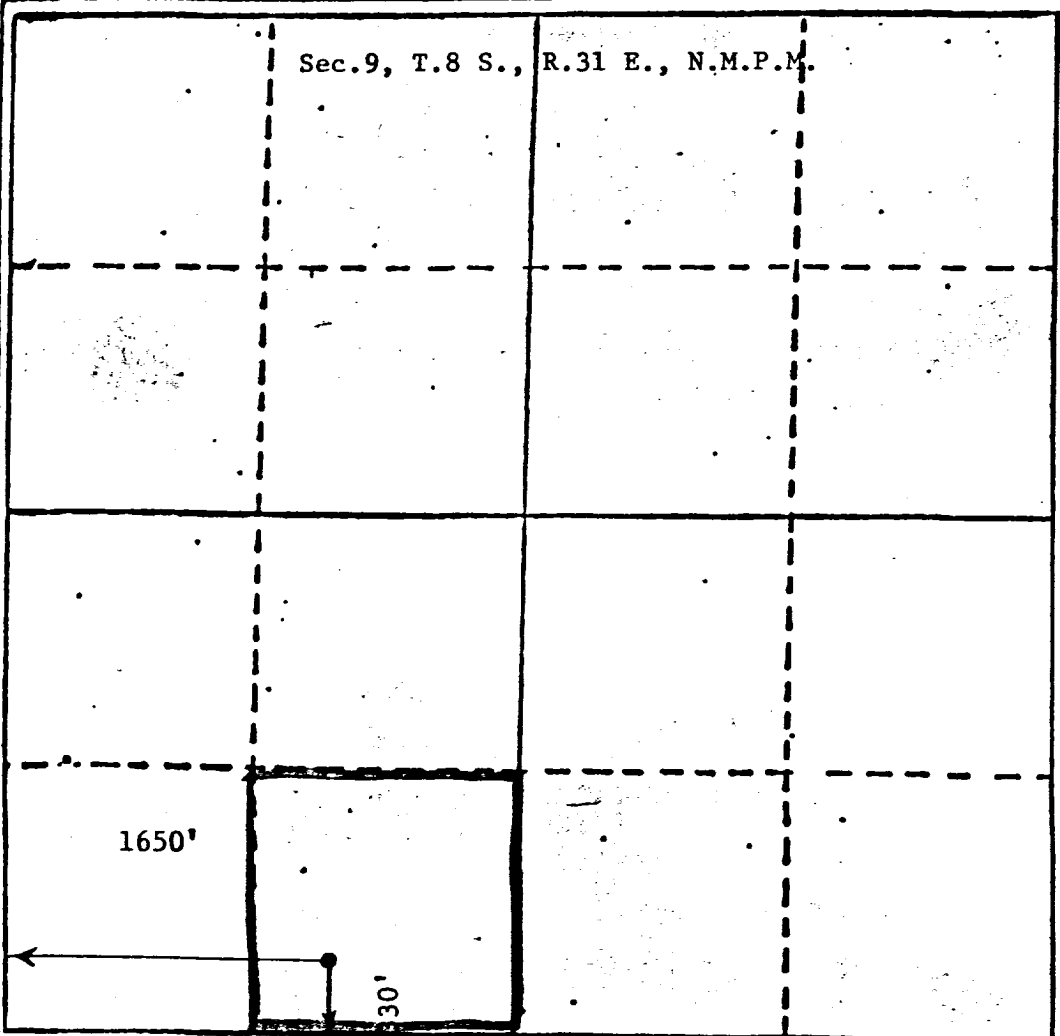

CERTIFICATION

I hereby certify that the information contained herein is true and complete to the best of my knowledge and belief.

Mark B. Murphy

Name
Mark B. Murphy

Position
Vice President

Company
Murphy Operating Corporation

Date
June 1, 1985

I hereby certify that the well location shown on this plat was plotted from field notes of actual surveys made by me or under my supervision, and that the same is true and correct to the best of my knowledge and belief.



Date Surveyed
March 1, 1980

Registered Professional Engineer
John D. Jaquess, P.E. & L.S.

Certificate No.
6290