

NEW MEXICO OIL CONSERVATION COMMISSION

Santa Fe, New Mexico

NOTICE OF INTENTION TO DRILL OR RECOMPLETE

Notice must be given to the District Office of the Oil Conservation Commission and approval obtained before drilling or recompletion begins. If changes in the proposed plan are considered advisable, a copy of this notice showing such changes will be returned to the sender. Submit this notice in QUINTUPLICATE. One copy will be returned following approval. See additional instructions in Rules and Regulations of the Commission.

Midland, Texas

(Place)

October 18, 1955

(Date)

OIL CONSERVATION COMMISSION  
SANTA FE, NEW MEXICO

Gentlemen:

You are hereby notified that it is our intention to commence the (Drilling) (~~RECOMPLETION~~) of a well to be known as

**The Superior Oil Company**

(Company or Operator)

State "335-B"

(Lease)

Well No. **4-335B**

in **E**

(Unit)

located **1980** feet from the **North** line and **660** feet from the

**West**

line of Section **30**, T. **13-S**, R. **32-E**, NMPM.

(GIVE LOCATION FROM SECTION LINE)

**Caprock (Queen)**

Pool,

**Lee**

County

If State Land the Oil and Gas Lease is No. **E-8005**

If patented land the owner is **-----**

Address **-----**

We propose to drill well with drilling equipment as follows: **Rotary Rig**

The status of plugging bond is **Active**

Drilling Contractor **Unknown at this time**

We intend to complete this well in the **Queen Sand**

formation at an approximate depth of **3050'** feet.

CASING PROGRAM

We propose to use the following strings of Casing and to cement them as indicated:

Size of Hole	Size of Casing	Weight per Foot	New or Second Hand	Depth	Sacks Cement
<b>12-1/4"</b>	<b>9-5/8"</b>	<b>32#</b>	<b>NEW</b>	<b>850</b>	<b>Will circulate</b>
<b>8-3/4"</b>	<b>7"</b>	<b>20#</b>	<b>NEW</b>	<b>3050'</b>	<b>w/150 sac</b>

If changes in the above plans become advisable we will notify you immediately.

ADDITIONAL INFORMATION (If recompletion give full details of proposed plan of work.)

OCT 20 1955

Approved **-----**, 19 **-----**  
Except as follows:

OIL CONSERVATION COMMISSION

By **-----**

Title **Engineer District 1**

Sincerely yours,

**THE SUPERIOR OIL COMPANY**  
(Company or Operator)

By **Herman High**

**Herman High**

Position **Petroleum Engineer**

Send Communications regarding well to

Name **Mr. J. E. Boskey**

Address **Midland, Texas**

MEMBER  
AMERICAN SOCIETY OF  
CIVIL ENGINEERS

ARIZONA  
COLORADO  
IDAHO  
LOUISIANA  
MONTANA  
NEVADA  
NEW MEXICO  
OKLAHOMA  
TEXAS  
UTAH  
WYOMING

MIDLAND, TEXAS

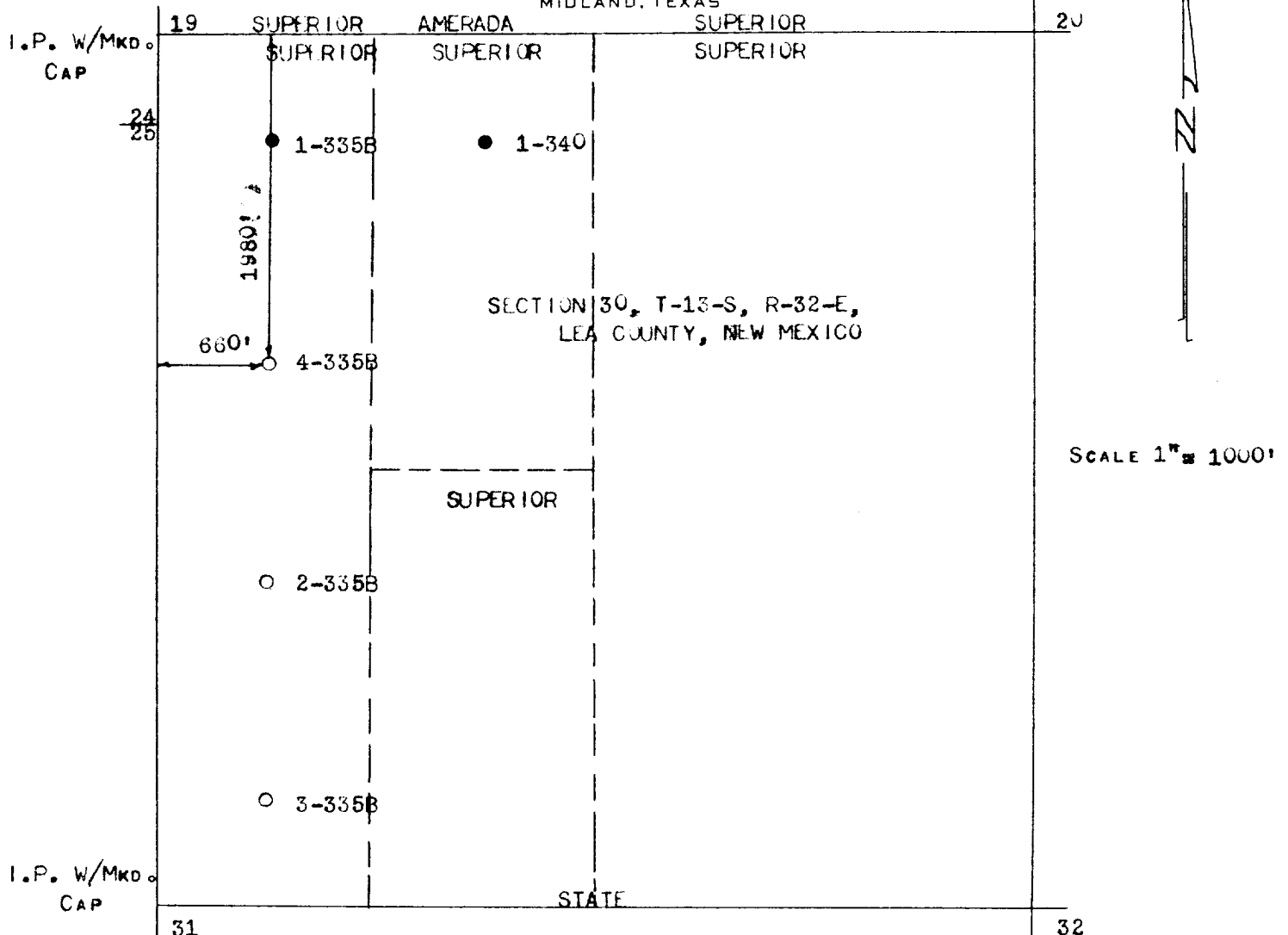

I, EARL K. MONTEITH, REGISTERED LAND SURVEYOR #1317, STATE OF NEW MEXICO HEREBY CERTIFY THAT THIS WELL LOCATION: SUPERIOR OIL CO. -STATE #4-335B, 1980' FROM NORTH LINE AND 660' FROM WEST LINE, SECTION 30, T-13-S, R-32-E, LEA COUNTY, NEW MEXICO WAS STAKED ON THE GROUND UNDER MY SUPERVISION AND THAT THIS PLAT IS TRUE AND CORRECT.

OCTOBER 17, 1955

OCTOBER 17, 1955

Earl H. Montross

EARL K. MONTEITH

