

NEW MEXICO OIL CONSERVATION COMMISSION
WELL LOCATION AND ACREAGE DEDICATION PLAT

FORM C-128
Revised 5/1/57

SEE INSTRUCTIONS FOR COMPLETING THIS FORM ON THE REVERSE SIDE

| | | | | | | | | | |
|---------------------------------------------------------------------------------------------------------------------------------------|----------------------|------------------------------------------|-------------------------|---------------------------------|--|----------------------------------------|---------------------------------------|----------------|--|
| Operator TEXACO Inc. | | | | SECTION A 100 MAY 13 PM 2:24 | | Lease State of New Mexico "O" NCT-3 | | Well No. 23 | |
| Unit Letter E | Section 12 | Township 17 South | Range 32 East | County Lea | | | | | |
| Actual Footage Location of Well: 1980 feet from the North line and 660 feet from the West line Sec. 12 | | | | | | | | | |
| Ground Level Elev. 4247 | | Producing Formation San Andres | | Pool Roberts | | | Dedicated Acreage: 40 Acres | | |

1. Is the Operator the only owner in the dedicated acreage outlined on the plat below? YES X NO ____ . ("Owner" means the person who has the right to drill into and to produce from any pool and to appropriate the production either for himself or for himself and another. (65-3-29 (e) NMSA 1935 Comp.)
2. If the answer to question one is "no," have the interests of all the owners been consolidated by communitization agreement or otherwise? YES ____ NO ____ . If answer is "yes," Type of Consolidation ____
3. If the answer to question two is "no," list all the owners and their respective interests below:

| Owner | Land Description |
|-------|------------------|
| | |
| | |

SECTION B

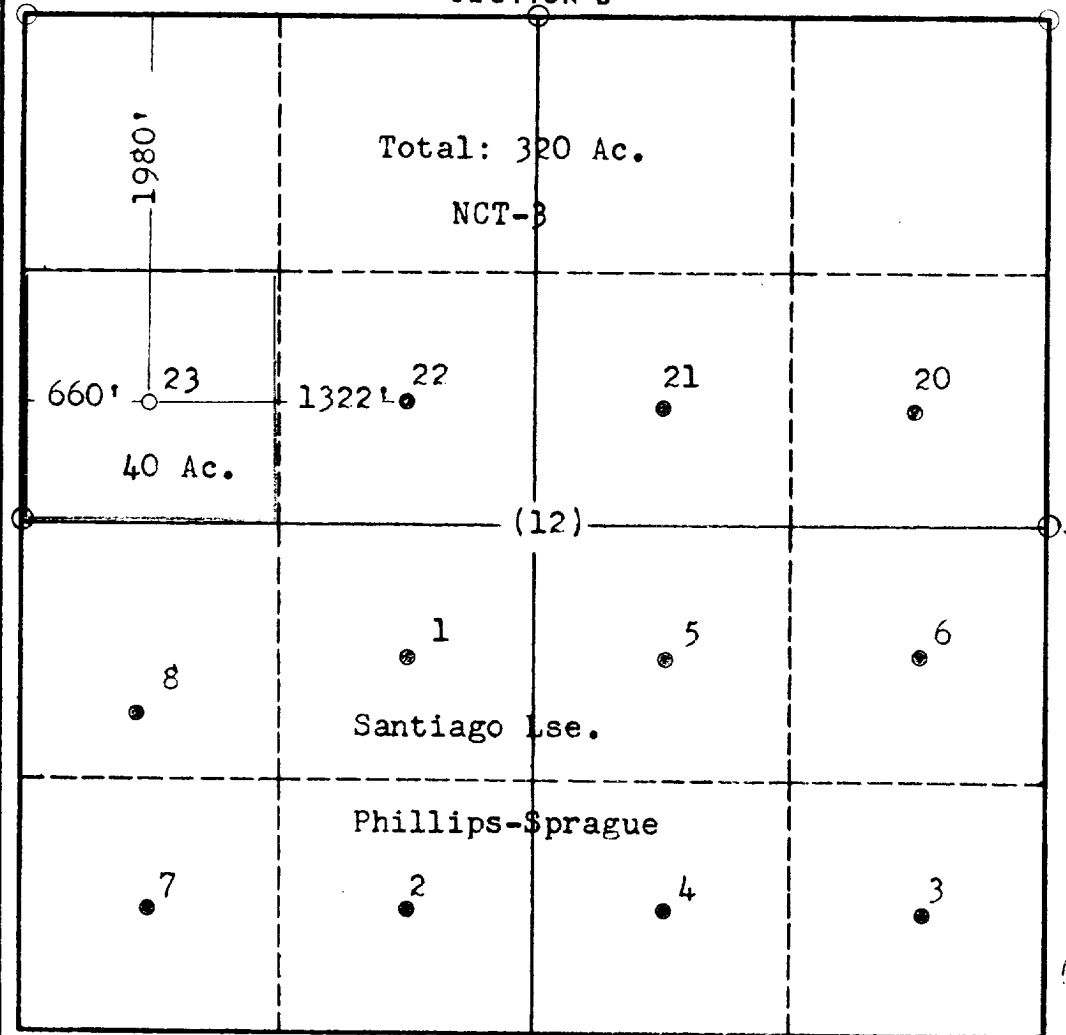

CERTIFICATION

I hereby certify that the information in SECTION A above is true and complete to the best of my knowledge and belief.

Name J. J. Velten
 Position Division Civil Engineer
 Company TEXACO Inc.
 Date 5/17/60

GLO Marker

I hereby certify that the well location shown on the plat in SECTION B was plotted from field notes of actual surveys made by me or under my supervision, and that the same is true and correct to the best of my knowledge and belief.

Date Surveyed 5-16-60
 Registered Professional Engineer and/or Land Surveyor J. J. Velten
 Certificate No. 8174