

NEW MEXICO OIL CONSERVATION COMMISSION

Well Location and Acreage-Dedication Plat

Section A.

1957 JUL 9 10 00 AM DISTRICT OFFICE 000 Date 7-6-57

Operator Neville G. Penrose, Inc. Lease Vickers State
Well No. 2 Unit Letter I Section 4 Township 17 S Range 33 E NMPM
Located 660 Feet From East Line, 2310 Feet from South Line
County Lea G. L. Elevation 4170.22 Dedicated Acreage 40 Acres
Name of Producing Formation Grayburg or San Andres Pool Samuel

1. Is the Operator the only owner* in the dedicated acreage outlined on the plat below?
Yes _____ No
2. If the answer to question one is "no," have the interests of all the owners been consolidated by communitization agreement or otherwise? Yes No _____. If answer is "yes," Type of Consolidation joint venture
3. If the answer to question two is "no," list all the owners and their respective interests below:

Owner

Land Description

Section B

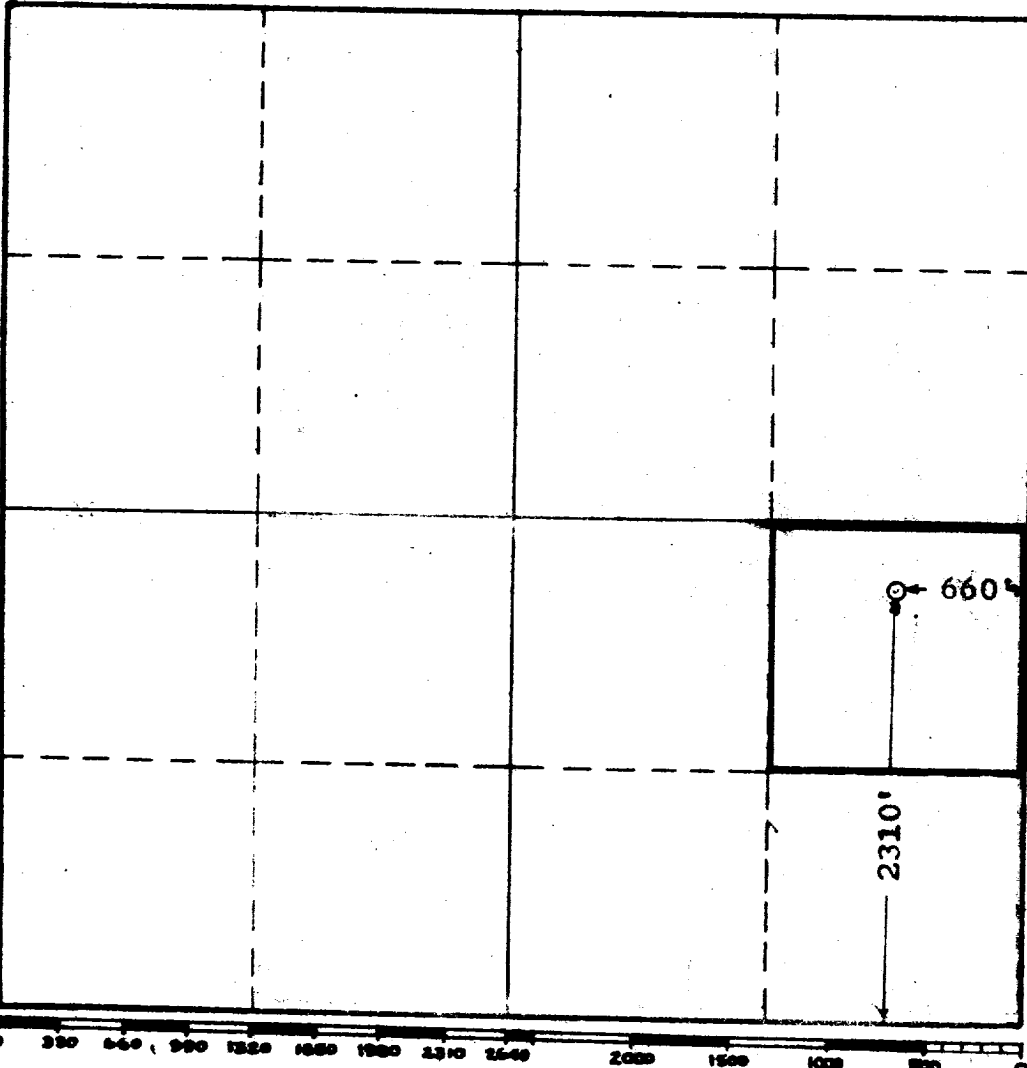

This is to certify that the information in Section A above is true and complete to the best of my knowledge and belief.

Neville G. Penrose, Inc.
(Operator)

Blair S. Reed
(Representative)

Box 988, Escalante, Utah
Address

This is to certify that the well location shown on the plat in Section B was plotted from field notes of actual surveys made by me or under my supervision and that the same is true and correct to the best of my knowledge and belief.

Date Surveyed 7-5-57

John W. West
Registered Professional
Engineer and/or Land Surveyor.

Certificate No. 676
the reverse side

(See instructions for completing this form on the reverse side)