

W. W. STUDDERT  
 MEMBER  
 AMERICAN SOCIETY OF  
 CIVIL ENGINEERS

REGISTERED ENGINEERS  
 & LAND SURVEYORS

ARIZONA  
 COLORADO  
 IDAHO  
 LOUISIANA  
 MONTANA  
 NEVADA  
 NEW MEXICO  
 OKLAHOMA  
 TEXAS  
 UTAH  
 WYOMING

**STUDDERT ENGINEERING CO.**  
 CIVIL ENGINEERS  
 221 SOUTH COLORADO  
 MIDLAND, TEXAS

TELEPHONES 4-8682 & 2-1373

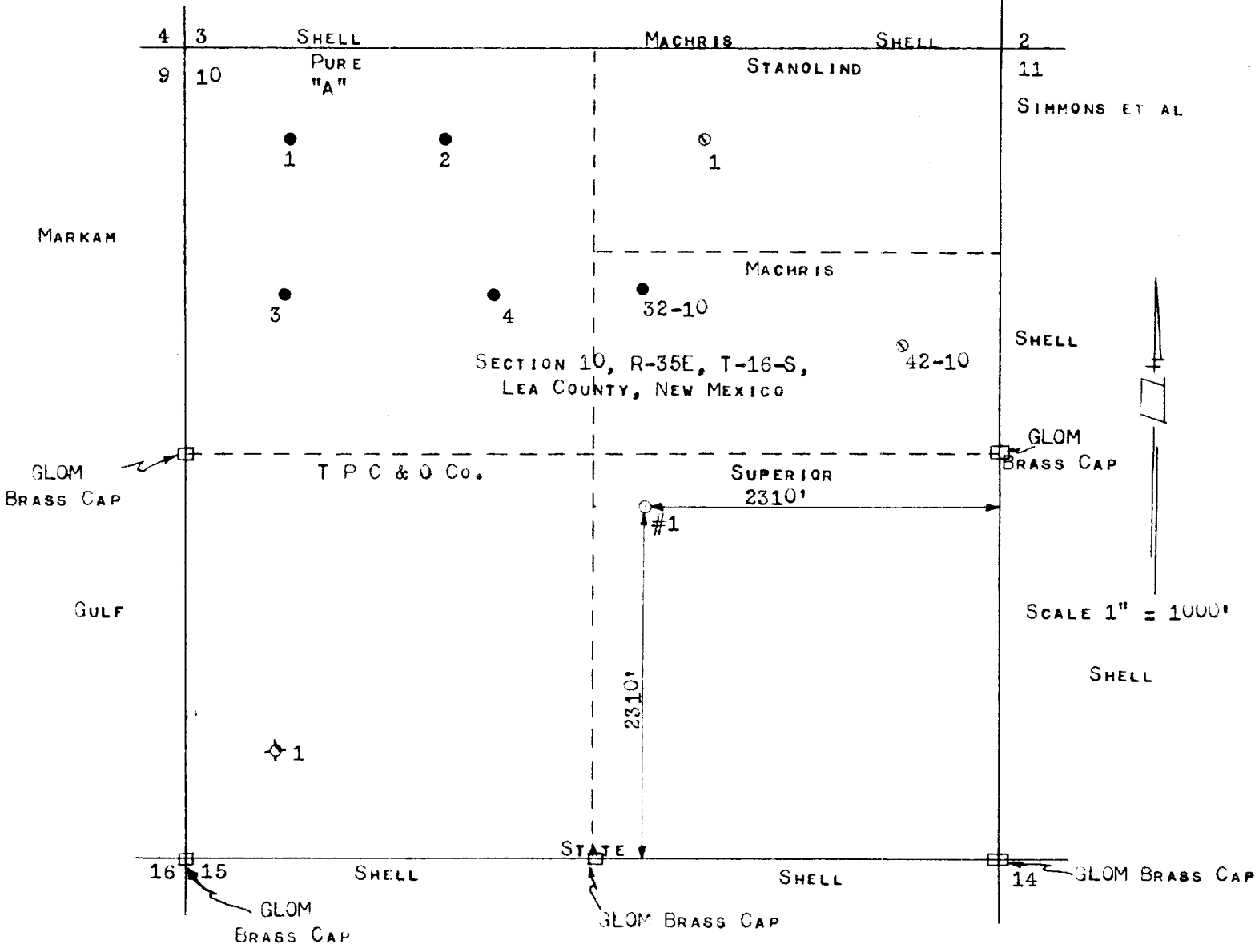

I, W. W. STUDDERT, REGISTERED PROFESSIONAL ENGINEER AND LICENSED LAND SURVEYOR, No. 388, STATE OF NEW MEXICO, HEREBY CERTIFY THAT THIS WELL LOCATION: THE SUPERIOR OIL CO. - STATE #1, 2310' FROM THE EAST AND SOUTH LINES OF SEC. 10, R-35-E, T-16-S, LEA COUNTY, NEW MEXICO, WAS STAKED ON THE GROUND BY ME AND THAT THIS PLAT IS TRUE AND CORRECT.

SEPT. 12, 1954

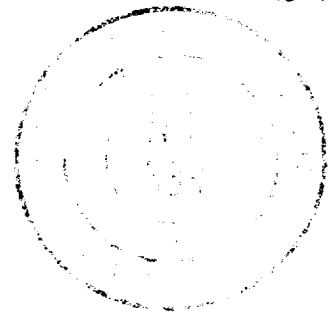

*W. W. Studdert*  
 W. W. STUDDERT