

Form 9-331a
(Feb. 1951)

(SUBMIT IN TRIPLICATE)

Land Office LAS CRUCES

Lease No. 059576

Unit 1

UNITED STATES
DEPARTMENT OF THE INTERIOR
GEOLOGICAL SURVEY

SUNDRY NOTICES AND REPORTS ON WELLS

NOTICE OF INTENTION TO DRILL.....	<input checked="" type="checkbox"/>	SUBSEQUENT REPORT OF WATER SHUT-OFF.....	
NOTICE OF INTENTION TO CHANGE PLANS.....		SUBSEQUENT REPORT OF SHOOTING OR ACIDIZING.....	
NOTICE OF INTENTION TO TEST WATER SHUT-OFF.....		SUBSEQUENT REPORT OF ALTERING CASING.....	
NOTICE OF INTENTION TO RE-DRILL OR REPAIR WELL.....		SUBSEQUENT REPORT OF RE-DRILLING OR REPAIR.....	
NOTICE OF INTENTION TO SHOOT OR ACIDIZE.....		SUBSEQUENT REPORT OF ABANDONMENT.....	
NOTICE OF INTENTION TO PULL OR ALTER CASING.....		SUPPLEMENTARY WELL HISTORY.....	
NOTICE OF INTENTION TO ABANDON WELL.....			

(INDICATE ABOVE BY CHECK MARK NATURE OF REPORT, NOTICE, OR OTHER DATA)

6.12 . 63

, 19

Well No. 50 is located 1080 ft. from 120 line and 660 ft. from E line of sec. 3

16.15. 3 (1/4 Sec. and Sec. No.) 17 (Twp.) 32 (Range) 1 (Meridian)

MALJANAR (Field) LEA (County or Subdivision) NEW MEXICO (State or Territory)

The elevation of the drill floor above sea level is 4370 ft.
GROUND

DETAILS OF WORK

(State names of and expected depths to objective sands; show sizes, weights, and lengths of proposed casings; indicate mudlogs, job placement points, and all other important proposed work)

11" HOLE @ 5/8" CASIN 360 FT. CIRCULATE CEMENT BACK TO TOP.

7 7/8" HOLE @ 1/2" CASIN 4225 FT. 360 SACKS CEMENT.

WILL DRILL WITH ROTARY TOOLS TOP TO BOTTOM

AUG 14 1963

ARTESIA, OFFICE

I understand that this plan of work must receive approval in writing by the Geological Survey before operations may be commenced.

Company LEONARD NICHOLS

Address MALJANAR

NEW MEXICO

By L. McCutcheon & P. McCutcheon

Title SRPT.

NUMBER OF COPIES RECEIVED	
DISTRIBUTION	
SANTA FE	
FILE	
U.S.G.S.	
LAND OFFICE	
TRANSPORTER	OIL
	GAS
PRODUCTION OFFICE	
OPERATOR	

NEW MEXICO OIL CONSERVATION COMMISSION

WELL LOCATION AND ACREAGE DEDICATION PLAT

SEE INSTRUCTIONS FOR COMPLETING THIS FORM ON THE REVERSE SIDE

FORM C-128
Revised 5/1/57

SECTION A

Operator Leonard Nichols		Lease Federal Iles		Well No. 30	
Unit Letter I	Section 3	Township T-17-S	Range R-32-E	County Lea	
Actual Footage Location of Well: 1980 feet from the South line and 660 feet from the East line					
Ground Level Elev. 4279	Producing Formation <i>Anyboy</i>		Pool <i>maljamar</i>	Dedicated Acreage: 40 Acres	

1. Is the Operator the only owner in the dedicated acreage outlined on the plat below? YES ☒ NO ____ . ("Owner" means the person who has the right to drill into and to produce from any pool and to appropriate the production either for himself or for himself and another. (65-3-29 (e) NMSA 1935 Comp.)
2. If the answer to question one is "no," have the interests of all the owners been consolidated by communitization agreement or otherwise? YES ____ NO ____ . If answer is "yes," Type of Consolidation _____
3. If the answer to question two is "no," list all the owners and their respective interests below:

Owner	Land Description

SECTION B

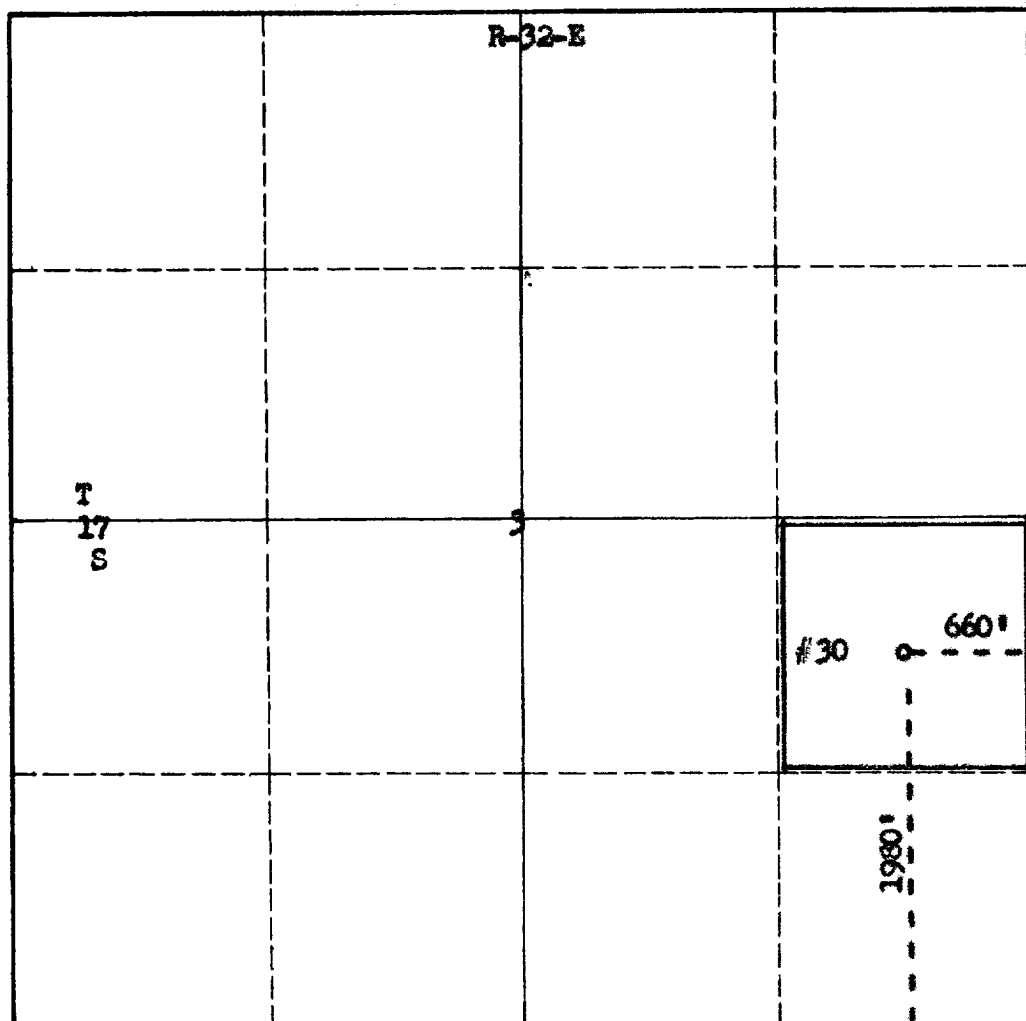

CERTIFICATION

I hereby certify that the information in SECTION A above is true and complete to the best of my knowledge and belief.

Name <i>D. S. McCutcheon</i>
Position <i>Supt.</i>
Company <i>Leonard Nichols</i>
Date <i>8-12-63</i>

I hereby certify that the well location shown on the plat in SECTION B was plotted from field notes of actual surveys made by me or under my supervision, and that the same is true and correct to the best of my knowledge and belief.

Date Surveyed August 6, 1963
Registered Professional Engineer and/or Land Surveyor

James H. Brown
Certificate No. **542**

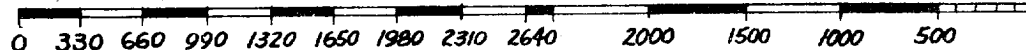

INSTRUCTIONS FOR COMPLETION OF FORM C-128

1. Operator shall furnish and certify to the information called for in Section A.
2. Operator shall outline the dedicated acreage for *both* oil and gas wells on the plat in Section B.
3. A registered professional engineer or land surveyor registered in the State of New Mexico or approved by the Commission shall show on the plat the location of the well and certify this information in the space provided.
4. All distances shown on the plat must be from the outer boundaries of the Section.
5. If additional space is needed for listing owners and their respective interests as required in question 3 of Section A, please use space below.