

NEW MEXICO OIL CONSERVATION COMMISSION
Santa Fe, New Mexico

NOTICE OF INTENTION TO DRILL OR RECOMPLETE

Notice must be given to the District Office of the Oil Conservation Commission and approval obtained before drilling or recompletion begins. If changes in the proposed plan are considered advisable, a copy of this notice showing such changes will be returned to the sender. Submit this notice in QUINTUPLICATE. One copy will be returned following approval. See additional instructions in Rules and Regulations of the Commission. If State Land submit 6 Copies

Hobbs, New Mexico
(Place)

January 19, 1962
(Date)

OIL CONSERVATION COMMISSION
SANTA FE, NEW MEXICO

Gentlemen:

You are hereby notified that it is our intention to commence the (Drilling) (~~RECOMPLETION~~) of a well to be known as
Skelly Oil Company
(Company or Operator)

Hobbs #1, Well No. **2**, in **"C"** (Lease) (Unit) The well is located **330** feet from the **North** line and **1690** feet from the **West** line of Section **8**, T. **18-S**, R. **31-E**, NMPM. (GIVE LOCATION FROM SECTION LINE) **Vacuum Abe** Pool, **Lee** County

If State Land the Oil and Gas Lease is No. **E-6704**

If patented land the owner is **-**

Address **-**

We propose to drill well with drilling equipment as follows: **To be drilled with rotary tools from surface to total depth.**

The status of plugging bond is **Blanket Bond No. 1251600 for \$100,000.00 with Federal Insurance Company.**

Drilling Contractor **Hende Drilling Company**
P. O. Box 116
Midland, Texas

We intend to complete this well in the **Abe** formation at an approximate depth of **9050'** feet.

CASING PROGRAM

We propose to use the following strings of Casing and to cement them as indicated:

Size of Hole	Size of Casing	Weight per Foot	New or Second Hand	Depth	Sacks Cement
17-1/4"	13-3/8"	48#	New	300'	300
11"	8-5/8"	32#	"	3250'	1100
7-7/8"	5-1/2"	17#	"	9050'	925

If changes in the above plans become advisable we will notify you immediately.

ADDITIONAL INFORMATION (If recompletion give full details of proposed plan of work.)

The pump & plug process will be used in cementing all strings of casing and cement will be circulated to surface behind the 13-3/8" OD casing.

Approved _____, 19____

Except as follows:

Control must tie back casing

OIL CONSERVATION COMMISSION

By _____

Sincerely yours,

Skelly Oil Company
(Company or Operator)

By **J. E. Cab**

Position **Dist. Supt.**

Name **Skelly Oil Company**

Address **Box 38 - Hobbs, New Mexico**

**NEW MEXICO OIL CONSERVATION COMMISSION
WELL LOCATION AND ACREAGE DEDICATION PLAT**

FORM C-128
Revised 5/1/57

SEE INSTRUCTIONS FOR COMPLETING THIS FORM ON THE REVERSE SIDE

SECTION A

Operator Skelly Oil Company		Lease Hobbs 111th		Well No. 2
Unit Letter C	Section 8	Township 18 South	Range 35 East	County Lea
Actual Footage Location of Well: 330 feet from the North line and 1650 feet from the West line				
Ground Level Elev.	Producing Formation Abo	Pool Vacuum Abo	Dedicated Acreage: 40 Acres	

1. Is the Operator the only owner in the dedicated acreage outlined on the plat below? YES NO ("Owner" means the person who has the right to drill into and to produce from any pool and to appropriate the production either for himself or for himself and another. (65-3-29 (e) NMSA 1935 Comp.)
2. If the answer to question one is "no," have the interests of all the owners been consolidated by communitization agreement or otherwise? YES NO . If answer is "yes," Type of Consolidation _____
3. If the answer to question two is "no," list all the owners and their respective interests below:

Owner	Land Description

SECTION B

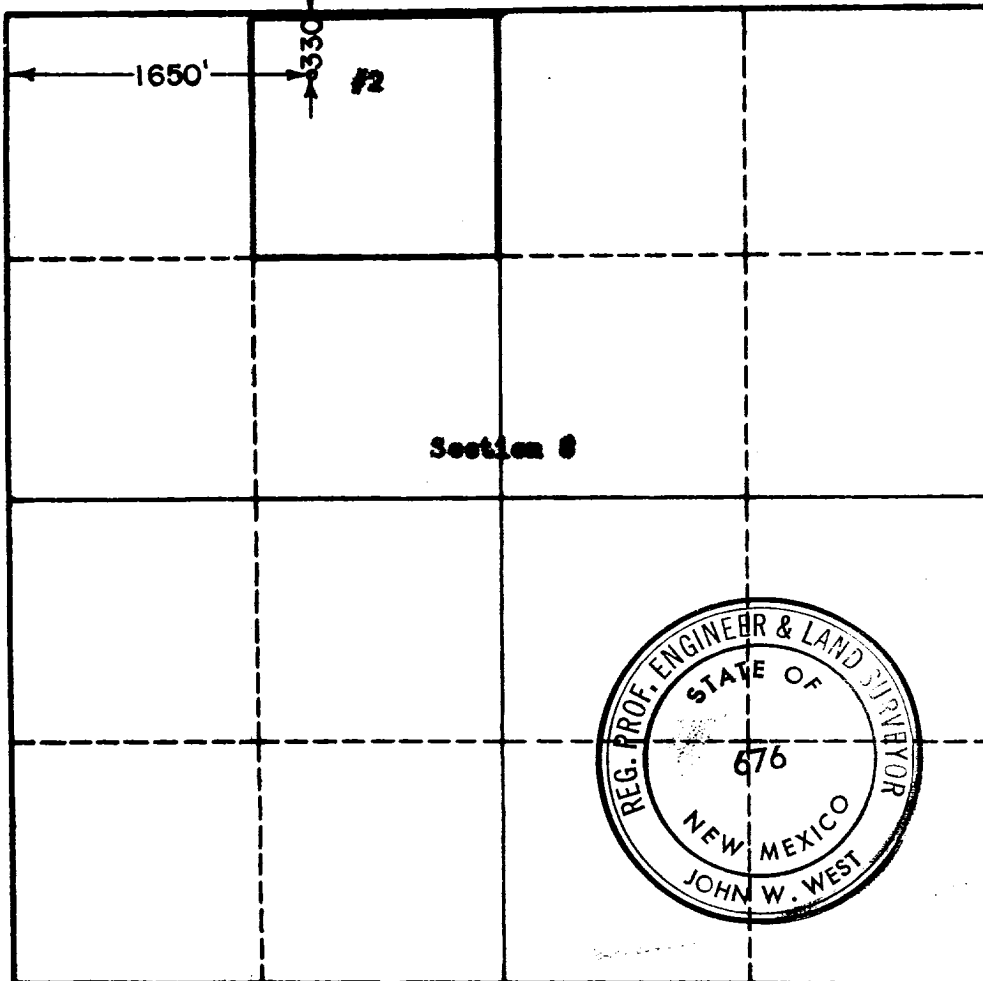

CERTIFICATION

I hereby certify that the information in SECTION A above is true and complete to the best of my knowledge and belief.

Name <i>J. E. Cook</i>
Position Dist. Supt.
Company Skelly Oil Company
Date January 19, 1962

I hereby certify that the well location shown on the plat in SECTION B was plotted from field notes of actual surveys made by me or under my supervision, and that the same is true and correct to the best of my knowledge and belief.

Date Surveyed 1-18-62
Registered Professional Engineer and/or Land Surveyor, JOHN W. WEST
<i>John W. West</i>
Certificate No. N. M. - P. E. & L. S. NO. 676

