

NEW MEXICO OIL CONSERVATION COMMISSION
Well Location and Acreage Dedication Plat

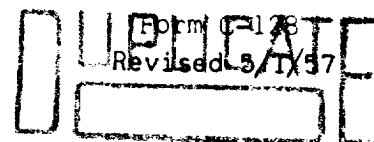

Section A.

Date 8-7-57

Operator Great Western Drilling Co. Lease Sylvester Johnson
Well No. 2 Unit Letter C Section 8 Township 18 S Range 39 E NMPM
Located 330 Feet From North Line, 1650 Feet From West Line
County Lea G. L. Elevation 3628.9 Dedicated Acreage 26 Acres
Name of Producing Formation _____ Pool South Carter (San Andres)

1. Is the Operator the only owner* in the dedicated acreage outlined on the plat below?
Yes X No _____.
2. If the answer to question one is "no," have the interests of all the owners been consolidated by communitization agreement or otherwise? Yes _____ No _____. If answer is "yes," Type of Consolidation _____
3. If the answer to question two is "no," list all the owners and their respective interests below:

Owner

Land Description

Section. B

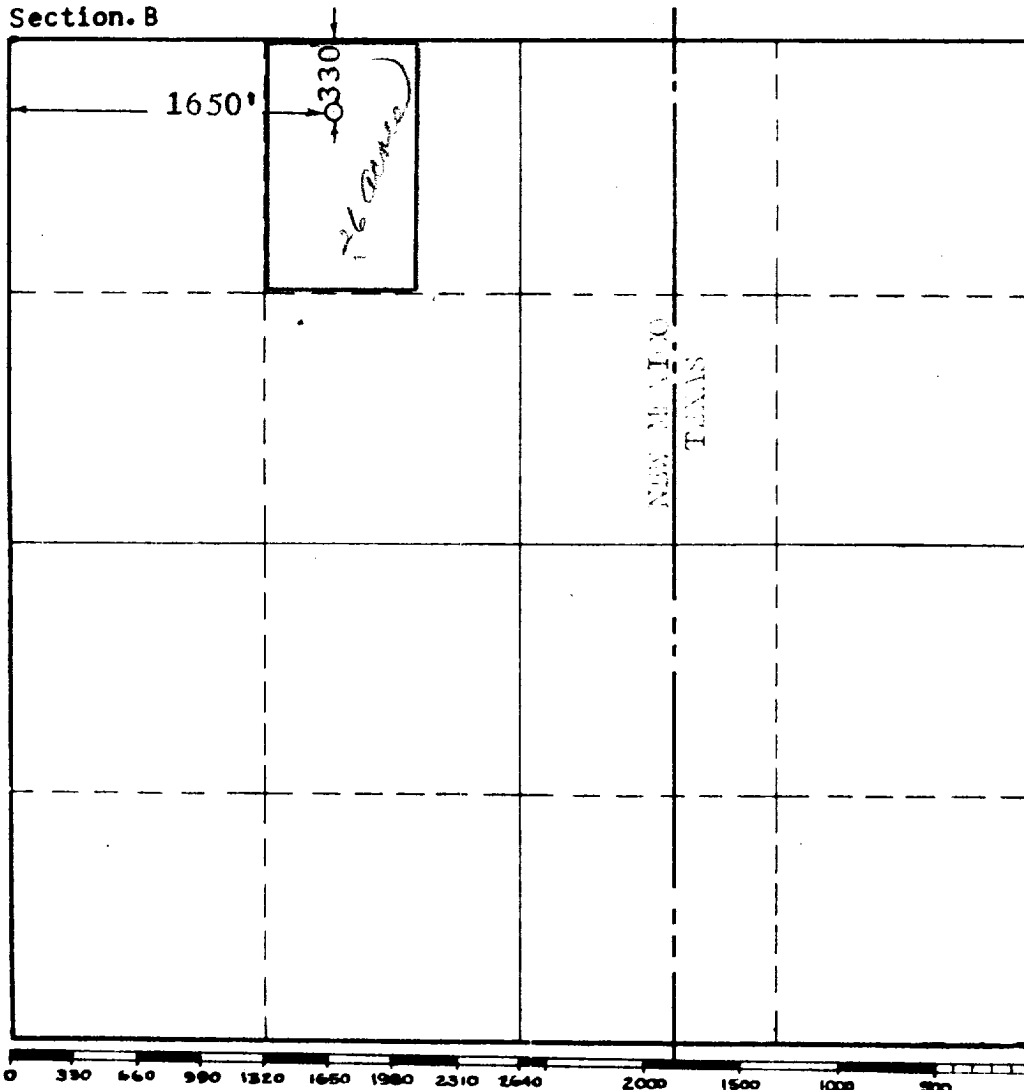

This is to certify that the information in Section A above is true and complete to the best of my knowledge and belief.

Great Western Drilling Company

(Operator)

Orlano

(Representative)

Box 1659, Midland, Texas

Address

This is to certify that the well location shown on the plat in Section B was plotted from field notes of actual surveys made by me or under my supervision and that the same is true and correct to the best of my knowledge and belief.

Date Surveyed 8-4-57

John W. West
Registered Professional
Engineer and/or Land Surveyor.

Certificate No. 676

(See instructions for completing this form on the reverse side)