

NEW MEXICO OIL CONSERVATION COMMISSION

Form C-101
Revised 1-1-65

| | |
|------------------|--|
| NAME OF OPERATOR | |
| ADDRESS | |
| CITY | |
| STATE | |
| ZIP | |
| PHONE | |
| DATE | |

5A. Indicate Type of Lease
STATE FEE

5. State Oil & Gas Lease No.

7. Unit Agreement Name

8. Farm or Lease Name
Stoltz, Wagner & Brown

9. Well No.
1

10. Field and Pool, or Wildcat
Undesignated Morrow

12. County
Lea

19. Proposed Depth: **13,600'** 19A. Formation: **Morrow** 20. Rotary or Casing: **Rotary**

21A. Kind & Status Plug. Bond: **Required/Approved** 21B. Drilling Contractor: **Not released** 22. Approx. Date Work will start: **September 1, 1974**

APPLICATION FOR PERMIT TO DRILL, DEEPEN, OR PLUG BACK

1. Name of Work

2. Kind of Well: DRILL DEEPEN PLUG BACK

3. Kind of Well: GAS WELL OTHER SINGLE ZONE MULTIPLE ZONE

4. Name of Operator: **Cities Service Oil Company**

5. Address of Operator: **Box 1919 - Midland, Texas 79701**

6. Location: UNIT LETTER **N** LOCATED **660'** FEET FROM THE **South** LINE
 ADJ. **1980** FEET FROM THE **West** LINE OF SEC. **3** TWP. **18S** RGE. **33E** NMPM

11. Previous Status (Show whether DE, RT, etc.): **4018' DF**

PROPOSED CASING AND CEMENT PROGRAM

| SIZE OF HOLE | SIZE OF CASING | WEIGHT PER FOOT | SETTING DEPTH | SACKS OF CEMENT | EST. TOP |
|--------------|----------------|-----------------|---------------|-----------------|------------|
| * 17 1/2" | 13 3/8" | 48# | 300' | 300 sacks | Circulated |
| * 12 1/4" | 9 5/8" | 36# | 3402' | 300 sacks | --- |
| 8 3/4" | 5 1/2" | 17# | 13600' | 1000 sacks | 9000' |

This well was originally drill to a T.D. of 10,520' by William G. Ross and plugged as a dry hole in September, 1963. Sinclair Oil and Gas Company, now Arco, deepened the well to a T.D. of 12,900' and plugged it as a dry hole in January, 1964. It is proposed to drill out the plugs and drill to a new T.D. of 13,600' and test the Morrow formation.

The blowout prevention program is as follows:

1. One set of blind rams.
2. One set of drill pipe rams.
3. One Hydril.
4. One rotating head.

* This casing was set and cemented by William G. Ross in 1963.

IN ABOVE SPACE DESCRIBE PROPOSED PROGRAM; IF PROPOSAL IS TO DEEPEN OR PLUG BACK, GIVE DATA ON PRESENT PRODUCTIVE ZONE AND PROPOSED NEW PRODUCTIVE ZONE. GIVE BLOWOUT PREVENTER PROGRAM, IF ANY.

I hereby certify that the information above is true and complete to the best of my knowledge and belief.

Signed *E. Spindler* Title Region Operation Manager Date August 16, 1974

(This space for State Use)
 APPROVED BY *John J. [Signature]* TITLE SUPERVISOR DISTRICT I DATE AUG 19 1974
 CONDITIONS OF APPROVAL, IF ANY:

NEW MEXICO OIL CONSERVATION COMMISSION
WELL LOCATION AND ACREAGE DEDICATION PLAN

Form O-112
Supersedes O-128
Effective 1-1-65

All distances must be from the outer boundaries of the Section

| | | | | | | | | | |
|--------------------------|--|----------------|--|-----------------------|--|----------|--|---------------------|--|
| City Service Oil Company | | Lease | | Stoltz Wagner & Brown | | Well No. | | 1 | |
| N | | Section | | 3 | | Township | | 18 South | |
| Range | | 33 East | | Lea | | County | | | |
| Acres | | 660 | | feet from the | | South | | line and | |
| 1980 | | feet from the | | West | | | | | |
| General Type of Well | | 4003' GR (Est) | | Morrow | | Pool | | Undesignated Morrow | |
| Dedicated Acreage | | 320 | | Area | | | | | |

- Outline the acreage dedicated to the subject well by colored pencil or hachure marks on the plat below.
- If more than one lease is dedicated to the well, outline each and identify the ownership thereof (both as to working interest and royalty)
- If more than one lease of different ownership is dedicated to the well, have the interests of all owners been consolidated by communitization, unitization, force-pooling, etc?

Yes No If answer is "yes," type of consolidation _____

If answer is "no," list the owners and tract descriptions which have actually been consolidated. (Use reverse side of this form if necessary.) _____

No allowable will be assigned to the well until all interests have been consolidated (by communitization, unitization, forced-pooling, or otherwise) or until a non-standard unit, eliminating such interests, has been approved by the Commission.

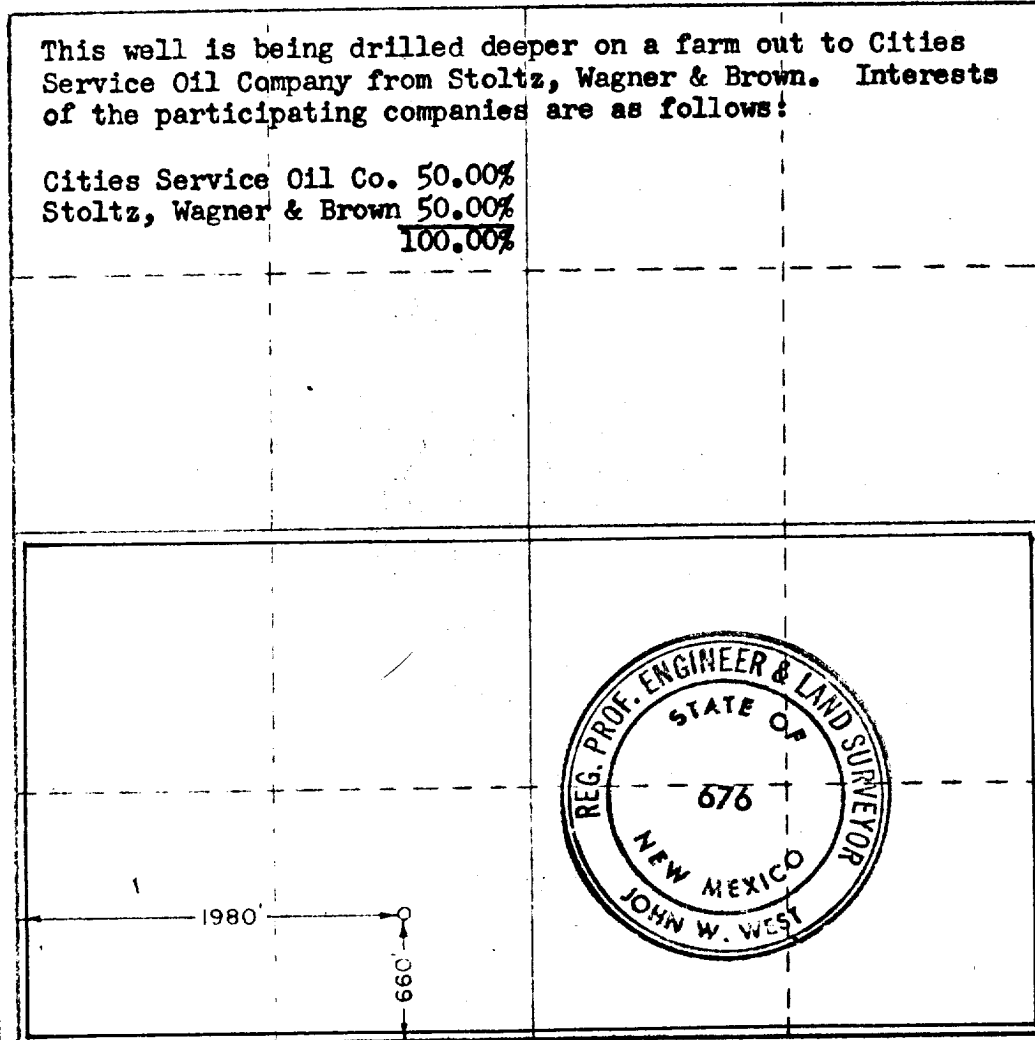

CERTIFICATION

I hereby certify that the information contained herein is true and complete to the best of my knowledge and belief.

Name: *E. Fielder*

Position: **Region Operation Manager**

Company: **Cities Service Oil Company**

Date: **August 16, 1974**

I hereby certify that the well location shown on this plat was plotted from field notes of actual surveys made by me or under my supervision, and that the same is true and correct to the best of my knowledge and belief.

Date Surveyed: **August 14, 1974**

Registered Professional Engineer and/or Land Surveyor

John W. West

Certificate No. **676**

