

NEW MEXICO OIL CONSERVATION COMMISSION

Santa Fe, New Mexico

HOBBBS DISTRICT O.C.C.

NOTICE OF INTENTION TO DRILL 56 PM '64

Notice must be given to the District Office of the Oil Conservation Commission and approval obtained before drilling or recompletion begins. If changes in the proposed plan are considered advisable, a copy of this notice showing such changes will be returned to the sender. Submit this notice in QUINTUPLICATE. One copy will be returned following approval. See additional instructions in Rules and Regulations of the Commission. If State Land submit 6 Copies. Attach Form C-128 in triplicate to first 3 copies of Form C-101.

Midland, Texas

August 19, 1964

(Place)

(Date)

OIL CONSERVATION COMMISSION
SANTA FE, NEW MEXICO

Gentlemen:

You are hereby notified that it is our intention to commence the Drilling of a well to be known as

TEXACO Inc.

(Company or Operator)

State of New Mexico "L"

(Lease)

, Well No. 9, in H The well is

(Unit)

located 1660 feet from the North line and 660 feet from the

East line of Section -1, T-18-S, R -34-E, NMPM.

(GIVE LOCATION FROM SECTION LINE) Glorieta Pool, Lea County

D	C	B	A
E	F	G	H
L	K	J	I
M	N	O	P

If State Land the Oil and Gas Lease is No. B-1733-1

If patented land the owner is

Address

We propose to drill well with drilling equipment as follows:

The status of plugging bond is \$10,000 blanket surety bond of Maryland Casualty Co. filed with State Geologist.

Drilling Contractor Unknown at present.

We intend to complete this well in the formation at an approximate depth of feet.

CASING PROGRAM

We propose to use the following strings of Casing and to cement them as indicated:

Size of Hole	Size of Casing	Weight per Foot	New or Second Hand	Depth	Sacks Cement

If changes in the above plans become advisable we will notify you immediately.

ADDITIONAL INFORMATION (If recompletion give full details of proposed plan of work.)

Approved AUG 21 1964, 19

Except as follows:

Sincerely yours,

TEXACO Inc.
(Company or Operator)

By J. J. Velten
Position Division Civil Engineer

Send Communications regarding well to

Name J. H. Markley

Address P. O. Box 3100 Midland Texas

OIL CONSERVATION COMMISSION

SUPERVISOR

CASING PROGRAM

HOBBS OFFICE O. C. C.

AUG 20 2 56 PM '64

We propose to use the following strings of Casing and to cement them as indicated:

Size of Hole	Size of Casing	Weight per foot	New or Second Hand	Depth	Sacks Cement
11"	8-5/8"	24	New	1450	700*
7-5/8"	2-7/8"	6.4	New	6850	800**

* 500 Sacks Class "C" 4% gel, followed by 200 sacks Class "C" Neat. Neat to contain accelerator.

** Externally clean casing & install centralizers over prospective zones. Cement with 500 sacks class "C" 8% gel, followed by 300 sacks Class "C" 4% gel. Displace plug with acetic acid.

FORMATION TOPS EXPECTED

Anhydrite	1435'
Top of salt	1545'
Base of salt	2560'
Yates	2820'
San Andres	4295'
Glorieta	5830'
Blinberry (Mkr)	6565'
Total Depth	6850'

NEW MEXICO OIL CONSERVATION COMMISSION
WELL LOCATION AND ACREAGE DEDICATION PLAT

FORM C-128
Revised 5/1/57

SEE INSTRUCTIONS FOR COMPLETING THIS FORM ON THE REVERSE SIDE

SECTION A

Operator TEXACO Inc.		Lease State of New Mexico "L"		Well No. 9
Unit Letter H	Section 1	Township 18 South	Range 34 East	County Lea
Actual Footage Location of Well: 1660 feet from the North line and 660 feet from the East line Sec. 1				
Ground Level Elev. 3983	Producing Formation Glorieta		Pool Vacuum Glorieta	Dedicated Acreage: 40 Acres

1. Is the Operator the only owner in the dedicated acreage outlined on the plat below? YES ☒ NO ____ . ("Owner" means the person who has the right to drill into and to produce from any pool and to appropriate the production either for himself or for himself and another. (65-3-29 (e) NMSA 1935 Comp.)
2. If the answer to question one is "no," have the interests of all the owners been consolidated by communitization agreement or otherwise? YES ____ NO ____ . If answer is "yes," Type of Consolidation _____
3. If the answer to question two is "no," list all the owners and their respective interests below:

Owner	Land Description

SECTION B

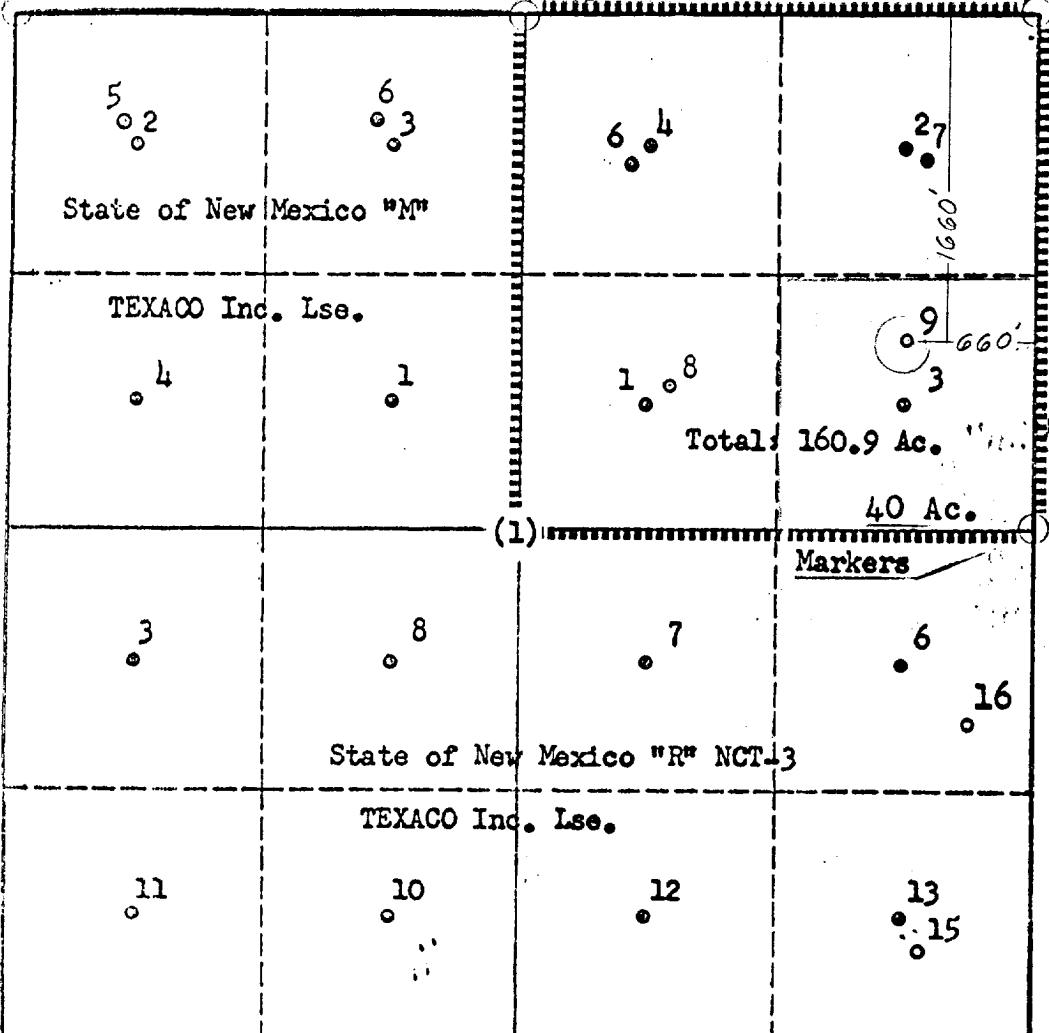

CERTIFICATION

I hereby certify that the information in SECTION A above is true and complete to the best of my knowledge and belief.

Name **J. J. Velten**
 Position **Division Civil Engineer**
 Company **TEXACO Inc.**
 Date **8/19/64**

I hereby certify that the well location shown on the plat in SECTION B was plotted from field notes of actual surveys made by me or under my supervision, and that the same is true and correct to the best of my knowledge and belief.

Date Surveyed **8/18/64**
 Registered Professional Engineer and/or Land Surveyor **J. J. Velten**
 Certificate No. **8174**

0 330 660 990 1320 1650 1980 2310 2640 2000 1500 1000 500 0