

RECEIVED	
DISTRIBUTION	
SANTA FE	
FILE	
U.I.G.S.	
LAND OFFICE	
TRANSPORTER	OIL GAS
PROMOTION OFFICE	
OPERATOR	

NEW MEXICO OIL CONSERVATION COMMISSION

Santa Fe, New Mexico

Form C-101
Revised 12/1/55

NOTICE OF INTENTION TO DRILL

Notice must be given to the District Office of the Oil Conservation Commission and approval obtained before drilling or recompletion begins. If changes in the proposed plan are considered advisable, a copy of this notice showing such changes will be returned to the sender. Submit this notice in QUINTUPLICATE. One copy will be returned following approval. See additional instructions in Rules and Regulations of the Commission. If State Land submit 6 Copies. Attach Form C-128 in triplicate to first 3 copies of Form C-101.

Midland, Texas

November 26, 1963

(Place)

(Date)

OIL CONSERVATION COMMISSION
SANTA FE, NEW MEXICO

Gentlemen:

You are hereby notified that it is our intention to commence the Drilling of a well to be known as
TEXACO Inc.

State of New Mexico "AC" NCT-1 (Company or Operator) 9, Well No. 9, in N The well is
(Lease) located 560 feet from the south line and 2100 feet from the
west line of Section 2, T 18-S, R 34-E, NMPM.

(GIVE LOCATION FROM SECTION LINE) Abo reef Pool, Lea County

D	C	B	A
E	F	G	H
L	K	J	I
M	N	O	P

If State Land the Oil and Gas Lease is No. B-1189-1

If patented land the owner is

Address

We propose to drill well with drilling equipment as follows: Rotary

The status of plugging bond is \$10,000 Surety Bond Maryland Casualty Company

Drilling Contractor

We intend to complete this well in the Vacuum Abo Reef formation at an approximate depth of 9050 feet.

CASING PROGRAM

We propose to use the following strings of Casing and to cement them as indicated:

Size of Hole	Size of Casing	Weight per Foot	New or Second Hand	Depth	Sacks Cement
SEE ATTACHED SHEET					

If changes in the above plans become advisable we will notify you immediately.

ADDITIONAL INFORMATION (If recompletion give full details of proposed plan of work.)

Approved _____, 19____
Except as follows:

Sincerely yours,

TEXACO Inc.

(Company or Operator)

By J. J. Velten

Position Division Civil Engineer

Send Communications regarding well to

Name J. J. Velten

Address P.O. Box 3109, Midland, Texas

OIL CONSERVATION COMMISSION

Rv

CASING PROGRAM

We propose to use the following strings of Casing and to cement them as indicated:

Size of Hole	Size of Casing	Weight per Foot	New or Second Hand	Depth	Sacks Cement
15"	11-3/4"	42# & 23.72#	New	350'	300 sax
10-5/8"	8-5/8"	24# & 32#	New	3220'	1650 sax **
7-5/8"	2-7/8"	6.5#	New	9050'	1300 sax
					Class "C" 8% gel followed
					by 250 sax
					Class "C" 4% gel.

** 1:1 Pozmix-Portland with 8% gel followed by 150 sax Portland neat.

FORMATION TOPS EXPECTED

Anhydrite	1680'
Top Salt	1770'
Seven Rivers	3200'
San Andres	4658'
Abo Reef	8660'
Total Depth	9050'

NEW MEXICO OIL CONSERVATION COMMISSION
WELL LOCATION AND ACREAGE DEDICATION PLAT

FORM C-128
Revised 5/1/57

SEE INSTRUCTIONS FOR COMPLETING THIS FORM ON THE REVERSE SIDE

SECTION A

Operator TEXACO Inc.		Lease State of New Mexico "AC" NCT-1		Well No. 9
Unit Letter N	Section 2	Township 18 South	Range 34 East	County Lea
Actual Footage Location of Well: 560 feet from the South line and 2100 feet from the West line Sec. 2				
Ground Level Elev. Later	Producing Formation Abo reef		Pool Vacuum Abo Reef	Dedicated Acreage: 40 Acres

- 4007-6-4
1. Is the Operator the only owner in the dedicated acreage outlined on the plat below? YES ☒ NO ☐ ("Owner" means the person who has the right to drill into and to produce from any pool and to appropriate the production either for himself or for himself and another. (65-3-29 (e) NMSA 1935 Comp.)
 2. If the answer to question one is "no," have the interests of all the owners been consolidated by communization agreement or otherwise? YES ☐ NO ☐ . If answer is "yes," Type of Consolidation _____
 3. If the answer to question two is "no," list all the owners and their respective interests below:

Owner	Land Description

SECTION B

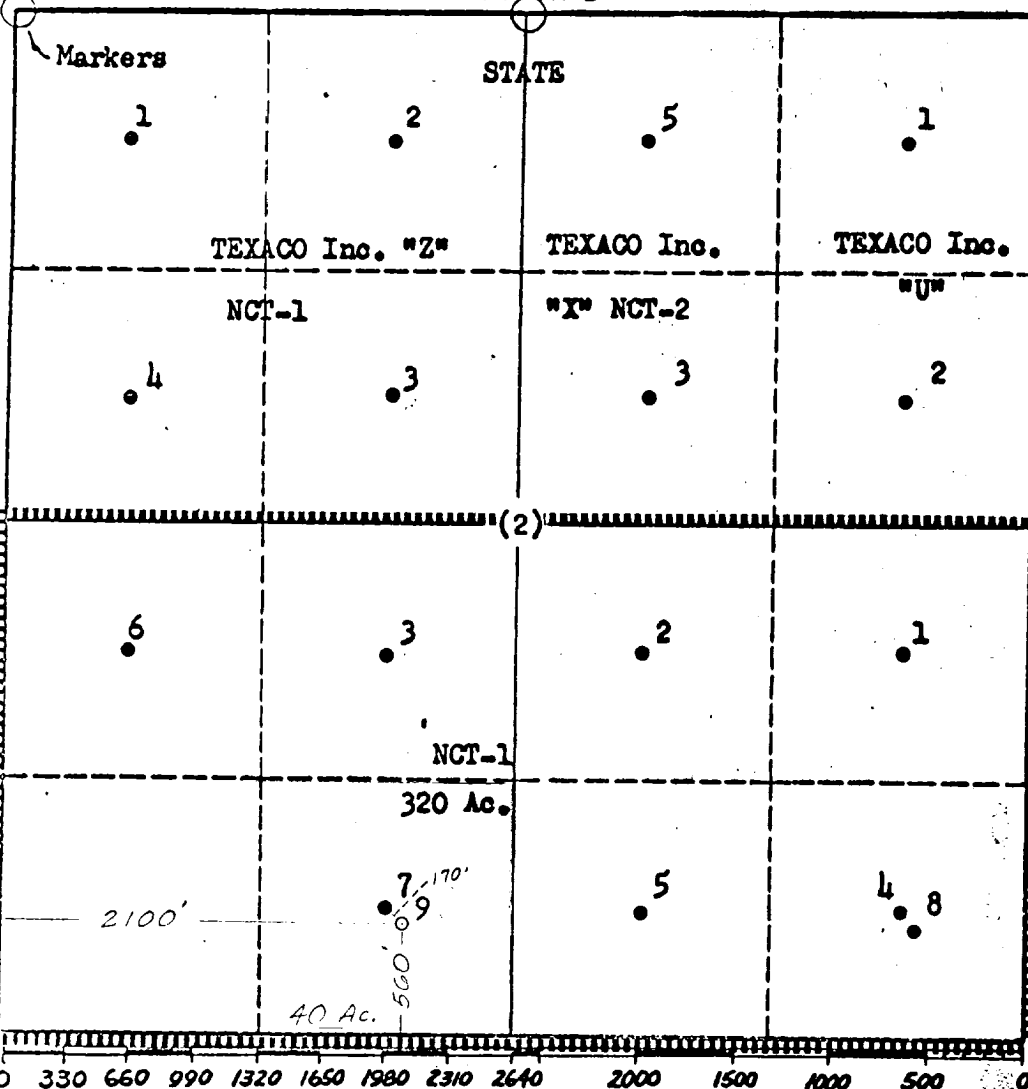

CERTIFICATION

I hereby certify that the information in SECTION A above is true and complete to the best of my knowledge and belief.

Name
J. J. Velten

Position
Division Civil Engineer

Company
TEXACO Inc.

Date
11/26/63

I hereby certify that the well location shown on the plat in SECTION B was plotted from field notes of actual surveys made by me or under my supervision, and that the same is true and correct to the best of my knowledge and belief.

Date Surveyed
11-27-63

Registered Professional Engineer and/or Land Surveyor
J. J. Velten

Certificate No.
8174