

NUMBER OF COPIES RECEIVED	
DISTRIBUTION	
SANTA FE	
FILE	
U.S.G.S.	
LAND OFFICE	
TRANSPORTER	OIL
	GAS
PRODUCTION OFFICE	
OPERATOR	

NEW MEXICO OIL CONSERVATION COMMISSION
WELL LOCATION AND ACREAGE DEDICATION PLAT
 SEE INSTRUCTIONS FOR COMPLETING THIS FORM ON THE REVERSE SIDE

FORM C-128
 Revised 5/1/57

AUG 17 11 25 AM '65

SECTION A

Operator L. R. FRENCH JR.		Lease Aztec Uncle		Well No. 1
Unit Letter C	Section 28	Township 18 South	Range 33 East	County Lea

Actual Footage Location of Well:
1650 feet from the **west** line and **660** feet from the **north** line

Ground Level Elev. 3820 EST.	Producing Formation Devonian	Pool Wildcat	Dedicated Acreage: E/2NW/4 80 Acres
--	--	------------------------	---

1. Is the Operator the only owner in the dedicated acreage outlined on the plat below? YES ☒ NO ____ . ("Owner" means the person who has the right to drill into and to produce from any pool and to appropriate the production either for himself or for himself and another. (65-3-29 (e) NMSA 1935 Comp.)
2. If the answer to question one is "no," have the interests of all the owners been consolidated by communization agreement or otherwise? YES ☒ NO ____ . If answer is "yes," Type of Consolidation **Limited Partnership**
3. If the answer to question two is "no," list all the owners and their respective interests below:

Owner L. R. French, Jr. & Jack N. Blair	Land Description E/2 of W/2 & E/2 Sec. 28, T-18-S, R-33-E
Lea County, New Mexico	

SECTION B

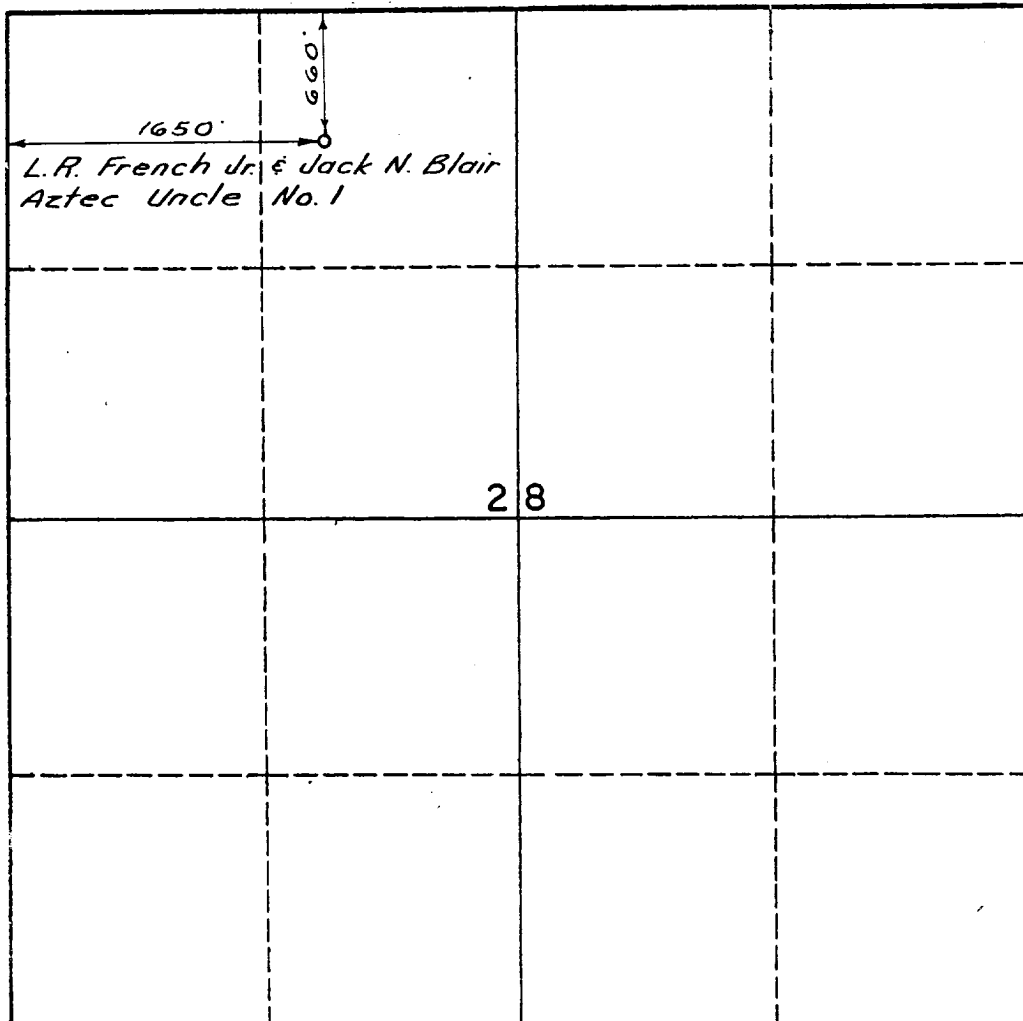

CERTIFICATION

I hereby certify that the information in SECTION A above is true and complete to the best of my knowledge and belief.

<i>David H. Donaldson</i> David H. Donaldson
Name
Production Superintendent
Position
L. R. French, Jr.
Company
8-12-65
Date

I hereby certify that the well location shown on the plat in SECTION B was plotted from field notes of actual surveys made by me or under my supervision, and that the same is true and correct to the best of my knowledge and belief.

Date Surveyed August 11, 1965
Registered Professional Engineer and/or Land Surveyor <i>S. W. Howell</i>
Certificate No. 1587

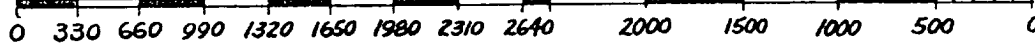

NUMBER OF COPIES SHEET	
SANTA FE	FILE #
U.S.G.S.	LAND OFFICE
TRANSPORTER	OIL
PRODUCTION OFFICE	OPERATOR

NEW MEXICO OIL CONSERVATION COMMISSION
WELL LOCATION AND ACRES DEDICATION PLAT
 SEE INSTRUCTIONS FOR COMPLETING THIS FORM ON THE REVERSE SIDE

FORM C-128
 Revised 5/1/57

APR 18 8 16 AM '66

SECTION A

Operator L. R. French, Jr.		Lease Aztec Uncle Com		Well No. 1
Unit Letter C	Section 28	Township 18 South	Range 33 East	County Lea
Actual Footage Location of Well: 1650 feet from the West line and 660 feet from the North line				
Ground Level Elev. 3813 D.F.	Producing Formation Morrow	Pool Wildcat	Dedicated Acreage: 320 Acres	

1. Is the Operator the only owner in the dedicated acreage outlined on the plat below? YES X NO ____ . ("Owner" means the person who has the right to drill into and to produce from any pool and to appropriate the production either for himself or for himself and another. (65-3-29 (e) NMSA 1935 Comp.)
2. If the answer to question one is "no," have the interests of all the owners been consolidated by communitization agreement or otherwise? YES X NO ____ . If answer is "yes," Type of Consolidation: Limited Partnership
3. If the answer to question two is "no," list all the owners and their respective interests below.

Owner L. R. French, Jr.	Land Description N/2 of Sec. 28, T-18-S, R-33-E
	Lea County, New Mexico

SECTION B

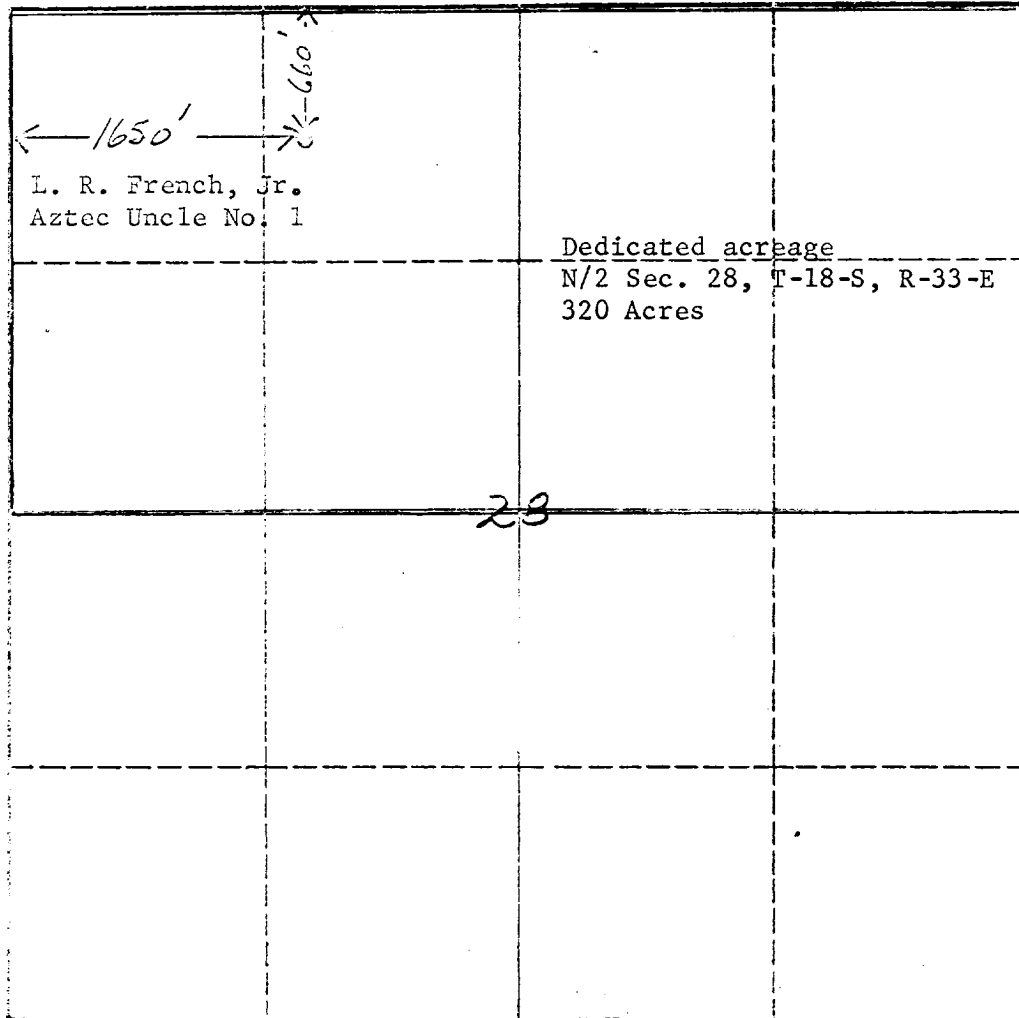

CERTIFICATION

I hereby certify that the information in SECTION A above is true and complete to the best of my knowledge and belief.
David H. Donaldson
 David H. Donaldson

Name
 Production Superintendent
 Position
L. R. French, Jr.
 Company
4-15-66
 Date

I hereby certify that the well location shown on the plat in SECTION B was plotted from field notes of actual surveys made by me or under my supervision, and that the same is true and correct to the best of my knowledge and belief.

Date Surveyed
 Registered Professional Engineer and/or Land Surveyor
 Certificate No.

0 350 650 950 1320 1650 1980 2310 2640 2000 1500 1000 500 0