

Submit to Appropriate District Office  
 State Lease - 6 copies  
 Fee Lease - 5 copies

State of New Mexico  
 Energy, Minerals and Natural Resources Department

Form C-101  
 Revised 1-1-89

**OIL CONSERVATION DIVISION**

P.O. Box 2088  
 Santa Fe, New Mexico 87504-2088

DISTRICT I  
 P.O. Box 1980, Hobbs, NM 88240

DISTRICT II  
 P.O. Drawer DD, Artesia, NM 88210

DISTRICT III  
 1000 Rio Brazos Rd., Aztec, NM 87410

API NO. ( assigned by OCD on New Wells)

30-025-21623

5. Indicate Type of Lease  
 STATE  FEE

6. State Oil & Gas Lease No.  
 K-3851

**APPLICATION FOR PERMIT TO DRILL, DEEPEN, OR PLUG BACK**

1a. Type of Work:  
 DRILL  RE-ENTER  DEEPEN  PLUG BACK   
 b. Type of Well:  
 OIL WELL  GAS WELL  OTHER   
 SINGLE ZONE  MULTIPLE ZONE

7. Lease Name or Unit Agreement Name  
 Lea 946 State

2. Name of Operator  
 Devon Energy Corporation (Nevada)

8. Well No.  
 1

3. Address of Operator  
 20 North Broadway Suite 1500 Oklahoma City, OK 73102

9. Pool name or Wildcat  
 Buckeye Abo

4. Well Location  
 Unit Letter E : 1980 Feet From The north Line and 660 Feet From The west Line  
 Section 2 Township 18S Range 35E NMPM Lea County

10. Proposed Depth  
 8960'

11. Formation  
 Abo

12. Rotary or C.T.  
 Service Rig

13. Elevations (Show whether DF, RT, GR, etc.)  
 3902' G.L.

14. Kind & Status Plug. Bond  
 Blanket

15. Drilling Contractor  
 unknown

16. Approx. Date Work will start  
 11-1-92

17. EXISTING <del>PROPOSED</del> CASING AND CEMENT PROGRAM					
SIZE OF HOLE	SIZE OF CASING	WEIGHT PER FOOT	SETTING DEPTH	SACKS OF CEMENT	EST. TOP
17 1/2"	13 3/8"	48	369'	380	surf.
11	8 5/8"	32	3592'	2450	surf
7 7/8"	4 1/2"	11.6	8995'	1180	surf.

Lease acquired by Devon Energy Corporation (Nevada) through Hondo Oil and Gas acquisition on January 1, 1992.

Propose to washdown wellbore to 8960', original PBTD with pulling unit. Resume Abo production. Cement plugs are located at:

- Surface - 30'
- 1482' - 1642'
- 2914' - 3074'
- 3974' - 4190' (retainer)
- 4990' - 5015' (CIBP)
- 8840' - 8928' (retainer)

IN ABOVE SPACE DESCRIBE PROPOSED PROGRAM: IF PROPOSAL IS TO DEEPEN OR PLUG BACK, GIVE DATA ON PRESENT PRODUCTIVE ZONE AND PROPOSED NEW PRODUCTIVE ZONE. GIVE BLOWOUT PREVENTER PROGRAM, IF ANY.

I hereby certify that the information above is true and complete to the best of my knowledge and belief.

SIGNATURE Charles W. Horsman TITLE District Engineer DATE 10/26/92

TYPE OR PRINT NAME Charles W. Horsman TELEPHONE NO. (405) 235-3611

(This space for State Use) ORIGINAL SIGNED BY **JERRY SEXTON**  
 DISTRICT I SUPERVISOR

APPROVED BY \_\_\_\_\_ TITLE \_\_\_\_\_ DATE **NOV 02 '92**

CONDITIONS OF APPROVAL, IF ANY:

Permit Expires 6 Months From Approval Date Unless Drilling Underway.  
*R. S. ...*

Submit to Appropriate District Office  
 State Lease - 4 copies  
 Fee Lease - 3 copies

State of New Mexico  
 Energy, Minerals and Natural Resources Department

Form C-102  
 Revised 1-1-89

**OIL CONSERVATION DIVISION**  
 P.O. Box 2088  
 Santa Fe, New Mexico 87504-2088

**DISTRICT I**  
 P.O. Box 1980, Hobbs, NM 88240

**DISTRICT II**  
 P.O. Drawer DD, Artesia, NM 88210

**DISTRICT III**  
 1000 Rio Brazos Rd., Aztec, NM 87410

**WELL LOCATION AND ACREAGE DEDICATION PLAT**  
 All Distances must be from the outer boundaries of the section

Operator Devon Energy Corporation (Nevada)			Lease Lea 946 State		Well No. 1
Unit Letter E	Section 2	Towship 18S	Range 35E	County Lea	

Actual Footage Location of Well:  
 1980 feet from the north line and 660 feet from the west line

Ground level Elev. 3902 G.L.	Producing Formation <del>Bone Springs</del> <i>ABO</i>	Pool Buckeye Abo	Dedicated Acreage: 40 Acres
---------------------------------	---	---------------------	--------------------------------

- Outline the acreage dedicated to the subject well by colored pencil or hatchure marks on the plat below.
- If more than one lease is dedicated to the well, outline each and identify the ownership thereof (both as to working interest and royalty).
- If more than one lease of different ownership is dedicated to the well, have the interest of all owners been consolidated by communitization, unitization, force-pooling, etc.?  
 Yes  No If answer is "yes" type of consolidation \_\_\_\_\_  
 If answer is "no" list the owners and tract descriptions which have actually been consolidated. (Use reverse side of this form if necessary.)  
 No allowable will be assigned to the well until all interests have been consolidated (by communitization, unitization, forced-pooling, or otherwise) or until a non-standard unit, eliminating such interest, has been approved by the Division.

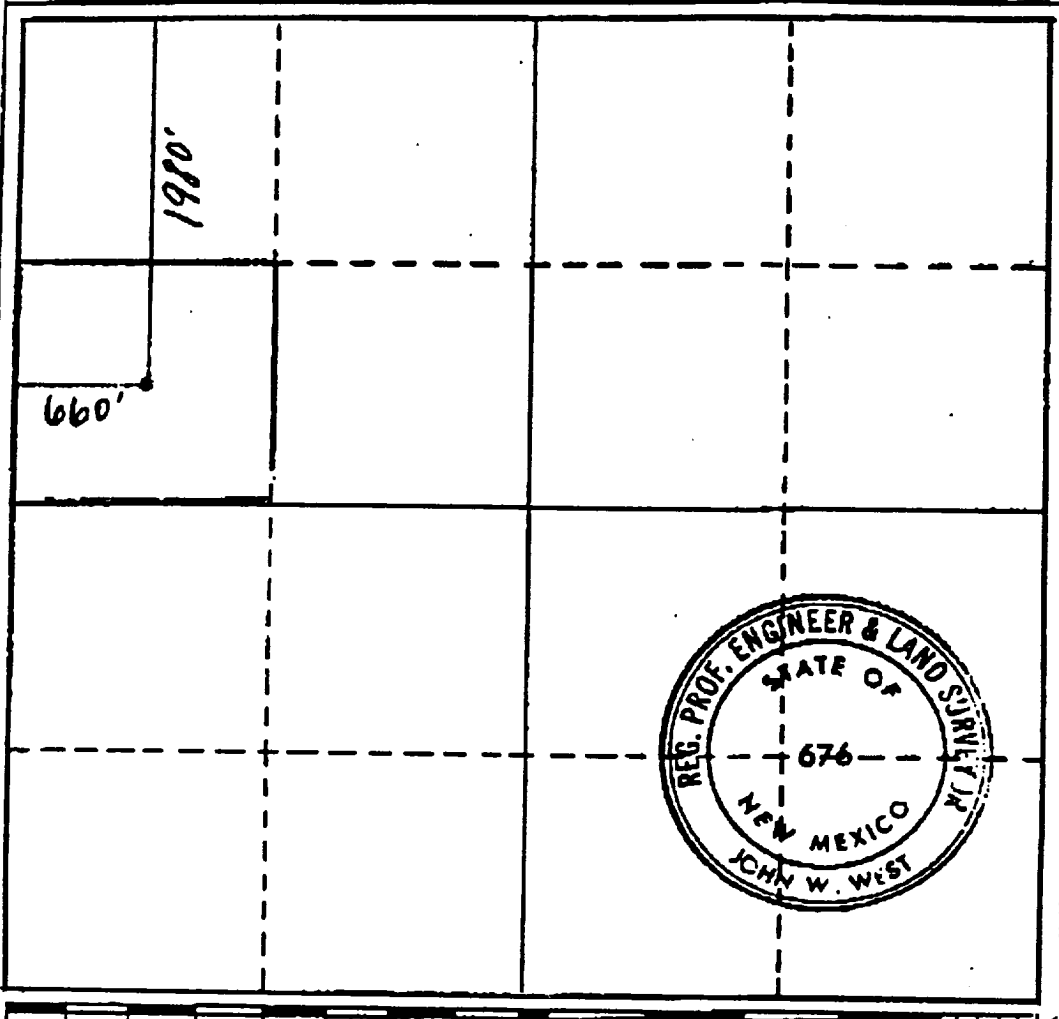

**OPERATOR CERTIFICATION**

I hereby certify that the information contained herein is true and complete to the best of my knowledge and belief.

Signature: *Charles W. Horsman*  
 Printed Name: Charles W. Horsman  
 Position: District Engineer  
 Company: Devon Energy Corporation  
 Date: (Nevada) October 27, 1992

**SURVEYOR CERTIFICATION**

I hereby certify that the well location shown on this plat was plotted from field notes of actual surveys made by me or under my supervision, and that the same is true and correct to the best of my knowledge and belief.

Date Surveyed: *11-4-1995*  
 Signature & Seal of Professional Surveyor: *John W. West*  
 Certificate No.: 676

