

UNITED STATES N. M. OIL CONS. COMMISSION  
DEPARTMENT OF THE INTERIOR  
GEOLOGICAL SURVEY HOBBS, NEW MEXICO 88240

APPLICATION FOR PERMIT TO DRILL, DEEPEN, OR PLUG BACK

1a. TYPE OF WORK  
 DRILL  DEEPEN  PLUG BACK   
 b. TYPE OF WELL  
 OIL WELL  GAS WELL  OTHER   
 SINGLE ZONE  MULTIPLE ZONE

2. NAME OF OPERATOR  
 Southland Royalty Company

3. ADDRESS OF OPERATOR  
 1100 Wall Towers West, Midland, TX 79701

4. LOCATION OF WELL (Report location clearly and in accordance with any State requirements.)\*  
 At surface  
 1980' FNL & 660' FEL  
 At proposed prod. zone

14. DISTANCE IN MILES AND DIRECTION FROM NEAREST TOWN OR POST OFFICE\*  
 8 miles Southeast of Maljamar, New Mexico

15. DISTANCE FROM PROPOSED\* LOCATION TO NEAREST PROPERTY OR LEASE LINE, FT. (Also to nearest drlg. unit line, if any) 660'  
 16. NO. OF ACRES IN LEASE 640

17. NO. OF ACRES ASSIGNED TO THIS WELL 40  
 18. DISTANCE FROM PROPOSED LOCATION\* TO NEAREST WELL, DRILLING, COMPLETED, OR APPLIED FOR, ON THIS LEASE, FT. NA  
 19. PROPOSED DEPTH NA

20. ROTARY OR CABLE TOOLS NA  
 21. ELEVATIONS (Show whether DF, RT, GR, etc.) 3860' GR  
 22. APPROX. DATE WORK WILL START\* 10-1-81

5. LEASE DESIGNATION AND SERIAL NO. NM 93  
 6. IF INDIAN, ALLOTTEE OR TRIBE NAME  
 7. UNIT AGREEMENT NAME  
 8. FARM OR LEASE NAME West Corbin  
 9. WELL NO. 1  
 10. FIELD AND POOL, OR WILDCAT Undes. South Corbin (Wolfcamp)  
 11. SEC., T., R., M., OR BLM AND SURVEY OR AREA Sec. 18, T-18-S, R-33-E  
 12. COUNTY OR PARISH Lea 13. STATE NM

23. PROPOSED CASING AND CEMENTING PROGRAM

SIZE OF HOLE	SIZE OF CASING	WEIGHT PER FOOT	SETTING DEPTH	QUANTITY OF CEMENT

Propose plug back to Wolfcamp. See attached 9-331.

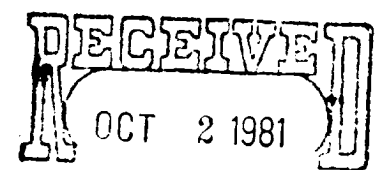

OIL & GAS  
U.S. GEOLOGICAL SURVEY  
ROSWell, NEW MEXICO

IN ABOVE SPACE DESCRIBE PROPOSED PROGRAM: If proposal is to deepen or plug back, give data on present productive zone and proposed new productive zone. If proposal is to drill or deepen directionally, give pertinent data on subsurface locations and measured and true vertical depths. Give blowout preventer program, if any.

24. SIGNED [Signature] TITLE Engineer Tech. DATE 9-30-81

(This space for Federal or State office use)

PERMIT NO. \_\_\_\_\_ APPROVAL DATE \_\_\_\_\_

APPROVED BY \_\_\_\_\_ TITLE \_\_\_\_\_

CONDITIONS OF APPROVAL, IF ANY:

\*See Instructions On Reverse Side

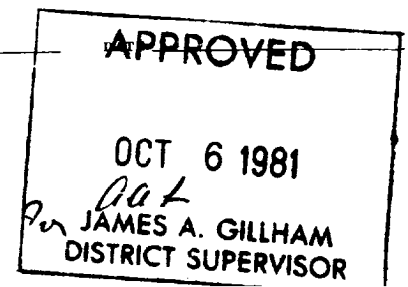

UNITED STATES  
DEPARTMENT OF THE INTERIOR  
GEOLOGICAL SURVEY

SUBMIT IN TRIPPLICATE  
(Other instructions on reverse side)

Form approved.  
Budget Bureau No. 42-R1424.

SUNDRY NOTICES AND REPORTS ON WELLS

(Do not use this form for proposals to drill or to deepen or plug back to a different reservoir. Use "APPLICATION FOR PERMIT—" for such proposals.)

<p>1. OIL WELL <input checked="" type="checkbox"/> GAS WELL <input type="checkbox"/> OTHER <input type="checkbox"/></p> <p>2. NAME OF OPERATOR Southland Royalty Company</p> <p>3. ADDRESS OF OPERATOR 1100 Wall Towers West, Midland, TX 79701</p> <p>4. LOCATION OF WELL (Report location clearly and in accordance with any State requirements.* See also space 17 below.) At surface 1980' FNL &amp; 660' FEL</p>	<p>5. LEASE DESIGNATION AND SERIAL NO. NM 93</p> <p>6. IF INDIAN, ALLOTTEE OR TRIBE NAME</p> <p>7. UNIT AGREEMENT NAME</p> <p>8. FARM OR LEASE NAME West Corbin</p> <p>9. WELL NO. 1</p> <p>10. FIELD AND POOL, OR WILDCAT Undes. South Corbin (Wolfcamp)</p> <p>11. SEC. T. R., M., OR BLK. AND SURVEY OR AREA Sec. 18, T-18-S, R-33-E</p>	
<p>14. PERMIT NO.</p>	<p>15. ELEVATIONS (Show whether DF, RT, GR, etc.) 3860' GR</p>	<p>12. COUNTY OR PARISH Lea</p> <p>13. STATE NM</p>

16. Check Appropriate Box To Indicate Nature of Notice, Report, or Other Data

NOTICE OF INTENTION TO:		SUBSEQUENT REPORT OF:	
TEST WATER SHUT-OFF <input type="checkbox"/>	PULL OR ALTER CASING <input type="checkbox"/>	WATER SHUT-OFF <input type="checkbox"/>	REPAIRING WELL <input type="checkbox"/>
FRACTURE TREAT <input type="checkbox"/>	MULTIPLE COMPLETE <input type="checkbox"/>	FRACTURE TREATMENT <input type="checkbox"/>	ALTERING CASING <input type="checkbox"/>
SHOOT OR ACIDIZE <input type="checkbox"/>	ABANDON* <input type="checkbox"/>	SHOOTING OR ACIDIZING <input type="checkbox"/>	ABANDONMENT* <input type="checkbox"/>
REPAIR WELL <input type="checkbox"/>	CHANGE PLANS <input type="checkbox"/>	(Other) <input type="checkbox"/>	
(Other) PB <input checked="" type="checkbox"/>			

(NOTE: Report results of multiple completion on Well Completion or Recompletion Report and Log form.)

17. DESCRIBE PROPOSED OR COMPLETED OPERATIONS (Clearly state all pertinent details, and give pertinent dates, including estimated date of starting any proposed work. If well is directionally drilled, give subsurface locations and measured and true vertical depths for all markers and zones pertinent to this work.)\*

RUPU. Set cmt. retainer @ 12,050' & sqz. perfs from 12,157-12,284' (Morrow) w/250 sxs Cl "H" cmt. Perf w/4 JSPF @ 11,350'. Set cmt retainer @ 11,300' & sqz w/150 sxs Cl "H" to cover proposed perforation interval. Sting out of retainer. Rev. excess cmt. off of retainer & SI for 24 hours. GIH w/bit & drl out retainer & cmt to 11,450'. Run CBL to insure good cement bond across proposed perforation interval from 11,178-11,285'. Perforate 1 JSPF, 27 holes (OA) from 11,178'-11,285'. Set pkr & tbg @ 11,000 & acdz w/5,400 gal acid. Swab to rec. load. Above procedure approved 9-30-81 per Armando Lopez (USGS in Roswell, NM). Note: USGS in Hobbs, New Mexico is to be notified 24 hours prior commencing plug back activity.

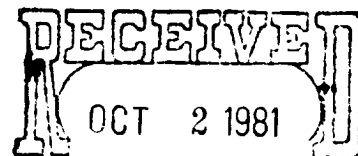

OIL & GAS  
U.S. GEOLOGICAL SURVEY  
ROSWELL, NEW MEXICO

18. I hereby certify that the foregoing is true and correct

SIGNED Ray [Signature] TITLE Engineer Tech. DATE 9-30-81

(This space for Federal or State office use)

APPROVED BY \_\_\_\_\_ TITLE \_\_\_\_\_ DATE \_\_\_\_\_  
CONDITIONS OF APPROVAL, IF ANY:

NEW MEXICO OIL CONSERVATION COMMISSION  
WELL LOCATION AND ACREAGE DEDICATION

Form O-112  
Supersedes O-128  
Effective 1-1-65

All distances must be from the outer boundaries of the Section

Southland Royalty Company			WEST CORBIN		Well No. 1	
H	18	18 SOUTH	33 EAST	LEA		
Actual Well Location of Well:						
1980	feet from the	NORTH	line and	660	feet from the	EAST
3860	Producing Formation	Und. South Corbin		Estimated Acreage:		40 Acres

- Outline the acreage dedicated to the subject well by colored pencil or hachure marks on the plat below.
- If more than one lease is dedicated to the well, outline each and identify the ownership thereof (both as to working interest and royalty).
- If more than one lease of different ownership is dedicated to the well, have the interests of all owners been consolidated by communitization, unitization, force-pooling, etc?

Yes  No If answer is "yes," type of consolidation \_\_\_\_\_

If answer is "no," list the owners and tract descriptions which have actually been consolidated. (Use reverse side of this form if necessary.) \_\_\_\_\_

No allowable will be assigned to the well until all interests have been consolidated (by communitization, unitization, forced-pooling, or otherwise) or until a non-standard unit, eliminating such interests, has been approved by the Commission.

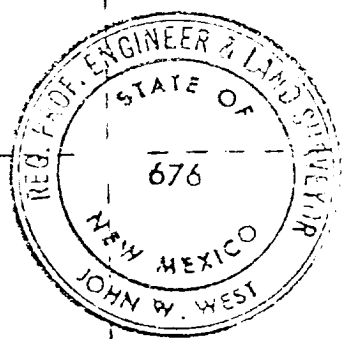
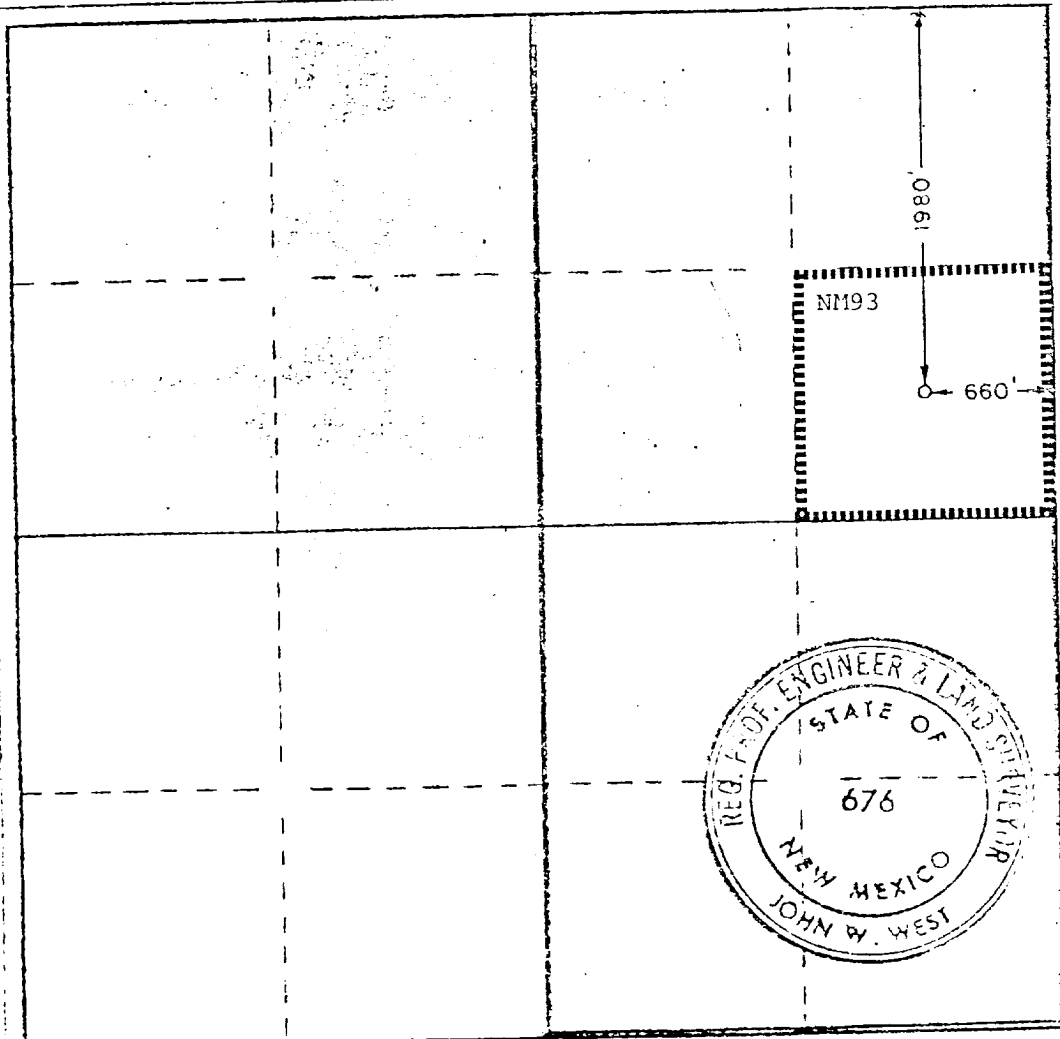

CERTIFICATION

I hereby certify that the information contained herein is true and complete to the best of my knowledge and belief.

Name \_\_\_\_\_  
 Position  
 Engineer Tech  
 Company  
 Southland Royalty Co.  
 Date  
 9-30-81

I hereby certify that the well location shown on this plat was plotted from field notes of actual surveys made by me or under my supervision, and that the same is true and correct to the best of my knowledge and belief.

Date Surveyed  
 APRIL 8, 1974  
 Registered Professional Engineer  
 and/or Land Surveyor

*John W. West*  
 Signature