

NE EXICO OIL CONSERVATION COMMISSION
WELL LOCATION AND ACREAGE DEDICATION PLAT

Form C-102
Supersedes C-128
Effective 1-1-65

All distances must be from the outer boundaries of the Section

Operator GETTY OIL COMPANY			Lease State AP		Well No. 1
Tract Letter 'L'	Section 9	Township 18 South	Range 35 East	County Lea	
Actual Footage Location of Well: 1980 feet from the South line and 660 feet from the West line					
Ground Level Elev. 3940.5	Producing Formation Vac Abo Reef		Pool Vac Abo Reef		Dedicated Acreage: 40 Acres

1. Outline the acreage dedicated to the subject well by colored pencil or hachure marks on the plat below.
2. If more than one lease is dedicated to the well, outline each and identify the ownership thereof (both as to working interest and royalty).
3. If more than one lease of different ownership is dedicated to the well, have the interests of all owners been consolidated by communitization, unitization, force-pooling, etc?

☐ Yes ☐ No If answer is "yes," type of consolidation _____

If answer is "no," list the owners and tract descriptions which have actually been consolidated. (Use reverse side of this form if necessary.) _____

No allowable will be assigned to the well until all interests have been consolidated (by communitization, unitization, forced-pooling, or otherwise) or until a non-standard unit, eliminating such interests, has been approved by the Commission.

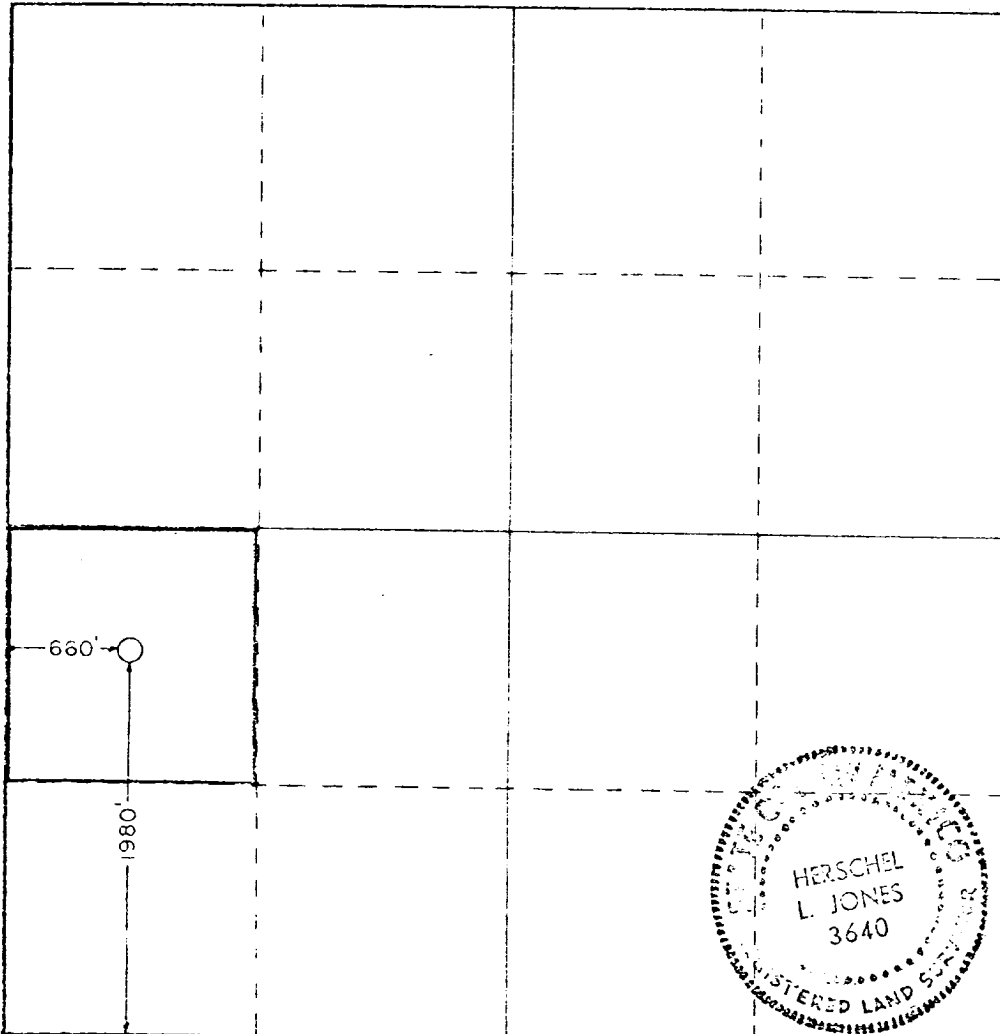

CERTIFICATION

I hereby certify that the information contained herein is true and complete to the best of my knowledge and belief.

Dale R. Crockett

Name
Dale R. Crockett

Position
Area Superintendent

Company
Getty Oil Company

Date
May 21, 1980

I hereby certify that the well location shown on this plat was plotted from field notes of actual surveys made by me or under my supervision, and that the same is true and correct to the best of my knowledge and belief.

Date Surveyed
December 12, 1980

Registered Professional Engineer and/or Land Surveyor

Herschel L. Jones
Certificate No. **3640**

330 650 970 1290 1610 1930 2250 2570 2890 3210 3530 3850 4170 4490 4810 5130 5450 5770 6090

RECEIVED

MAY 23 1980

OIL CONSERVATION DIV.

Cement Bond Log 9-22-80

7-11-80