

Amended

All distances must be from the outer boundaries of the Section.

Operator Amoco Production Company			Lease South Hobbs Unit			Well No. 225
Unit Letter M	Section 34	Township 18 South	Range 38 East	County Lea		
Actual Footage Location of Well: 5 feet from the West line and 683 feet from the South line						
Ground Level Elev. 3620.2	Producing Formation Grayburg-S		Pool Hobbs Field	Dedicated Acreage 40 Acres		

1. Outline the acreage dedicated to the subject well by colored pencil or hachure marks on the plat below.
2. If more than one lease is dedicated to the well, outline each and identify the ownership thereof (both as to working interest and royalty).
3. If more than one lease of different ownership is dedicated to the well, have the interests of all owners been consolidated by communitization, unitization, force-pooling, etc?

Yes No If answer is "yes," type of consolidation _____

If answer is "no," list the owners and tract descriptions which have actually been consolidated. (Use reverse side of this form if necessary.) _____

No allowable will be assigned to the well until all interests have been consolidated (by communitization, unitization, forced-pooling, or otherwise) or until a non-standard unit, eliminating such interests, has been approved by the Division.

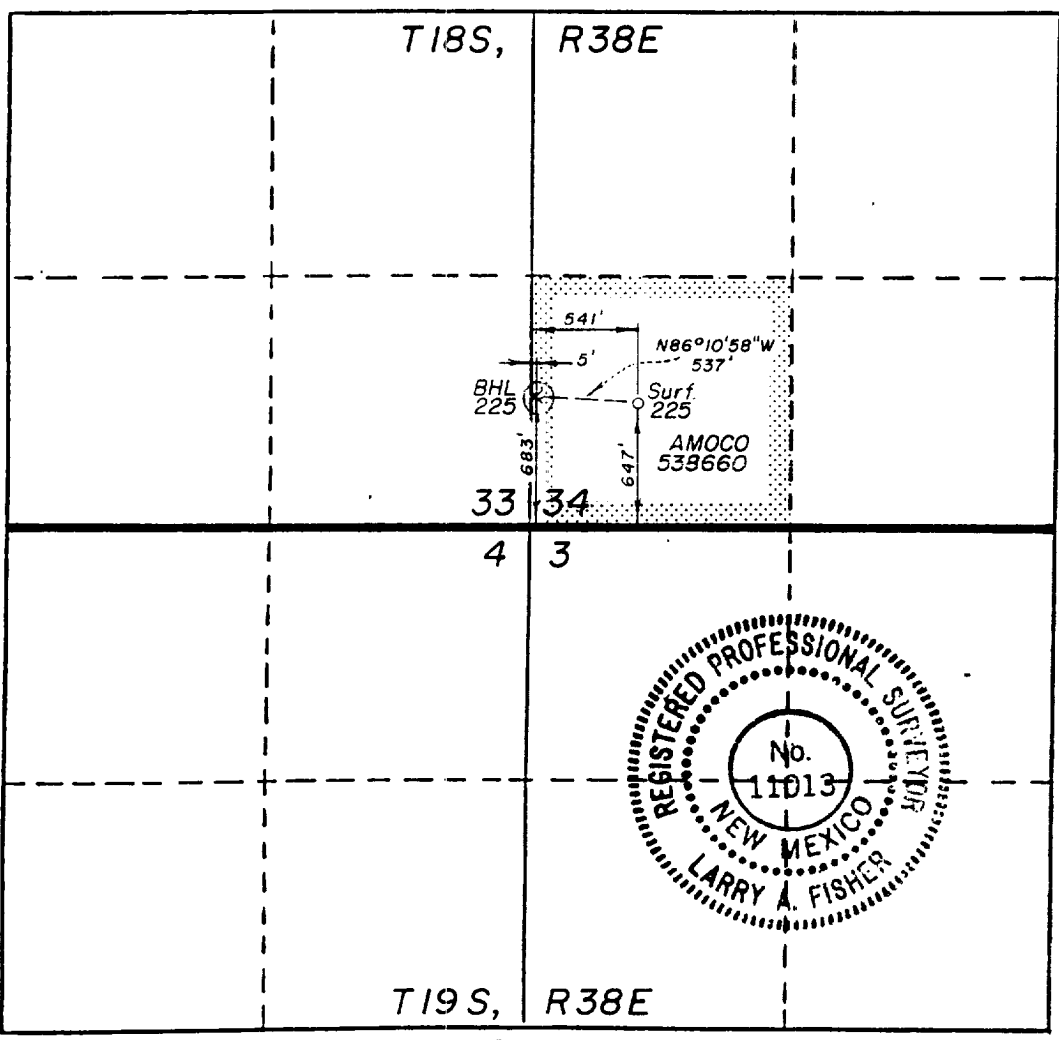

CERTIFICATION

I hereby certify that the information contained herein is true and complete to the best of my knowledge and belief.

Name
Kim A. Cahin

Position
Asst. Admin. Analyst

Company
Amoco Production Company

Date
8-7-91

I hereby certify that the well location shown on this plat was plotted from field notes of actual surveys made by me or under my supervision, and that the same is true and correct to the best of my knowledge and belief.

Date Surveyed
March 13, 1991

Registered Land Surveyor
Larry A. Fisher

Certificate No.
11013

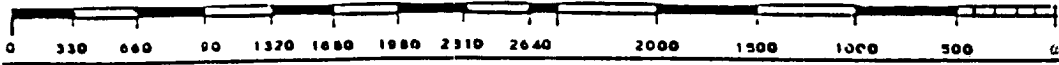

OFFICE

AUG 18 1981

HOBBS COUNTY