

NEW MEXICO OIL CONSERVATION COMMISSION
WELL LOCATION AND ACREAGE DEDICATION PLAT

FORM C-12B
 Revised 5/1/57

SEE INSTRUCTIONS FOR COMPLETING THIS FORM ON THE REVERSE SIDE

SECTION A

Operator MARATHON OIL COMPANY		Lease STATE WARN ACCOUNT 1		Well No. 3
Unit Letter F	Section 31	Township 17 SOUTH	Range 35 EAST	County LEA
Actual Footage Location of Well: 1908 feet from the WEST line and 2080 feet from the EAST line				
Ground Level Elev.	Producing Formation PENNSYLVANIAN	Pool VACUUM UPPER PENN	Dedicated Acreage: 80 Acres	

1. Is the Operator the only owner in the dedicated acreage outlined on the plat below? YES NO ("Owner" means the person who has the right to drill into and to produce from any pool and to appropriate the production either for himself or for himself and another. (65-3-29 (e) NMSA 1935 Comp.).
2. If the answer to question one is "no," have the interests of all the owners been consolidated by communitization agreement or otherwise? YES NO . If answer is "yes," Type of Consolidation _____
3. If the answer to question two is "no," list all the owners and their respective interests below:

Owner	Land Description

SECTION B

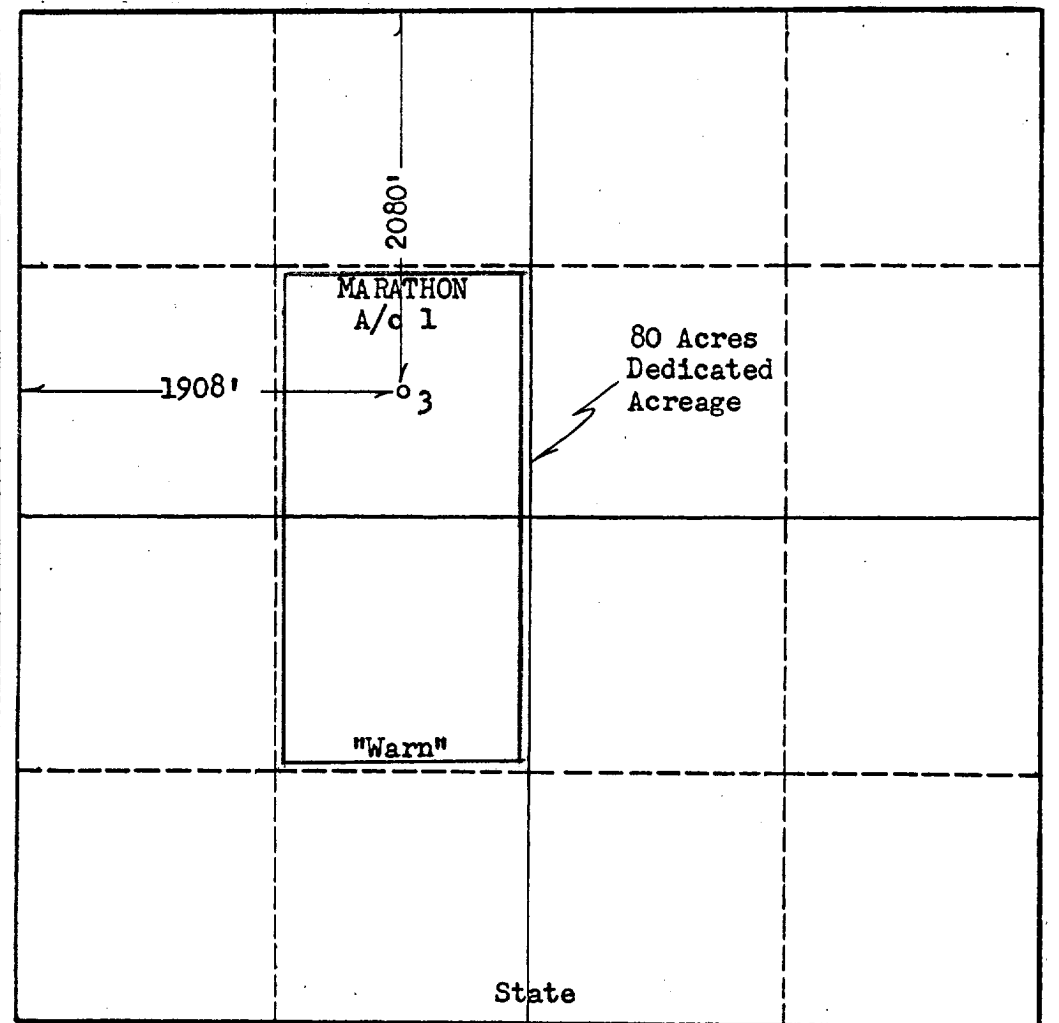

CERTIFICATION

I hereby certify that the information in SECTION A above is true and complete to the best of my knowledge and belief.

J. L. Frank
 Name
J. L. Frank
 Position
Petroleum Engineer
 Company
Marathon Oil Company
 Date
7-1-64

I hereby certify that the well location shown on the plat in SECTION B was plotted from field notes of actual surveys made by me or under my supervision, and that the same is true and correct to the best of my knowledge and belief.

Date Surveyed
April 13, 1964
 Registered Professional Engineer and/or Land Surveyor
/s/ John W. West
 Certificate No. **676**

