

DISTRICT I  
P.O. Box 1930, Hobbs, NM 88241-1980

DISTRICT II  
P.O. Box Drawer DD, Artesia, NM 88211-0719

DISTRICT III  
1000 Rio Brazos Rd., Aztec, NM 87410

DISTRICT IV  
P.O. Box 2088, Santa Fe, NM 87504-2088

State of New Mexico  
Energy, Minerals and Natural Resources Department

**OIL CONSERVATION DIVISION**

P.O. Box 2088  
Santa Fe, New Mexico 87504-2088

Form C-101  
Revised February 10, 1994

Instructions on back  
Submit to Appropriate District Office  
State Lease - 6 Copies  
Free Lease - 5 Copies

AMENDED REPORT

**APPLICATION FOR PERMIT TO DRILL, RE-ENTER, DEEPEN, PLUGBACK, OR ADD A ZONE**

<sup>1</sup> Operator Name and Address TEXACO EXPLORATION & PRODUCTION INC. 205 E. Bender, HOBBS, NM 88240		<sup>2</sup> OGRID Number 022351
<sup>4</sup> Property Code 011125	<sup>5</sup> Property Name <i>Formerly: NM O State #37</i> VACUUM GLORIETA WEST UNIT	<sup>3</sup> API Number 30-025-32450
		<sup>6</sup> Well No. 189

<sup>7</sup> Surface Location

Ul or lot no.	Section	Township	Range	Lot.Idn	Feet From The	North/South Line	Feet From The	East/West Line	County
1	36	17S	34E		1650	SOUTH	330	EAST	LEA

<sup>8</sup> Proposed Bottom Hole Location If Different From Surface

Ul or lot no.	Section	Township	Range	Lot.Idn	Feet From The	North/South Line	Feet From The	East/West Line	County
<sup>9</sup> Proposed Pool 1 Vacuum Glorieta					<sup>10</sup> Proposed Pool 2				

<sup>11</sup> Work Type Code P	<sup>12</sup> WellType Code O	<sup>13</sup> Rotary or C.T. ROTARY	<sup>14</sup> Lease Type Code S	<sup>15</sup> Ground Level Elevation
<sup>16</sup> Multiple No	<sup>17</sup> Proposed Depth	<sup>18</sup> Formation Glorieta	<sup>19</sup> Contractor	<sup>20</sup> Spud Date 10/11/1999

<sup>21</sup> Proposed Casing and Cement Program

SIZE OF HOLE	SIZE OF CASING	WEIGHT PER FOOT	SETTING DEPTH	SACKS OF CEMENT	EST. TOP
No change					

<sup>22</sup> Describe the proposed program. If this application is to DEEPEN or PLUG BACK give the data on the present productive zone and proposed new productive zone. Describe the blowout prevention program, if any. Use additional sheets if necessary.

This well was formerly the New Mexico O State #37.... Texaco intends to recomplete the subject well from the Drinkard and Blinbry to the Glorieta. The intended procedure is as follows:

- MIRU PU. NUBOP.
- TIH W/bit & csg scraper. C/O to PBTD @ 7997'.
- TIH W/CIBP & set above Drinkard perms @ 7450'. TIH W/dump bailer & place 35' cmt cap on CIBP. TIH W/2nd CIBP & set above Blinbry perms @ 6345'. TIH W/dump bailer & place 35' cmt cap on CIBP.
- TIH W/GR-CCL log & log 1000' from PBTD. TIH W/csg gun & perf Glorieta fr 5890-5925,5930-50,5955-80.
- TIH W/pkr & set @ 5840. Load backside & test to 500#.
- Acidize perms w/6000 gals 15% NEFE HCL.
- Swab back load. Run tbg, rds & pmp & place well on test.

*Plugback*

<sup>23</sup> I hereby certify that the rules and regulations of the Oil Conservation Division have been complied with and that the information given above is true and complete to the best of my knowledge and belief.		<b>OIL CONSERVATION DIVISION</b>	
Signature <i>J. Denise Leake</i>		Approved By: <i>[Signature]</i>	
Printed Name J. Denise Leake		Title: <i>[Signature]</i>	
Title Engineering Assistant		Approval Date: <b>OCT 09 1999</b>	Expiration Date
Date 09/28/1999	Telephone 397-0405	Conditions of Approval Attached <input type="checkbox"/>	

DISTRICT I  
P.O. Box 1980, Hobbs, NM 88241-1980

DISTRICT II  
P.O. Box Drawer DD, Artesia, NM 88211-0719

DISTRICT III  
1000 Rio Brazos Rd., Aztec, NM 87410

DISTRICT IV  
P.O. Box 2088, Santa Fe, NM 87504-2088

State of New Mexico  
Energy, Minerals and Natural Resources Department

# OIL CONSERVATION DIVISION

P.O. Box 2088  
Santa Fe, New Mexico 87504-2088

Form C-102  
Revised February 10, 1994  
Instructions on back  
Submit to Appropriate District Office  
State Lease - 4 Copies  
Fee Lease - 3 Copies  
 AMENDED REPORT

## WELL LOCATION AND ACREAGE DEDICATION PLAT

<sup>1</sup> API Number 30-025-32450	<sup>2</sup> Pool Code 62160	<sup>3</sup> Pool Name VACUUM GLORIETA
<sup>4</sup> Property Code 011125	<sup>5</sup> Property Name <i>formerly: NM's State #37</i> VACUUM GLORIETA WEST UNIT	<sup>6</sup> Well No. 189
<sup>7</sup> OGRID Number 022351	<sup>8</sup> Operator Name TEXACO EXPLORATION & PRODUCTION INC.	<sup>9</sup> Elevation

### <sup>10</sup> Surface Location

Ul or lot no.	Section	Township	Range	Lot.Idn	Feet From The	North/South Line	Feet From The	East/West Line	County
I	36	17S	34E		1650	SOUTH	330	EAST	LEA

### <sup>11</sup> Bottom Hole Location If Different From Surface

Ul or lot no.	Section	Township	Range	Lot.Idn	Feet From The	North/South Line	Feet From The	East/West Line	County

<sup>12</sup> Dedicated Acres 40	<sup>13</sup> Joint or Infill No	<sup>14</sup> Consolidation Code	<sup>15</sup> Order No.
-------------------------------------	-------------------------------------	----------------------------------	-------------------------

NO ALLOWABLE WILL BE ASSIGNED TO THIS COMPLETION UNTIL ALL INTERESTS HAVE BEEN CONSOLIDATED OR A NON-STANDARD UNIT HAS BEEN APPROVED BY THE DIVISION

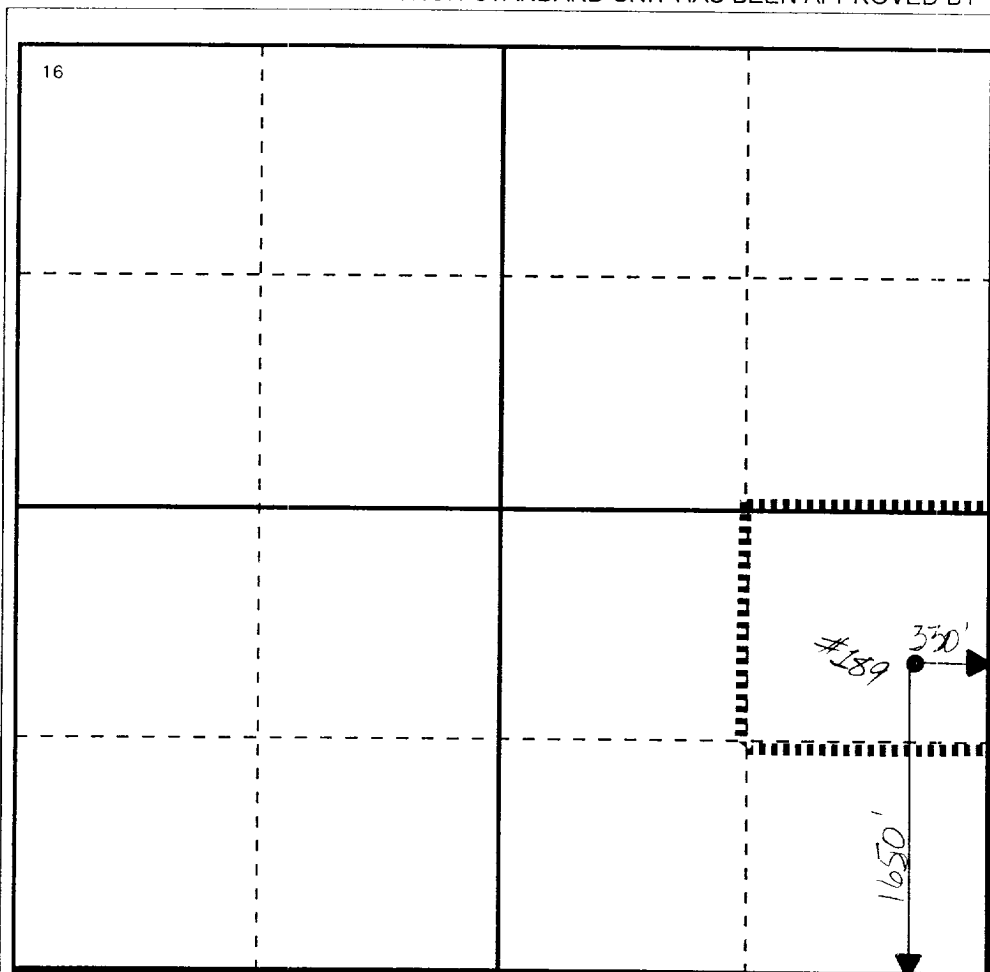

<b>17 OPERATOR CERTIFICATION</b> I hereby certify that the information contained herein is true and complete to the best of my knowledge and belief.
Signature <i>J. Denise Leake</i>
Printed Name J. Denise Leake
Position Engineering Assistant
Date 09/28/1999
<b>18 SURVEYOR CERTIFICATION</b> I hereby certify that the well location shown on this plat was plotted from field notes of actual surveys made by me or under my supervision, and that the same is true and correct to the best of my knowledge and belief.
Date Surveyed
Signature & Seal of Professional Surveyor
Certificate No.

NMO Scale #37

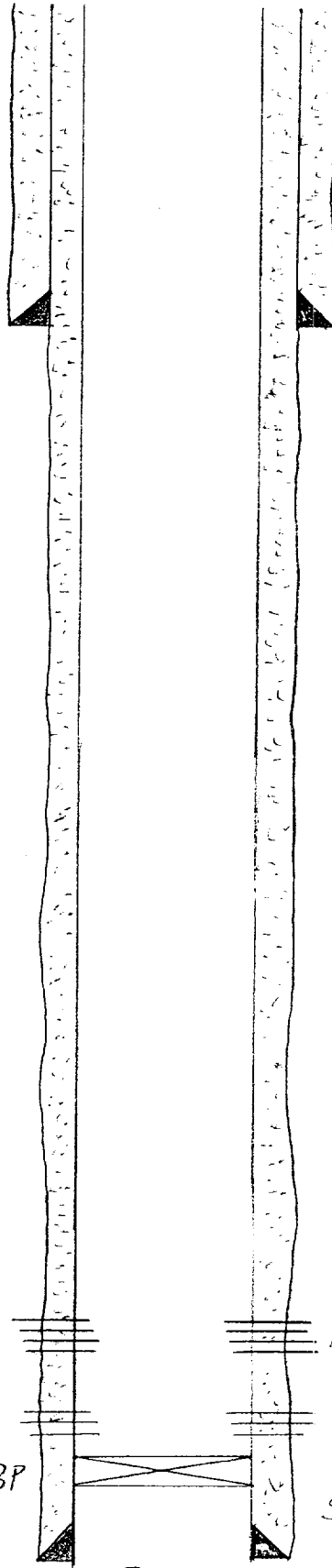

8-5/8" 24# NC-50 @ 1476'  
CMT w/ 575 SX circ

Junk LBP  
@ 7997'

TDC @ 8148'

Blinebry perfs 6396'-7162'

Drinkard perfs 7503'-7918'

5-1/2" 15.5# + 17# L-80 + WC-50  
45g @ 8148'  
CMT w/ 1700 SX circ