

WRS COMPLETION REPORT

COMPLETIONS SEC 24 TWP 19S RGE 36E
PI# 30-T-0024 01/10/92 30-025-04047-0001 PAGE 1

NMEX LEA * 1985FSL 661FWL SEC NW SW
STATE COUNTY FOOTAGE SPOT
ORYX ENERGY D X D
OPERATOR WELL CLASS INIT FIN
2 BARR J L
WELL NO. LEASE NAME
3681GR EUMONT
OPER ELEV FIELD POOL AREA
API 30-025-04047-0001
LEASE NO. PERMIT OR WELL I.D. NO.
11/14/1991 01/02/1992 WO-UNIT VERT D&AWG
SPUD DATE COMP. DATE TYPE TOOL HOLE TYPE STATUS

3800 NOT RPTD
PROJ. DEPTH PROJ. FORM CONTRACTOR
DTD 3800 OTD 3800 FM/TD QUE
DRILLERS T.D. LOG T.D. PLUG BACK TO OLD T.D. FOR

LOCATION DESCRIPTION

2 MI NW MONUMENT, NM

PRODUCTION TEST DATA

PTS 1 UG 4HRS
QUEEN PERF 3594- 3757
ACID 3594- 3757 2000GALS
15% NEFE HCL
RBP @ 3350 3594- 3757
SWBD 10 BLW W/SSG IN 4 HRS

PTF 0
SVN RVRS PERF W/ 408/IT 2933- 3293 GROSS
PERF 2933- 2942 2958- 2967 3005- 3018 3043- 3048
PERF 3073- 3078 3160- 3171 3217- 3233 3252- 3261
PERF 3278- 3293
ACID 2933- 3293 4000GALS
15% NEFE HCL
FLWD 11 BLW IN 4 HRS THRU 48/64 CK
PLD RBP @ 3350
WELL PROD NO FLUID, OIL OR GAS ON 24 HR FLOW TEST.
WELL NOT PLUGGED TO SURF.

DRILLING PROGRESS DETAILS

ORYX ENERGY

CONTINUED IC# 300257000292

COMPLETIONS
PI# 30-T-0024 01/10/92 SEC 24 TWP 19S RGE 36E
30-025-04047-0001 PAGE 2

ORYX ENERGY
2

BARR J L

D X D

DRILLING PROGRESS DETAILS

BOX 26300
OKLAHOMA CITY, OK 73126
405-752-7100

OWWO: OLD INFO: FORMERLY SUN OIL #2 BARR J L.
ELEV 3691 DF. SPUD 3/9/54. 9 5/8 @ 1238
W/330 SX, 5 1/2 @ 3800 W/560 SX. DRLR TOP:
QUEEN 3594. OTD 3800. COMP 11/22/54.
IPF 7600 MCFGPD. PROD ZONE: QUEEN 3594-3784.
01/09 LOC/1992/
01/09 CO TO 3757
01/09 3800 TD
COMP 1/2/92, D&A

Submit to Appropriate District Office
 State Lease - 4 copies
 Fee Lease - 3 copies

State of New Mexico
 Energy, Minerals and Natural Resources Department

Form C-102
 Revised 1-1-89

OIL CONSERVATION DIVISION
 P.O. Box 2088
 Santa Fe, New Mexico 87504-2088

DISTRICT I
 P.O. Box 1980, Hobbs, NM 88240

DISTRICT II
 P.O. Drawer DD, Artesia, NM 88210

DISTRICT III
 1000 Rio Brazos Rd., Aztec, NM 87410

WELL LOCATION AND ACREAGE DEDICATION PLAT
 All Distances must be from the outer boundaries of the section

| | | | | | | | | |
|---|---------------|------------------------------------|---------------------------------|-------------------------------------|--|---------------------------------|--|--|
| Operator Me-Tex Oil & Gas, Inc. | | | Lease J.L. Barr | | | Well No. 2 | | |
| Unit Letter L | Section 24 | Township 19 South | Range 36 East | County NMPM | | Lea | | |
| Actual Footage Location of Well: | | | | | | | | |
| 661.1 feet from the West line and | | | 1225.3 feet from the South line | | | | | |
| Ground level Elev. 3684' | | Producing Formation Yates SR-OU | | Pool Eumont Yates 7 Rivers Queen | | Dedicated Acreage: 120 Acres | | |
| <p>1. Outline the acreage dedicated to the subject well by colored pencil or hachure marks on the plat below.</p> <p>2. If more than one lease is dedicated to the well, outline each and identify the ownership thereof (both as to working interest and royalty).</p> <p>3. If more than one lease of different ownership is dedicated to the well, have the interest of all owners been consolidated by communitization, unitization, force-pooling, etc.? <input type="checkbox"/> Yes <input type="checkbox"/> No If answer is "yes" type of consolidation _____</p> <p>If answer is "no" list the owners and tract descriptions which have actually been consolidated. (Use reverse side of this form if necessary.) _____</p> <p>No allowable will be assigned to the well until all interests have been consolidated (by communitization, unitization, forced-pooling, or otherwise) or until a non-standard unit, eliminating such interest, has been approved by the Division.</p> | | | | | | | | |

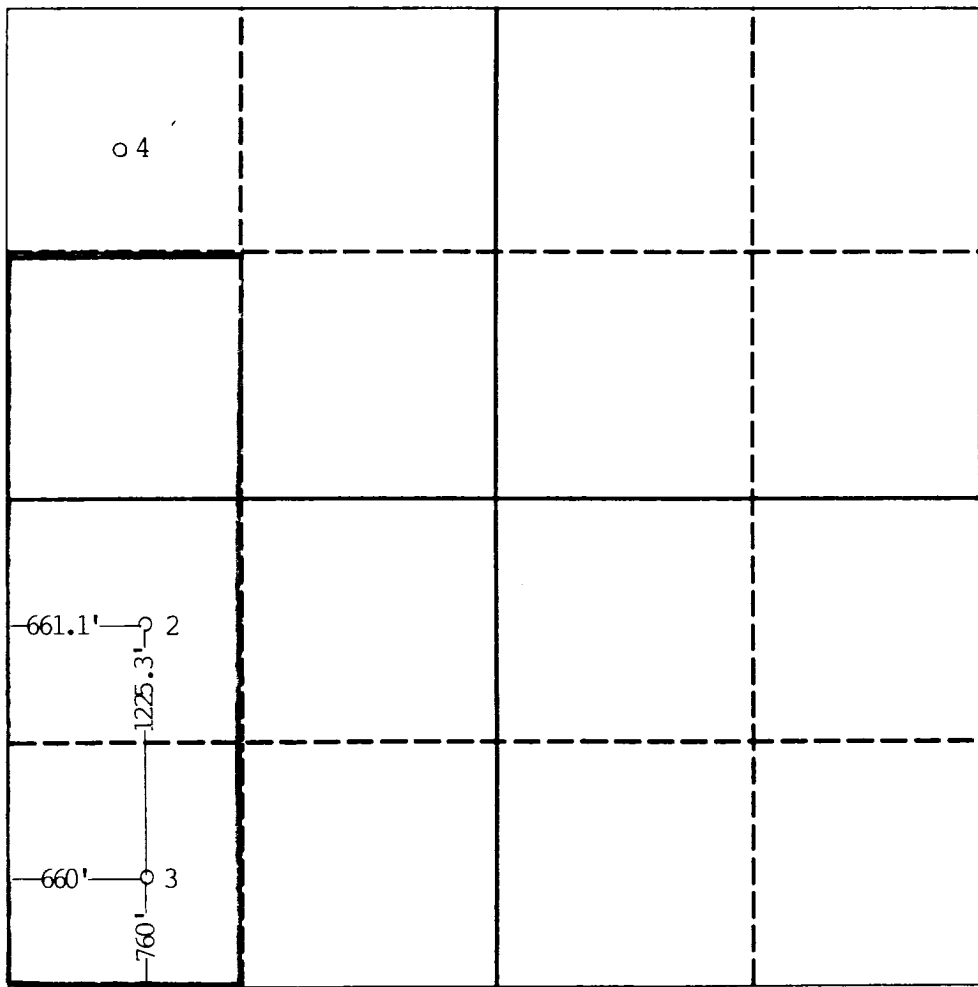

OPERATOR CERTIFICATION
 I hereby certify that the information contained herein in true and complete to the best of my knowledge and belief.

Signature: *Rodena Hiser*

Printed Name: Rodena Hiser

Position: Production Clerk

Company: Me-Tex Oil & Gas, Inc.

Date: October 29, 1993

SURVEYOR CERTIFICATION
 I hereby certify that the well location shown on this plat was plotted from field notes of actual surveys made by me or under my supervision, and that the same is true and correct to the best of my knowledge and belief.

Date Surveyed: _____

Signature & Seal of Professional Surveyor: _____

Certificate No.: _____

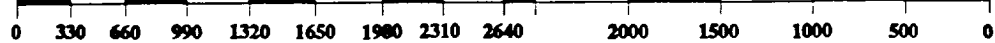

NMP-1288 (SD)

Submit to Appropriate
District Office
State Lease - 4 copies
Fee Lease - 3 copies

State of New Mexico
Energy, Minerals and Natural Resources Department

Form C-102
Revised 1-1-89

OIL CONSERVATION DIVISION
P.O. Box 2088
Santa Fe, New Mexico 87504-2088

DISTRICT I
P.O. Box 1980, Hobbs, NM 88240

DISTRICT II
P.O. Drawer DD, Artesia, NM 88210

DISTRICT III
1000 Rio Brazos Rd., Aztec, NM 87410

WELL LOCATION AND ACREAGE DEDICATION PLAT
All Distances must be from the outer boundaries of the section

| | | | | |
|---|------------------------------------|-------------------------------------|---------------------------------|---------------|
| Operator Me-Tex Oil & Gas, Inc. | | Lease J.L. Barr | | Well No. 2 |
| Unit Letter L | Section 24 | Township 19South | Range 36 East | County Lea |
| Actual Footage Location of Well: 661.1 feet from the West line and 1985.3 feet from the South line | | | | |
| Ground level Elev. 3684' | Producing Formation Yates SR-QU | Pool Eumont Yates 7 Rivers Queen | Dedicated Acreage: 160 Acres | |

- Outline the acreage dedicated to the subject well by colored pencil or hatchure marks on the plat below.
- If more than one lease is dedicated to the well, outline each and identify the ownership thereof (both as to working interest and royalty).
- If more than one lease of different ownership is dedicated to the well, have the interest of all owners been consolidated by communitization, unitization, force-pooling, etc.?
 - Yes No If answer is "yes" type of consolidation _____

If answer is "no" list the owners and tract descriptions which have actually been consolidated. (Use reverse side of this form if necessary.)
No allowable will be assigned to the well until all interests have been consolidated (by communitization, unitization, forced-pooling, or otherwise) or until a non-standard unit, eliminating such interest, has been approved by the Division.

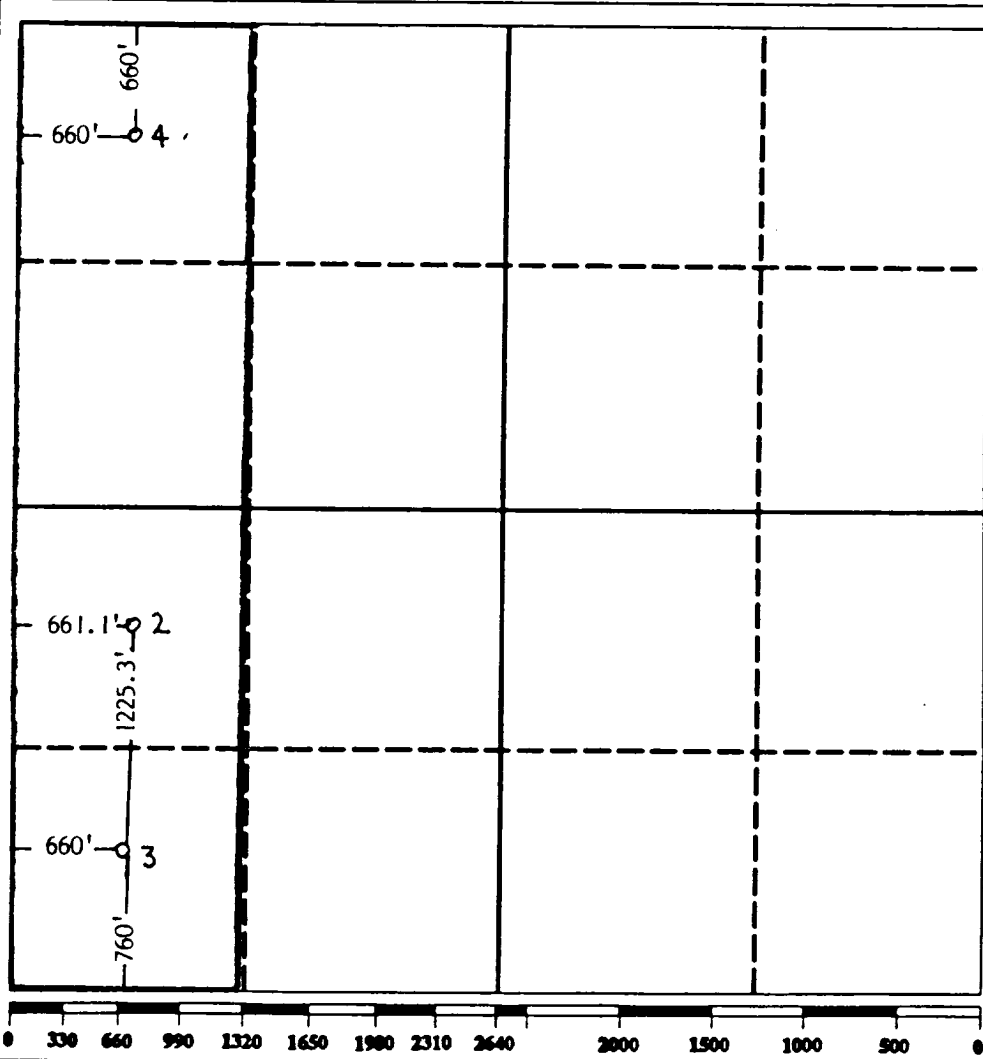

OPERATOR CERTIFICATION
I hereby certify that the information contained herein is true and complete to the best of my knowledge and belief.

Signature
Rodena Hiser

Printed Name
Rodena Hiser

Position
Production Clerk

Company
Me-Tex Oil & Gas, Inc.

Date
10-22-93

SURVEYOR CERTIFICATION
I hereby certify that the well location shown on this plat was plotted from field notes of actual surveys made by me or under my supervision, and that the same is true and correct to the best of my knowledge and belief.

Date Surveyed

Signature & Seal of Professional Surveyor

Certificate No.

SD-932

NEW MEXICO
OIL CONSERVATION COMMISSION

Gas Well Plat

Date June 29, 1950

Sun Oil Company
Operator

J. L. Barr
Lease

2
Well No. 7:41

Name of Producing Formation Queen Sand

Pool Mount Gas

No. Acres Dedicated to the Well 160.44

(Approved by Order No. R-453
Case 663, 5/27/50)

SECTION 24 TOWNSHIP 19-S RANGE 36-E

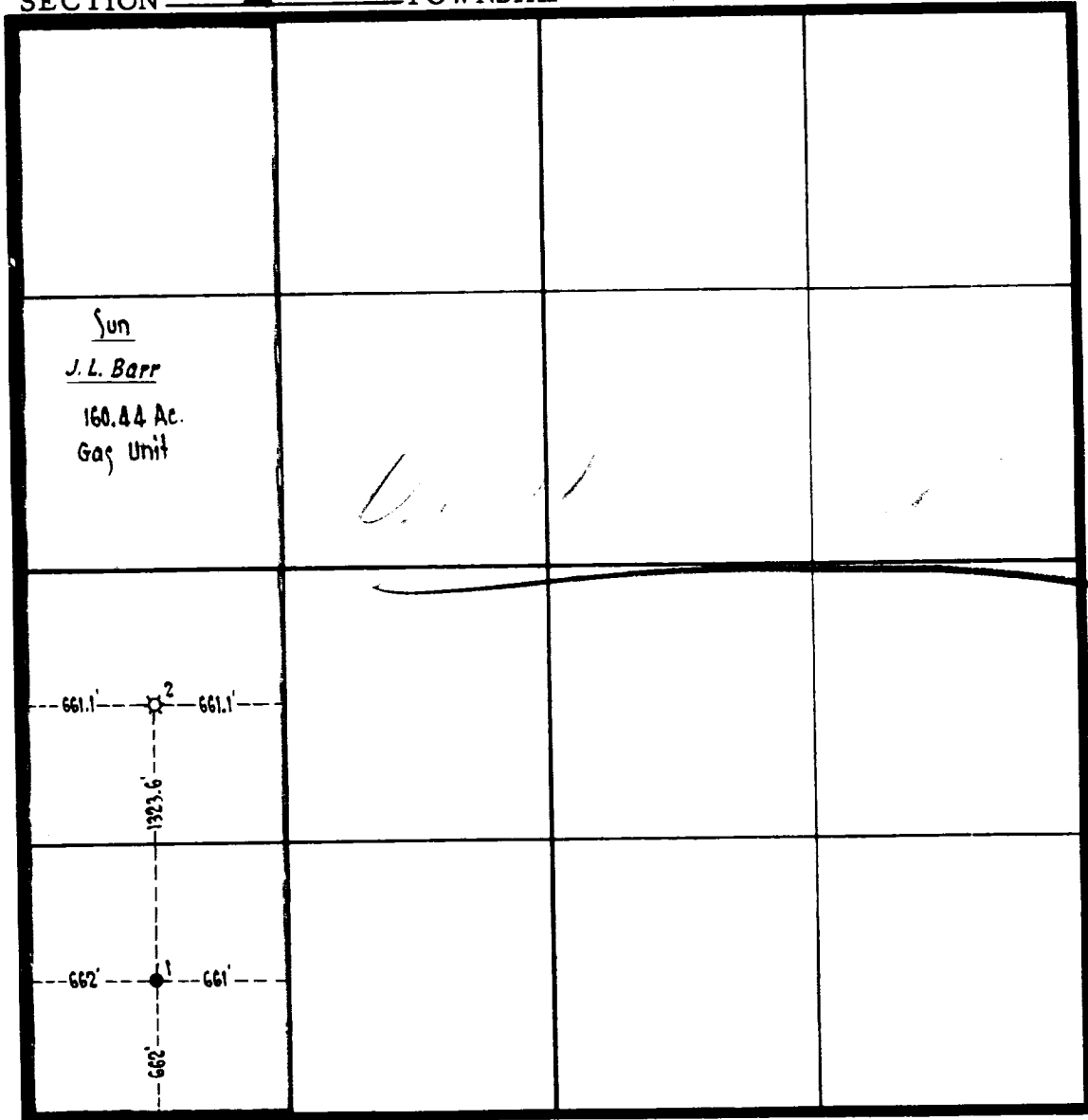

I hereby certify that the information given above is true and complete to the best of my knowledge.

Name R. English
Position Superintendent
Representing Sun Oil Company
Address Box 2880, Dallas, Texas

(over)

INSTRUCTIONS

1. Is this gas well a dual completion? Yes No

2. If the answer to Question 1 is Yes, are there any other dually completed wells within the dedicated acreage? Yes No

A separate plat must be filed for each gas well, outlining the area dedicated to such well and showing the location of all other wells (oil and gas) within the outlined area.

Mail in duplicate to the district office for the district in which the well is located.