

NEW MEXICO
OIL CONSERVATION COMMISSION

Form C-128

Well Location and/or Gas Proration Plat

OFFICE CCC

Date February 20, 1957

Operator Tidewater Oil Company Lease State "AT"

Well No. 3 Section 15 Township 19-S Range 37-E NMPM

Located 1980 Feet From North Line, 1980 Feet From West Line,

Lea County, New Mexico. G. L. Elevation _____

Name of Producing Formation Queens Pool Eumont Dedicated Acreage 40

(Note: All distances must be from outer boundaries of Section)

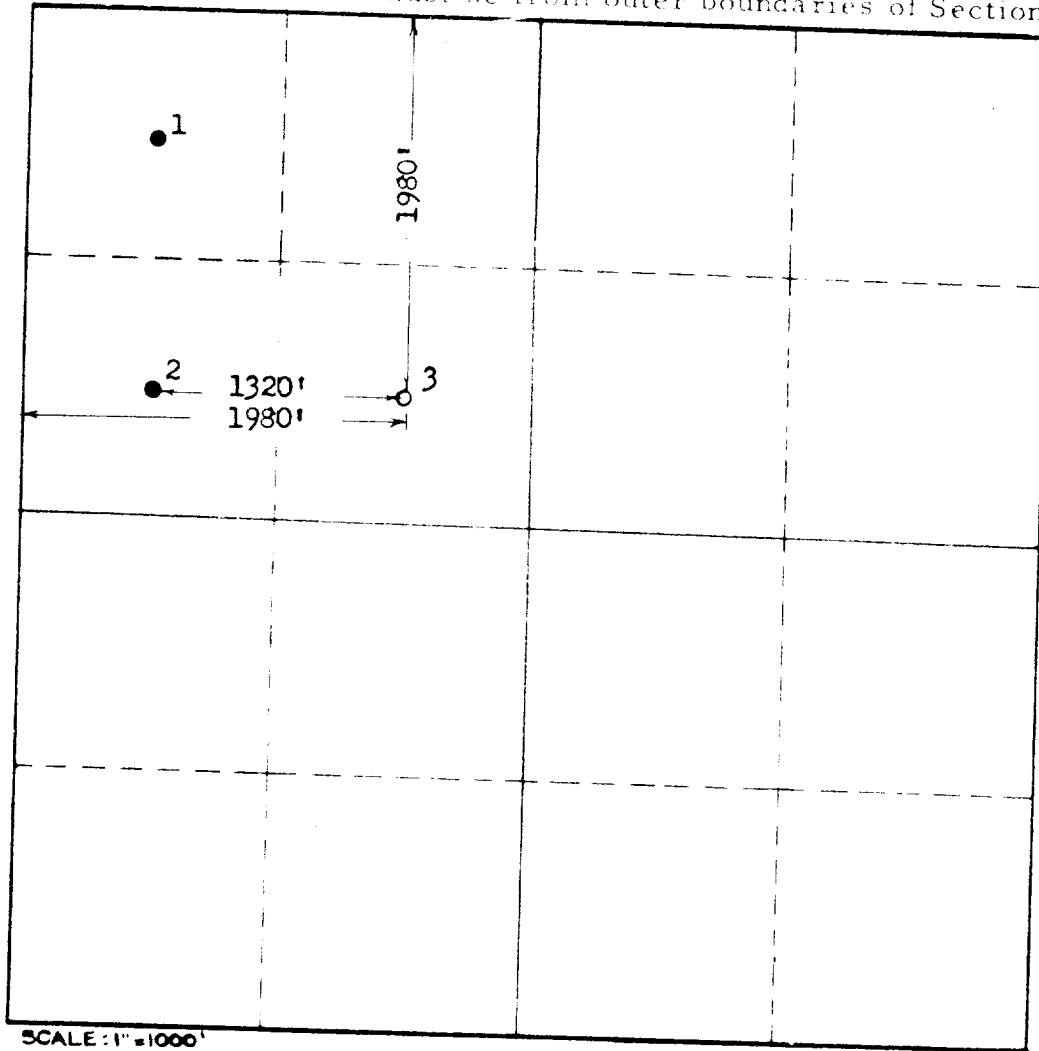

SCALE: 1"=1000'

1. Is this Well a Dual Comp. ? Yes ___ No X.
2. If the answer to Question 1 is yes, are there any other dually completed wells within the dedicated acreage? Yes ___ No ___.

This is to certify that the above plat was prepared from field notes of actual surveys made by me or under my supervision and that the same are true and correct to the best of my knowledge and belief.

Name _____
Position _____
Representing _____
Address _____

Date Surveyed February 19, 1957
[Signature]
Registered Professional Engineer and/or
Land Surveyor