

NEW MEXICO
OIL CONSERVATION COMMISSION

Form C-128

Well Location and/or Gas Proration Plat

Date 4/18/57

Operator JOHN M. KELLY Lease Gulf State "B"

Well No. 3 Section 16 Township 19 S. Range 37 E. NMPM

Located 660 Feet From North Line, 990 Feet From East Line,

Lea County, New Mexico. G. L. Elevation _____

Name of Producing Formation Queen Pool Eumont Dedicated Acreage 40

(Note: All distances must be from outer boundaries of Section)

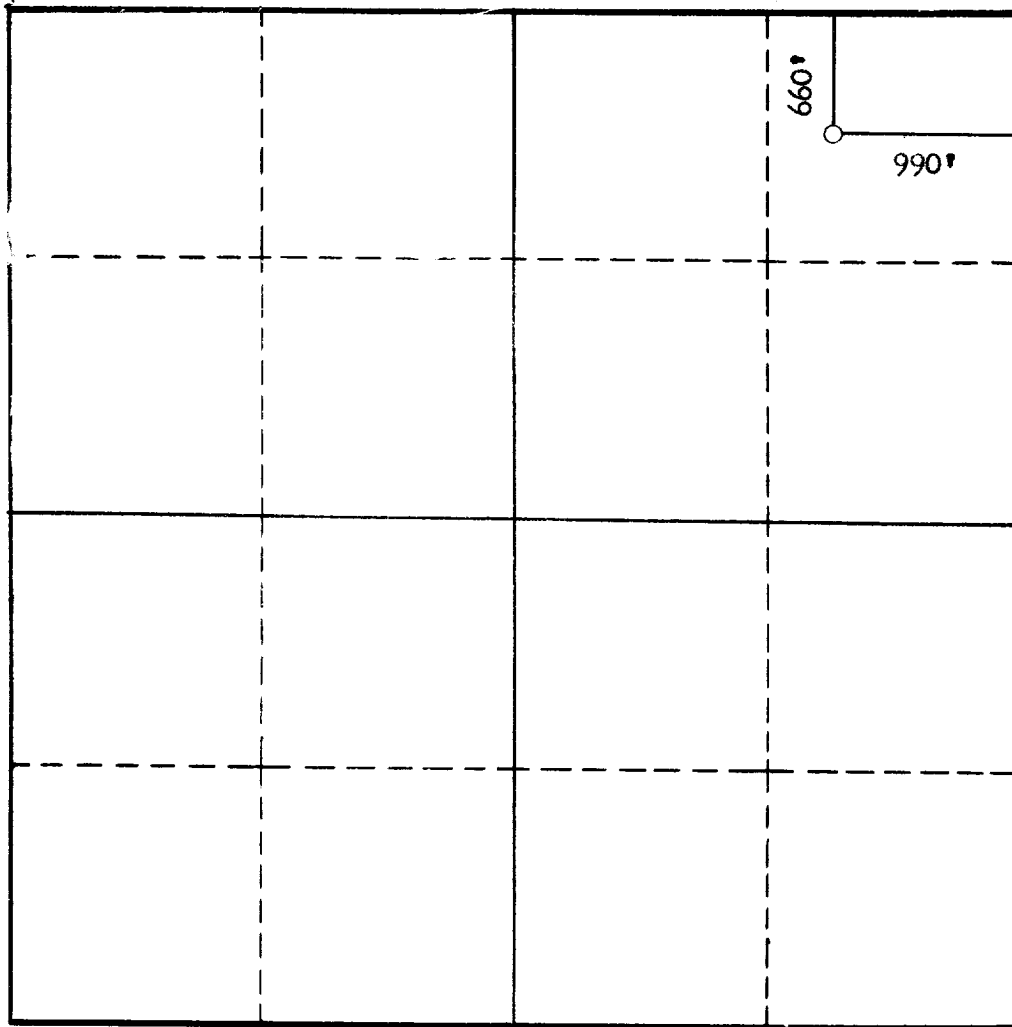

NOTE

This section of form is to be used for gas wells only.



SCALE: 1" = 1000'

1. Is this Well a Dual Comp. ? Yes ___ No ___.
2. If the answer to Question 1 is yes, are there any other dually completed wells within the dedicated acreage ? Yes ___ No ___.

This is to certify that the above plat was prepared from field notes of actual surveys made by me or under my supervision and that the same are true and correct to the best of my knowledge and belief.

Name _____
Position _____
Representing _____
Address _____

Date Surveyed 4/17/57
George H. Hinckfeld
Registered Professional Engineer and/or
Land Surveyor