

**NOTICE OF INTENTION TO DRILL**

Notice must be given to the District Office of the Oil Conservation Commission and approval obtained before drilling or recompletion begins. If changes in the proposed plan are considered advisable a copy of this notice showing such changes will be returned to the sender. Submit this notice in **QUINTUPLICATE**. One copy will be retained following approval. See additional instructions in Rules and Regulations of the Commission. If State Land submit 6 copies of form C-128 in triplicate to first 3 copies of form C-101

Roswell, New Mexico

May 27, 1958

(Place)

(Date)

OIL CONSERVATION COMMISSION  
SANTA FE, NEW MEXICO

Gentlemen:

You are hereby notified that it is our intention to construct a well of a well to be known as

Byard Bennett

D.A. Williams

(Lease)

Section No. 1

in E M

(Unit) The well is

located 330 feet from the West line and 330 feet from the

South line of Section 23, T. 19 S, R. 37 E, NMPM.

(GIVE LOCATION FROM SECTION LINE) Undesignated Pool, Lea County

If State Land the Oil and Gas Lease is No. \_\_\_\_\_

If patented land the owner is H.T. Mattern, Trustee

Address \_\_\_\_\_

We propose to drill well with drilling equipment as follows: Rotary Tools

The status of plugging bond is \$10,000 Blanket Bond No. S-11697  
approved 12/16/57.

Drilling Contractor \_\_\_\_\_

We intend to complete the well in the Penrose formation at an approximate depth of 4,000 feet.

**CASING PROGRAM**

We propose to use the following strings of Casing and to cement them as indicated:

Size of Hole	Size of Casing	Weight per Foot	New or Second Hand	Depth	Sacks Cement
<u>10-3/4</u>	<u>8-5/8</u>	<u>24</u>	<u>New</u>	<u>400</u>	<u>Cement Solid</u>
<u>7-2/8</u>	<u>5-1/2</u>	<u>14</u>	<u>New</u>	<u>4000</u>	<u>150</u>

If changes in the above plans become advisable we will notify you as follows:

ADDITIONAL INFORMATION (If recompletion give full details of proposed plan of work.)

Approved \_\_\_\_\_  
Except as follows:

Sincerely yours,

Byard Bennett

(Company or Operator)

*Byard Bennett*

Operator

Send Communications regarding well to

Byard Bennett

Box 48 Roswell, New Mexico

OIL CONSERVATION COMMISSION

By \_\_\_\_\_

MEXICO OIL CONSERVATION COMMISSION

Well Location and Acreage Dedication Plat

Section A.

Date, May 27, 1958

Operator Byard Bennett Lease D.A. Williams  
 Well No. 1 Unit Letter M Section 23 Township 19 S Range 33 E NMPM  
 Located 330 Feet From West Line, 330 Feet From South Line  
 County Lea G. T. Elevation \_\_\_\_\_ Dedicated Acreage 4 Acres  
 Name of Producing Formation Penrose Pool Undesignated

1. Is the Operator the only owner\* in the dedicated acreage outlined on the plat below?  
Yes  No \_\_\_\_\_.
2. If the answer to question one is "no," have the interests of all the owners been consolidated by communitization agreement or otherwise? Yes \_\_\_\_\_ No \_\_\_\_\_. If answer is "yes," Type of Consolidation \_\_\_\_\_.
3. If the answer to question two is "no," list all the owners and their respective interests below:

<u>Owner</u>	<u>Land Description</u>

Section B

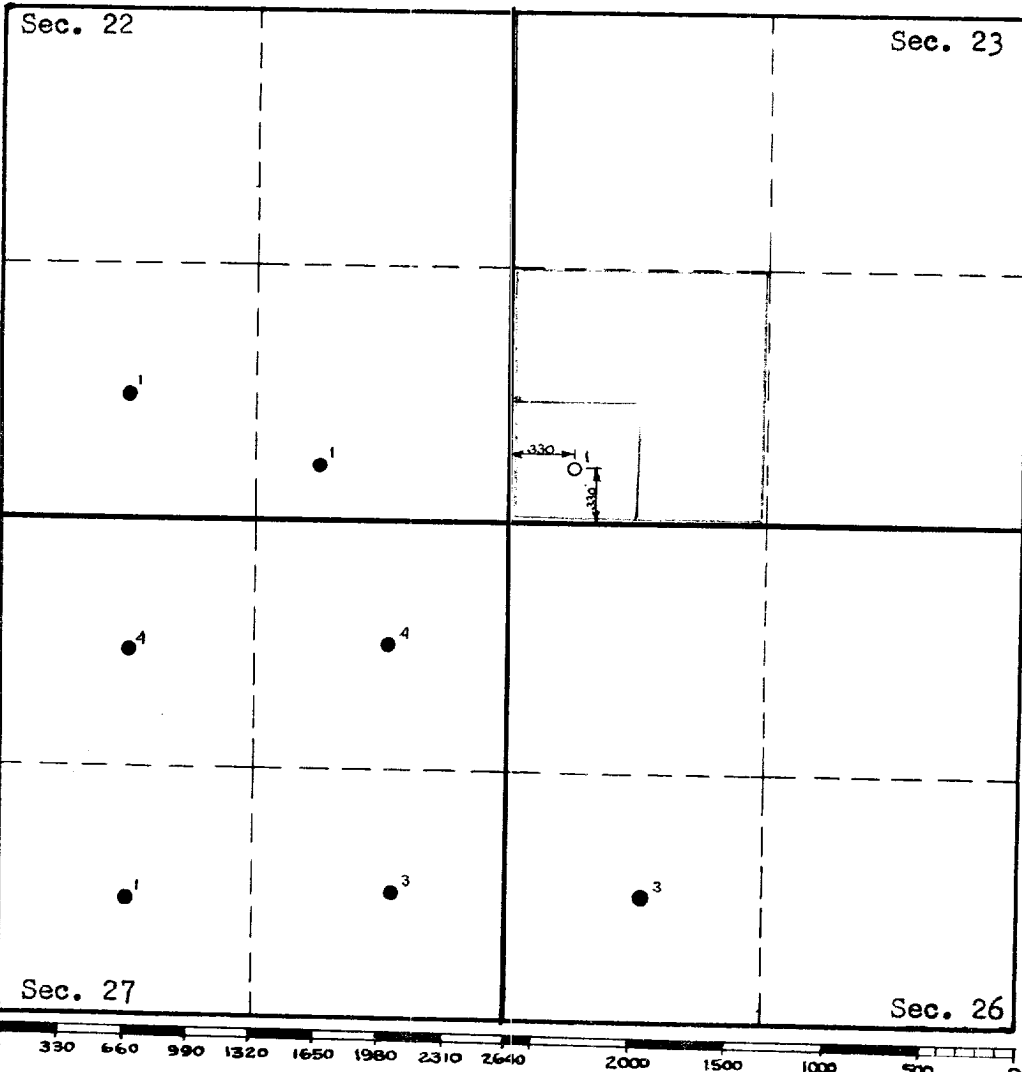

This is to certify that the information in Section A above is true and complete to the best of my knowledge and belief.

Byard Bennett

(Operator)

Byard Bennett  
(Representative)

Box 48 Roswell, N.M.

Address

This is to certify that the well location shown on the plat in Section B was plotted from field notes of actual surveys made by me or under my supervision and that the same is true and correct to the best of my knowledge and belief.

Date Surveyed 4-25-58

Gay A. Smith  
Registered Professional Engineer and/or Land Surveyor.

Certificate No. 2787

INSTRUCTIONS FOR COMPLETION:

1. Operator shall furnish and certify to the information called for in Section A.
2. Operator shall outline the dedicated acreage for both oil and gas wells on the plat in Section B.
3. A registered professional engineer or land surveyor registered in the State of New Mexico or approved by the Commission shall show on the plat the location of the well and certify this information in the space provided.
4. All distances shown on the plat must be from the outer boundaries of Section.
5. If additional space is needed for listing owners and their respective interests as required in question 3, Section A, please use space below

\* "Owner" means the person who has the right to drill into and to produce from any pool and to appropriate the production either for himself or for himself and another. (65-3-29 (e) NMSA 1953 Comp.)