

NEW MEXICO
OIL CONSERVATION COMMISSION

Form C-128

Well Location and/or Gas Proration Plat

Operator Gulf Lease HOBBS OFFICE 000-56 Date 000-56
E.M. Kutter "B"
 Well No. 4 Section 28 Township 19-S Range 37-E NMPM
 Located 1980 Feet From North Line, 1650 Feet From West Line,
Lea County, New Mexico. G. L. Elevation _____

Name of Producing Formation _____ Pool _____ Dedicated Acreage _____

(Note: All distances must be from outer boundaries of Section)

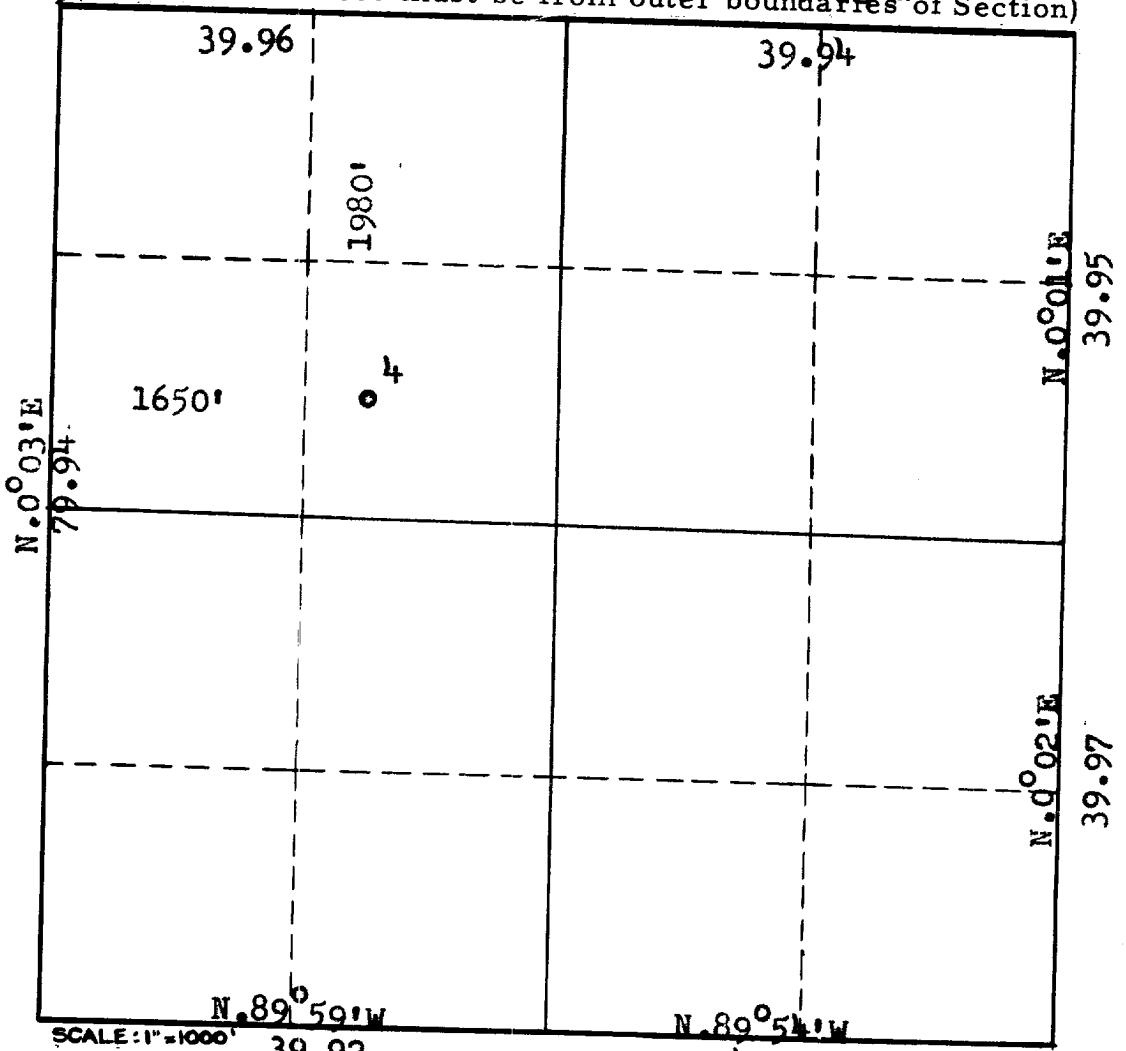

1. Is this Well a Dual Comp. ? Yes 39.92 No x.
2. If the answer to Question 1 is yes, are there any other dually completed wells within the dedicated acreage? Yes _____ No _____.

This is to certify that the above plat was prepared from field notes of actual surveys made by me or under my supervision and that the same are true and correct to the best of my knowledge and belief.

Name _____
 Position _____
 Representing _____
 Address _____

Date Surveyed 4-30-56
J. G. Jant
 Registered Professional Engineer and/or
 Land Surveyor