

STATE OF NEW MEXICO  
ENERGY AND MINERALS DEPARTMENT

CONSERVATION DIVISION  
P. O. BOX 2088  
SANTA FE, NEW MEXICO 87501

Form C-101  
Revised 10-1-78

NO. OF COPIES RECEIVED	
DISTRIBUTION	
SANTA FE	
FILE	
U.S.G.S.	
LAND OFFICE	
OPERATOR	

5A. Indicate Type of Lease  
STATE ☐ FEE ☒

5. State Oil & Gas Lease No.

APPLICATION FOR PERMIT TO DRILL, DEEPEN, OR PLUG BACK

1a. Type of Work b. Type of Well OIL WELL <input checked="" type="checkbox"/> GAS WELL <input type="checkbox"/> OTHER <input type="checkbox"/> SINGLE ZONE <input checked="" type="checkbox"/> MULTIPLE ZONE <input type="checkbox"/>				7. Unit Agreement Name	
2. Name of Operator AMOCO PRODUCTION COMPANY				8. Farm or Lease Name Capps	
3. Address of Operator P. O. Box 68, Hobbs, NM 88240				9. Well No. 32	
4. Location of Well UNIT LETTER L LOCATED 2026 FEET FROM THE South LINE AND 516 FEET FROM THE West LINE OF SEC. 3 TWP. 19-S RGE. 38-E NMPM				10. Field and Pool, or Wildcat Hobbs GSA	
11. Elevations (show whether DT, RT, etc.) 3609.9' GL				12. County Lea	
19. Proposed Depth		19A. Formation GSA		20. Rotary or C.T. Rotary	
21A. Kind & Status Plug. Bond		21B. Drilling Contractor		22. Approx. Date Work will start	

23.

PROPOSED CASING AND CEMENT PROGRAM

SIZE OF HOLE	SIZE OF CASING	WEIGHT PER FOOT	SETTING DEPTH	SACKS OF CEMENT	EST. TOP
	Existing casing	will not be altered			

Propose to abandon the Drinkard, recomplete to the Grayburg San Andres, and shut-in pending approval for injection as follows:

Pull rods, pump, and tubing. Set a cast iron bridge plug at apx. 6600' and cap with 35' of cement. Spot 34 bbl 10# brine water with 25# gel/bbl. Spot 34 sacks class C neat cement at apx. 5600'. Spot 32 bbl 10# brine water with 25# gel/bbl. Spot 34 sacks class C neat cement at apx. 4600'. Pull up to 4450' and circ. casing with clean fresh water. Perforate San Andres Zones II and III intervals 4108'-24', 44'-52', 57'-87', 4197'-4206', 17'-25', and 30'-35' with 4 JSPF. Run a packer to 4230' and spot 4 bbl 15% NE HCL acid. Pull up and set the packer at 4000'. Acidize San Andres with 8000 gallons of 15% NE HCL acid in 2 equal stages separated by 200# graded rock salt and 70# 100 mesh salt in 200 gal 30# gelled brine water. Flush with 75 bbl clean, fresh water. Pull the packer. Run 2-3/8" plastic coated tubing and injection packer. Set the packer at 4000' and load the backside with corrosion inhibitor. Shut the well in pending approval for injection.

0+5-NMOCD, H 1-R. E. Ogden, HOU Rm. 21.150 1-F. J. Nash, HOU Rm. 4.206 1-CLF

IN ABOVE SPACE DESCRIBE PROPOSED PROGRAM; IF PROPOSAL IS TO DEEPEN OR PLUG BACK, GIVE DATA ON PRESENT PRODUCTIVE ZONE AND PROPOSED NEW PRODUCTIVE ZONE. GIVE BLOWOUT PREVENTER PROGRAM, IF ANY.

I hereby certify that the information above is true and complete to the best of my knowledge and belief.

Signed Cathy L. Torman Title Assist. Admin. Analyst Date 1-17-84

(This space for SIGNED BY EDDIE SEAY)

APPROVED BY OIL & GAS INSPECTOR TITLE  DATE JAN 18 1984

CONDITIONS OF APPROVAL, IF ANY:

NEW MEXICO OIL CONSERVATION COMMISSION  
WELL LOCATION AND ACREAGE DEDICATION PLAT

Form C-102  
Supersedes C-128  
Effective 1-1-65

All distances must be from the outer boundaries of the Section.

Operator <b>AMOCO Production Co.</b>			Lease <b>Capps</b>		Well No. <b>32</b>
Unit Letter <b>L</b>	Section <b>3</b>	Township <b>19 South</b>	Range <b>38 East</b>	County <b>Lea</b>	
Actual Footage Location of Well: <b>2026</b> feet from the <b>South</b> line and <b>516</b> feet from the <b>West</b> line					
Ground Level Elev. <b>3609.9</b>	Producing Formation <b>Grayburg San Andres</b>		Pool <b>Hobbs GSA</b>	Dedicated Acreage: <b>40</b> Acres	

1. Outline the acreage dedicated to the subject well by colored pencil or hachure marks on the plat below.
2. If more than one lease is dedicated to the well, outline each and identify the ownership thereof (both as to working interest and royalty).
3. If more than one lease of different ownership is dedicated to the well, have the interests of all owners been consolidated by communitization, unitization, force-pooling, etc?

☐ Yes ☐ No If answer is "yes," type of consolidation \_\_\_\_\_

If answer is "no," list the owners and tract descriptions which have actually been consolidated. (Use reverse side of this form if necessary.) \_\_\_\_\_

No allowable will be assigned to the well until all interests have been consolidated (by communitization, unitization, forced-pooling, or otherwise) or until a non-standard unit, eliminating such interests, has been approved by the Commission.

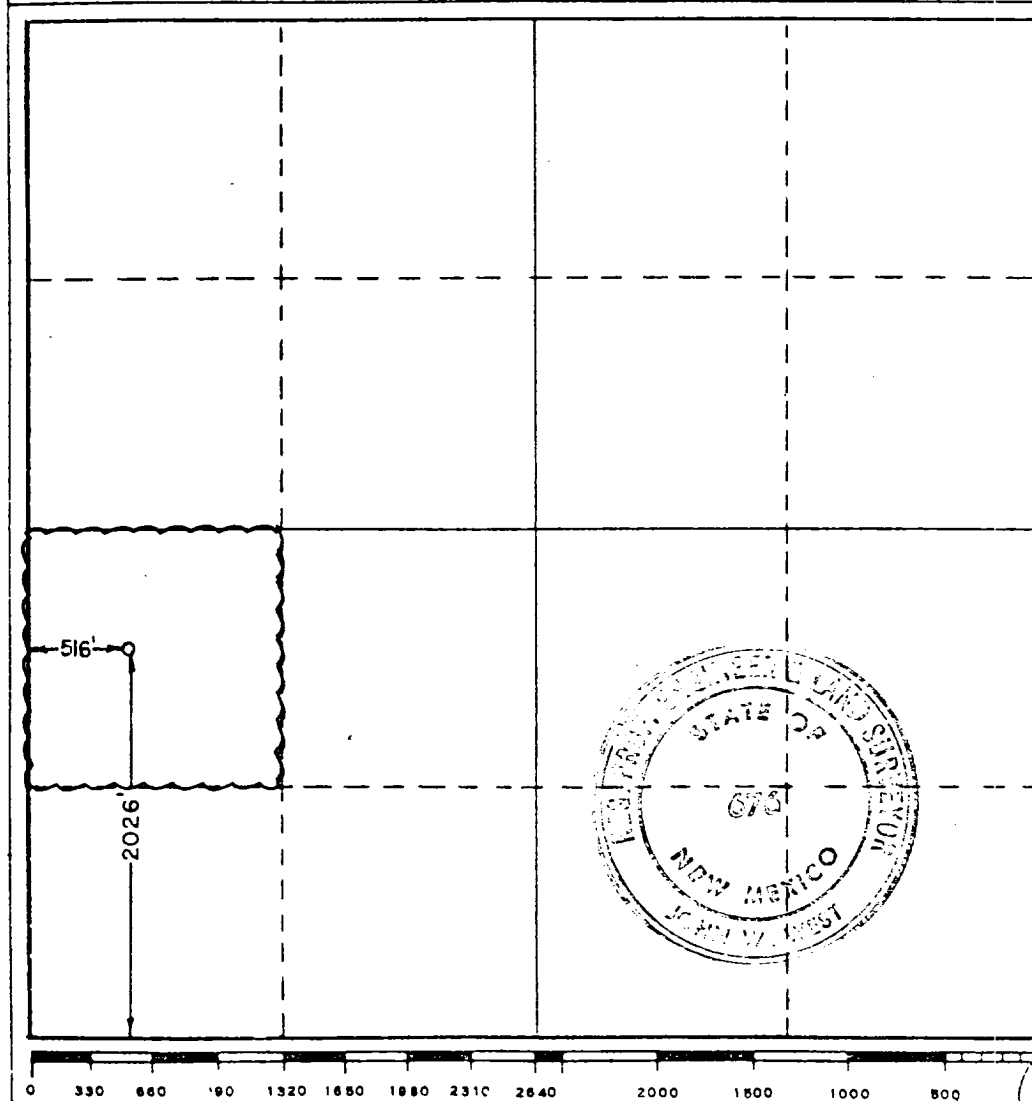

CERTIFICATION

I hereby certify that the information contained herein is true and complete to the best of my knowledge and belief.

Name  
*Cathy L. Forman*  
Position  
Assist. Admin. Analyst  
Company  
AMOCO PRODUCTION COMPANY  
Date  
1-17-84

I hereby certify that the well location shown on this plat was plotted from field notes of actual surveys made by me or under my supervision, and that the same is true and correct to the best of my knowledge and belief.

Date Surveyed  
December 27, 1979  
Registered Professional Engineer and/or Land Surveyor

*John W. West*  
Certificate No. **John W. West 676**  
**Ronald J. Eidson 3239**