

All distances must be from the outer boundaries of the Section.

Operator Amoco Production Company		Lease South Hobbs Unit		Well No. 238	
Unit Letter 0	Section 4	Township 19 South	Range 38 East	County Lea	
Actual Footage Location of Well: 660' feet from the South line and 2610' feet from the East line					
Ground Level Elev. 3606.0'	Producing Formation San Andres		Pool Hobbs (G/SA)	Dedicated Acreage 40 Acres	

1. Outline the acreage dedicated to the subject well by colored pencil or hatchure marks on the plat below.
2. If more than one lease is dedicated to the well, outline each and identify the ownership thereof (both as to working interest and royalty).
3. If more than one lease of different ownership is dedicated to the well, have the interests of all owners been consolidated by communization, unitization, force-pooling, etc?

☐ Yes ☐ No If answer is "yes," type of consolidation _____

If answer is "no," list the owners and tract descriptions which have actually been consolidated. (Use reverse side of this form if necessary.) _____

No allowable will be assigned to the well until all interests have been consolidated (by communization, unitization, forced-pooling, or otherwise) or until a non-standard unit, eliminating such interests, has been approved by the Division.

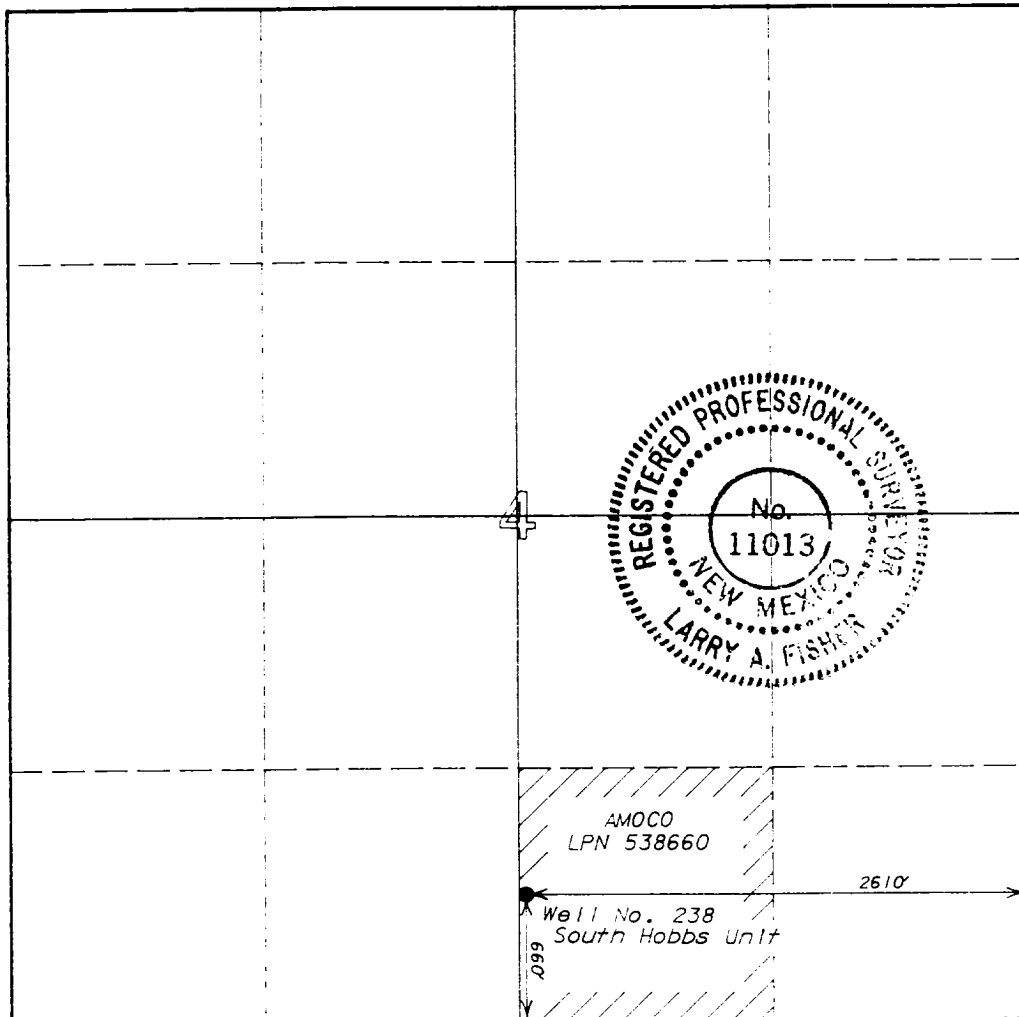

CERTIFICATION

I hereby certify that the information contained herein is true and complete to the best of my knowledge and belief.

Name Kim A. Colman
Position Asst. Admin. Analyst
Company Amoco Production Company
Date 10-14-91

I hereby certify that the well location shown on this plat was plotted from field notes of actual surveys made by me or under my supervision, and that the same is true and correct to the best of my knowledge and belief.

Date Surveyed October 2, 1991

Registered Land Surveyor
Larry A. Fisher
Larry A. Fisher

Certificate No. 11013