

Submit to Appropriate
District Office
State Lease - 6 copies
Fee Lease - 5 copies

State of New Mexico
Energy, Minerals and Natural Resources Department

Form C-101
Revised 1-1-89

OIL CONSERVATION DIVISION

DISTRICT I
P.O. Box 1980, Hobbs, NM 88240

P.O. Box 2088
Santa Fe, New Mexico 87504-2088

DISTRICT II
P.O. Drawer DD, Artesia, NM 88210

DISTRICT III
1000 Rio Brazos Rd., Aztec, NM 87410

API NO. (assigned by OCD on New Wells)

3D-025-32163

5. Indicate Type of Lease

STATE ☐

FEE ☒

6. State Oil & Gas Lease No.

APPLICATION FOR PERMIT TO DRILL, DEEPEN, OR PLUG BACK

1a. Type of Work:

DRILL ☒

RE-ENTER ☐

DEEPEN ☐

PLUG BACK ☐

b. Type of Well:

OIL
WELL ☒

GAS
WELL ☐

OTHER ☐

SINGLE
ZONE ☒

MULTIPLE
ZONE ☐

7. Lease Name or Unit Agreement Name

Francis Evelyn

2. Name of Operator

Drum Energy Corporation

8. Well No.

1

3. Address of Operator

P.O. Box 2134, Midland, TX 79702

9. Pool name or Wildcat

House Blinbry

4. Well Location

Unit Letter N : 990 Feet From The South Line and 1740 Feet From The West Line

Section 35 Township 19S Range 38E NMPM Lea County

10. Proposed Depth

6200 feet

11. Formation

Blinbry

12. Rotary or C.T.

Rotary

13. Elevations (Show whether DF, RT, GR, etc.)

3579.7-ground

14. Kind & Status Plug Bond

* Cash

15. Drilling Contractor

to be determined

16. Approx. Date Work will start

10-15-93

17.

PROPOSED CASING AND CEMENT PROGRAM

SIZE OF HOLE	SIZE OF CASING	WEIGHT PER FOOT	SETTING DEPTH	SACKS OF CEMENT	EST. TOP
15	12 3/4	33	30	RediMix	Surface
12 1/4	8 5/8	24	1650	800	Surface
7 7/8	5 1/2	17	6200	1600	Surface

8 5/8 casing: Use 8 5/8" guide shoe and 8 5/8" insert float, class C cement, circulate to surface

5 1/2 casing: Use 5 1/2" guide shoe and 5 1/2" float collar with automatic fill, DV tool. Cement 1 st stage with 50/50 Pozmix "C", 2 % gel, 18% salt; second stage with Halliburton Lite with 15 lbs. salt, 5 lbs. Gilsonite, and 1/4 lb. Flocele per sack, tail with class "C" with 4 lbs. salt per sack, circulate to surface

Mud: Drill surface hole with fresh water gel. Drill production hole with saturated salt (10.1 lb./gal.), water loss of 10 cc/30 min., viscosity of 34 to 36 seconds.

Completion: Perforate in top 100' of Blinbry; acid treat. Fracture treat if necessary.

BOP Program: A 10 3/4" 2000psi Rotating Head will be used while drilling surface hole. Before drilling out from under the surface the well will be equipped with a 3000 psi 10" 900 Series double ram hydraulic BOP system.

* 7,500 cash bond to be tendered prior to spudding well.

IN ABOVE SPACE DESCRIBE PROPOSED PROGRAM: IF PROPOSAL IS TO DEEPEN OR PLUG BACK, GIVE DATA ON PRESENT PRODUCTIVE ZONE AND PROPOSED NEW PRODUCTIVE ZONE. GIVE BLOWOUT PREVENTER PROGRAM, IF ANY.

I hereby certify that the information above is true and complete to the best of my knowledge and belief.

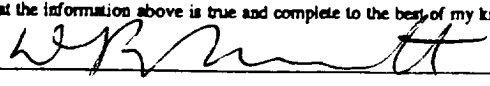
SIGNATURE  TITLE President DATE 8-4-93

TYPE OR PRINT NAME David R. Mussett

TELEPHONE NO(915)684-9081

(This space for State Use)

ORIGINAL SIGNED BY JERRY SEXTON
DISTRICT I SUPERVISOR

APPROVED BY _____ TITLE _____ DATE OCT 19 1993

CONDITIONS OF APPROVAL, IF ANY:

Permit Expires 6 Months From Approval
Date Unless Drilling Underway.

Submit to Appropriate
District Office
State Lease - 4 copies
Fee Lease - 3 copies

State of New Mexico
Energy, Minerals and Natural Resources Department

Form C-102
Revised 1-1-89

OIL CONSERVATION DIVISION

P.O. Box 2088
Santa Fe, New Mexico 87504-2088

DISTRICT I
P.O. Box 1980, Hobbs, NM 88240

DISTRICT II
P.O. Drawer DD, Artesia, NM 88210

DISTRICT III
1000 Rio Brazos Rd., Aztec, NM 87410

WELL LOCATION AND ACREAGE DEDICATION PLAT

All Distances must be from the outer boundaries of the section

Operator Drum Energy Corporation			Lease Francis Evelyn		Well No. 1
Unit Letter N	Section 35	Township 19 South	Range 38 East	County NMPM Lea	
Actual Footage Location of Well: 990.0 feet from the South line and 1740.0 feet from the West line					
Ground level Elev. 3579.7	Producing Formation Blinebry		Pool House	Dedicated Acreage: 40 Acres	

1. Outline the acreage dedicated to the subject well by colored pencil or hatchure marks on the plat below.
2. If more than one lease is dedicated to the well, outline each and identify the ownership thereof (both as to working interest and royalty).
3. If more than one lease of different ownership is dedicated to the well, have the interest of all owners been consolidated by communitization, unitization, force-pooling, etc.?
☐ Yes ☐ No If answer is "yes" type of consolidation _____
If answer is "no" list the owners and tract descriptions which have actually been consolidated. (Use reverse side of this form if necessary.) _____
No allowable will be assigned to the well until all interests have been consolidated (by communitization, unitization, forced-pooling, or otherwise) or until a non-standard unit, eliminating such interest, has been approved by the Division.

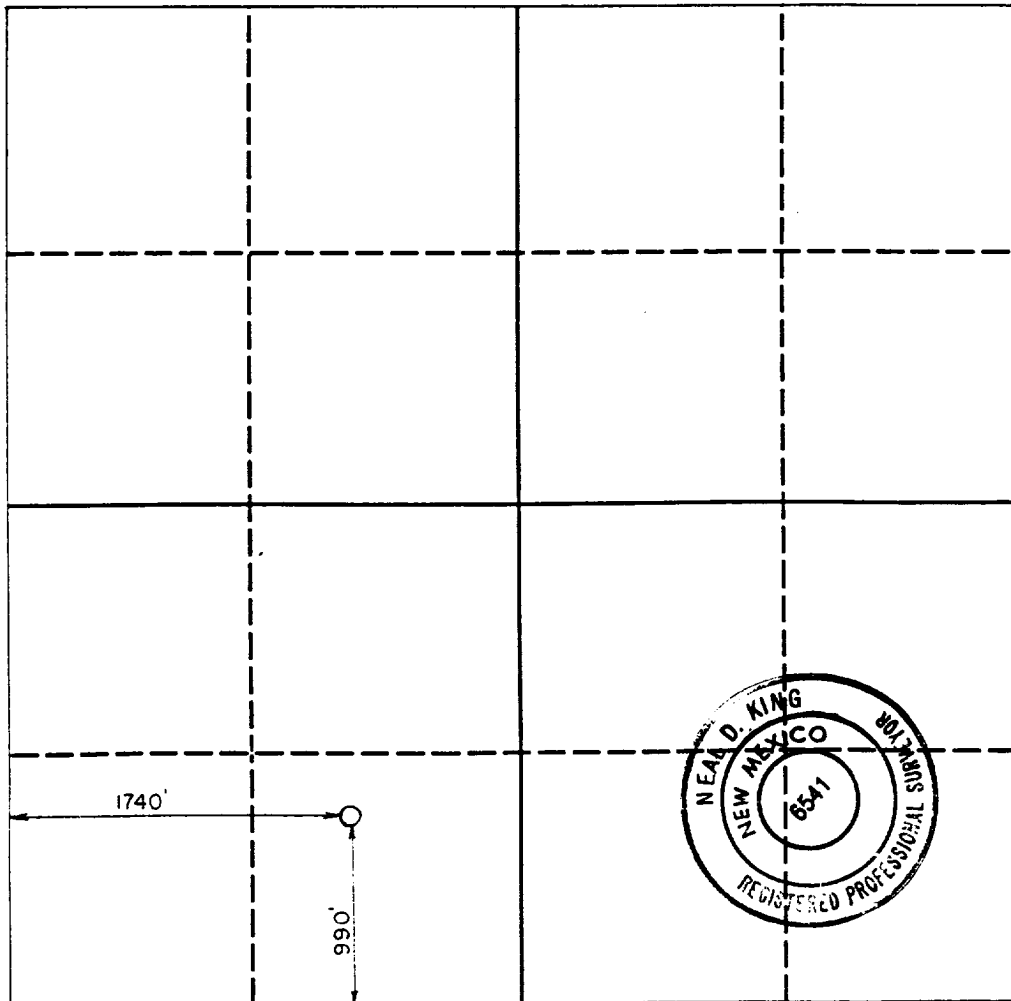

OPERATOR CERTIFICATION

I hereby certify that the information contained herein is true and complete to the best of my knowledge and belief.

Signature
David R. Mussett
Printed Name
David R. Mussett
Position
President
Company
Drum Energy Corp.
Date
8-03-93

SURVEYOR CERTIFICATION

I hereby certify that the well location shown on this plat was plotted from field notes of actual surveys made by me or under my supervision, and that the same is true and correct to the best of my knowledge and belief.

Date Surveyed
August 3, 1993
Signature & Seal of
Professional Surveyor
Neal D. King
Certificate No.
6541