

District I
PO Box 1980, Hobbs, NM 88241-1980
District II
811 S. 1st Street, Artesia, NM 88210-2834
District III
1000 Rio Brazos Rd., Aztec, NM 87410
District IV
PO Box 2088, Santa Fe, NM 87504-2088

OIL CONSERVATION DIVISION
P.O. Box 2088
Santa Fe, NM 87504-2088

AMENDED REPORT

APPLICATION FOR PERMIT TO DRILL, RE-ENTER, DEEPEN, PLUGBACK, OR ADD A ZONE

¹ Operator name and Address Chevron U.S.A. Inc. P.O. Box 1150 Midland, TX 79702		² OGRID Number 4323
⁴ Property Code 18927	⁵ Property Name MONUMENT "12" STATE	³ API Number 30-0 25-3392D
		⁶ Well Number 8

⁷ Surface Location									
UL or lot no.	Section	Township	Range	Lot. Idn	Feet from the	North/South Line	Feet from the	East/West line	County
N	12	19S	36E		419	SOUTH	1801	WEST	LEA

⁸ Proposed Bottom Hole Location If Different From Surface									
UL or lot no.	Section	Township	Range	Lot. Idn	Feet from the	North/South Line	Feet from the	East/West line	County
⁹ Proposed Pool 1 MONUMENT: ABO. NORTH 46980					¹⁰ Proposed Pool 2				

¹¹ Work Type Code N	¹² Well Type Code O	¹³ Cable/Rotary ROTARY	¹⁴ Lease Type Code S	¹⁵ Ground Level Elevation 3728'
¹⁶ Multiple NO	¹⁷ Proposed Depth 8000'	¹⁸ Formations ABO	¹⁹ Contractor UNKNOWN	²⁰ Spud Date 4/30/97

²¹ Proposed Casing and Cement Program

Hole Size	Casing Size	Casing weight/foot	Setting Depth	Sacks of Cement	Estimated TOC
14-3/4"	11-3/4"	42	400'	275	SURFACE
11"	8-5/8"	24	2800'	800	SURFACE
7-7/8"	5-1/2"	15.5 & 17	TD	850	2600'

²² Describe the proposed program. If this application is to DEEPEN or PLUG BACK give the data on the present productive zone and proposed new productive zone. Describe the blowout prevention program, if any. Use additional sheets if necessary.

CHEVRON PROPOSES TO:
DRILL WITH BIT TO 400', RUN 11-3/4" CSG. CMT WITH CLASS "C" TO SURFACE. NU BOPE & TEST.
DRILL WITH BIT TO 2800', RUN 8-5/8" CSG. CMT WITH CLASS "C" TO SURFACE. DRILL WITH BIT TO 8000', RUN 5-1/2" CSG. CMT WITH CLASS "C" AND "H" IN 2 STAGES. NU BOPE & TEST.

MUD PROGRAM: SURFACE HOLE: 0' - 400', FRESH WATER 8.4 PPG. INTERMEDIATE HOLE: 400' - 2800', BRINE WATER 10.0 PPG. PRODUCTION HOLE: 2800' - TD, CUT BRINE WATER 8.8 PPG.

*****PLEASE EXPEDITE*****

²³ I hereby certify that the information given above is true and complete to the best of my knowledge and belief.		OIL CONSERVATION DIVISION	
Signature: <i>J. K. Ripley</i>	Printed name: J. K. Ripley	Approved by: ORIGINAL SIGNED BY JERRY SEXTON	Title: DISTRICT I SUPERVISOR
Title: T. A.	Date: 4/7/97	Approval Date: APR 11 1997	Expiration Date:
Phone: (915) 687-7148	Conditions of Approval: Attached <input type="checkbox"/>		

Permit Expires 1 Year From Approval Date Unless Drilling Underway

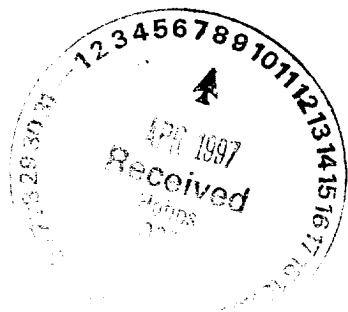

DISTRICT I
P.O. Box 1980, Hobbs, NM 88241-1980

State of New Mexico

Form C-102

Energy, Minerals and Natural Resources Department

Revised February 10, 1994
Submit to Appropriate District Office
State Lease - 4 Copies
Fee Lease - 3 Copies

DISTRICT II
P.O. Drawer DD, Artesia, NM 88211-0719

DISTRICT III
1000 Rio Brazos Rd., Aztec, NM 87410

OIL CONSERVATION DIVISION

P.O. Box 2088

DISTRICT IV
P.O. BOX 2088, SANTA FE, N.M. 87504-2088

Santa Fe, New Mexico 87504-2088

AMENDED REPORT

WELL LOCATION AND ACREAGE DEDICATION PLAT

API Number 30-025-33920		Pool Code 46980	Pool Name MONUMENT; ABO, NORTH
Property Code 18927	Property Name MONUMENT 12 STATE		Well Number 8
OGRID No. 4323	Operator Name CHEVRON U.S.A. INC.		Elevation 3728

Surface Location

UL or lot No.	Section	Township	Range	Lot Idn	Feet from the	North/South line	Feet from the	East/West line	County
N	12	19 S	36 E		419	SOUTH	1801	WEST	LEA

Bottom Hole Location If Different From Surface

UL or lot No.	Section	Township	Range	Lot Idn	Feet from the	North/South line	Feet from the	East/West line	County

Dedicated Acres 40	Joint or Infill	Consolidation Code	Order No.
-----------------------	-----------------	--------------------	-----------

NO ALLOWABLE WILL BE ASSIGNED TO THIS COMPLETION UNTIL ALL INTERESTS HAVE BEEN CONSOLIDATED OR A NON-STANDARD UNIT HAS BEEN APPROVED BY THE DIVISION

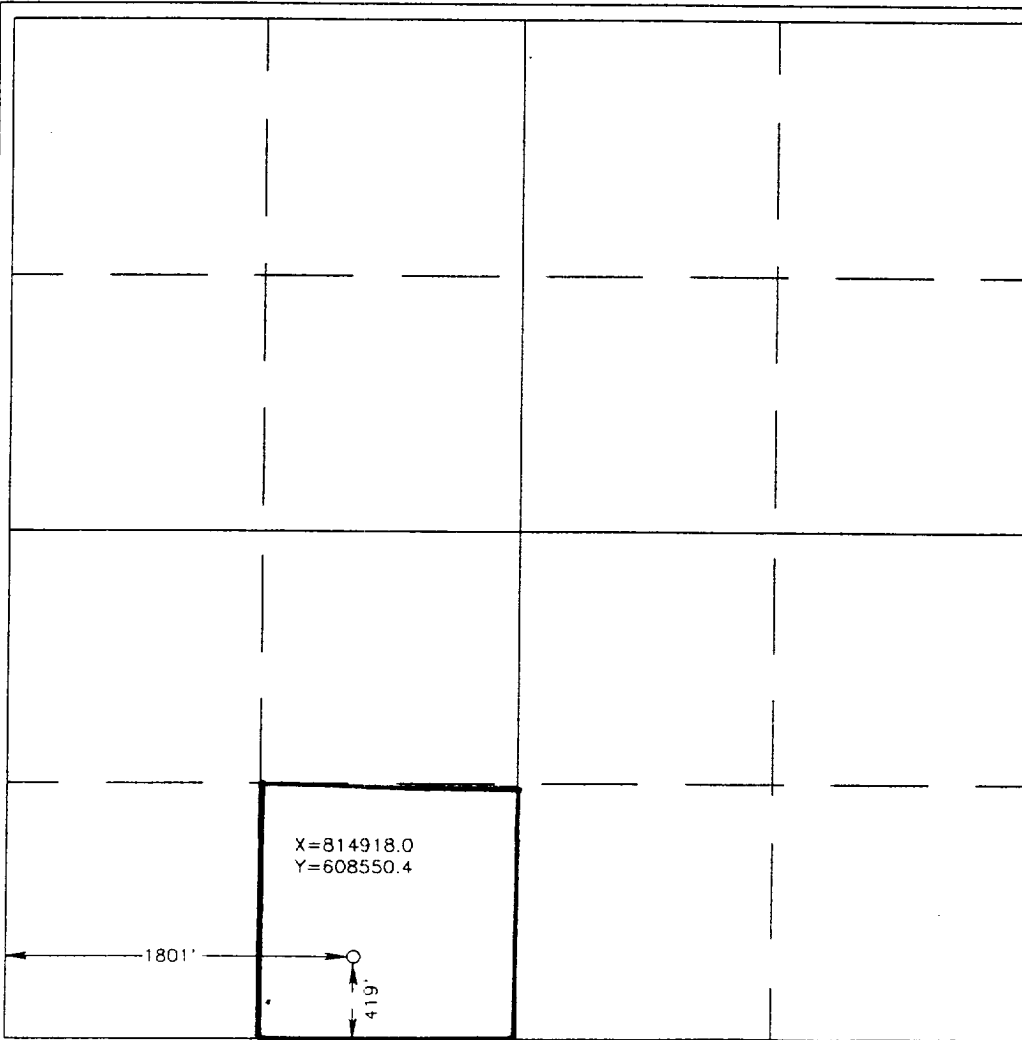

OPERATOR CERTIFICATION

I hereby certify the the information contained herein is true and complete to the best of my knowledge and belief.

J. K. Ripley
Signature

J. K. Ripley
Printed Name

T.A.
Title

4/7/97
Date

SURVEYOR CERTIFICATION

I hereby certify that the well location shown on this plat was plotted from field notes of actual surveys made by me or under my supervision, and that the same is true and correct to the best of my belief.

MARCH 25, 1997
Date Surveyed

J. EIDSON DMCC
Signature & Seal of Professional Surveyor

[Signature]
3-28-97

98-11-0547

Certificate No. JOHN W. WEST 676
RONALD E. EIDSON 3239
GARY EIDSON 12641



VICINITY MAP

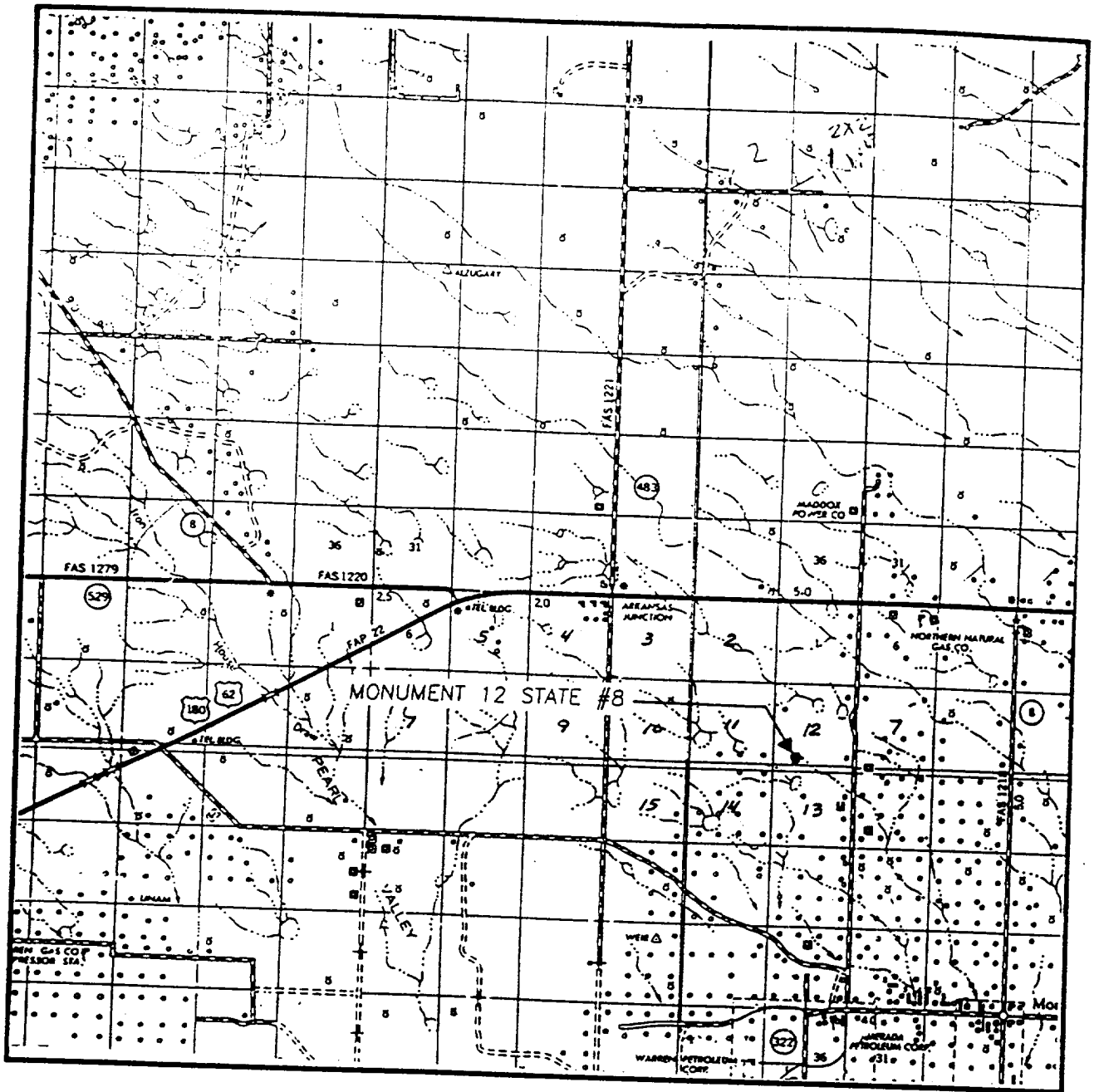

SCALE: 1" = 2 MILES

SEC. 12 TWP. 19-S RGE. 36-E
 SURVEY N.M.P.M.
 COUNTY LEA
 DESCRIPTION 419' FSL & 1801' FWL
 ELEVATION 3728
 OPERATOR CHEVRON U.S.A. INC.
 LEASE MONUMENT 12 STATE

JOHN WEST ENGINEERING
HOBBS, NEW MEXICO
(505) 393-3117

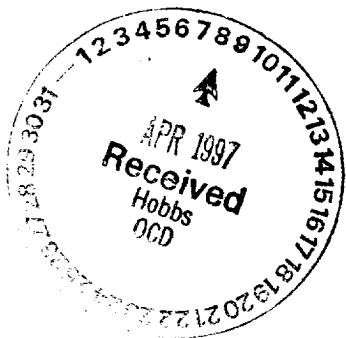

LOCATION VERIFICATION MAP

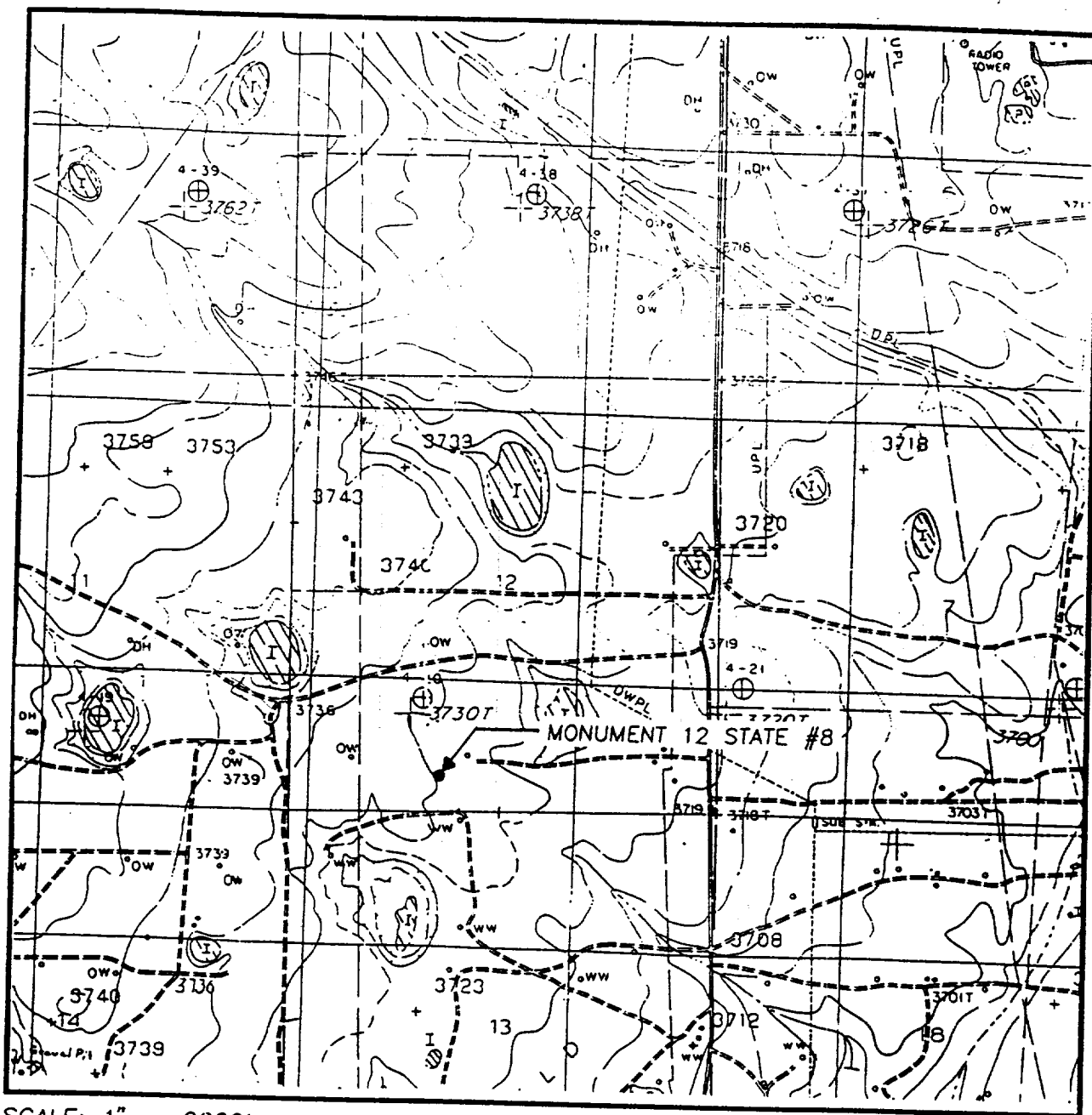

SCALE: 1" = 2000'

CONTOUR INTERVAL:
MONUMENT NORTH - 5'

SEC. 12 TWP. 19-S RGE. 36-E

SURVEY N.M.P.M.

COUNTY LEA

DESCRIPTION 419' FSL & 1801' FWL

ELEVATION 3728

OPERATOR CHEVRON U.S.A. INC.

LEASE MONUMENT 12 STATE

U.S.G.S. TOPOGRAPHIC MAP

MONUMENT NORTH, N.M.

**JOHN WEST ENGINEERING
HOBBS, NEW MEXICO**

(505) 393-3117

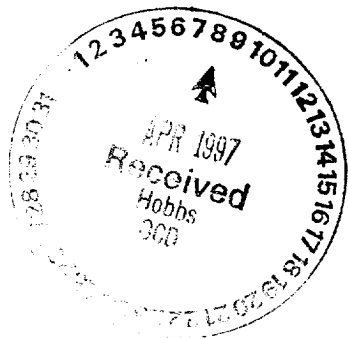

4/15/97

300