

NEW MEXICO OIL CONSERVATION COMMISSION
WELL LOCATION AND DEDICATION PLAT

FORM C-123
Revised 5/1/57

SEE INSTRUCTIONS FOR COMPLETING THIS FORM ON THE REVERSE SIDE

Operator: **TEXACO Inc.** Lease: **C. H. Weir "B"** Well No.: **5**

Unit Letter: **G** Section: **11** Township: **20 South** Range: **17 East** County: **Lea**

Actual Footage Location of Well: **1980** feet from the **North** line and **1650** feet from the **East** line, Sec. **11**

Ground Level Elev.: _____ Producing Formation: **Blinebry (Gas)** Pool: **Undesignated Blinebry (Gas)** Dedicated Acreage: ~~160~~ **160** Acres

- * To be a triple with Glorietta (Oil) & Brinnard (Oil)
1. Is the Operator the only owner in the dedicated acreage outlined on the plat below? YES _____ NO X. ("Owner" means the person who has the right to drill into and to produce from any pool and to appropriate the production either for himself or for himself and another. (65-3-29 (e) NMSA 1935 Comp.)
 2. If the answer to question one is "no," have the interests of all the owners been consolidated by communitization agreement or otherwise? YES X NO _____. If answer is "yes," Type of Consolidation: Joint Operating Agreement
 3. If the answer to question one is "no," list all the owners and their respective interests below:

Owner	Land Description

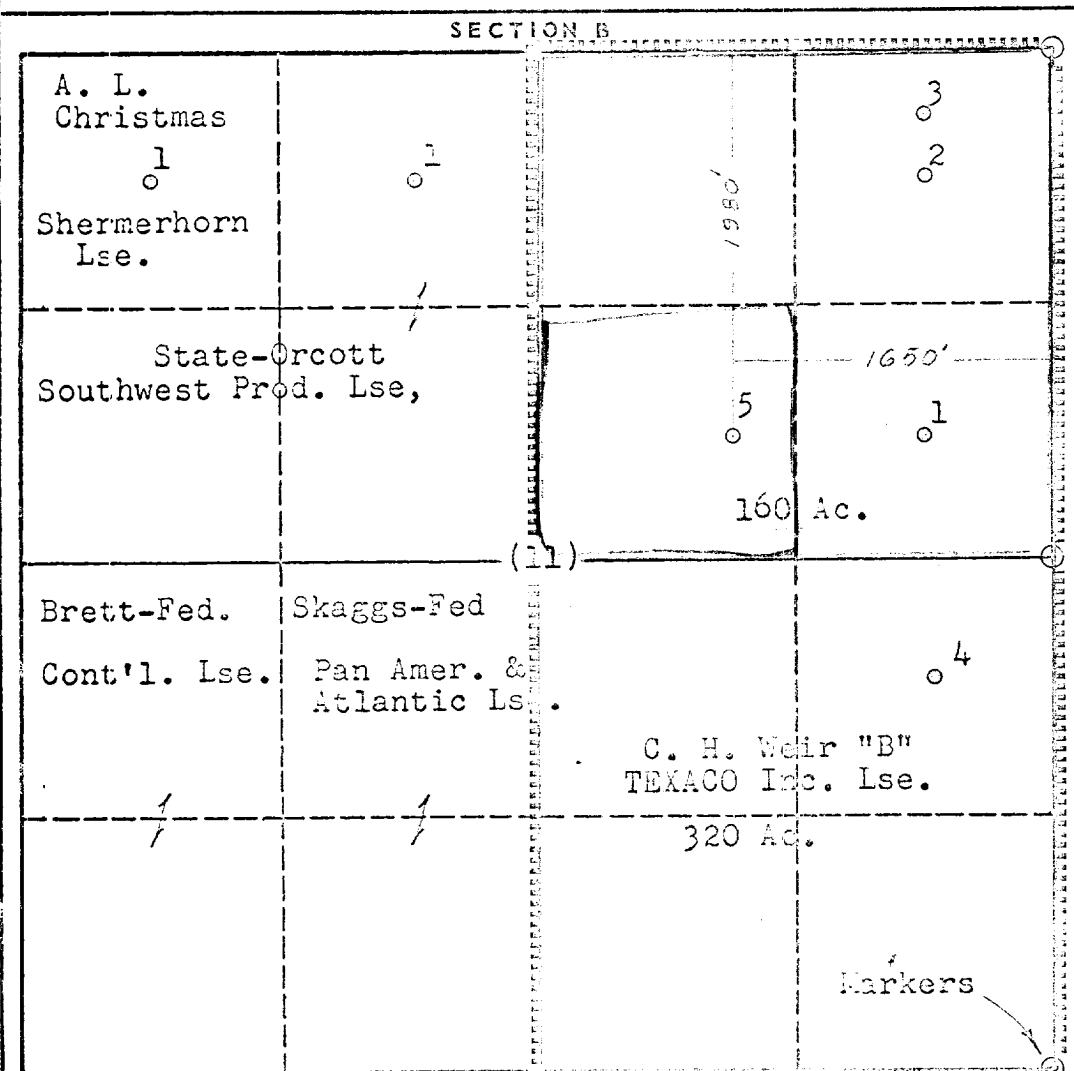

CERTIFICATION

I hereby certify that the information in SECTION A above is true and complete to the best of my knowledge and belief.

Name: J. J. Velten
Position: Division Civil Engineer
Company: TEXACO Inc.
Date: 11/15/61

I hereby certify that the well location shown on the plat in SECTION B was plotted from field notes of actual surveys made by me or under my supervision, and that the same is true and correct to the best of my knowledge and belief.

Date Surveyed: 11/15/61

Registered Professional Engineer and/or Land Surveyor: J. J. Velten

Certificate No.: 8174

