

DISTRICT I  
 P.O. Box 30, Hobbs, NM 88241-1980  
 DISTRICT II  
 P.O. Box Drawer 100, Artesia, NM 88211-0719  
 DISTRICT III  
 1000 Rio Brazos Rd., Aztec, NM 87410  
 DISTRICT IV  
 P.O. Box 2088, Santa Fe, NM 87504-2088

State of New Mexico  
 Energy, Minerals and Natural Resources Department

C-102  
 Revised February 10, 1994  
 Instructions on back  
 Submit to Appropriate District Office  
 State Lease - 4 Copies  
 Fee Lease - 3 Copies  
 AMENDED REPORT

**OIL CONSERVATION DIVISION**

P.O. Box 2088  
 Santa Fe, New Mexico 87504-2088

**WELL LOCATION AND ACREAGE DEDICATION PLAT**

<sup>1</sup> API Number 30 025 06133		<sup>2</sup> Pool Code 76480		<sup>3</sup> Pool Name Eumont Yates 7R Queen	
<sup>4</sup> Property Code 11100		<sup>5</sup> Property Name STATE -I-			<sup>6</sup> Well No. 2
<sup>7</sup> OGR D Number 02:351		<sup>8</sup> Operator Name TEXACO EXPLORATION & PRODUCTION INC.			<sup>9</sup> Elevation 3541 DF

<sup>10</sup> Surface Location

UI or lot no.	Section	Township	Range	Lot.Idn	Feet From The	North/South Line	Feet From The	East/West Line	County
K	16	20-S	37-E		1980	SOUTH	1980	WEST	LEA

<sup>11</sup> Bottom Hole Location If Different From Surface

UI or lot no.	Section	Township	Range	Lot.Idn	Feet From The	North/South Line	Feet From The	East/West Line	County

<sup>12</sup> Dedicated Acres 160	<sup>13</sup> Joint or Infill No	<sup>14</sup> Consolidation Code	<sup>15</sup> Order No.
--------------------------------------	-------------------------------------	----------------------------------	-------------------------

NO ALLOWABLE WILL BE ASSIGNED TO THIS COMPLETION UNTIL ALL INTERESTS HAVE BEEN CONSOLIDATED OR A NON-STANDARD UNIT HAS BEEN APPROVED BY THE DIVISION

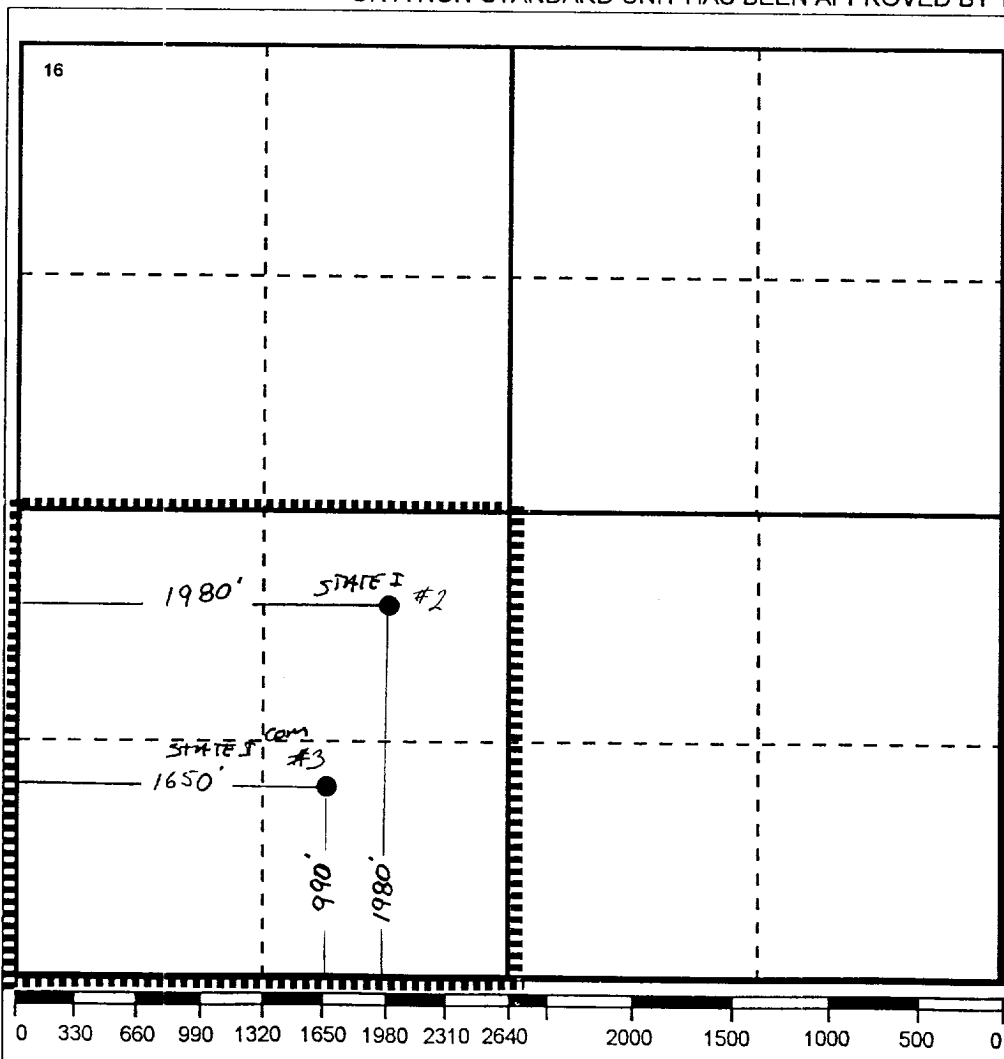

**17 OPERATOR CERTIFICATION**  
 I hereby certify that the information contained herein is true and complete to the best of my knowledge and belief

Signature: *[Signature]*  
 Printed Name: Darrell J. Carnger  
 Position: Engineering Assistant  
 Date: 6/2/95

**18 SURVEYOR CERTIFICATION**  
 I hereby certify that the well location shown on this plat was plotted from field notes of actual surveys made by me or under my supervision, and that the same is true and correct to the best of my knowledge and belief.

Date Surveyed:  
 Signature & Seal of Professional Surveyor:  
 Certificate No.:

**RECEIVED**

JAN 15 1964  
U.S. CUSTOMS  
OFFICE