

NEW MEXICO
OIL CONSERVATION COMMISSION

Form C-128

Well Location and/or Gas Incorporation Plat

Date 11-2-56

Operator TEXAS CRUDE OIL CO. Lease NOV 5 1956 MASTER

Well No. 3-12 Section 12 Township 20 SOUTH Range 38 EAST NMPM

Located 1980 Feet From EAST Line, 660 Feet From SOUTH Line,

LEA

County, New Mexico. G. L. Elevation

Name of Producing Formation Drinkard Pool House Dedicated Acreage 40

(Note: All distances must be from outer boundaries of Section)

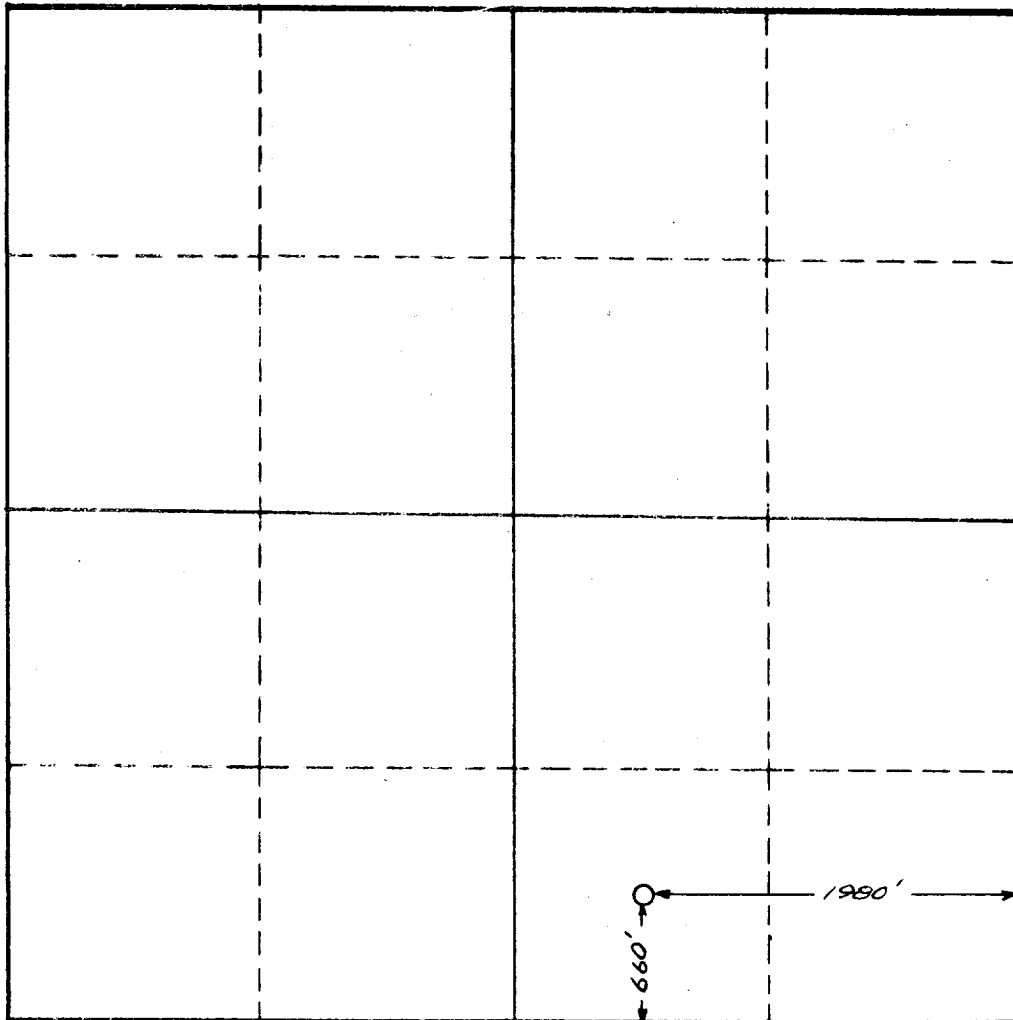

SCALE: 1" = 1000'

Is this Well a Dual Comp.? Yes No

If the answer to Question 1 is yes, are there any other dually completed wells within the dedicated acreage? Yes No

This is to certify that the above plat was prepared from field notes of actual surveys made by me or under my supervision and that the same are true and correct to the best of my knowledge and belief.

Date Surveyed 11-2-56

Registered Professional Engineer and/or Land Surveyor

Signature John G. Oliver
Petroleum Engineer
Representing Texas Crude Oil Company
Address 111 Capital Bldg., Midland, Texas
MOOC 3, File 1, PW 1.