

**NEW MEXICO OIL CONSERVATION COMMISSION**  
**Santa Fe, New Mexico**

Form O-101  
 Revised (12/1/55)

**NOTICE OF INTENTION TO DRILL**

Notice must be given to the District Office of the Oil Conservation Commission and approval obtained before drilling or recompletion begins. If changes in the proposed plan are considered advisable, a copy of this notice showing such changes will be returned to the sender. Submit this notice in **QUINTUPLICATE**. One copy will be returned following approval. See additional instructions in Rules and Regulations of the Commission. **If State Land submit 6 Copies Attach Form O-128 in triplicate to first 3 copies of form O-101**

Midland, Texas  
 (Place)

9-12-62  
 (Date)

**OIL CONSERVATION COMMISSION**  
**SANTA FE, NEW MEXICO**

Gentlemen:

You are hereby notified that it is our intention to commence the Drilling of a well to be known as  
 Humble Oil & Refining Co. PR 43-2-85  
 (Company or Operator)

New Mexico State BU  
 (Lease)

Well No. 1, in N (Unit)

The well is

located 1980 feet from the West line and 660 feet from the

South line of Section 2, T 22-S, R 34-E, NMPM.

(GIVE LOCATION FROM SECTION LINE) Wildcat Pool, Lea County

If State Land the Oil and Gas Lease is No. E-6618

If patented land the owner is Surface Owner - Merchant Livestock Co.

Address

We propose to drill well with drilling equipment as follows: rotary

The status of plugging bond is on file

Drilling Contractor Unknown

We intend to complete this well in the Permian Capitan formation at an approximate depth of 4500 feet.

**CASING PROGRAM**

We propose to use the following strings of Casing and to cement them as indicated:

Size of Hole	Size of Casing	Weight per Foot	New or Second Hand	Depth	Sacks Cement
9-7/8	7-5/8	24	New	300	200 sks*
6-3/4	4-1/2	9.5	New	4500	200 sks**

If changes in the above plans become advisable we will notify you immediately.

**ADDITIONAL INFORMATION** (If recompletion give full details of proposed plan of work.)

\*Circl to surface.

\*\*Circl to at least 600' above top of uppermost pay zone.

Min. mud for samples.

**CORING PROGRAM**

2 Yates 7-Rivers 3800'

Approved....., 19.....  
 Except as follows:

Sincerely yours,

HUMBLE OIL & REFINING COMPANY

By J.E. Pinkston  
 (Company or Operator)

Position Adm. Specialist

Send Communications regarding well to

Name R. R. McCarty

Address Box 1600, Midland, Texas

**OIL CONSERVATION COMMISSION**

By.....

Well Location and Acreage Dedication Plat

Section A.

Date 9-11-62

Operator Humble Oil & Refining Co. Lease 113 NEW MEXICO STATE "BU"  
 Well No. 1 Unit Letter "N" Section Sec 2 Township 22 South Range 34 East NMPM  
 Located 1980' Feet From West Line, 660' Feet From South Line  
 County Lea G. L. Elevation Later Dedicated Acreage 40 Acres  
 Name of Producing Formation Permian Capitan Pool Wildcat

1. Is the Operator the only owner\* in the dedicated acreage outlined on the plat below?  
 Yes  No \_\_\_\_\_
2. If the answer to question one is "no", have the interests of all the owners been consolidated by communitization agreement or otherwise? Yes \_\_\_\_\_ No \_\_\_\_\_ If answer is "yes," Type of Consolidation \_\_\_\_\_
3. If the answer to question two is "no," list all the owners and thier respective interests below:

Owner

Land Description

<u>Owner</u>	<u>Land Description</u>

Section B

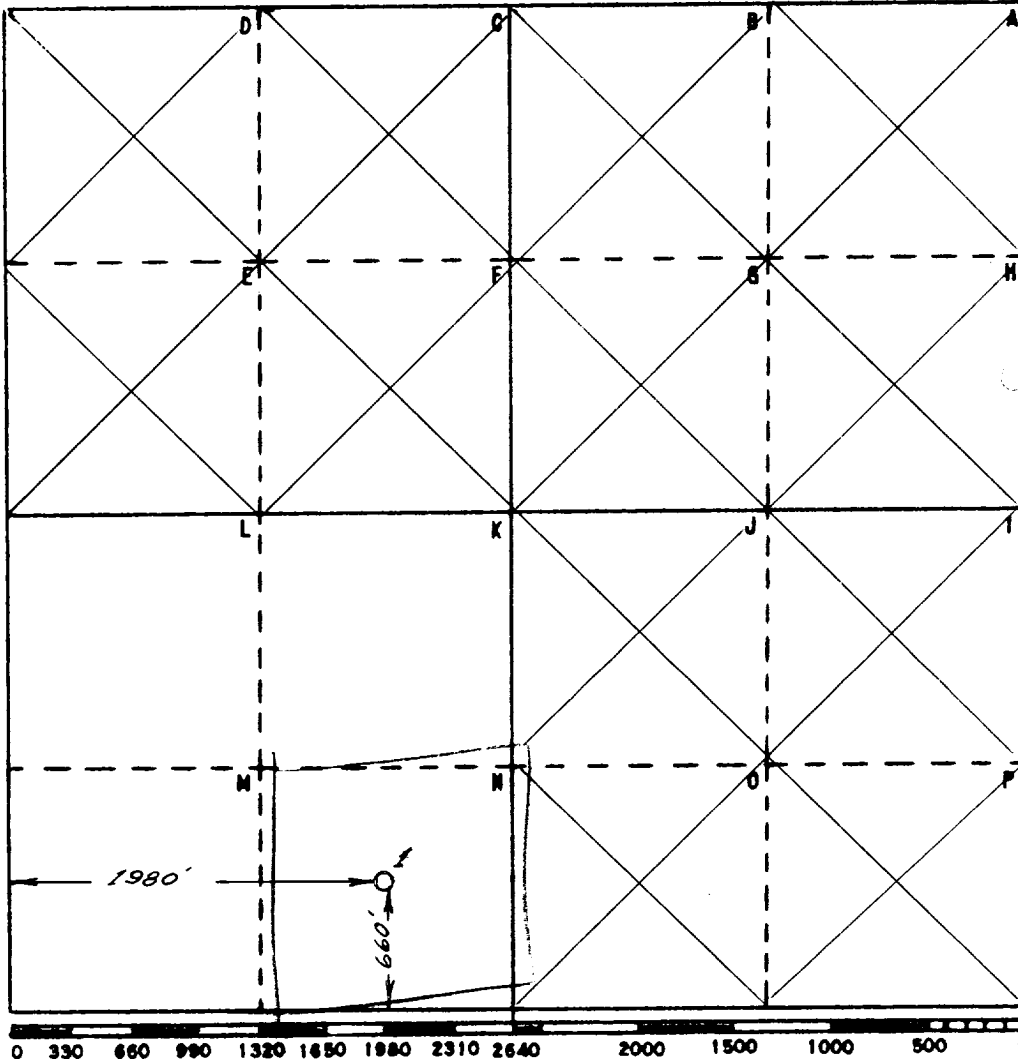

This is to certify that the information in Section A above is true and complete to the best of my knowledge and belief

HUMBLE OIL & REFG. CO.

(Operator)

W. S. Shepherd  
 (Representative)

Box 1600 Midland, Texas  
 Address

This is to certify that the well location shown on the plat in Section B was plotted from field notes of actual surveys made by me or under my supervision and that the same is true and correct to the best of my knowledge and belief.

Date Surveyed 9-11-62

W. S. Shepherd  
 Registered Professional  
 Engineer and/or Land Surveyor

Certificate No. 1382

1-21-S R-34-E  
Shell

Jos. I. O'Neill

Gulf  
State 34  
Shell 3

State

35 36 State

Humble

2 1 Atlantic

T-22-S R-34-E

Texaco

160 AC. LSE., ST. LSE. NO.  
E-6618

1980'



State

State

State

Ohio 10

Amerada

Humble

11 12 C.W. Merchant

U.S.

State

C.W. Merchant

This is to certify that I am a registered professional engineer or registered land surveyor, in the State of New Mexico, that this map was prepared from field notes of actual surveys made by me or under my direction and that the same is true and correct to the best of my knowledge and belief.

1382 *A. S. Hunterfield*  
Registration Number Registered Professional Engineer or Registered Land Surveyor

This Application For Well No. 1

NEW MEXICO STATE "BU" P.R. 43-2-85  
LEA COUNTY, NEW MEXICO

HUMBLE OIL & REFINING COMPANY  
SOUTHWEST REGION  
PRODUCTION DEPARTMENT  
MIDLAND, TEXAS

DRAWN J.E.C.

ENGR. SECTION CIVIL

REVISED

SCALE 1" = 1000'

JOB NO.

FILE NO.

CHECKED *R.L. MSLH*

APPROVED

DATE 9-11-62

W-A 3402