

DUPLICATE

NEW MEXICO OIL CONSERVATION COMMISSION
Santa Fe, New Mexico

NOTICE OF INTENTION TO DRILL OR RECOMPLETE

Notice must be given to the District Office of the Oil Conservation Commission and approval obtained before drilling or recompletion begins. If changes in the proposed plan are considered advisable, a copy of this notice showing such changes will be returned to the sender. Submit this notice in **QUINTUPLICATE**. One copy will be returned following approval. See additional instructions in **Rule 13** and Regulations of the Commission. **If State Land submit 6 Copies**

Midland, Texas

(Place)

May 8, 1956

(Date)

OIL CONSERVATION COMMISSION
SANTA FE, NEW MEXICO

Gentlemen:

You are hereby notified that it is our intention to commence the (Drilling) (Recompletion) of a well to be known as **The British American Oil Producing Company**

(Company or Operator)

Hall State "D"

(Lease)

Well No. **2**

in **H**

(Unit)

The well is

located **330** feet from the **East** line and **1900** feet from the

North

line of Section **23**

, T. **22-S**

, R. **35-E**

, NMPM.

(GIVE LOCATION FROM SECTION LINE)

Undesignated Pool,

Lea County

County

If State Land the Oil and Gas Lease is No. **State No. 13137**

If patented land the owner is.....

Address.....

We propose to drill well with drilling equipment as follows: **Rotary to T.D. of 4200'**

The status of plugging bond is **\$ 10,000 Continental Casualty Company**
effective 1947.

Drilling Contractor **Unknown**

We intend to complete this well in the **Yates Formation**

formation at an approximate depth of **3800-4100** feet.

CASING PROGRAM

We propose to use the following strings of Casing and to cement them as indicated:

Size of Hole	Size of Casing	Weight per Foot	New or Second Hand	Depth	Sacks Cement
12 1/4"	8 5/8"OD	22.7	New	320	350
7 7/8"	4 1/2"OD	9.50	New	4200	250

If changes in the above plans become advisable we will notify you immediately.

ADDITIONAL INFORMATION (If recompletion give full details of proposed plan of work.)

Note: Please call approval to: C.E. Brandon, Dist. Sup t., Phone 4-8021, Midland, Texas, Collect.

Approved....., 19.....
Except as follows:

OIL CONSERVATION COMMISSION

By.....

Sincerely yours,

The British American Oil Producing Company
(Company or Operator)

By **German B. French** *Remond. French*

Position **District Clerk**

Send Communications regarding well to

Name **The British American Oil Prod. Co.**

Address **P.O. Box 2818, Midland, Texas**

NEW MEXICO
OIL CONSERVATION COMMISSION

Form C-128

Well Location and/or Gas Proration Plat

Date MAY 8, 1956

Operator BRITISH AMERICAN OIL PROD'G CO. Lease HALL-STATE "D", N/2 SEC. 23

Well No. 2 Section 23 Township 22-S Range 35-E NMPM

Located 1980' Feet From NORTH Line, 330' Feet From EAST Line,

LEA County, New Mexico. G. L. Elevation 3593'

Name of Producing Formation YATES-SAND Pool UNDESIGNATED Dedicated Acreage 40

(Note: All distances must be from outer boundaries of Section)

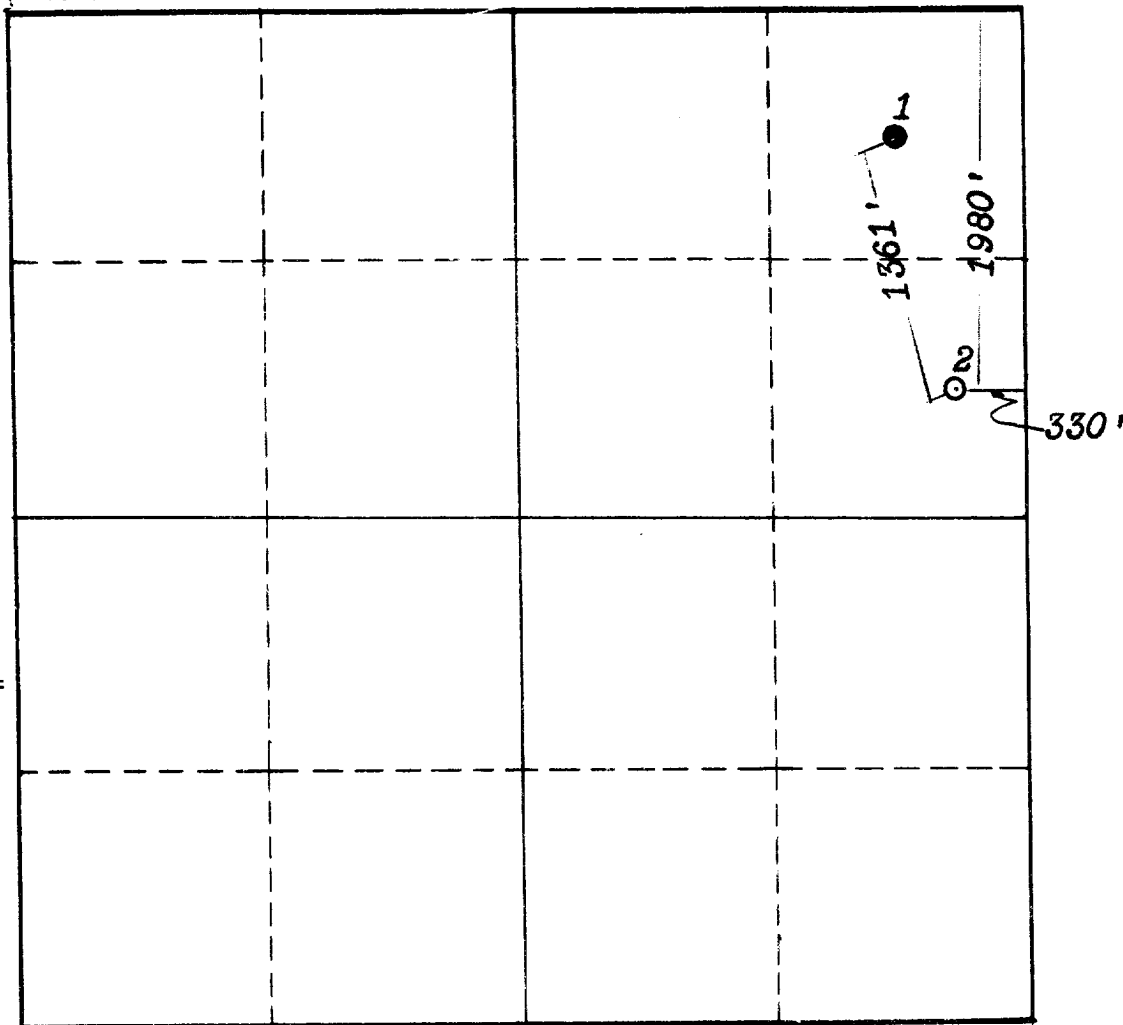

NOTE

This section of form is to be used for gas wells only.



SCALE: 1"=1000'

1. Is this Well a Dual Comp. ? Yes No .
2. If the answer to Question 1 is yes, are there any other dually completed wells within the dedicated acreage? Yes No .

Name _____
Position _____
Representing _____
Address _____

This is to certify that the above plat was prepared from field notes of actual surveys made by me or under my supervision and that the same are true and correct to the best of my knowledge and belief.

Date Surveyed MAY 8, 1956
[Signature]
Registered Professional Engineer and/or Land Surveyor